

# VERTICAL KARRIER™ PANEL - HORIZONTAL METAL FACADE

|                |                                    |
|----------------|------------------------------------|
| KPV-DS-01-MTLH | C & I DISCLAIMER                   |
| KPV-PP-01-MTLH | PANEL PROFILES                     |
| KPV-PP-02-MTLH | PANEL PROFILES                     |
| KPV-PJ-01-MTLH | EXPANDED PANEL JOINT               |
| KPV-PJ-02-MTLH | ENGAGED PANEL JOINT                |
| KPV-PJ-03-MTLH | INTERMEDIATE SUPPORT               |
| KPV-FS-01-MTLH | MULTI-STORY FIRE STOPPING DETAIL   |
| KPV-FS-02-MTLH | MULTI-STORY FIRE STOPPING ASSEMBLY |
| KPV-BS-01-MTLH | BASE DETAIL FLUSH                  |
| KPV-BS-02-MTLH | BASE AT NOTCHED CONCRETE           |
| KPV-BS-03-MTLH | BASE AT OVERHANG                   |
| KPV-BS-04-MTLH | BASE AT OVERHANG                   |
| KPV-OC-01-MTLH | OUTSIDE CORNER                     |
| KPV-IC-01-MTLH | INSIDE CORNER                      |
| KPV-FO-01-MTLH | FRAMED OPENING HEAD                |
| KPV-FO-02-MTLH | FRAMED OPENING JAMB                |
| KPV-FO-03-MTLH | FRAMED OPENING SILL                |
| KPV-FO-04-MTLH | FRAMED OPENING JAMB                |
| KPV-SJ-01-MTLH | STACK JOINT                        |
| KPV-PR-01-MTLH | PARAPET DETAIL                     |
| KPV-LE-01-MTLH | LOW EAVE DETAIL                    |
| KPV-RD-01-MTLH | RAKE DETAIL                        |
| KPV-TP-01-MTLH | PANEL TERMINATION                  |
| KPV-TL-01-MTLH | TRIM END LAP                       |
| KPV-TL-02-MTLH | TRIM END LAP WITH HEMS             |

## INDEX SHEET

DETAIL #: KPV-XX-XX-MTLH

DATE: 2019 REV1



[www.kingspanpanels.us](http://www.kingspanpanels.us)  
[www.kingspanpanels.ca](http://www.kingspanpanels.ca)

# VERTICAL KARRIER™ PANEL - HORIZONTAL METAL FACADE

## DISCLAIMERS:

THESE DETAILS ARE PROVIDED AS A GUIDELINE FOR PROPER PANEL AND ASSOCIATED COMPONENT INSTALLATION, AND ARE BASED ON INDUSTRY ACCEPTED PRACTICES.

LOCATION OF VAPOR BARRIERS AND ASSOCIATED SEALANTS IN THESE DETAILS ARE BASED ON TYPICAL DESIGN PRACTICES FOR MOST U.S. AND CANADIAN CLIMATIC ZONES. (THE PRIMARY VAPOR BARRIER IS PLACED ON THE "WARM" SIDE IN WINTER).

PROJECTS LOCATED IN AREAS SUBJECT TO EXTREME COLD AND/OR HIGH SNOW LOADS MAY REQUIRE MODIFICATIONS TO THESE DETAILS - CONTACT KINGSPAN TECHNICAL SERVICES FOR SPECIFIC PROJECT RECOMMENDATIONS.

ALL STRUCTURAL SUPPORTS ARE NOT BY KINGSPAN AND ARE SHOWN FOR CLARIFICATION AND ILLUSTRATION PURPOSES ONLY.

WALL SYSTEM DEFLECTIONS ARE TO BE DETERMINED BY THE ENGINEER OF RECORD.

ALL STRUCTURAL SUPPORTS ARE NOT BY KINGSPAN AND ARE SHOWN FOR CLARIFICATION AND ILLUSTRATION PURPOSES ONLY.

CONTACT KINGSPAN TECHNICAL SERVICES FOR MAXIMUM ALLOWABLE PANEL SPANS AND FASTENING PATTERNS.

DISCLAIMER

DETAIL #: KPV-DS-01-MTLH

DATE: 2019 REV1



[www.kingspanpanels.us](http://www.kingspanpanels.us)  
[www.kingspanpanels.ca](http://www.kingspanpanels.ca)

# VERTICAL KARRIER™ PANEL - HORIZONTAL METAL FACADE

CORE DEPTHS:  
2", 2.5", 3", 4", 5", 6"

MODULE WIDTH: 24", 30", 36", 42"

EMBOSSING:

EXTERIOR: STUCCO / SMOOTH\*

INTERIOR: STUCCO / SMOOTH

LENGTHS:

MINIMUM: 8'-0"

MAXIMUM: 53'-0"

STEEL GAUGES:

EXTERIOR: (REFER TO PROFILE)

INTERIOR: 26, 24, 22

REVEAL:  $\frac{3}{8}$ "

KARRIER CONFIGURATION

REQUIRES  $\frac{3}{8}$ " REVEAL

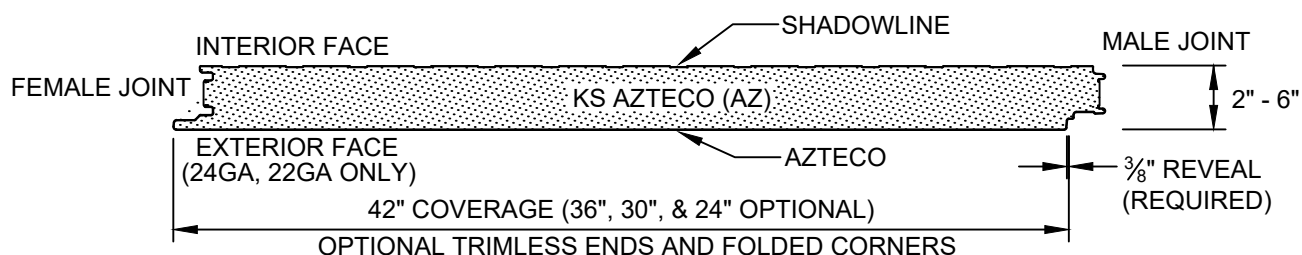
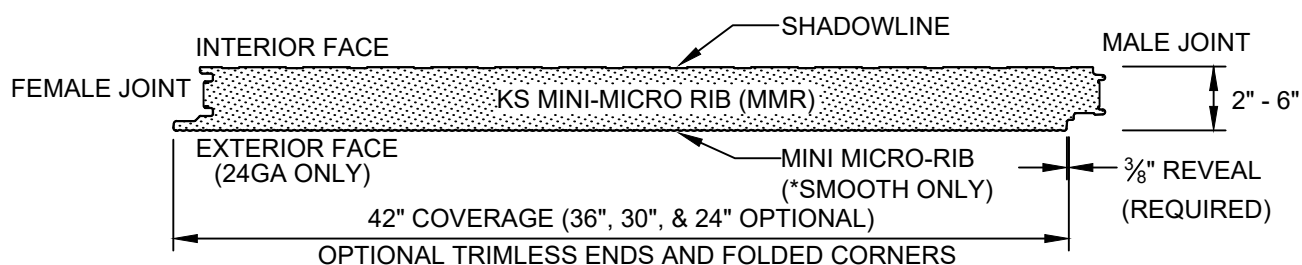
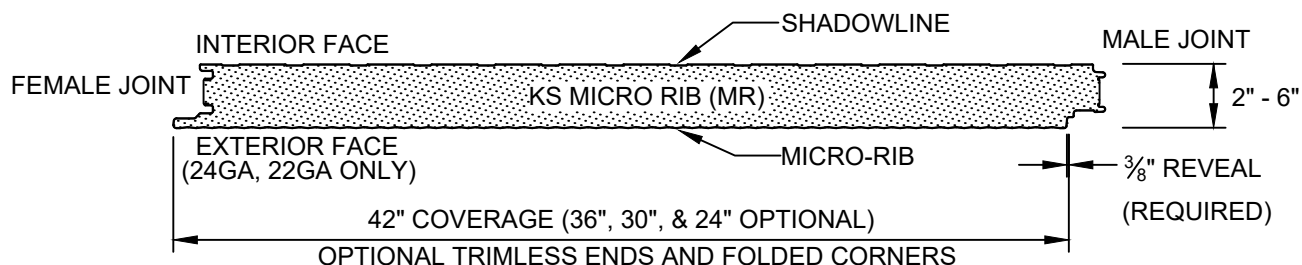
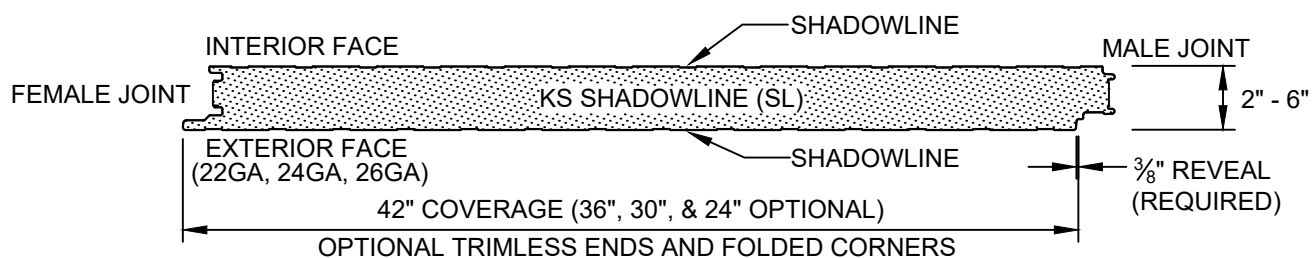

PANEL PROFILES

DETAIL #: KPV-PP-01-MTLH

DATE: 2019 REV1



[www.kingspanpanels.us](http://www.kingspanpanels.us)  
[www.kingspanpanels.ca](http://www.kingspanpanels.ca)

# VERTICAL KARRIER™ PANEL - HORIZONTAL METAL FACADE

CORE DEPTHS:  
2", 2.5", 3", 4", 5", 6"

MODULE WIDTH: 24", 30", 36", 42"

PANEL ORIENTATION: VERTICAL

EMBOSSING:

EXTERIOR: STUCCO / SMOOTH\*

INTERIOR: STUCCO / SMOOTH

LENGTHS:

MINIMUM: 8'-0"

MAXIMUM: 53'-0"

STEEL GAUGES:

EXTERIOR: (REFER TO PROFILE)

INTERIOR: 26, 24, 22

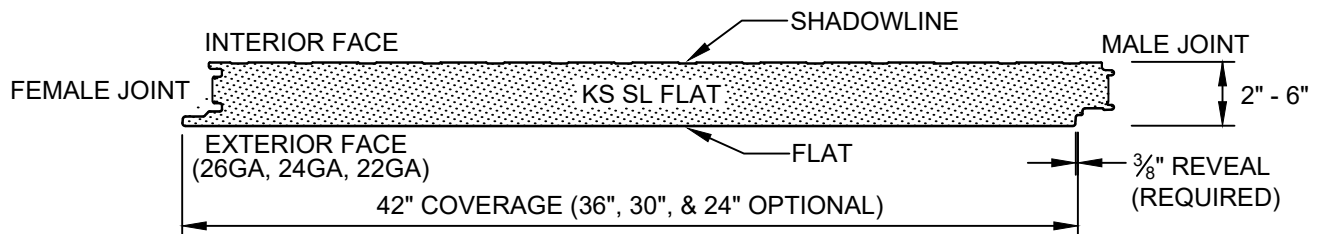
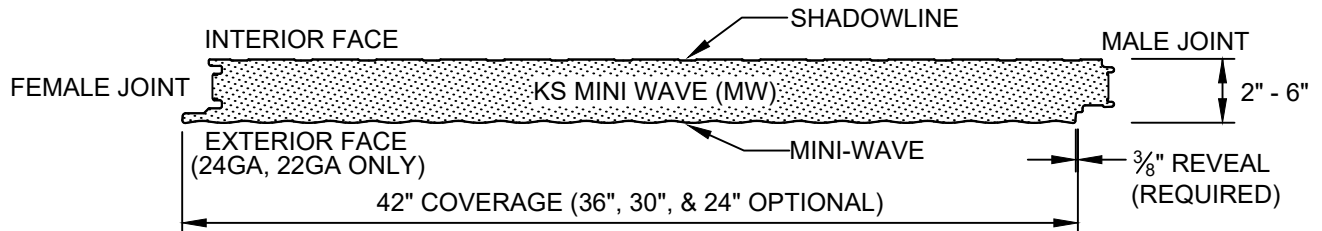

PANEL PROFILES

DETAIL #: KPV-PP-02-MTLH

DATE: 2019 REV1



[www.kingspanpanels.us](http://www.kingspanpanels.us)  
[www.kingspanpanels.ca](http://www.kingspanpanels.ca)

# VERTICAL KARRIER™ PANEL - HORIZONTAL METAL FACADE

NOTE:  
FOR PROJECTS REQUIRING NFPA 285:  
INTERIOR SIDE OF FRAMING MUST  
HAVE  $\frac{5}{8}$ " THICK FIRE BLOCK TYPE X  
GYPSUM BOARD (NOT BY KINGSPAN)

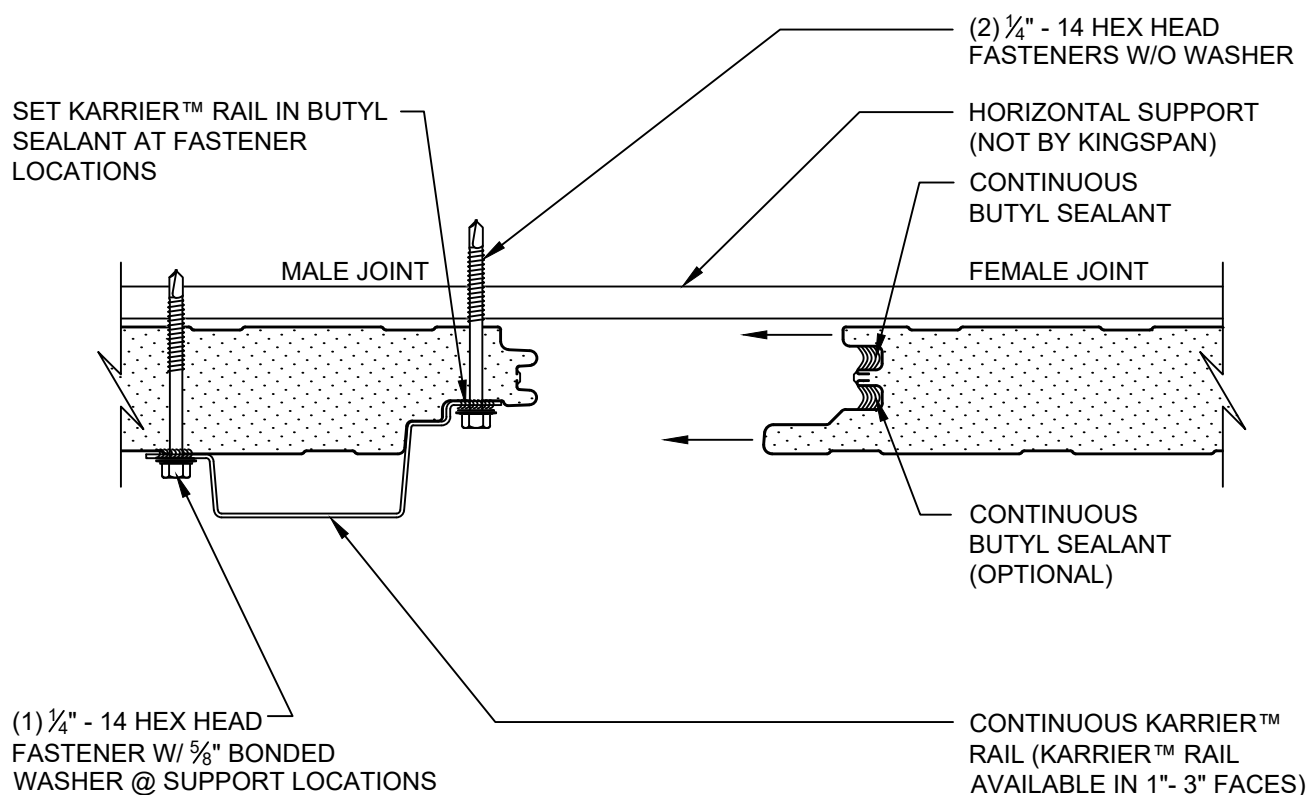

EXPANDED PANEL  
JOINT

DETAIL #: KPV-PJ-01-MTLH

DATE: 2019 REV1



[www.kingspanpanels.us](http://www.kingspanpanels.us)  
[www.kingspanpanels.ca](http://www.kingspanpanels.ca)

# VERTICAL KARRIER™ PANEL - HORIZONTAL METAL FACADE

NOTE:  
FOR PROJECTS REQUIRING NFPA 285:  
INTERIOR SIDE OF FRAMING MUST  
HAVE  $\frac{5}{8}$ " THICK FIRE BLOCK TYPE X  
GYPSUM BOARD (NOT BY KINGSPAN)

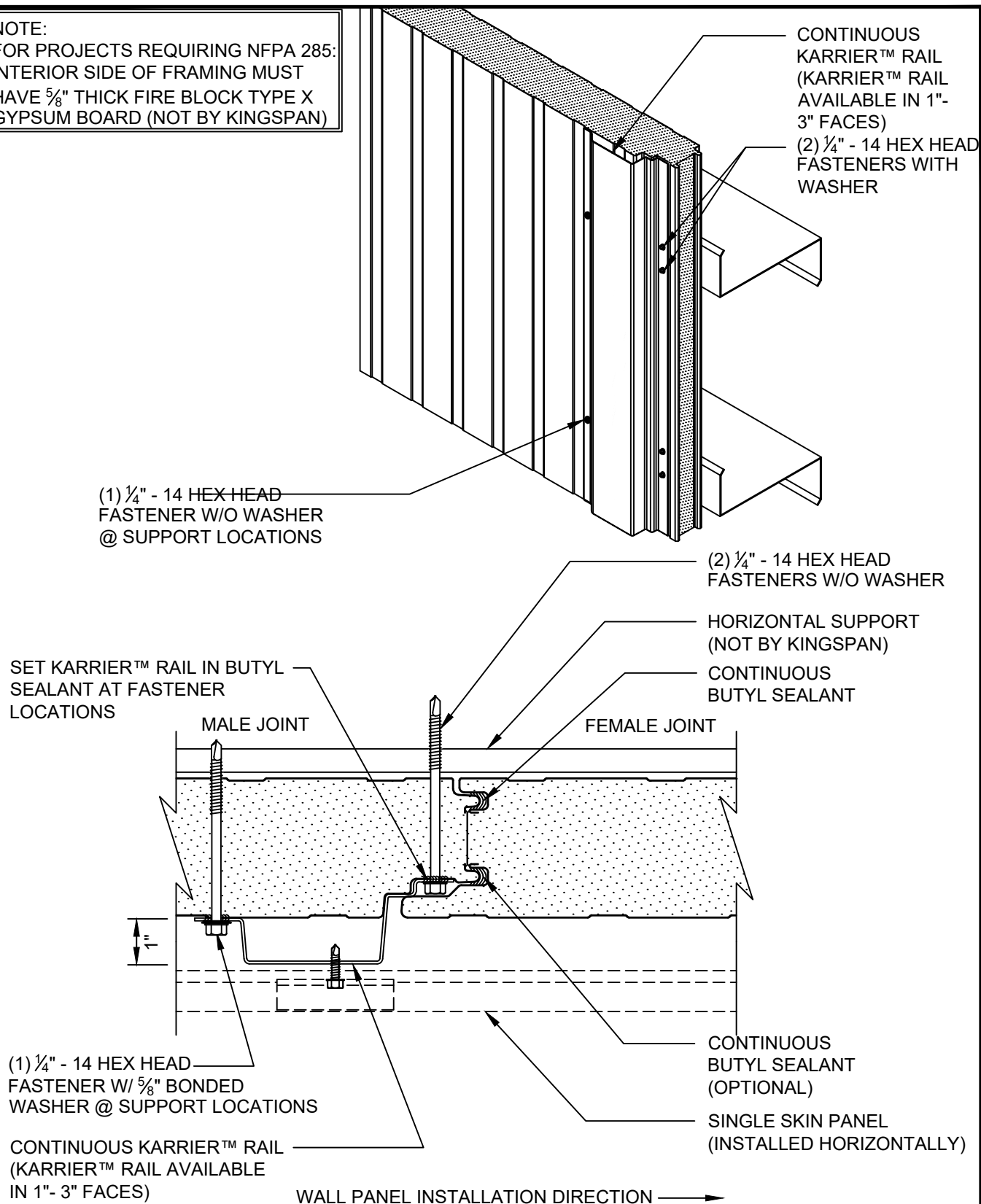

ENGAGED PANEL  
JOINT

DETAIL #: KPV-PJ-02-MTLH

DATE: 2019 REV1



www.kingspanpanels.us  
www.kingspanpanels.ca

# VERTICAL KARRIER™ PANEL - HORIZONTAL METAL FACADE

NOTE:  
FOR PROJECTS REQUIRING NFPA 285:  
INTERIOR SIDE OF FRAMING MUST  
HAVE  $\frac{5}{8}$ " THICK FIRE BLOCK TYPE X  
GYPSUM BOARD (NOT BY KINGSPAN)

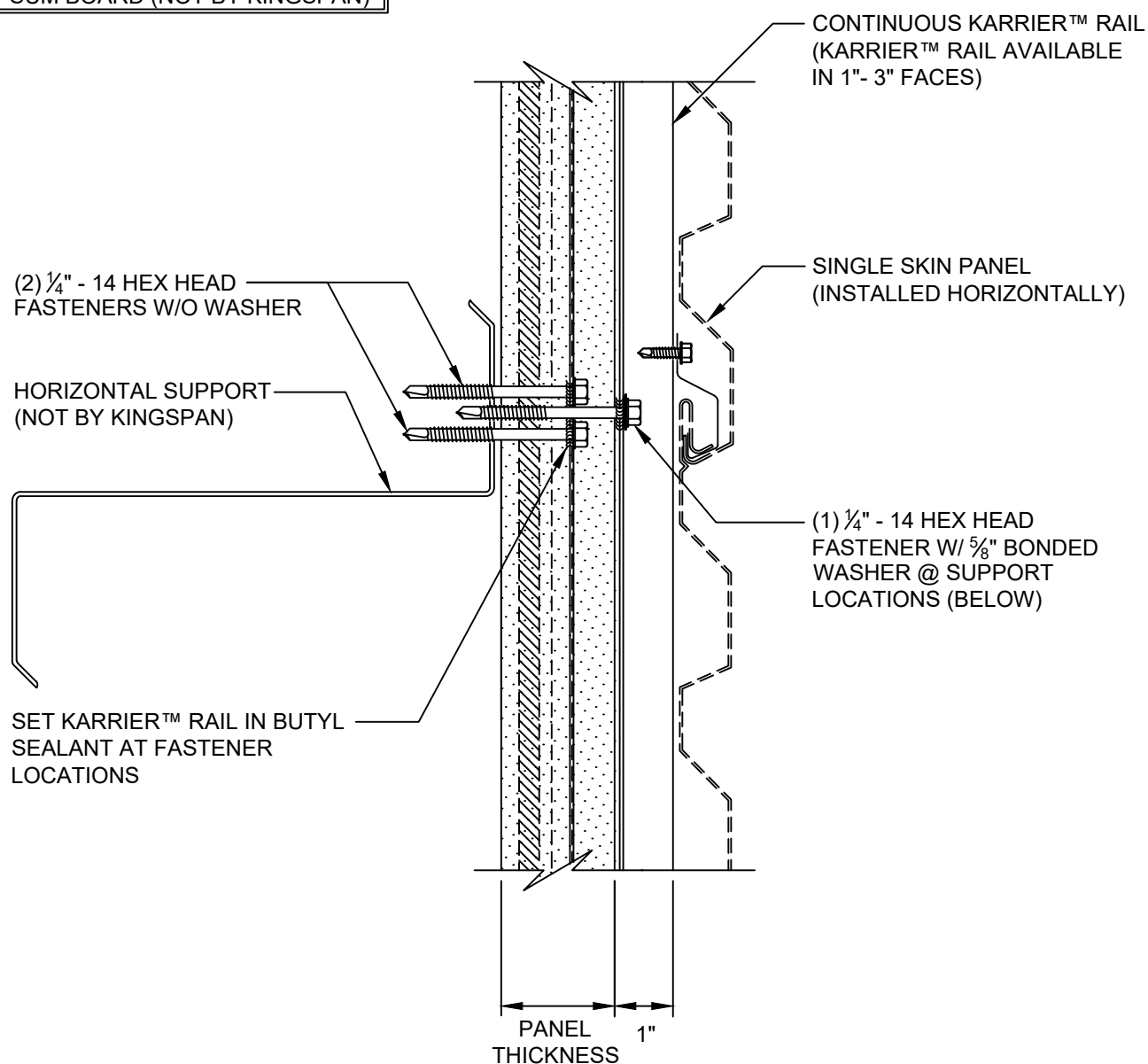

NOTE:  
CONTACT KINGSPAN TECHNICAL SERVICES FOR SPECIFIC PROJECT RECOMMENDATIONS

INTERMEDIATE  
SUPPORT

DETAIL #: KPV-PJ-03-MTLH

DATE: 2019 REV1



www.kingspanpanels.us  
www.kingspanpanels.ca

# VERTICAL KARRIER™ PANEL - HORIZONTAL METAL FACADE

NOTE:  
FOR PROJECTS REQUIRING NFPA 285:  
INTERIOR SIDE OF FRAMING MUST  
HAVE  $\frac{5}{8}$ " THICK FIRE BLOCK TYPE X  
GYPSUM BOARD (NOT BY KINGSPAN)

FLOOR SLAB, FRAMING  
AND OTHER MATERIALS  
(NOT BY KINGSPAN)

KARRIER PANEL  
INSTALLED  
VERTICALLY

FACADE PANEL  
(INSTALLED  
HORIZONTALLY)

F.F.

8" MIN

COMPLETELY FILL VOID BETWEEN  
INSULATED METAL PANEL SYSTEM  
AND FACADE WITH MIN 4PSI  
CONTINUOUS FIRE BLOCKING AT  
EACH FLOOR LINE  
(NOT BY KINGSPAN)

INSULATION WASHER  
AND FASTENERS @  
12" O.C.  
(NOT BY KINGSPAN)

NOTE:  
FASTENING AND OTHER MATERIALS  
NOT SHOWN FOR CLARITY OF  
DETAIL

VOID

MULTI-STORY FIRE  
STOPPING DETAIL

DETAIL #: KPV-FS-01-MTLH

DATE: 2019 REV1

  
**Kingspan**  
Insulated Panels

[www.kingspanpanels.us](http://www.kingspanpanels.us)  
[www.kingspanpanels.ca](http://www.kingspanpanels.ca)



# VERTICAL KARRIER™ PANEL - HORIZONTAL METAL FACADE

NOTE:  
FOR PROJECTS REQUIRING NFPA 285:  
INTERIOR SIDE OF FRAMING MUST  
HAVE  $\frac{5}{8}$ " THICK FIRE BLOCK TYPE X  
GYPSUM BOARD (NOT BY KINGSPAN)

NOTE:  
FASTENING AND OTHER MATERIALS  
NOT SHOWN FOR CLARITY OF  
DETAIL

FLOOR SLAB, FRAMING  
AND OTHER MATERIALS  
(NOT BY KINGSPAN)

COMPLETELY FILL VOID  
BETWEEN INSULATED  
METAL PANEL SYSTEM AND  
FACADE WITH MIN. 4 PSI  
CONTINUOUS FIRE  
BLOCKING AT EACH FLOOR  
LINE  
(NOT BY KINGSPAN)

INSULATION WASHER AND  
FASTENERS @ 12" O.C.  
(NOT BY KINGSPAN)

KARRIER PANEL AND RAIL  
INSTALLED VERTICALLY

FACADE PANEL  
(INSTALLED  
HORIZONTALLY)

MULTI-STORY FIRE  
STOPPING ASSEMBLY

DETAIL #: KPV-FS-02-MTLH

DATE: 2019 REV1



www.kingspanpanels.us  
www.kingspanpanels.ca

# VERTICAL KARRIER™ PANEL - HORIZONTAL METAL FACADE

NOTE:  
FOR PROJECTS REQUIRING NFPA 285:  
INTERIOR SIDE OF FRAMING MUST  
HAVE  $\frac{5}{8}$ " THICK FIRE BLOCK TYPE X  
GYPSUM BOARD (NOT BY KINGSPAN)

CONTINUOUS KARRIER™ RAIL  
(KARRIER™ RAIL AVAILABLE  
IN 1"- 3" FACES)

SINGLE SKIN PANEL  
(INSTALLED  
HORIZONTALLY)

(1)  $\frac{1}{4}$ " - 14 HEX HEAD  
FASTENER W/  $\frac{5}{8}$ " BONDED  
WASHER @ SUPPORT  
LOCATIONS  
(BEYOND)

SINGLE SKIN PANEL  
CONTINUOUS STARTER/  
FLASHING

SINGLE SKIN PANEL  
BASE FLASHING

CONTINUOUS BUTYL SEALANT  
BELOW BASE FLASHING

SET KARRIER™ RAIL IN BUTYL  
SEALANT AT FASTENER  
LOCATIONS

(2)  $\frac{1}{4}$ " - 14 HEX HEAD FASTENERS  
W/O WASHER

CONTINUOUS BUTYL  
SEALANT BOTH SIDES OF  
TRIM WITH MARRIAGE BEAD  
TO VERTICAL PANEL JOINT

FASTENER TO CONCRETE  
(NOT BY KINGSPAN)

BASE ANGLE W/ MINIMUM 3"  
VERT. LEG FOR PANEL  
ATTACHMENT SET IN SEALANT  
(NOT BY KINGSPAN)

BASE DETAIL  
FLUSH

DETAIL #: KPH-BS-01-MTLV

DATE: 2019 REV1



www.kingspanpanels.us  
www.kingspanpanels.ca

# VERTICAL KARRIER™ PANEL - HORIZONTAL METAL FACADE

**NOTE:**

FOR PROJECTS REQUIRING NFPA 285:  
INTERIOR SIDE OF FRAMING MUST  
HAVE  $\frac{5}{8}$ " THICK FIRE BLOCK TYPE X  
GYPSUM BOARD (NOT BY KINGSPAN)

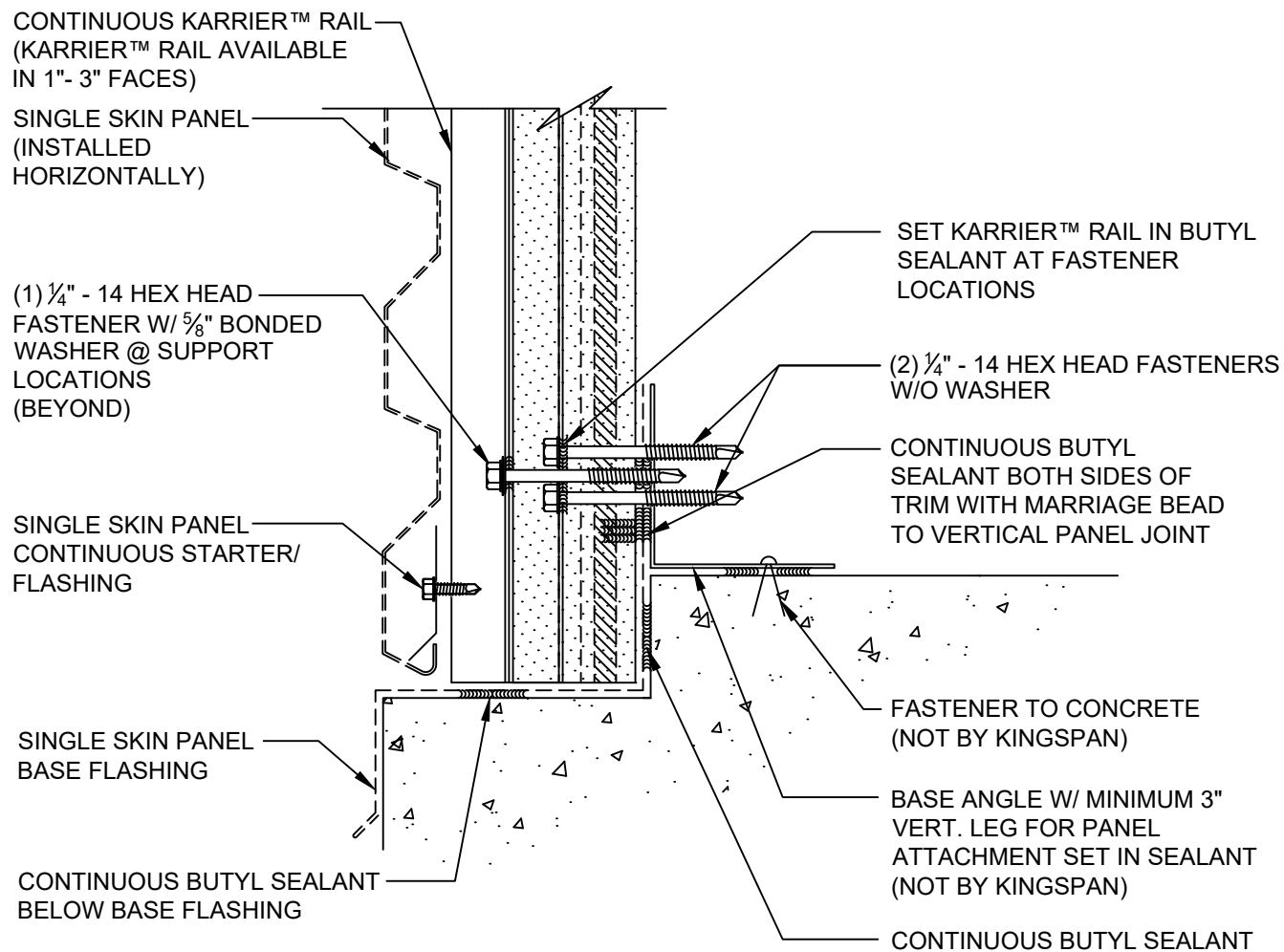

**BASE AT NOTCHED  
CONCRETE**

DETAIL #: KPV-BS-02-MTLH

DATE: 2019 REV1



[www.kingspanpanels.us](http://www.kingspanpanels.us)  
[www.kingspanpanels.ca](http://www.kingspanpanels.ca)

# VERTICAL KARRIER™ PANEL - HORIZONTAL METAL FACADE

NOTE:  
FOR PROJECTS REQUIRING NFPA 285:  
INTERIOR SIDE OF FRAMING MUST  
HAVE 5/8" THICK FIRE BLOCK TYPE X  
GYPSUM BOARD (NOT BY KINGSPAN)

CONTINUOUS KARRIER™ RAIL  
(KARRIER™ RAIL AVAILABLE  
IN 1"- 3" FACES)

SINGLE SKIN PANEL  
(INSTALLED  
HORIZONTALLY)

(1) 1/4" - 14 HEX HEAD  
FASTENER W/ 5/8" BONDED  
WASHER @ SUPPORT  
LOCATIONS  
(BEYOND)

SINGLE SKIN PANEL  
CONTINUOUS STARTER/  
FLASHING

SINGLE SKIN PANEL  
BASE FLASHING

SET KARRIER™ RAIL IN BUTYL  
SEALANT AT FASTENER  
LOCATIONS

(2) 1/4" - 14 HEX HEAD FASTENERS  
W/O WASHER

CONTINUOUS BUTYL  
SEALANT BOTH SIDES OF  
TRIM WITH MARRIAGE BEAD  
TO VERTICAL PANEL JOINT

FASTENER TO CONCRETE  
(NOT BY KINGSPAN)

BASE ANGLE W/ MINIMUM 3"  
VERT. LEG FOR PANEL  
ATTACHMENT SET IN SEALANT  
(NOT BY KINGSPAN)

CONTINUOUS BUTYL SEALANT

BASE AT OVERHANG

DETAIL #: KPV-BS-03-MTLH

DATE: 2019 REV1



[www.kingspanpanels.us](http://www.kingspanpanels.us)  
[www.kingspanpanels.ca](http://www.kingspanpanels.ca)

# VERTICAL KARRIER™ PANEL - HORIZONTAL METAL FACADE

NOTE:  
FOR PROJECTS REQUIRING NFPA 285:  
INTERIOR SIDE OF FRAMING MUST  
HAVE  $\frac{5}{8}$ " THICK FIRE BLOCK TYPE X  
GYPSUM BOARD (NOT BY KINGSPAN)

CONTINUOUS KARRIER™ RAIL  
(KARRIER™ RAIL AVAILABLE  
IN 1"-3" FACES)

SINGLE SKIN PANEL  
(INSTALLED  
HORIZONTALLY)

(1)  $\frac{1}{4}$ " - 14 HEX HEAD  
FASTENER W/O WASHER  
@ SUPPORT LOCATIONS  
(BEYOND)

SINGLE SKIN PANEL  
CONTINUOUS STARTER/  
FLASHING

SINGLE SKIN PANEL  
BASE FLASHING

SET KARRIER™ RAIL IN BUTYL  
SEALANT AT FASTENER  
LOCATIONS

(2)  $\frac{1}{4}$ " - 14 HEX HEAD FASTENERS  
W/O WASHER

CONTINUOUS BUTYL  
SEALANT BOTH SIDES OF  
TRIM WITH MARRIAGE BEAD  
TO VERTICAL PANEL JOINT

FASTENER TO CONCRETE  
(NOT BY KINGSPAN)

BASE ANGLE W/ MINIMUM 3"  
VERT. LEG FOR PANEL  
ATTACHMENT SET IN SEALANT  
(NOT BY KINGSPAN)

CONTINUOUS BUTYL SEALANT  
BELOW BASE FLASHING

BASE AT OVERHANG

DETAIL #: KPV-BS-04-MTLH

DATE: 2019 REV1



[www.kingspanpanels.us](http://www.kingspanpanels.us)  
[www.kingspanpanels.ca](http://www.kingspanpanels.ca)

# VERTICAL KARRIER™ PANEL - HORIZONTAL METAL FACADE

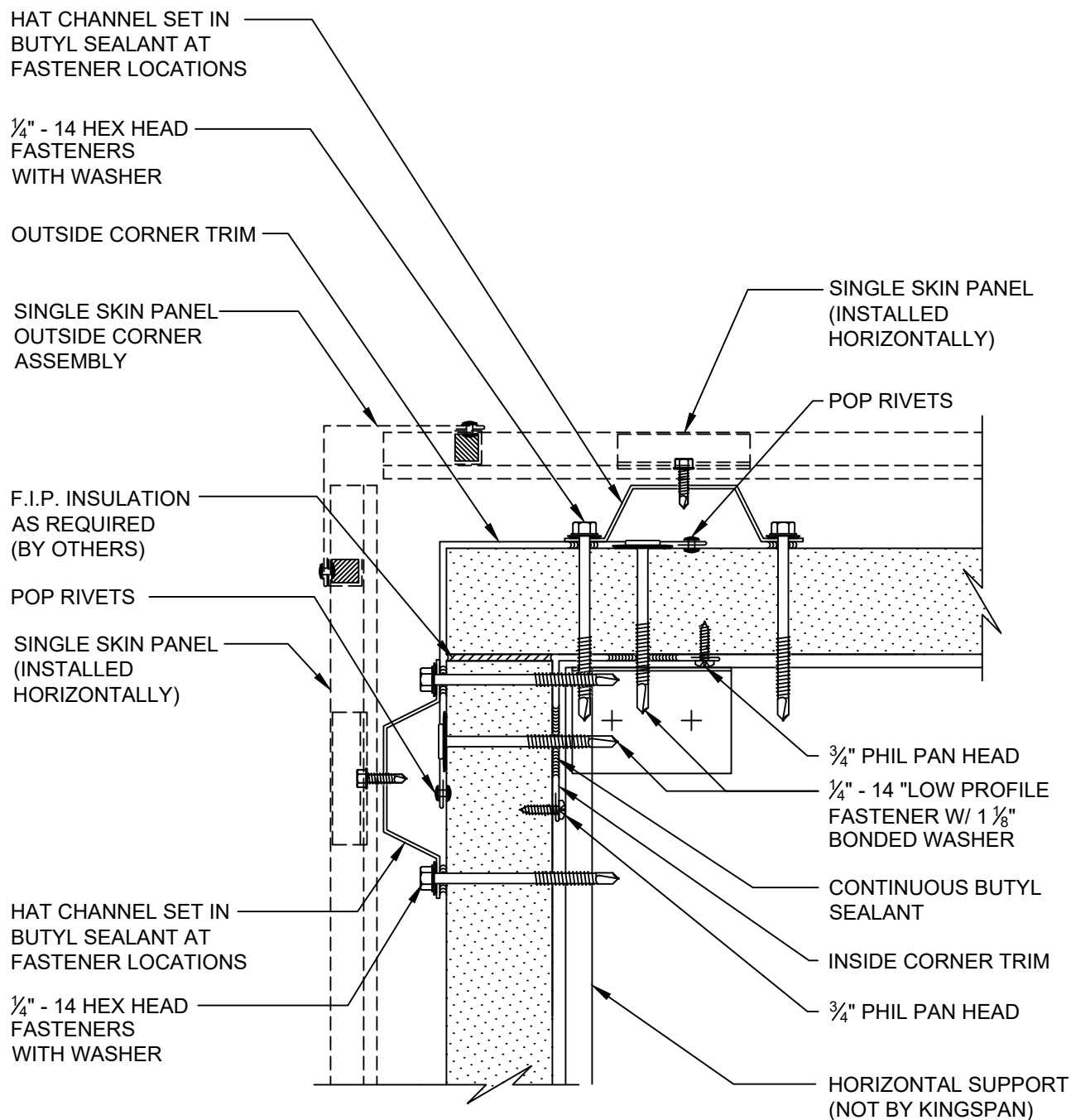

NOTE:  
FOR PROJECTS REQUIRING NFPA 285:  
INTERIOR SIDE OF FRAMING MUST  
HAVE 5/8" THICK FIRE BLOCK TYPE X  
GYPSUM BOARD (NOT BY KINGSPAN)

OUTSIDE CORNER

DETAIL #: KPV-OC-01-MTLH

DATE: 2019 REV1



www.kingspanpanels.us  
www.kingspanpanels.ca

# VERTICAL KARRIER™ PANEL - HORIZONTAL METAL FACADE

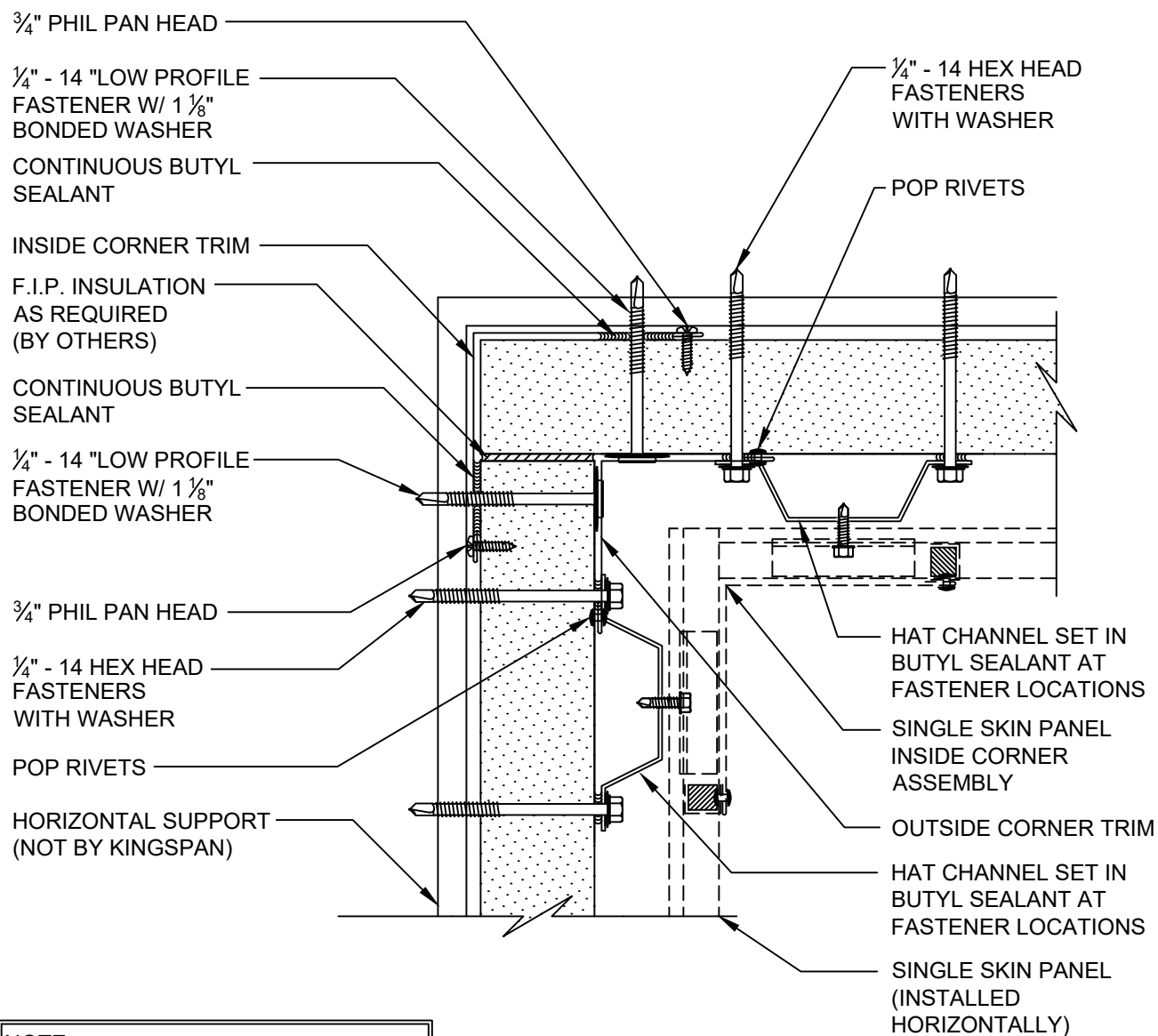

NOTE:  
FOR PROJECTS REQUIRING NFPA 285:  
INTERIOR SIDE OF FRAMING MUST  
HAVE 5/8" THICK FIRE BLOCK TYPE X  
GYPSUM BOARD (NOT BY KINGSPAN)

INSIDE CORNER

DETAIL #: KPV-IC-01-MTLH

DATE: 2019 REV1



[www.kingspanpanels.us](http://www.kingspanpanels.us)  
[www.kingspanpanels.ca](http://www.kingspanpanels.ca)

# VERTICAL KARRIER™ PANEL - HORIZONTAL METAL FACADE

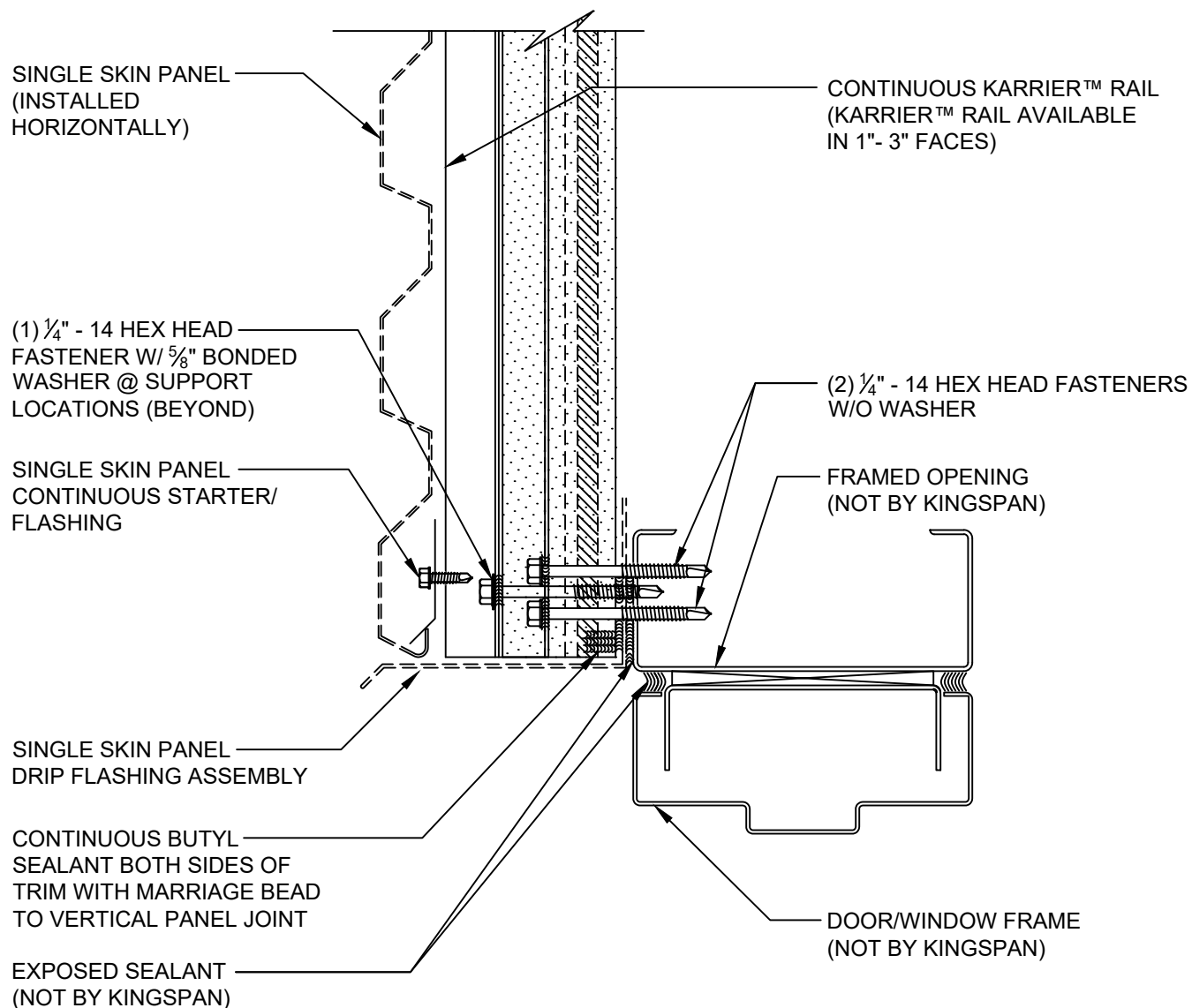

NOTE:  
FOR PROJECTS REQUIRING NFPA 285:  
INTERIOR SIDE OF FRAMING MUST  
HAVE 5/8" THICK FIRE BLOCK TYPE X  
GYPSUM BOARD (NOT BY KINGSPAN)

## FRAMED OPENING HEAD

DETAIL #: KPV-FO-01-MTLH

DATE: 2019 REV1



[www.kingspanpanels.us](http://www.kingspanpanels.us)  
[www.kingspanpanels.ca](http://www.kingspanpanels.ca)



# VERTICAL KARRIER™ PANEL - HORIZONTAL METAL FACADE

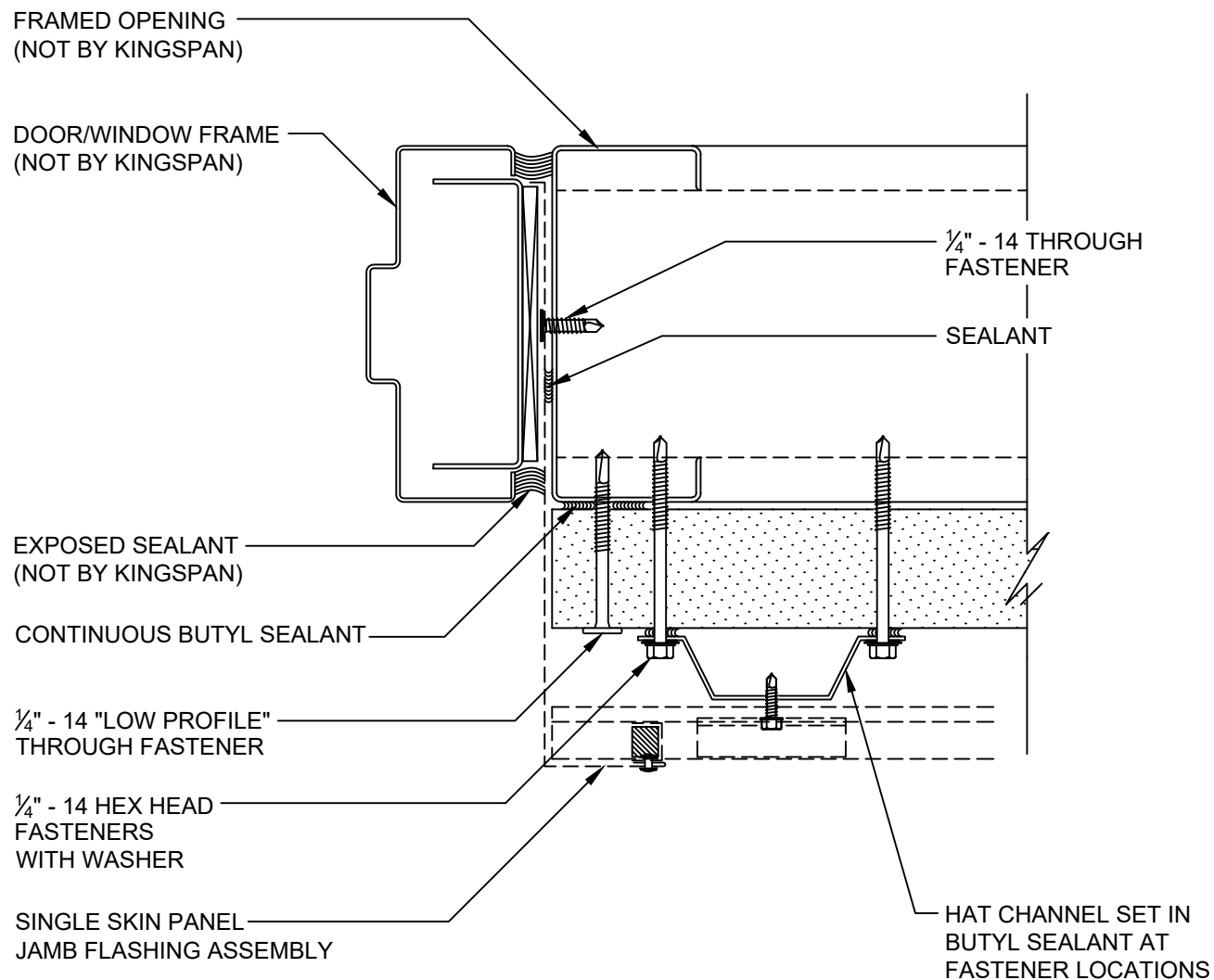

NOTE:  
FOR PROJECTS REQUIRING NFPA 285:  
INTERIOR SIDE OF FRAMING MUST  
HAVE 5/8" THICK FIRE BLOCK TYPE X  
GYPSUM BOARD (NOT BY KINGSPAN)

FRAMED OPENING  
JAMB

DETAIL #: KPV-FO-02-MTLH

DATE: 2019 REV1



www.kingspanpanels.us  
www.kingspanpanels.ca

# VERTICAL KARRIER™ PANEL - HORIZONTAL METAL FACADE

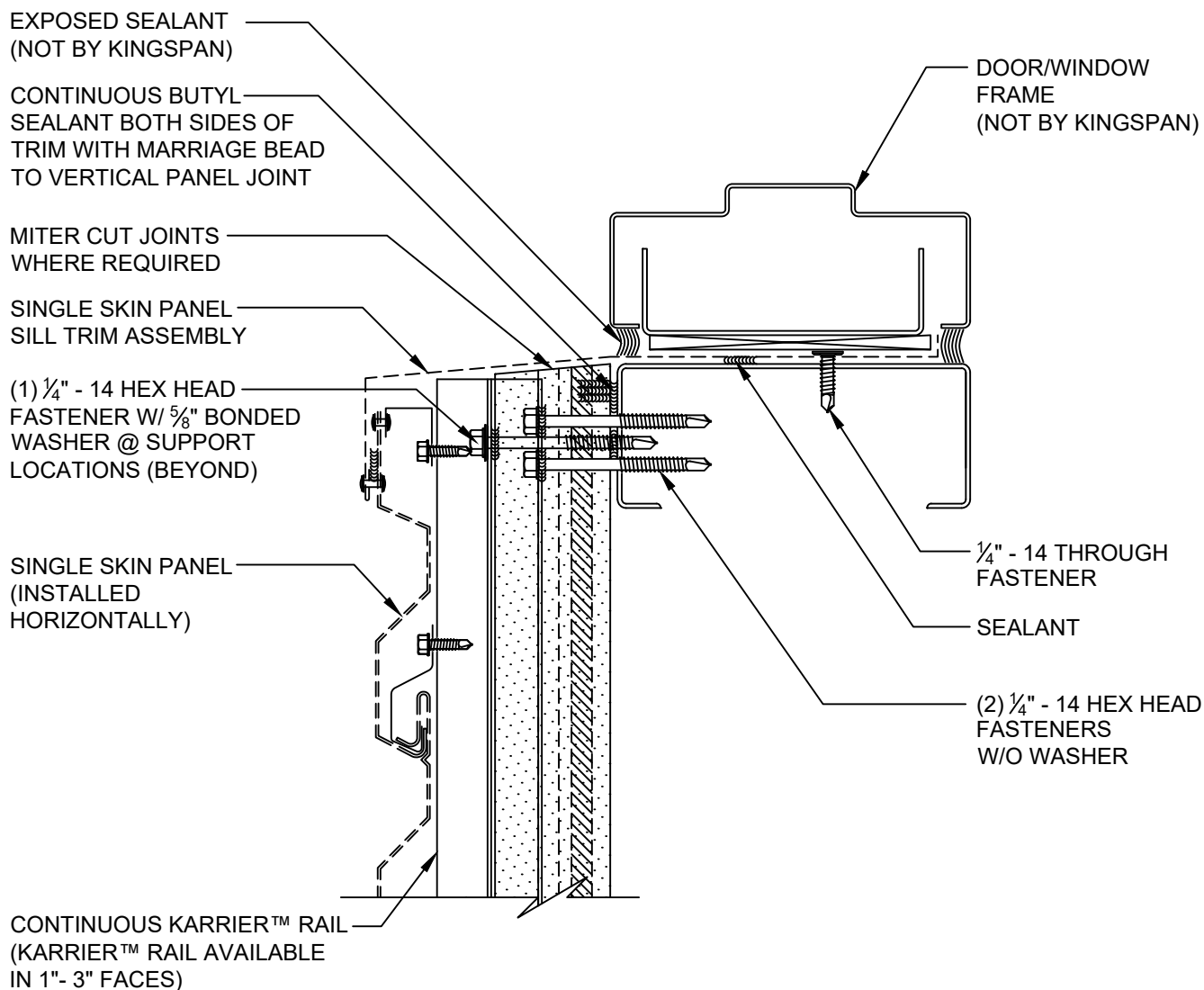

NOTE:  
FOR PROJECTS REQUIRING NFPA 285:  
INTERIOR SIDE OF FRAMING MUST  
HAVE 5/8" THICK FIRE BLOCK TYPE X  
GYPSUM BOARD (NOT BY KINGSPAN)

FRAMED OPENING SILL

DETAIL #: KPV-FO-03-MTLH

DATE: 2019 REV1



[www.kingspanpanels.us](http://www.kingspanpanels.us)  
[www.kingspanpanels.ca](http://www.kingspanpanels.ca)

# VERTICAL KARRIER™ PANEL - HORIZONTAL METAL FACADE

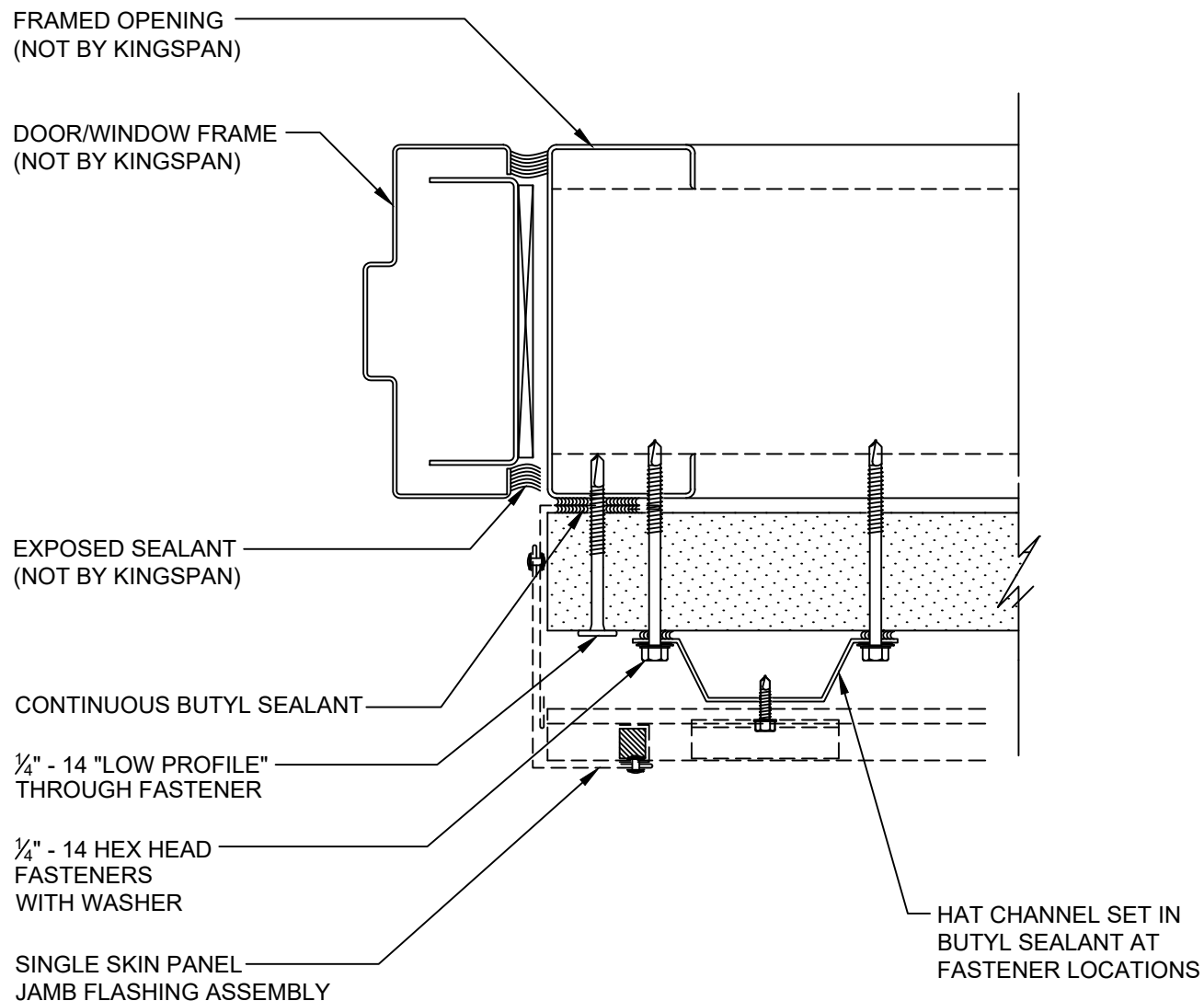

NOTE:  
FOR PROJECTS REQUIRING NFPA 285:  
INTERIOR SIDE OF FRAMING MUST  
HAVE 5/8" THICK FIRE BLOCK TYPE X  
GYPSUM BOARD (NOT BY KINGSPAN)

**FRAMED OPENING  
JAMB**

DETAIL #: KPV-FO-04-MTLH

DATE: 2019 REV1



[www.kingspanpanels.us](http://www.kingspanpanels.us)  
[www.kingspanpanels.ca](http://www.kingspanpanels.ca)

# VERTICAL KARRIER™ PANEL - HORIZONTAL METAL FACADE

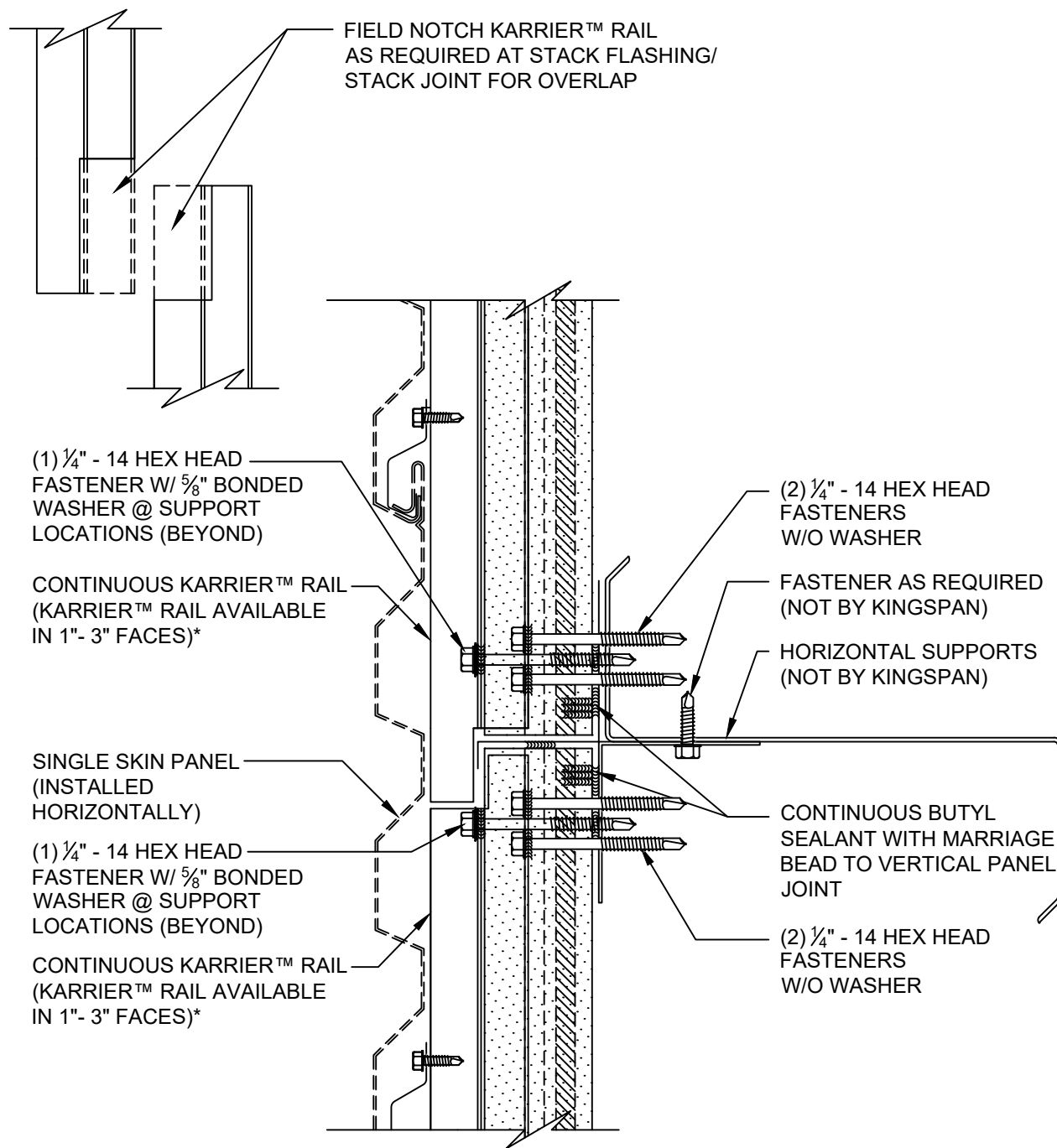

\*NOTE: FIELD NOTCH KARRIER™ RAIL AS REQUIRED\*

NOTE:  
FOR PROJECTS REQUIRING NFPA 285:  
INTERIOR SIDE OF FRAMING MUST  
HAVE 5/8" THICK FIRE BLOCK TYPE X  
GYPSUM BOARD (NOT BY KINGSPAN)

STACK JOINT

DETAIL #: KPV-SJ-01-MTLH

DATE: 2019 REV1

**Kingspan**  
Insulated Panels

[www.kingspanpanels.us](http://www.kingspanpanels.us)  
[www.kingspanpanels.ca](http://www.kingspanpanels.ca)

# VERTICAL KARRIER™ PANEL - HORIZONTAL METAL FACADE

## NOTE:

FOR PROJECTS REQUIRING NFPA 285:  
INTERIOR SIDE OF FRAMING MUST  
HAVE  $\frac{5}{8}$ " THICK FIRE BLOCK TYPE X  
GYPSUM BOARD (NOT BY KINGSPAN)

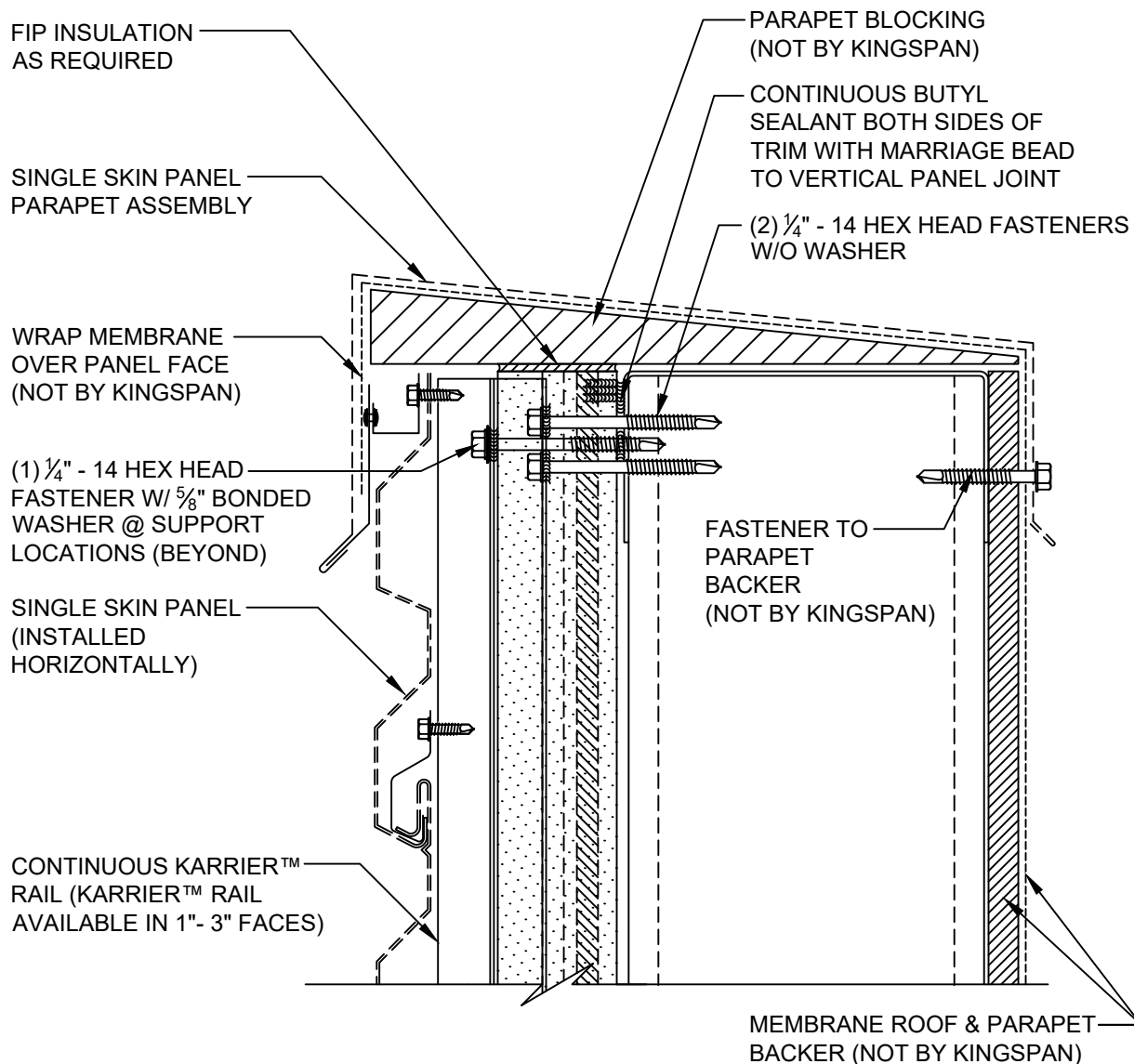

## PARAPET DETAIL

DETAIL #: KPV-PR-01-MTLH

DATE: 2019 REV1



[www.kingspanpanels.us](http://www.kingspanpanels.us)  
[www.kingspanpanels.ca](http://www.kingspanpanels.ca)

# VERTICAL KARRIER™ PANEL - HORIZONTAL METAL FACADE

NOTE:  
FOR PROJECTS REQUIRING NFPA 285:  
INTERIOR SIDE OF FRAMING MUST  
HAVE  $\frac{5}{8}$ " THICK FIRE BLOCK TYPE X  
GYPSUM BOARD (NOT BY KINGSPAN)

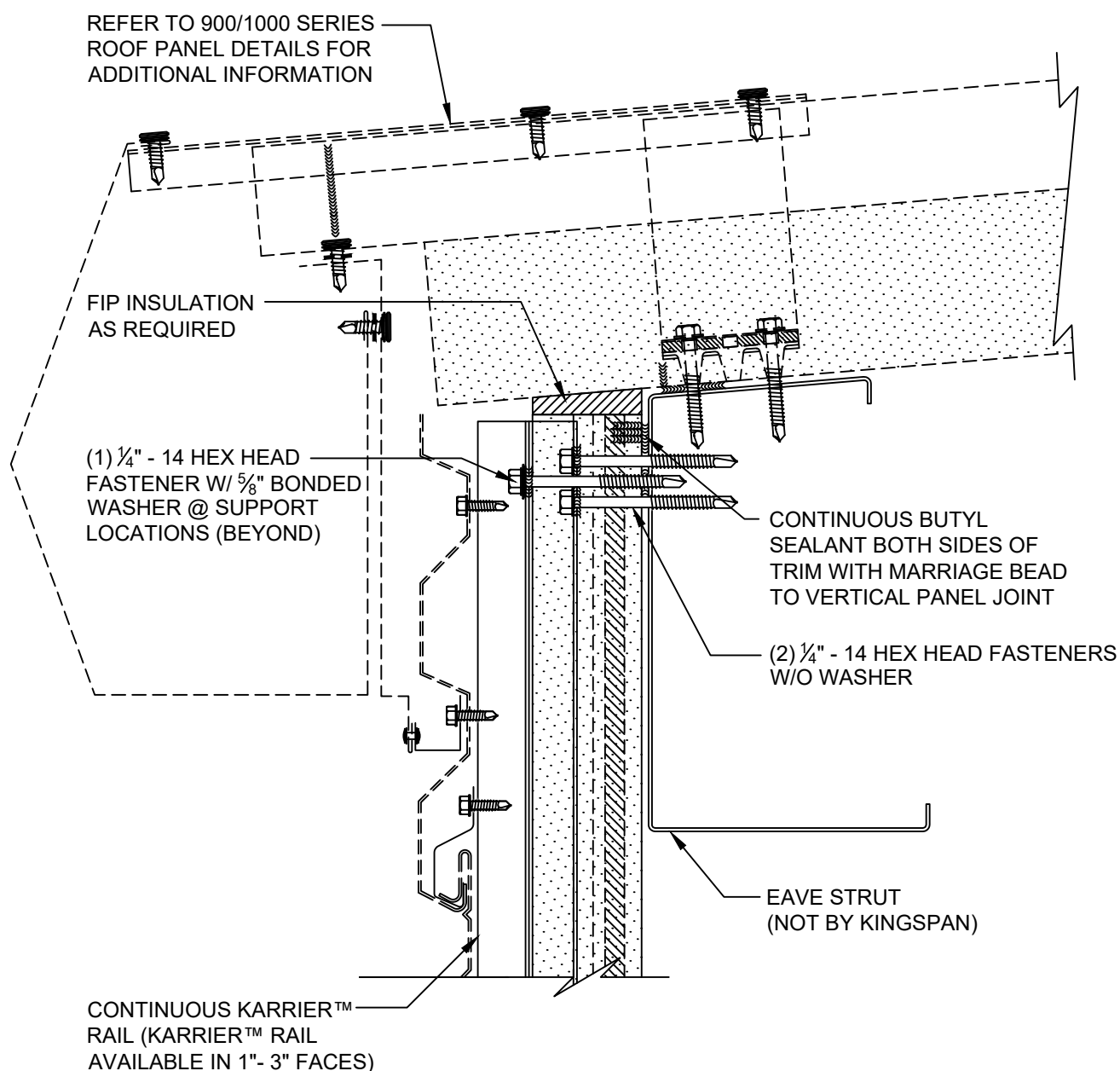

LOW EAVE DETAIL

DETAIL #: KPV-LE-01-MTLH

DATE: 2019 REV1



[www.kingspanpanels.us](http://www.kingspanpanels.us)  
[www.kingspanpanels.ca](http://www.kingspanpanels.ca)

# VERTICAL KARRIER™ PANEL - HORIZONTAL METAL FACADE

NOTE:  
FOR PROJECTS REQUIRING NFPA 285:  
INTERIOR SIDE OF FRAMING MUST  
HAVE  $\frac{5}{8}$ " THICK FIRE BLOCK TYPE X  
GYPSUM BOARD (NOT BY KINGSPAN)

REFER TO 900/1000 SERIES  
ROOF PANEL DETAILS FOR  
ADDITIONAL INFORMATION

RAKE ANGLE  
(NOT BY KINGSPAN)

FIP INSULATION  
AS REQUIRED

(1)  $\frac{1}{4}$ " - 14 HEX HEAD  
FASTENER W/  $\frac{5}{8}$ " BONDED  
WASHER @ SUPPORT  
LOCATIONS (BEYOND)

CONTINUOUS BUTYL  
SEALANT BOTH SIDES OF  
TRIM WITH MARRIAGE BEAD  
TO VERTICAL PANEL JOINT

(2)  $\frac{1}{4}$ " - 14 HEX HEAD  
FASTENERS  
W/O WASHER

RAKE ANGLE  
(NOT BY KINGSPAN)

CONTINUOUS KARRIER™  
RAIL (KARRIER™ RAIL  
AVAILABLE IN 1"- 3" FACES)

## RAKE DETAIL

DETAIL #: KPV-RD-01-MTLH

DATE: 2019 REV1

  
**Kingspan**  
Insulated Panels

[www.kingspanpanels.us](http://www.kingspanpanels.us)  
[www.kingspanpanels.ca](http://www.kingspanpanels.ca)

# VERTICAL KARRIER™ PANEL - HORIZONTAL METAL FACADE

NOTE:  
FOR PROJECTS REQUIRING NFPA 285:  
INTERIOR SIDE OF FRAMING MUST  
HAVE  $\frac{5}{8}$ " THICK FIRE BLOCK TYPE X  
GYPSUM BOARD (NOT BY KINGSPAN)

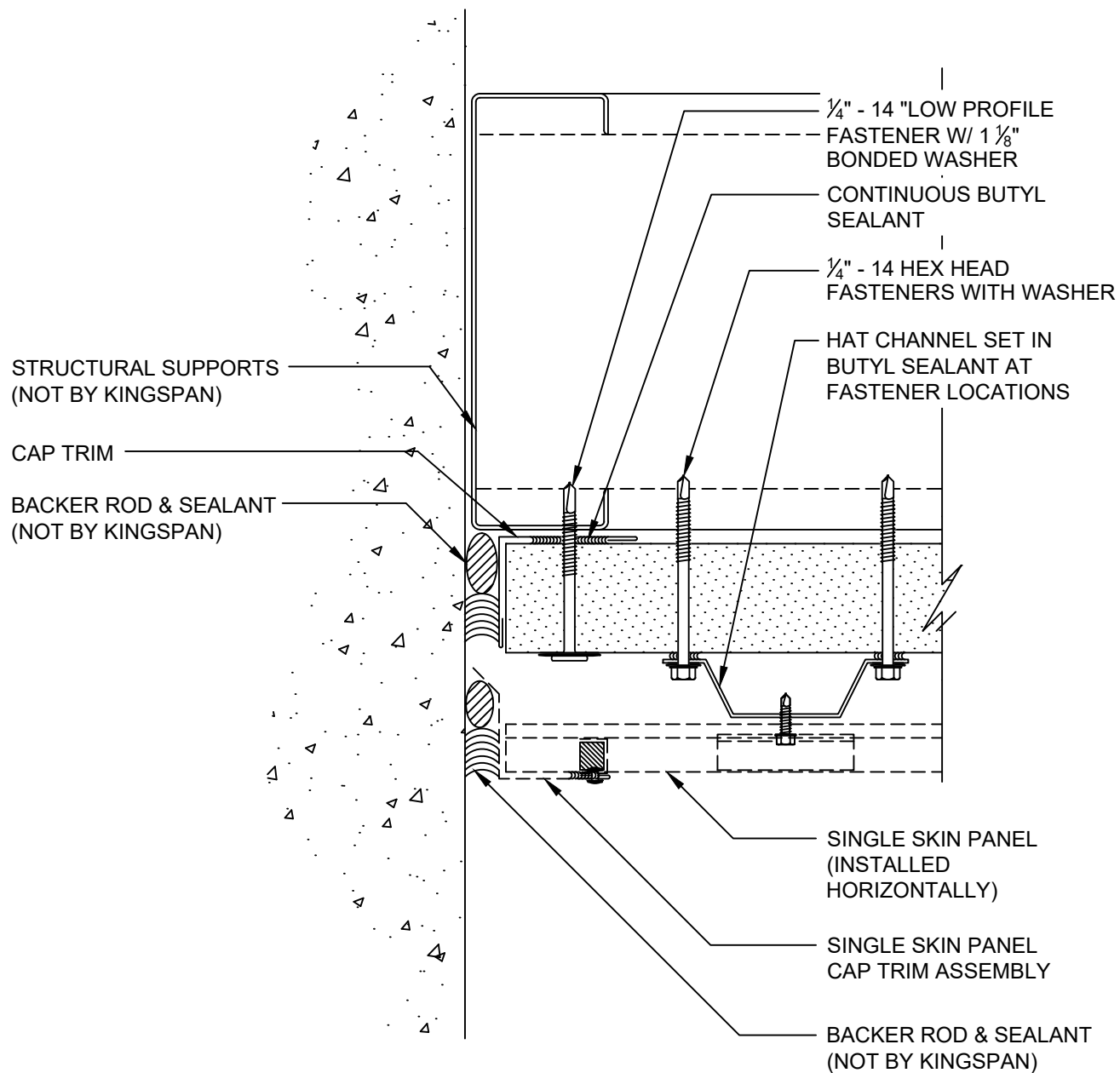

## PANEL TERMINATION

DETAIL #: KPV-TP-01-MTLH

DATE: 2019 REV1



[www.kingspanpanels.us](http://www.kingspanpanels.us)  
[www.kingspanpanels.ca](http://www.kingspanpanels.ca)



# VERTICAL KARRIER™ PANEL - HORIZONTAL METAL FACADE

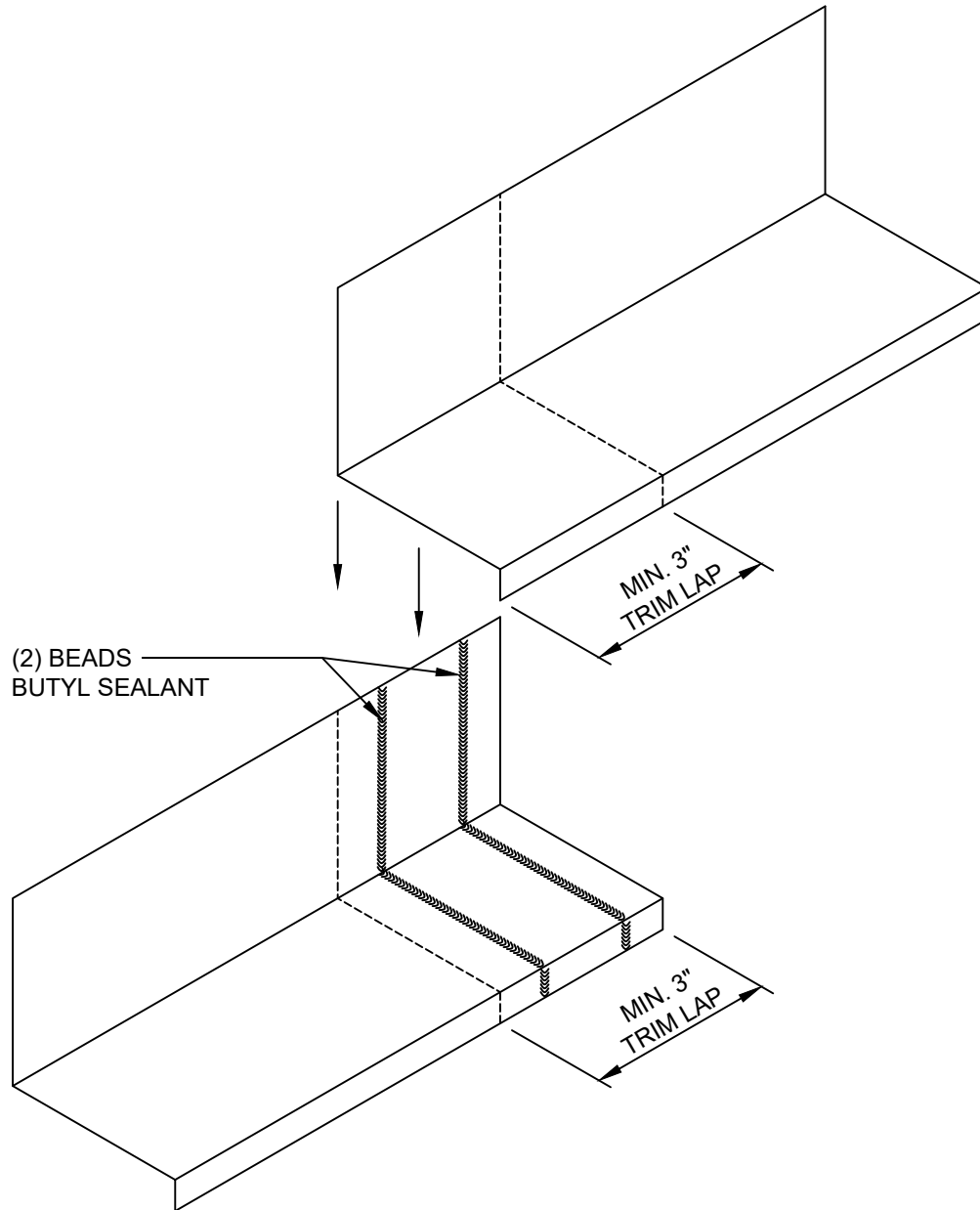

TRIM END LAP

DETAIL #: KPV-TL-01-MTLH

DATE: 2019 REV1

**Kingspan**  
Insulated Panels

[www.kingspanpanels.us](http://www.kingspanpanels.us)  
[www.kingspanpanels.ca](http://www.kingspanpanels.ca)

# VERTICAL KARRIER™ PANEL - HORIZONTAL METAL FACADE

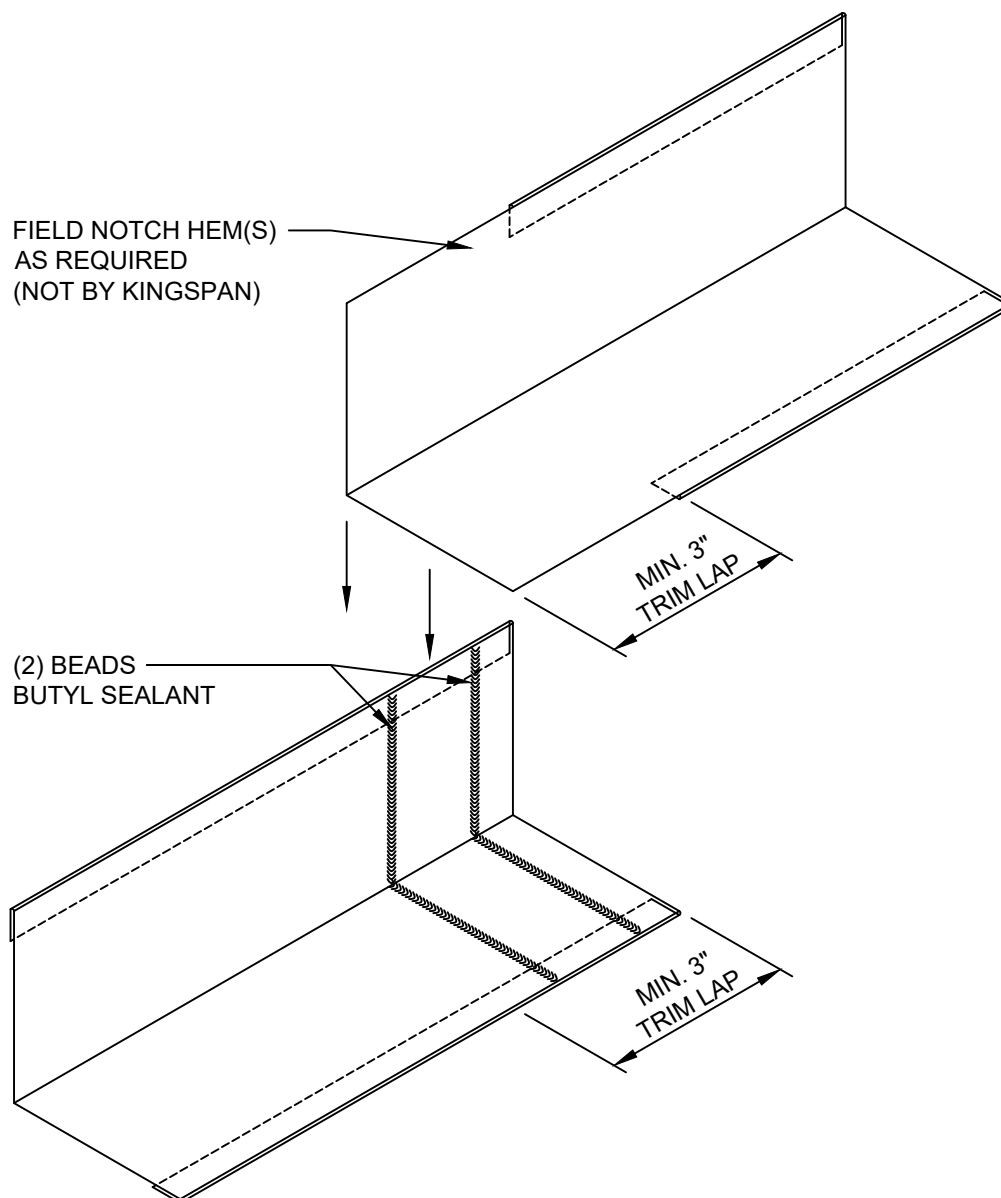

TRIM END LAP  
WITH HEMS

DETAIL #: KPV-TL-02-MTLH

DATE: 2019 REV1



[www.kingspanpanels.us](http://www.kingspanpanels.us)  
[www.kingspanpanels.ca](http://www.kingspanpanels.ca)