

KINGRIB HR-3 / HR-5 SERIES ROOF PANEL

REVISION

0	1/01/21
1	3/25/21
2	8/12/21
3	4/14/22

CI-DS-01-KINGRIB	C & I DISCLAIMER
CI-PJ-01-KINGRIB	PANEL JOINT
CI-PJ-02-KINGRIB	INTERMEDIATE SUPPORT
CI-EL-01-KINGRIB	ENDLAP
CI-EL-02-KINGRIB	ENDLAP CONDITIONS
CI-EL-03-KINGRIB	4-WAY INTERSECTION
CI-EL-04-KINGRIB	CONTINUOUS MALE LEG AT STAGGERED ENDLAP
CI-EL-05-KINGRIB	STAGGERED MALE LEG AT ENDLAP
CI-EL-06-KINGRIB	MALE LEG ENDLAP AT CONTINUOUS FEMALE
CI-EL-07-KINGRIB	ENDLAP INSTALLATION SEQUENCE
CI-EL-08-KINGRIB	STAGGERED ENDLAP ASSEMBLY
CI-RD-01-KINGRIB	RIDGE
CI-RD-02-KINGRIB	RIDGE ASSEMBLY
CI-RD-03-KINGRIB	RIDGE CLOSURE ASSEMBLY HR-3
CI-RD-04-KINGRIB	RIDGE CLOSURE ASSEMBLY HR-5
CI-RD-05-KINGRIB	RIDGE TRIM LAP
CI-EV-01-KINGRIB	LOW EAVE W/O GUTTER
CI-EV-02-KINGRIB	LOW EAVE W/ GUTTER
CI-EV-03-KINGRIB	HIGH EAVE
CI-RK-01-KINGRIB	RAKE
CI-VL-01-KINGRIB	VALLEY CONDITION
CI-VL-02-KINGRIB	VALLEY ASSEMBLY
CI-WR-01-KINGRIB	WALL TO ROOF HIGH EAVE
CI-WR-02-KINGRIB	CONCRETE WALL TO HIGH EAVE
CI-WR-03-KINGRIB	WALL TO RAKE
CI-WR-04-KINGRIB	CONCRETE WALL TO ROOF

SHEET INDEX

DETAIL #: XX-XX-XX-KINGRIB

RELEASE: 2022

REGION: NORTH AMERICA

www.kingspanpanels.com



KINGRIB HR-3 / HR-5 SERIES ROOF PANEL

DISCLAIMER:

THESE DETAILS ARE PROVIDED AS A GUIDELINE FOR PROPER PANEL AND ASSOCIATED COMPONENT INSTALLATION, AND ARE BASED ON INDUSTRY ACCEPTED PRACTICES.

LOCATION OF VAPOR BARRIERS AND ASSOCIATED SEALANTS IN THESE DETAILS ARE BASED ON TYPICAL DESIGN PRACTICES FOR MOST U.S. CLIMATIC ZONES. (THE PRIMARY VAPOR BARRIER IS PLACED ON THE "WARM" SIDE IN WINTER).

PROJECTS LOCATED IN SPECIFIC AREAS SUBJECT TO EXTREME COLD AND/OR HIGH SNOW LOADS MAY REQUIRE MODIFICATIONS TO THESE DETAILS - CONTACT KINGSPAN TECHNICAL SERVICES FOR SPECIFIC PROJECT RECOMMENDATIONS.

ALL STRUCTURAL SUPPORTS ARE NOT BY KINGSPAN AND ARE SHOWN FOR CLARIFICATION PURPOSES ONLY.

TO ENSURE YOU ARE VIEWING THE MOST RECENT AND ACCURATE PRODUCT INFORMATION, PLEASE VISIT WWW.KINGSPANPANELS.COM

CARE HAS BEEN TAKEN TO ENSURE THAT THE CONTENTS OF THIS PUBLICATION ARE ACCURATE, BUT KINGSPAN AND ITS SUBSIDIARY COMPANIES DO NOT ACCEPT RESPONSIBILITY FOR ERRORS OR FOR INFORMATION THAT IS FOUND TO BE MISLEADING. SUGGESTIONS FOR, OR DESCRIPTION OF, THE END USE OR APPLICATION OF PRODUCTS OR METHODS OF WORKING ARE FOR INFORMATION ONLY AND KINGSPAN LIMITED AND ITS SUBSIDIARIES ACCEPT NO LIABILITY IN RESPECT THEREOF.

REVISION	
REVISION #	DATE
3	04/14/22

COMMERCIAL/INDUSTRIAL
DISCLAIMER

DETAIL #: CI-DS-01-KINGRIB
RELEASE: 2022
REGION: NORTH AMERICA
www.kingspanpanels.com



KINGRIB HR-3 / HR-5 SERIES ROOF PANEL

CORE DEPTHS:
1.5" (NON-STANDARD)
2.5", 4", 5", 6"

MODULE WIDTH:
40"

EMBOSSING:
EXTERIOR: STUCCO / NON-EMBOSSSED
INTERIOR: STUCCO / NON-EMBOSSSED

STEEL GAUGES:
EXTERIOR: 26 (STANDARD)
22, 24 (OPTIONAL)
INTERIOR: 26 (STANDARD)
22, 24 (OPTIONAL)

PANEL ORIENTATION:
ROOF

LENGTHS:
MINIMUM: 8'-0"
MAXIMUM: 59'-0"
(MAXIMUM ALLOWABLE LENGTH
SUBJECT TO SOLAR LOAD TABLE)

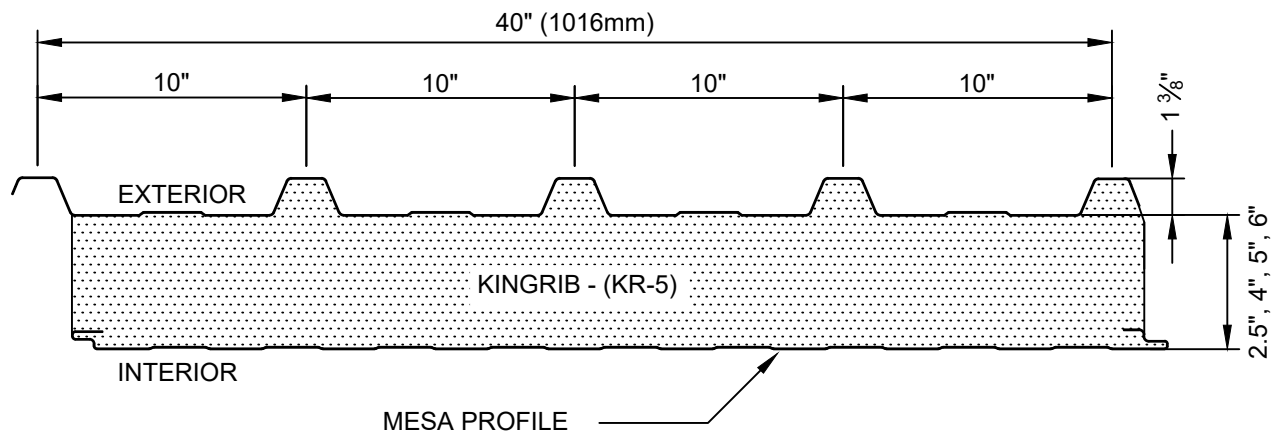
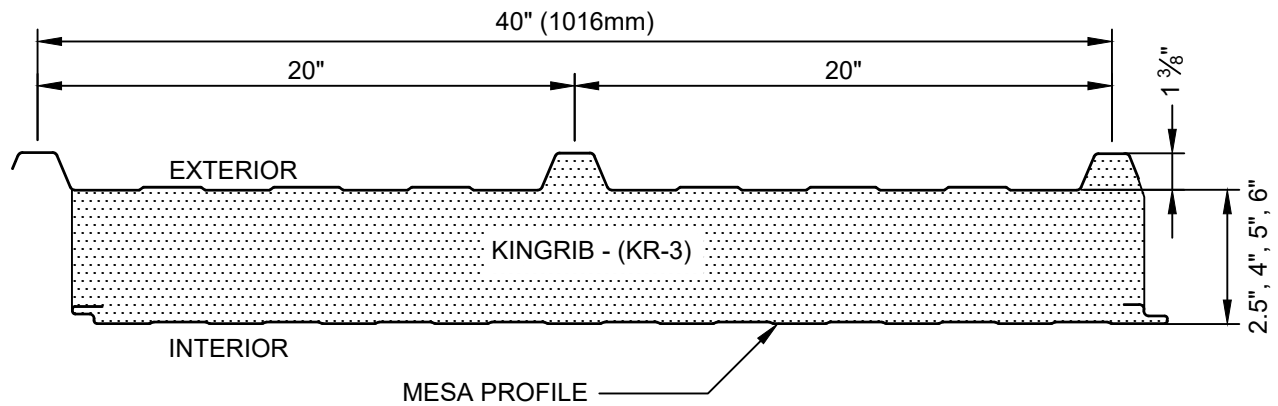

REVISION	
REVISION #	DATE
3	04/14/22

PANEL PROFILE

DETAIL #: CI-PP-01-KINGRIB
RELEASE: 2022
REGION: NORTH AMERICA
www.kingspanpanels.com



KINGRIB HR-3 / HR-5 SERIES ROOF PANEL

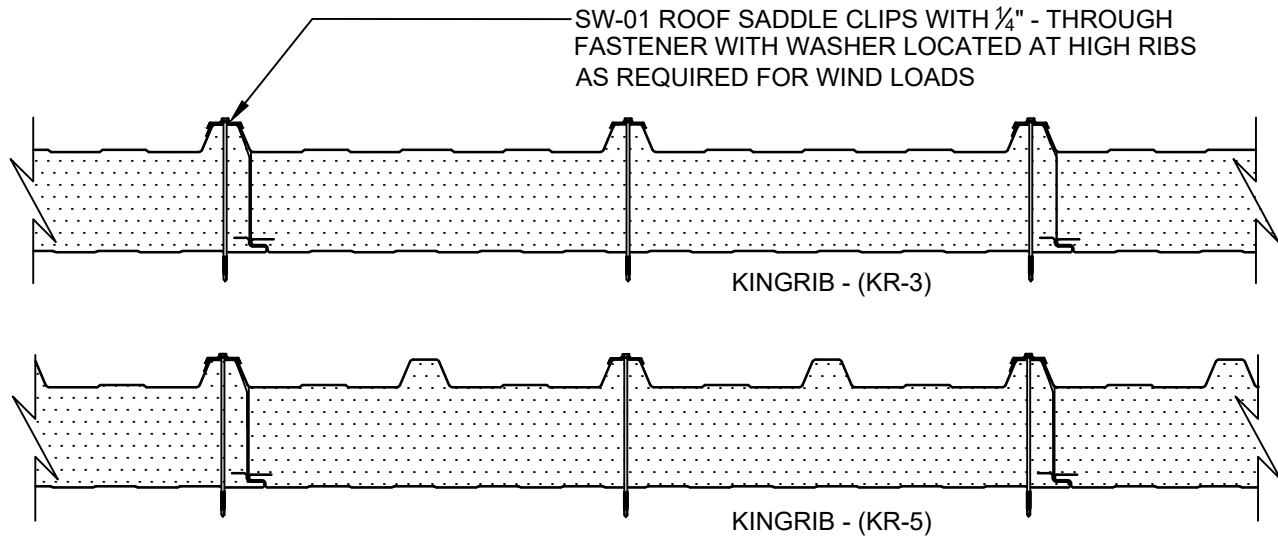

$\frac{1}{4}$ " - 14 X $\frac{7}{8}$ " STITCH TEK SCREWS
 * FOR SLOPES $\geq 1:12$ INSTALL AT 20" O.C. BETWEEN MAIN FASTENERS
 * FOR SLOPES $< 1:12$ INSTALL AT 12" O.C. BETWEEN MAIN FASTENERS

"SW-01" SADDLE WASHER W/ $\frac{1}{4}$ " Ø TEK FASTENER INTO SUPPORT MEMBER

1" x $\frac{3}{16}$ " BUTYL TAPE SEALANT ENTIRE LENGTH OF LAP JOINT

$\frac{1}{4}$ " - THROUGH FASTENERS WITH NEOPRENE WASHER

STAND ON THIS PANEL WHEN FASTENING

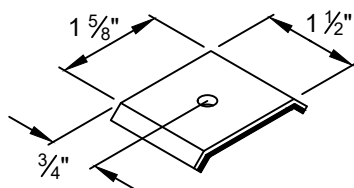

SW-01 SADDLE CLIP ISOMETRIC

DIRECTION OF INSTALLATION

CONTINUOUS BEAD OF FIELD APPLIED BUTYL SEALANT IN JOINT

$\frac{1}{4}$ " - THROUGH FASTENER WITH WASHER

REVISION	
REVISION #	DATE
0	01/01/21

PANEL JOINT

DETAIL #: CI-PJ-01-KINGRIB

RELEASE: 2022

REGION: NORTH AMERICA

www.kingspanpanels.com



KINGRIB HR-3 / HR-5 SERIES ROOF PANEL

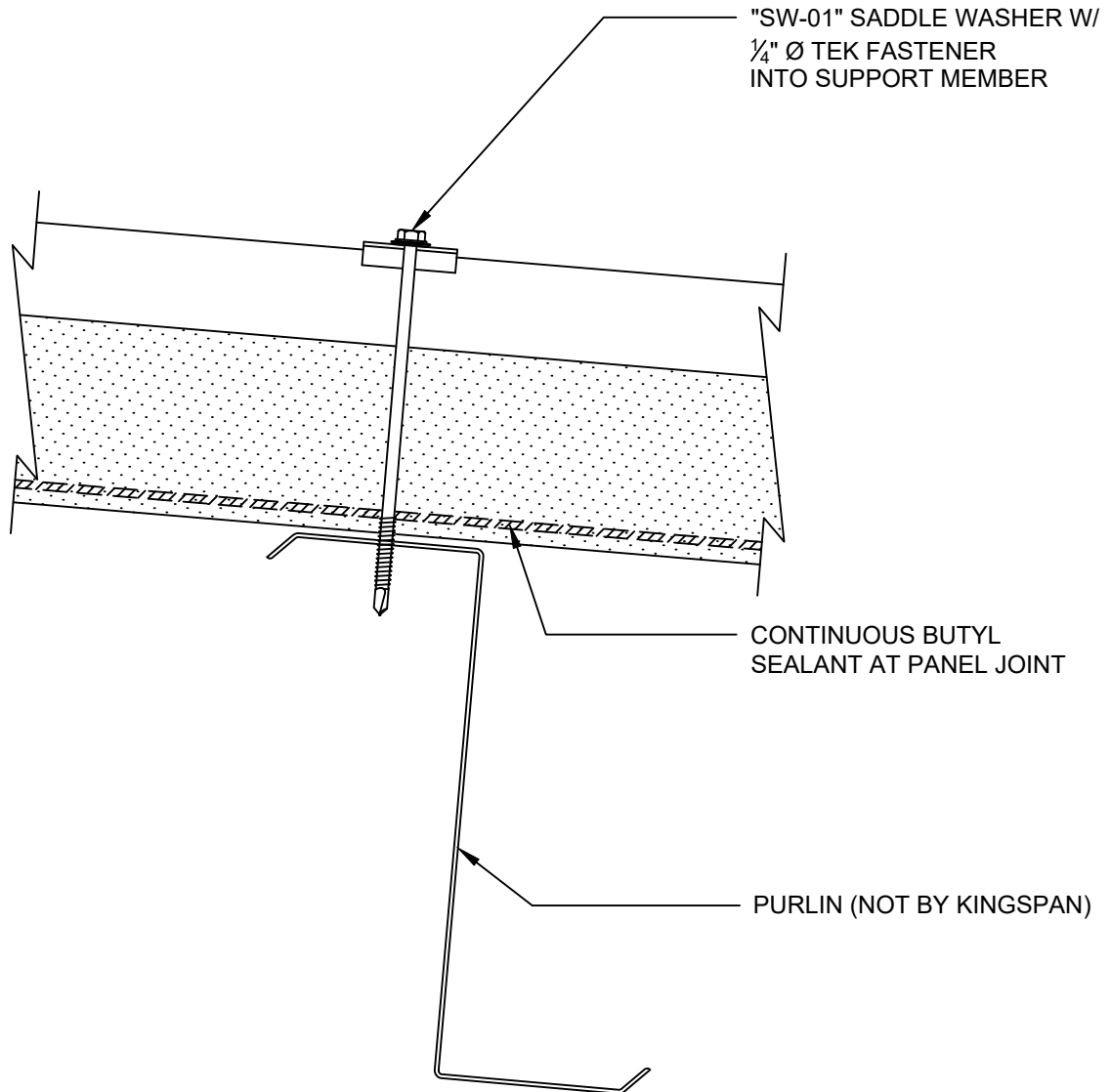

REVISION	
REVISION #	DATE
0	01/01/21

INTERMEDIATE
SUPPORT

DETAIL #: CI-PJ-02-KINGRIB

RELEASE: 2022

REGION: NORTH AMERICA

www.kingspanpanels.com



KINGRIB HR-3 / HR-5 SERIES ROOF PANEL

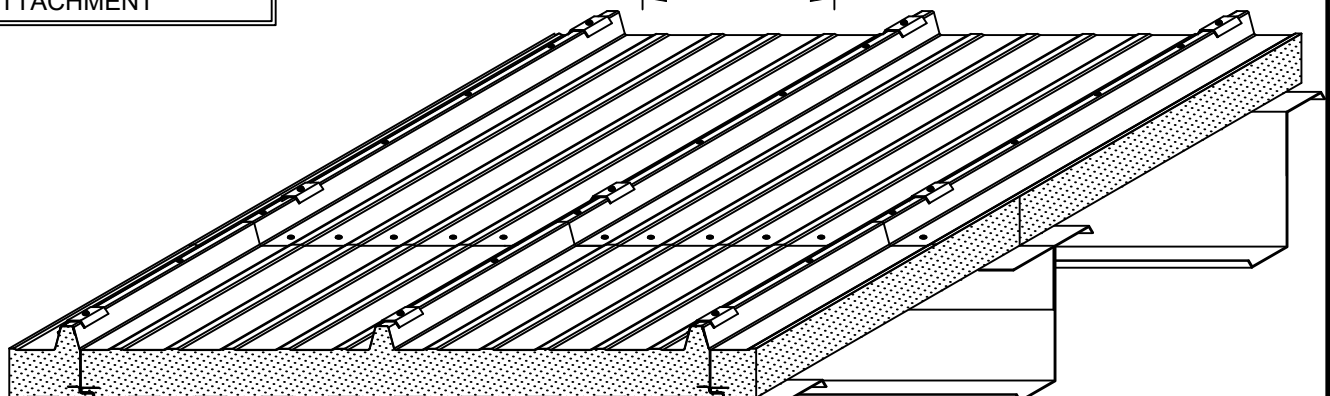
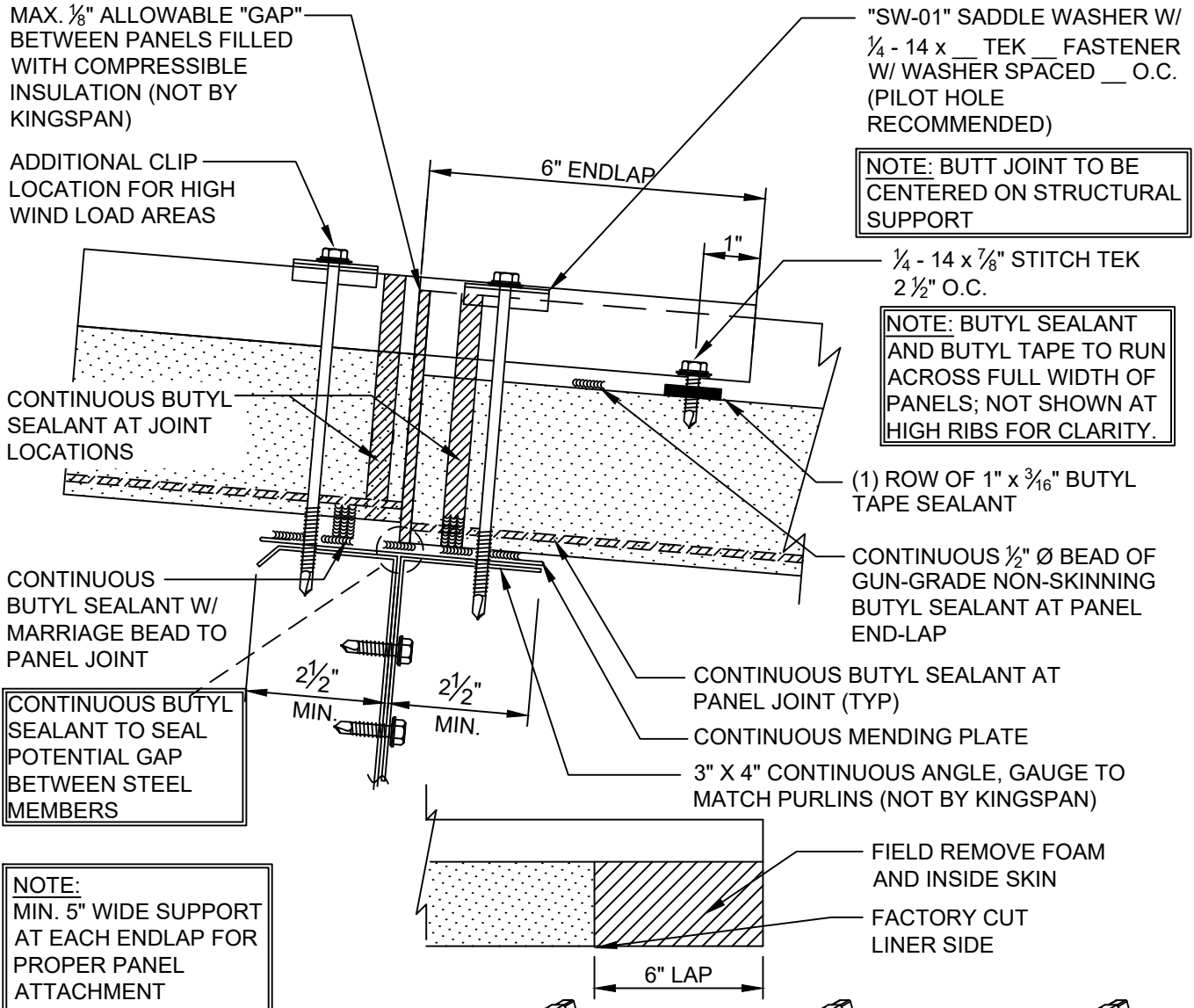

REVISION	
REVISION #	DATE
2	08/12/21

ENDLAP

DETAIL #: CI-EL-01-KINGRIB
 RELEASE: 2022
 REGION: NORTH AMERICA
www.kingspanpanels.com



KINGRIB HR-3 / HR-5 SERIES ROOF PANEL

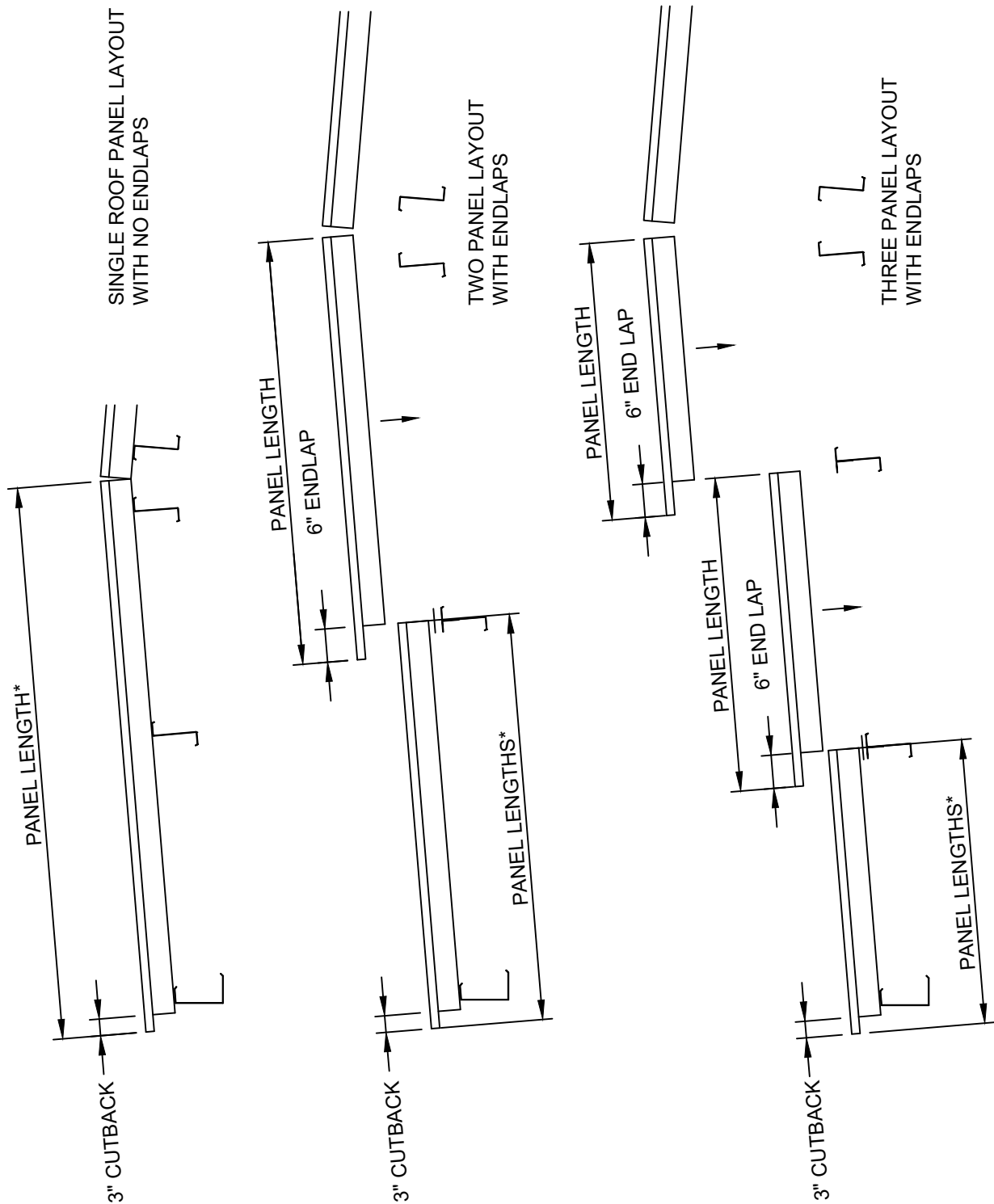

(*) ADD WALL PANEL THICKNESS TO PANEL LENGTH

REVISION	
REVISION #	DATE
0	01/01/21

ENDLAP CONDITIONS

DETAIL #: CI-EL-02-KINGRIB

RELEASE: 2022

REGION: NORTH AMERICA

www.kingspanpanels.com



KINGRIB HR-3 / HR-5 SERIES ROOF PANEL

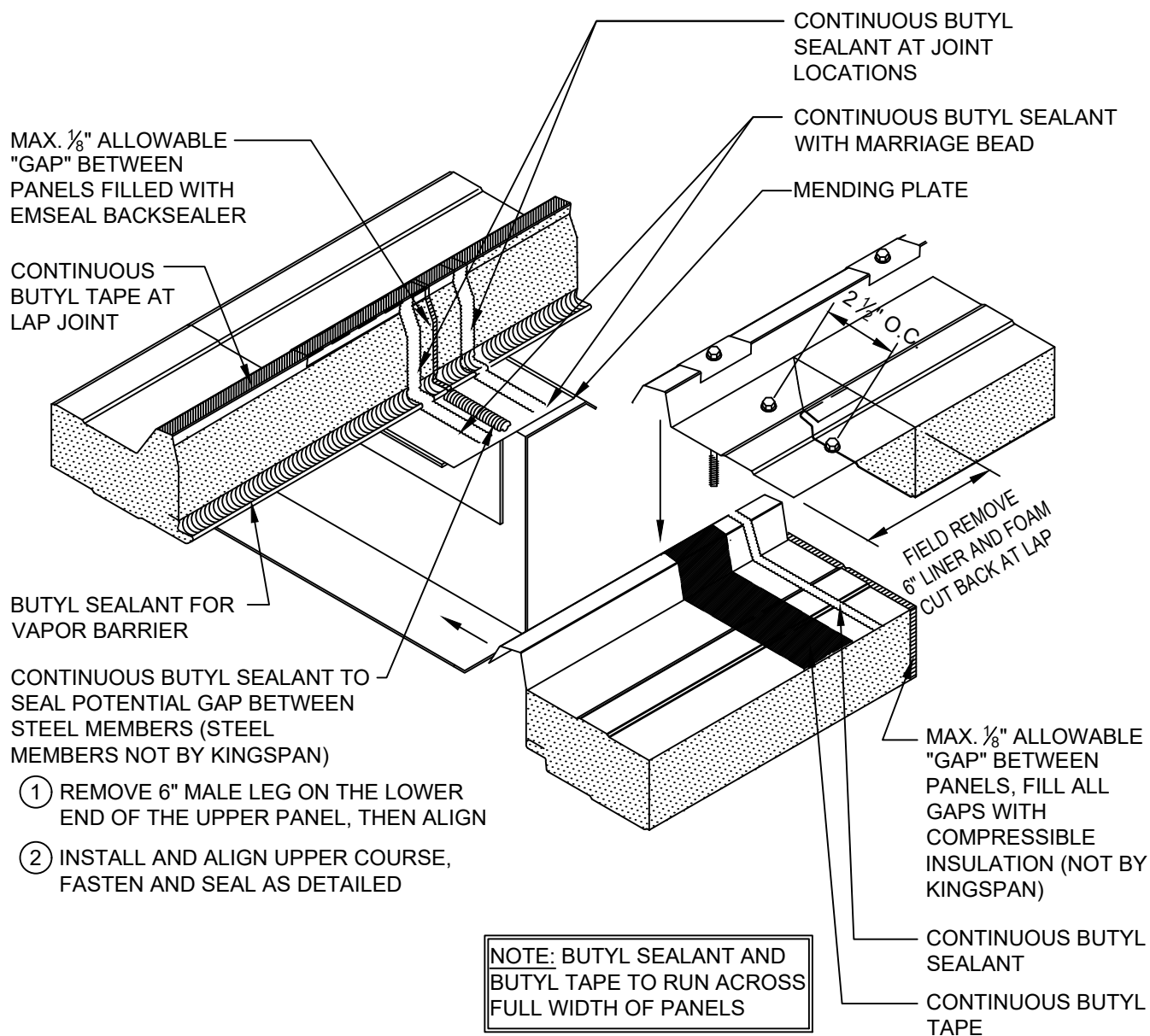

NOTES:

1. SET LOWER COURSE ROOF PANEL IN PLACE. UPPER END OF PANEL AT THE ENDLAP MUST ALIGN WITH THE WEB OF THE ENDLAP PURLIN AND REST ON THE 3" X 4" SUPPORT ANGLE.
2. CHECK PANEL MODULE, ADJUST IF NECESSARY BEFORE ATTACHING PANEL TO THE SUPPORT ANGLE WITH FASTENING SYSTEM.
3. SET THE UPPER PANEL IN PLACE, FASTEN PANELS TO THE SUPPORT STRUCTURE USING A SINGLE HEX HEAD FASTENER WITH PAINTED SADDLE CLIP WHICH MUST PASS THROUGH ALL FOUR PANELS.
4. KINGSPAN DOES NOT RECOMMEND INSTALLING ALL LOWER COURSE PANELS FIRST.

REVISION	
REVISION #	DATE
0	01/01/21

4-WAY INTERSECTION

DETAIL #: CI-EL-03-KINGRIB

RELEASE: 2022

REGION: NORTH AMERICA

www.kingspanpanels.com



KINGRIB HR-3 / HR-5 SERIES ROOF PANEL

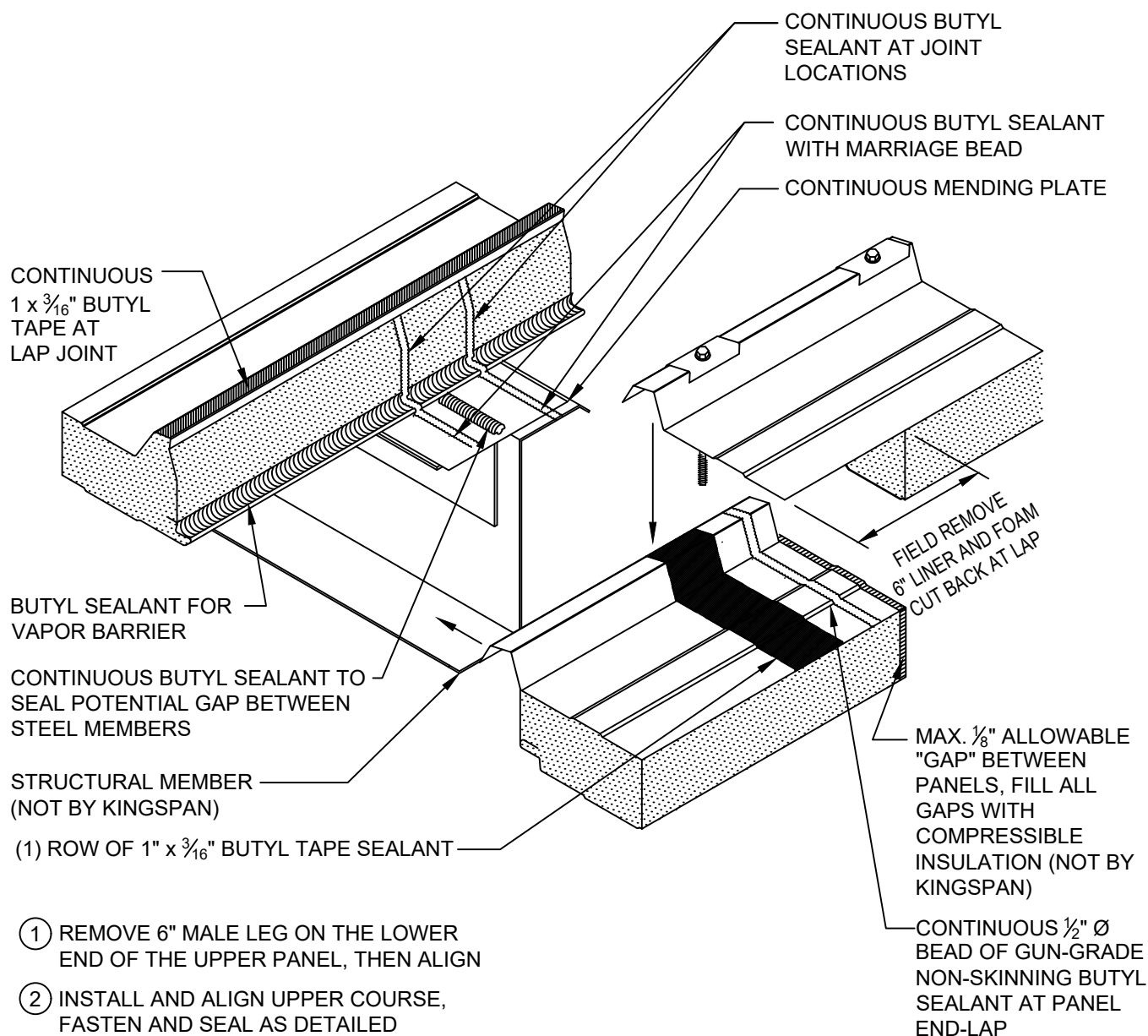

NOTES:

1. SET LOWER COURSE ROOF PANEL IN PLACE. UPPER END OF PANEL AT THE ENDLAP MUST ALIGN WITH THE WEB OF THE ENDLAP PURLIN AND REST ON THE 3" X 4" SUPPORT ANGLE.
2. CHECK PANEL MODULE, ADJUST IF NECESSARY BEFORE ATTACHING PANEL TO THE SUPPORT ANGLE WITH FASTENING SYSTEM.
3. SET THE UPPER PANEL IN PLACE, FASTEN PANELS TO THE SUPPORT STRUCTURE USING A SINGLE HEX HEAD FASTENER WITH PAINTED SADDLE CLIP WHICH MUST PASS THROUGH ALL FOUR PANELS.
4. KINGSPAN DOES NOT RECOMMEND INSTALLING ALL LOWER COURSE PANELS FIRST.

REVISION	
REVISION #	DATE
0	01/01/21

**CONTINUOUS MALE LEG
AT STAGGERED ENDLAP /
FEMALE ENDLAP**

DETAIL #: CI-EL-04-KINGRIB
RELEASE: 2022
REGION: NORTH AMERICA
www.kingspanpanels.com



KINGRIB HR-3 / HR-5 SERIES ROOF PANEL

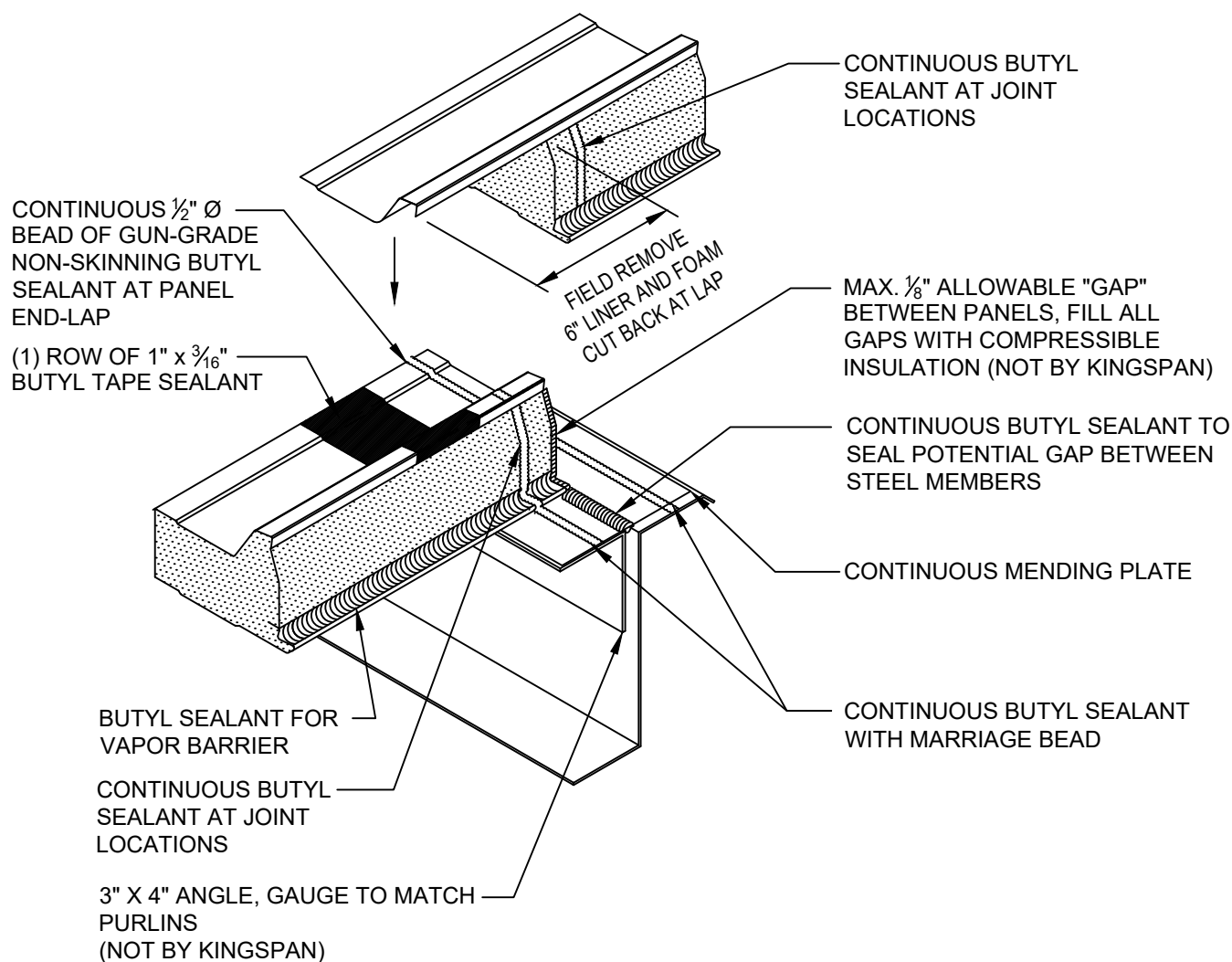

- ① REMOVE 6" MALE LEG ON THE LOWER END OF THE UPPER PANEL, THEN ALIGN
- ② INSTALL AND ALIGN UPPER COURSE, FASTEN AND SEAL AS DETAILED

NOTES:

1. SET LOWER COURSE ROOF PANEL IN PLACE. UPPER END OF PANEL AT THE ENDLAP MUST ALIGN WITH THE WEB OF THE ENDLAP PURLIN AND REST ON THE 3" X 4" SUPPORT ANGLE.
2. CHECK PANEL MODULE, ADJUST IF NECESSARY BEFORE ATTACHING PANEL TO THE SUPPORT ANGLE WITH FASTENING SYSTEM.
3. SET THE UPPER PANEL IN PLACE, FASTEN PANELS TO THE SUPPORT STRUCTURE USING A SINGLE HEX HEAD FASTENER WITH PAINTED SADDLE CLIP WHICH MUST PASS THROUGH ALL FOUR PANELS.
4. KINGSPAN DOES NOT RECOMMEND INSTALLING ALL LOWER COURSE PANELS FIRST.

REVISION	
REVISION #	DATE
0	01/01/21

STAGGERED MALE LEG AT ENDLAP

DETAIL #: CI-EL-05-KINGRIB

RELEASE: 2022

REGION: NORTH AMERICA

www.kingspanpanels.com



KINGRIB HR-3 / HR-5 SERIES ROOF PANEL

MAX. $\frac{1}{8}$ " ALLOWABLE "GAP"
BETWEEN PANELS, FILL ALL
GAPS WITH COMPRESSIBLE
INSULATION
(NOT BY KINGSPAN)

CONTINUOUS
BUTYL TAPE AT
LAP JOINT

CONTINUOUS BUTYL SEALANT
WITH MARRIAGE BEAD

BUTYL SEALANT FOR
VAPOR BARRIER

CONTINUOUS MENDING PLATE

CONTINUOUS BUTYL SEALANT TO
SEAL POTENTIAL GAP BETWEEN
STEEL MEMBERS

3" X 4" ANGLE, GAUGE TO MATCH
PURLINS
(NOT BY KINGSPAN)

STAGGERED MALE LEG AT
ENDLAP / CONTINUOUS
FEMALE LEG

DETAIL #: CI-EL-06-KINGRIB

RELEASE: 2022

REGION: NORTH AMERICA

www.kingspanpanels.com

REVISION	
REVISION #	DATE
0	01/01/21



KINGRIB HR-3 / HR-5 SERIES ROOF PANEL

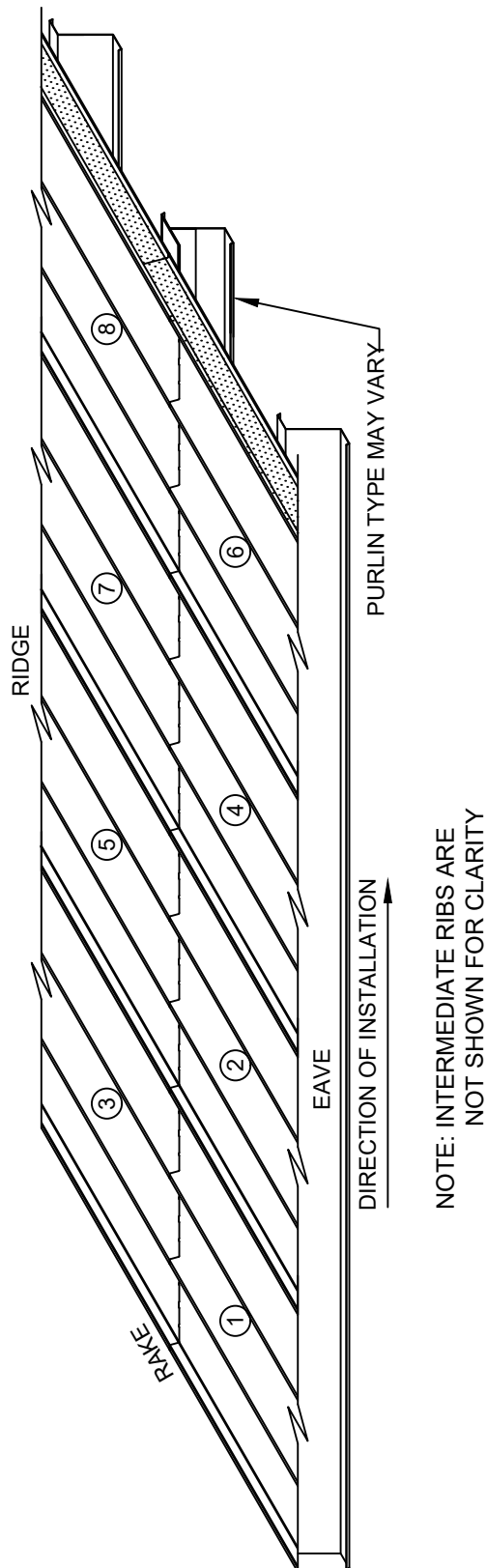

REVISION	
REVISION #	DATE
0	01/01/21

ENDLAP INSTALLATION SEQUENCE

DETAIL #: CI-EL-07-KINGRIB

RELEASE: 2022

REGION: NORTH AMERICA

www.kingspanpanels.com



KINGRIB HR-3 / HR-5 SERIES ROOF PANEL

① FASTEN AT EVERY MINOR RIB VALLEY

② STAGGERED ENDLAPS

③ SEE MALE LEG ENDLAP DETAIL

④ SEE CONTINUOUS MALE LEG DETAIL

⑤ SEE FEMALE LEG ENDLAP DETAIL

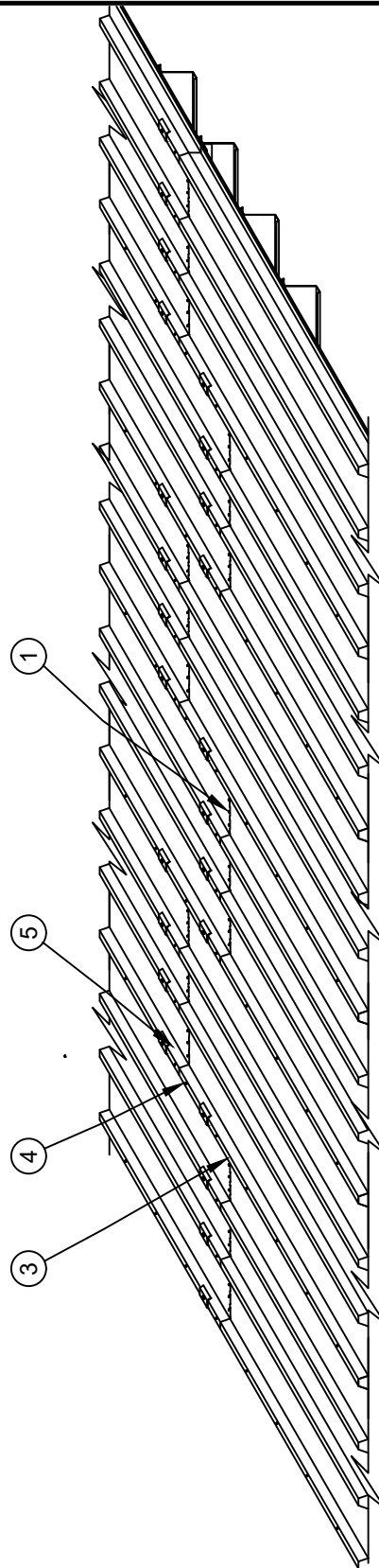

STAGGERED ENDLAP ASSEMBLY
(ISOMETRIC VIEW - TYPICAL)

REVISION	
REVISION #	DATE
0	01/01/21

STAGGERED ENDLAP ASSEMBLY

DETAIL #: CI-EL-08-KINGRIB

RELEASE: 2022

REGION: NORTH AMERICA

www.kingspanpanels.com



KINGRIB HR-3 / HR-5 SERIES ROOF PANEL

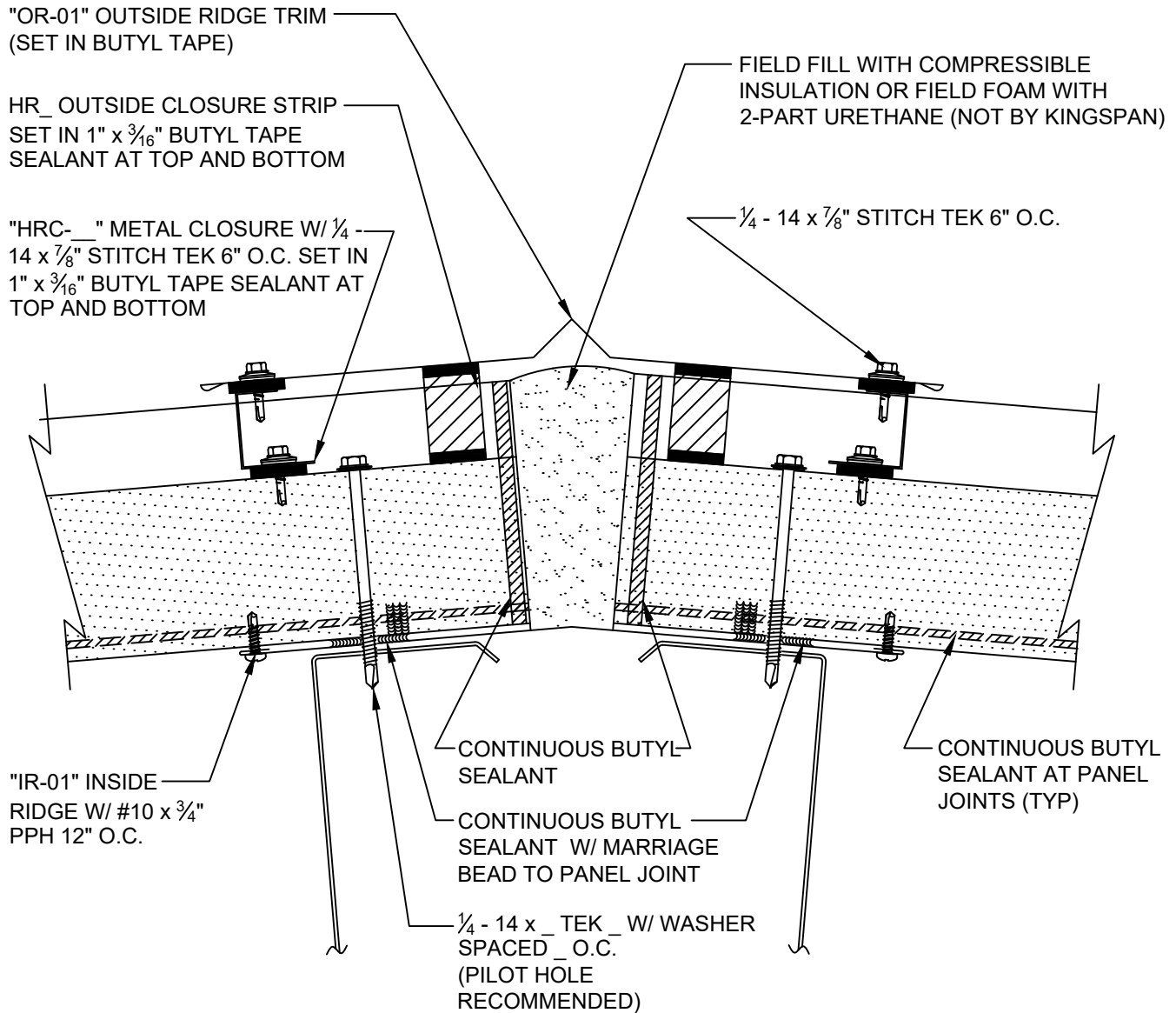

REVISION	
REVISION #	DATE
0	01/01/21

RIDGE

DETAIL #: CI-RD-01-KINGRIB
RELEASE: 2022
REGION: NORTH AMERICA
www.kingspanpanels.com



KINGRIB HR-3 / HR-5 SERIES ROOF PANEL

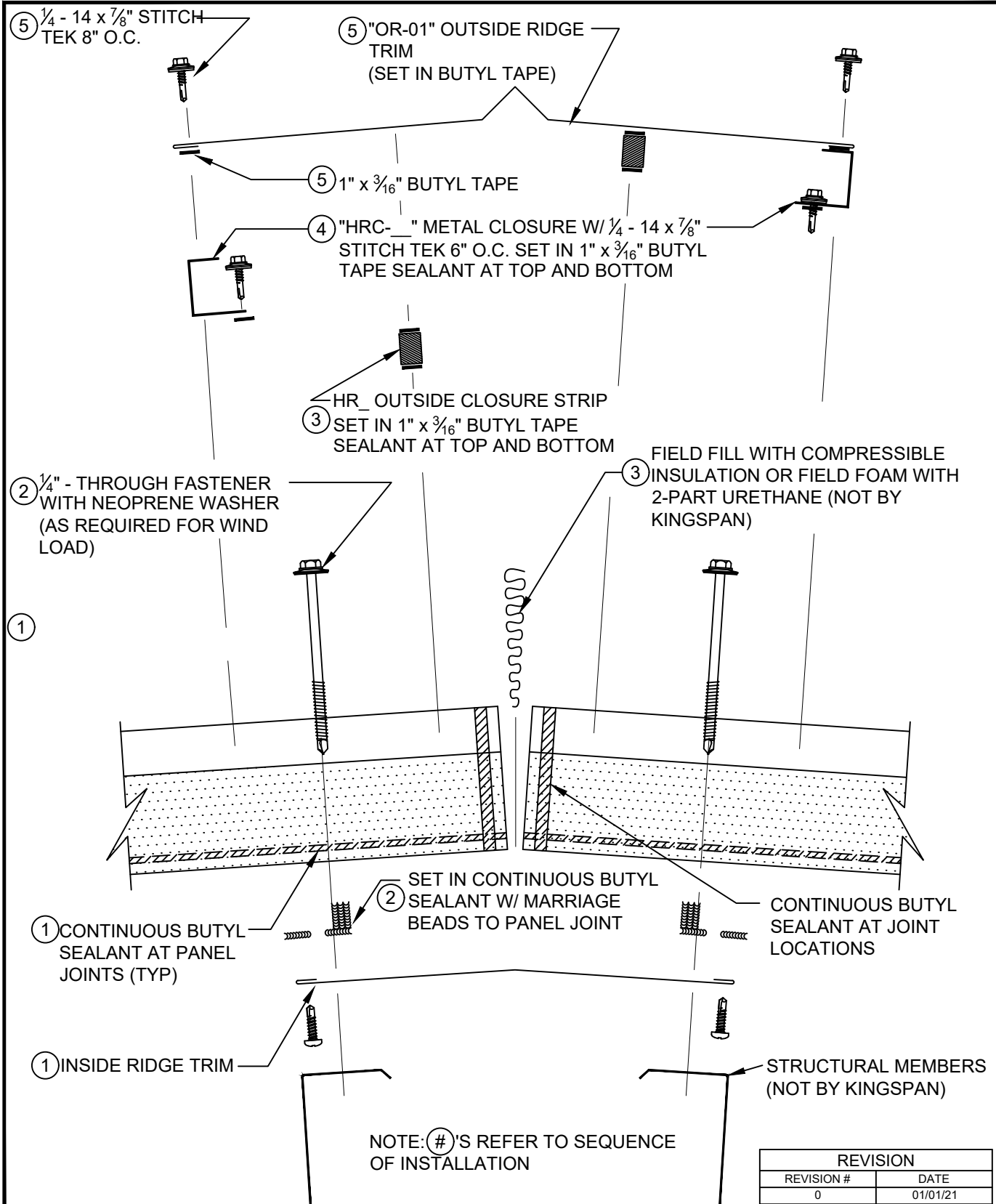

RIDGE ASSEMBLY

DETAIL #: CI-RD-02-KINGRIB

RELEASE: 2022

REGION: NORTH AMERICA

www.kingspanpanels.com



KINGRIB HR-3 / HR-5 SERIES ROOF PANEL

HR 3 STANDARD ROOF CLOSURE SET

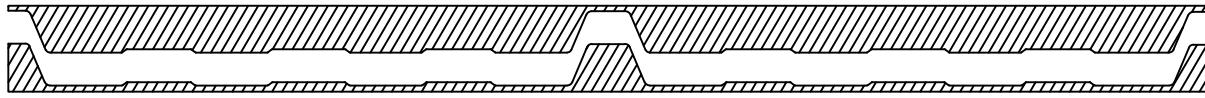

HRC 3 METAL CLOSURE

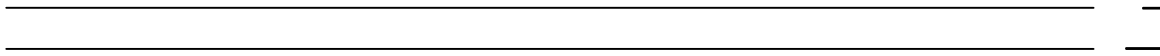

BUTYL TAPE



HR 3 OUTSIDE CLOSURE

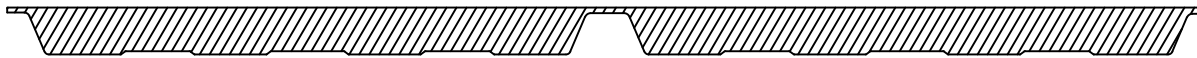

BUTYL TAPE



KINGRIB 3

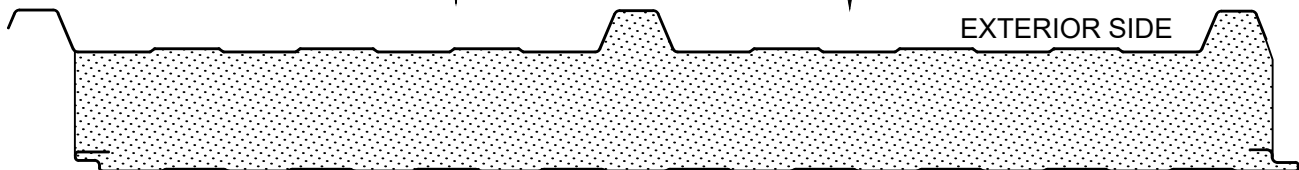

EXTERIOR SIDE

INTERIOR SIDE

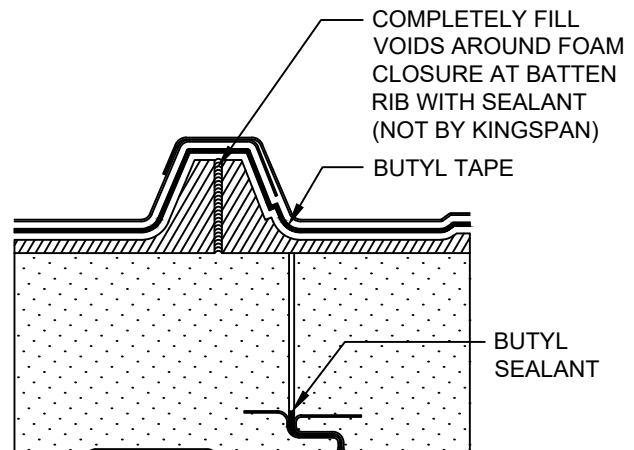
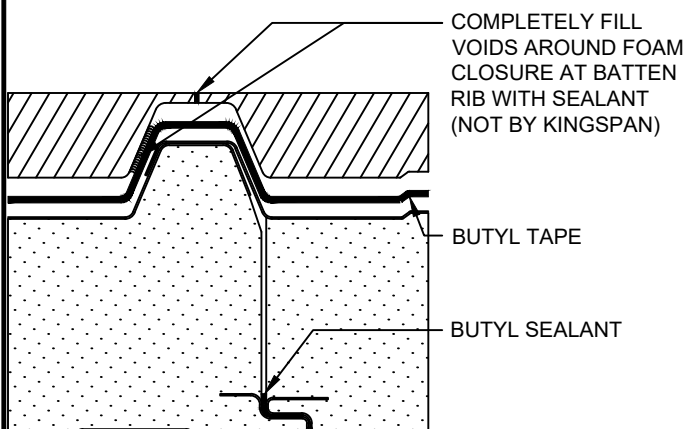

REVISION	
REVISION #	DATE
0	01/01/21

RIDGE CLOSURE ASSEMBLY

DETAIL #: CI-RD-03-KINGRIB

RELEASE: 2022

REGION: NORTH AMERICA

www.kingspanpanels.com



KINGRIB HR-3 / HR-5 SERIES ROOF PANEL

HR 5 STANDARD ROOF CLOSURE SET

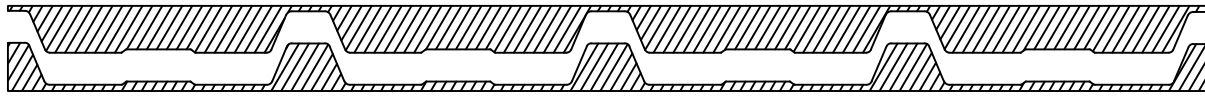

HRC 5 METAL CLOSURE

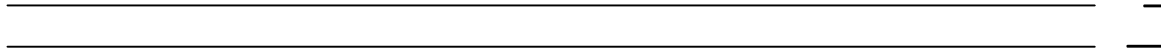

BUTYL TAPE



HR 5 OUTSIDE CLOSURE

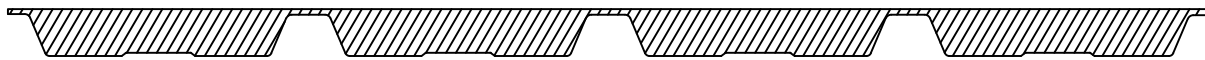

BUTYL TAPE



KINGRIB 5

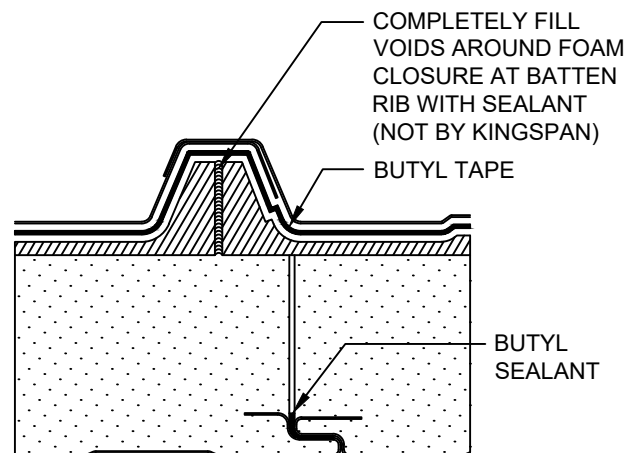
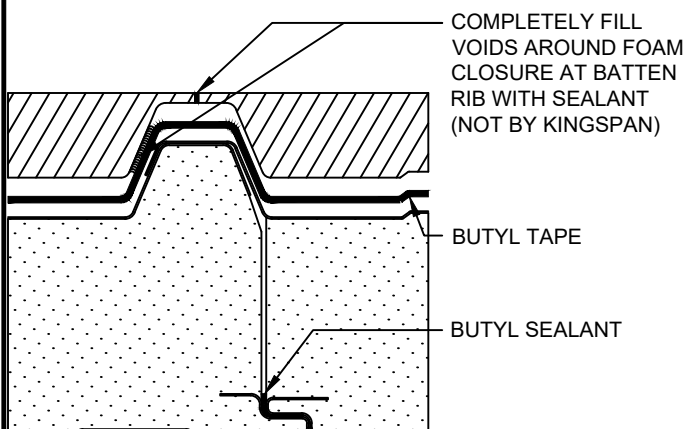
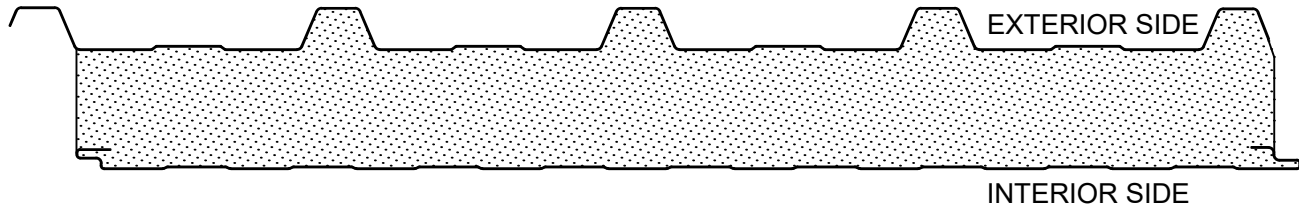

REVISION	
REVISION #	DATE
0	01/01/21

RIDGE CLOSURE ASSEMBLY

DETAIL #: CI-RD-04-KINGRIB

RELEASE: 2022

REGION: NORTH AMERICA

www.kingspanpanels.com



KINGRIB HR-3 / HR-5 SERIES ROOF PANEL

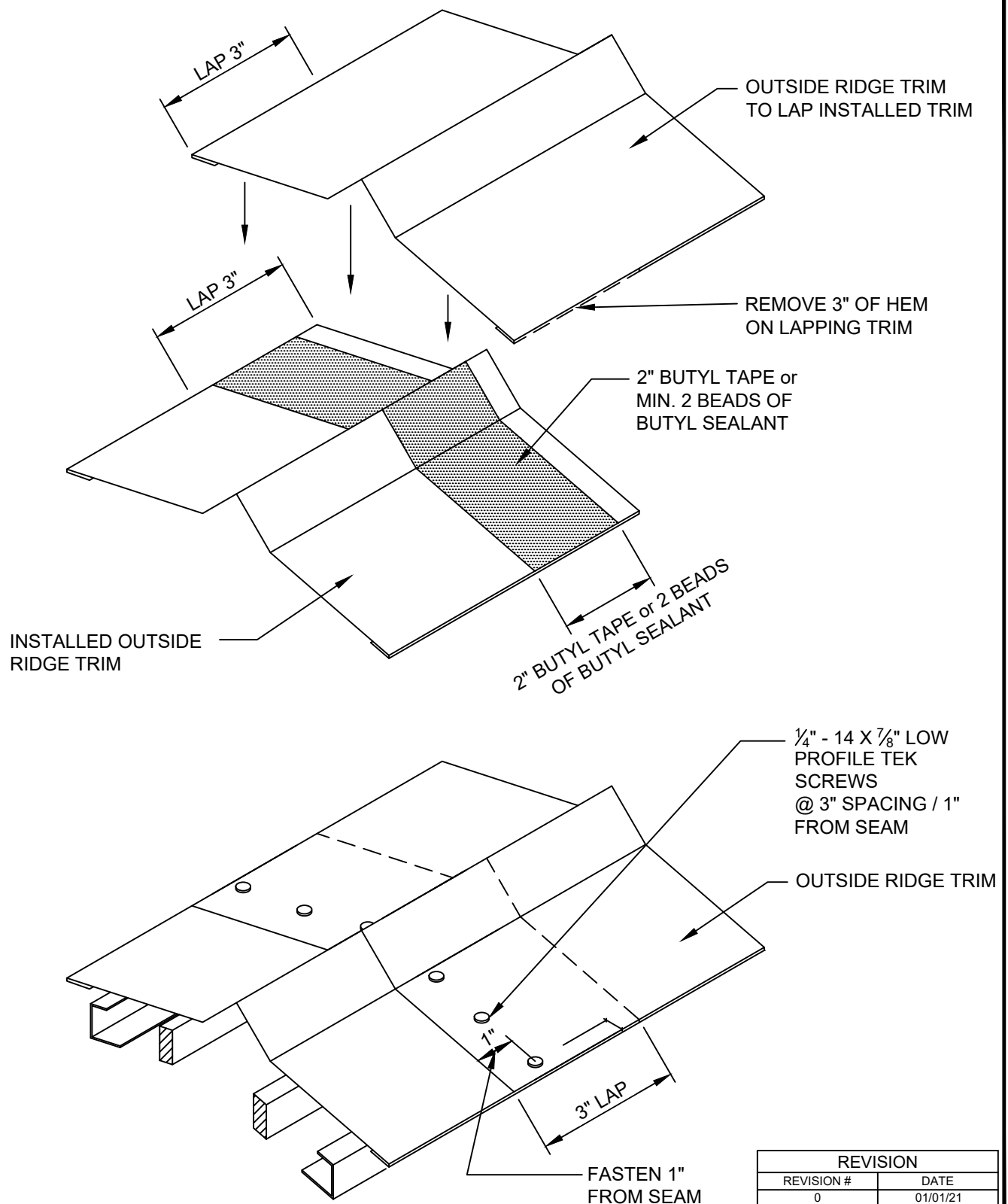

REVISION	
REVISION #	DATE
0	01/01/21

RIDGE TRIM LAP

DETAIL #: CI-RD-05-KINGRIB

RELEASE: 2022

REGION: NORTH AMERICA

www.kingspanpanels.com



KINGRIB HR-3 / HR-5 SERIES ROOF PANEL

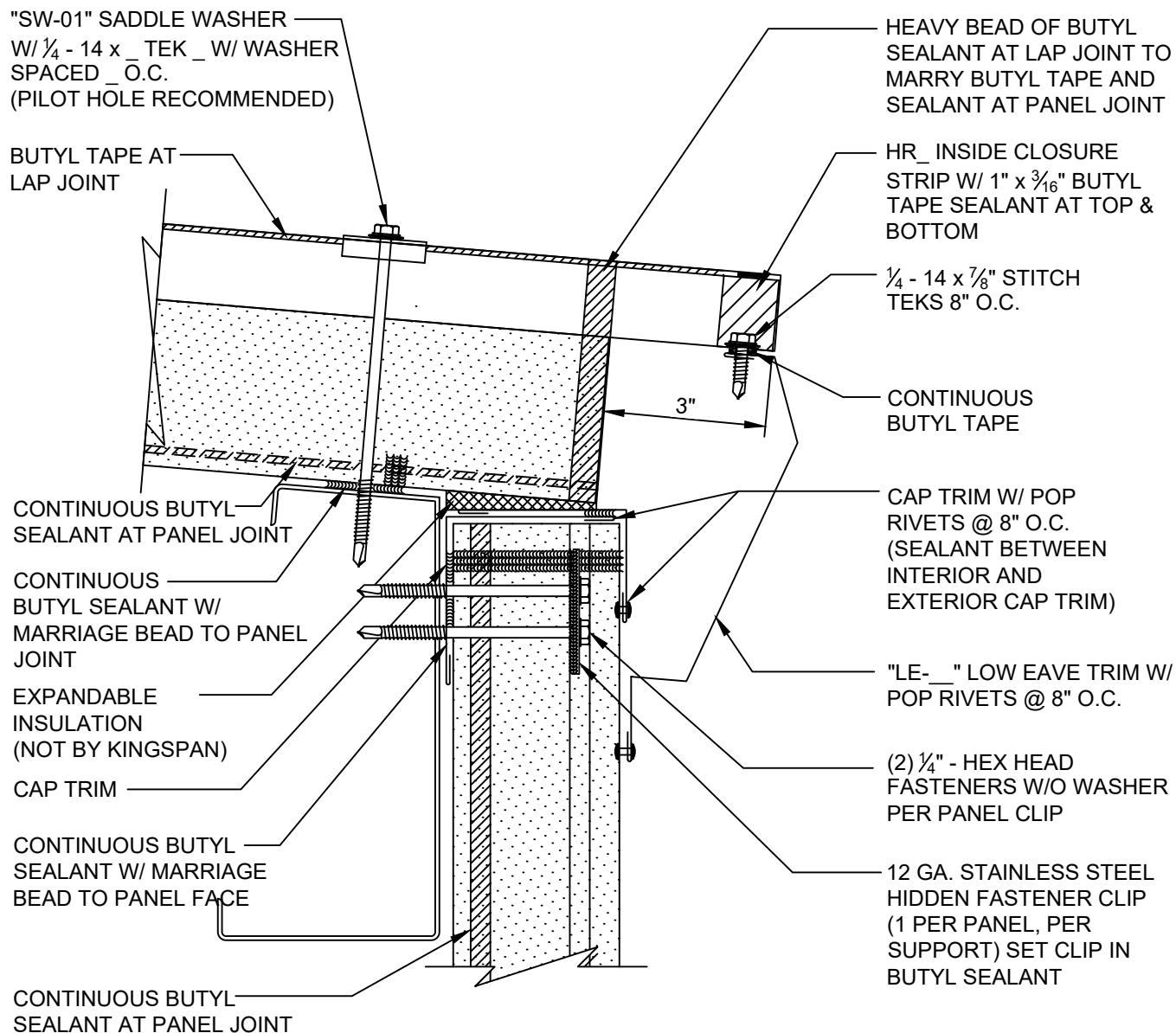

REVISION	
REVISION #	DATE
0	01/01/21

LOW EAVE W/O
GUTTER

DETAIL #: CI-EV-01-KINGRIB
RELEASE: 2022
REGION: NORTH AMERICA
www.kingspanpanels.com



KINGRIB HR-3 / HR-5 SERIES ROOF PANEL

"GH-01" GUTTER HANGER AT INTERIOR HI-RIBS 40" O.C. ATTACH W/ (3) $\frac{1}{4}$ " - 14 x $\frac{7}{8}$ " STITCH TEKS AND (1) $\frac{1}{4}$ " - 14 X _ TEK _ FASTENERS W/ WASHER

BUTYL TAPE AT LAP JOINT

CONTINUOUS BUTYL SEALANT AT PANEL JOINT

CONTINUOUS BUTYL SEALANT W/ MARRIAGE BEAD TO PANEL JOINT

EXPANDABLE INSULATION (NOT BY KINGSPAN)

CAP TRIM

CONTINUOUS BUTYL SEALANT W/ MARRIAGE BEAD TO PANEL FACE

STRUCTURAL MEMBER (NOT BY KINGSPAN)

CONTINUOUS BUTYL SEALANT AT PANEL JOINT

GUTTER HANGERS @ 40" O.C.

HEAVY BEAD OF BUTYL SEALANT TO MARRY BUTYL TAPE AND SEALANT AT PANEL JOINT

HR_ INSIDE CLOSURE STRIP W/ 1" x $\frac{3}{16}$ " BUTYL TAPE SEALANT AT TOP & BOTTOM

"GT- _" GUTTER TRIM

"BB-01" BIRD BLOCK W/ POP RIVETS @ 8" O.C.

(2) $\frac{1}{4}$ " - HEX HEAD FASTENERS W/O WASHER PER PANEL CLIP

12 GA. STAINLESS STEEL HIDDEN FASTENER CLIP (1 PER PANEL, PER SUPPORT) SET CLIP IN BUTYL SEALANT

FOR SNOW LOAD AREAS, ADD INTERMEDIATE GUTTER HANGERS, TWO PER PANEL MAXIMUM / AS REQUIRED (LOCATE AT HIGH RIBS)

REVISION

REVISION #	DATE
0	01/01/21

LOW EAVE W/ GUTTER

DETAIL #: CI-EV-02-KINGRIB

RELEASE: 2022

REGION: NORTH AMERICA

www.kingspanpanels.com



KINGRIB HR-3 / HR-5 SERIES ROOF PANEL

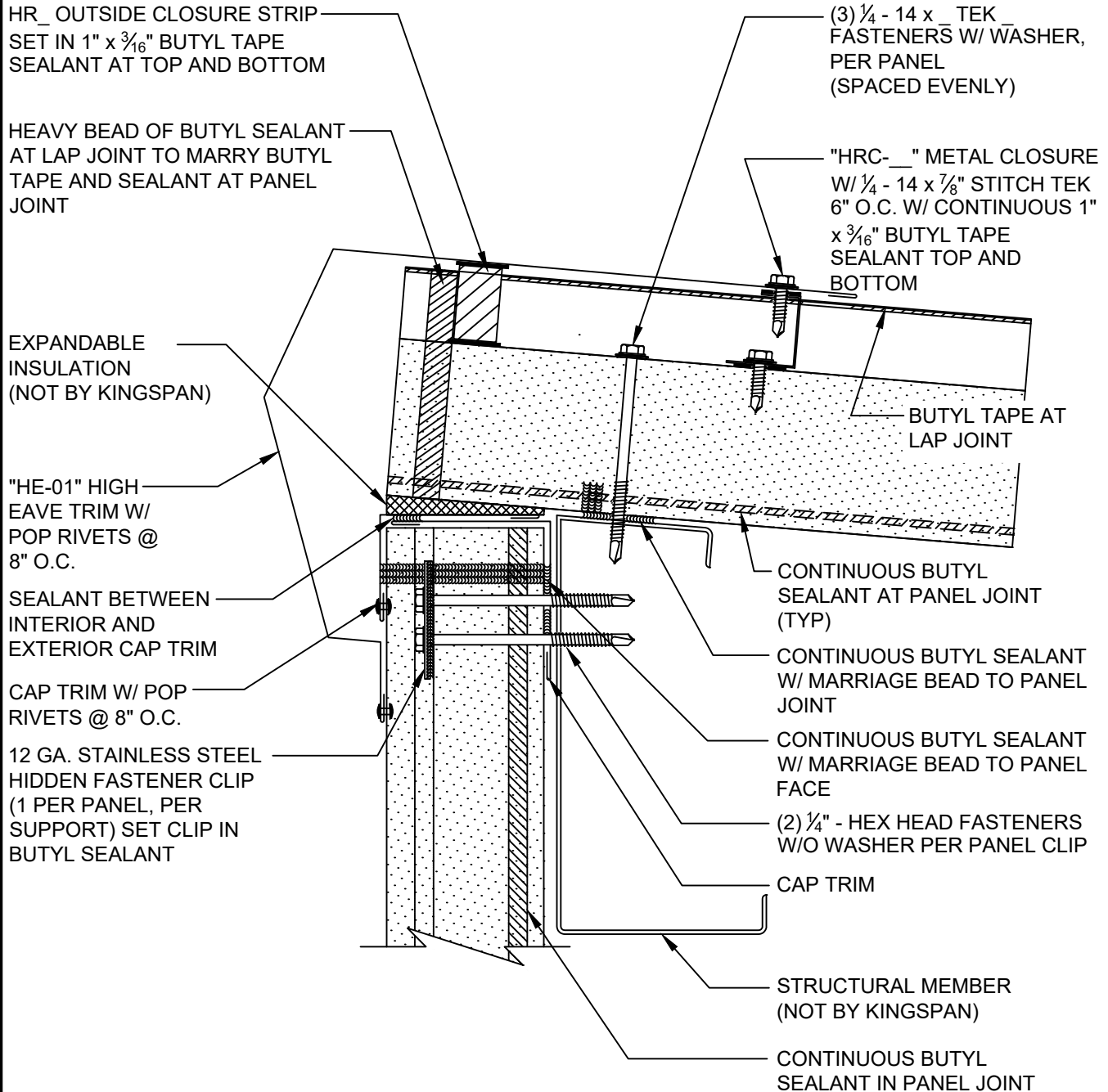

REVISION	
REVISION #	DATE
1	03/25/21

HIGH EAVE

DETAIL #: CI-EV-03-KINGRIB

RELEASE: 2022

REGION: NORTH AMERICA

www.kingspanpanels.com



KINGRIB HR-3 / HR-5 SERIES ROOF PANEL

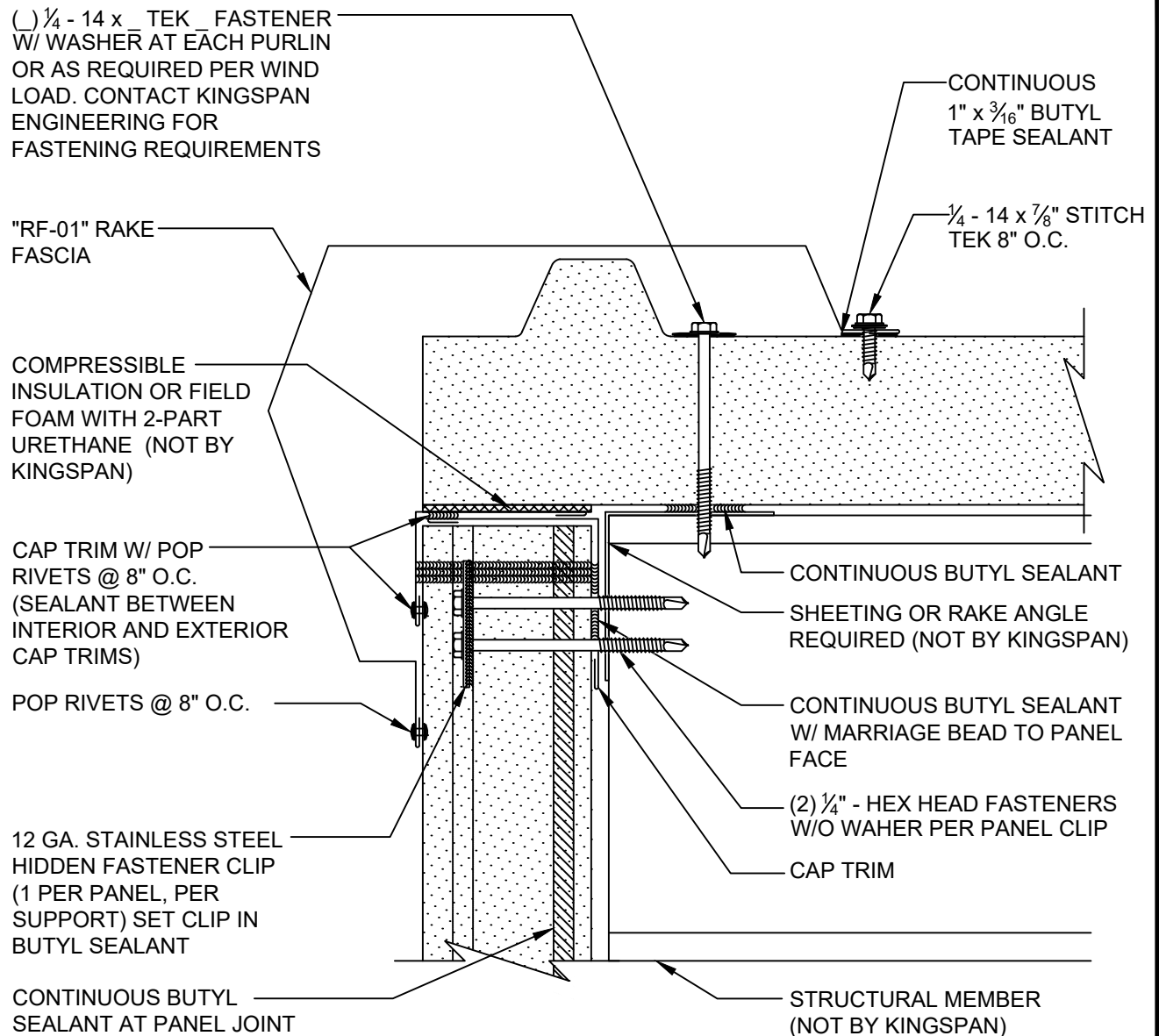

REVISION	
REVISION #	DATE
0	01/01/21

RAKE

DETAIL #: CI-RK-01-KINGRIB
 RELEASE: 2022
 REGION: NORTH AMERICA
www.kingspanpanels.com



KINGRIB HR-3 / HR-5 SERIES ROOF PANEL

UPPER VALLEY FLASHING
(FIELD BREAK FROM FLATSTOCK)

1/4" - 14 X 7/8" STITCH
TEK SCREWS 4" O.C.
(IN LOWS)

1/4" - 14 X 7/8" LOW PROFILE
TEK SCREWS W/O
WASHER

"SW-01" SADDLE WASHER W/
1/4 - 14 x _ TEK _ W/ WASHER
SPACED _ O.C. (PILOT HOLE
RECOMMENDED)

SEE BELOW FOR
ADDITIONAL INFO.

FIELD CUT HR_ INSIDE
FOAM CLOSURE SET
IN BUTYL TAPE TOP
AND BOTTOM

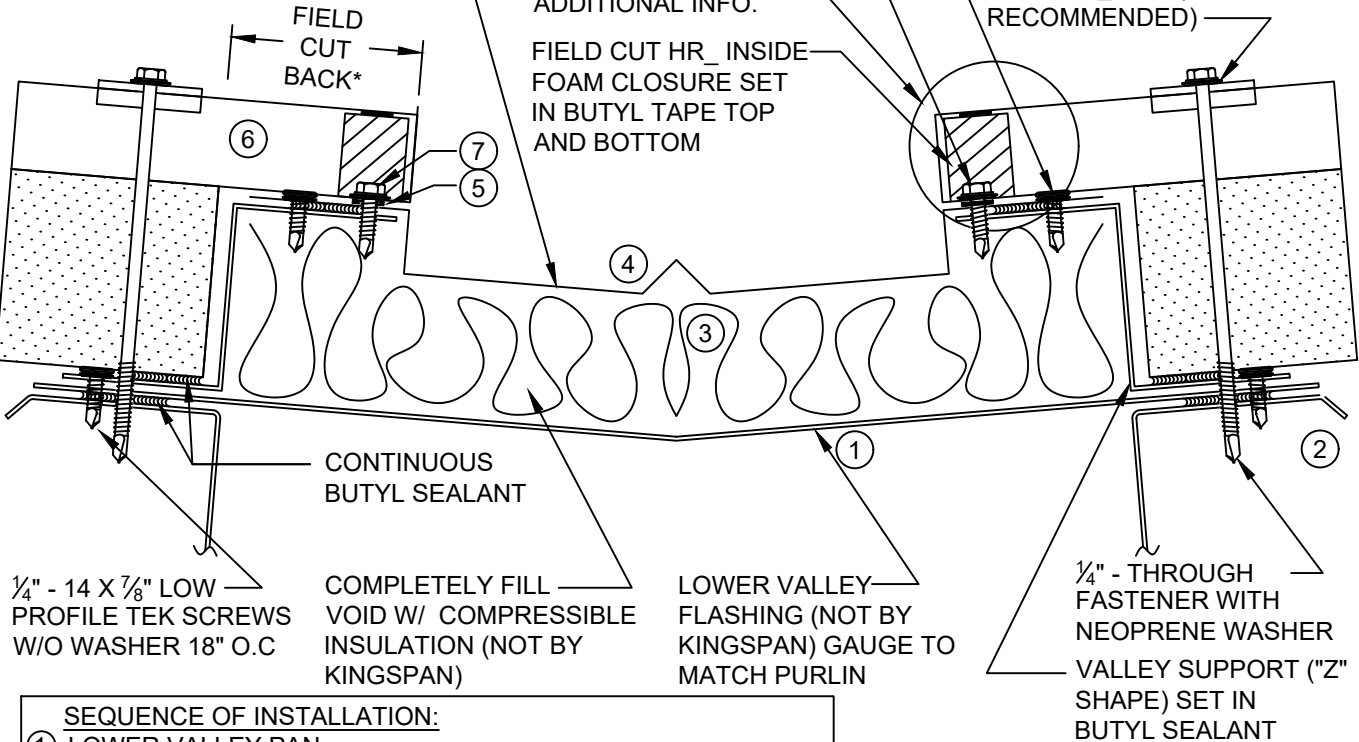

SEQUENCE OF INSTALLATION:

- ① LOWER VALLEY PAN
- ② "Z" SHAPED VALLEY SUPPORT
- ③ FILL VOID W/ INSULATION
- ④ INSTALL SECONDARY & UPPER VALLEY PAN
- ⑤ APPLY TAPE MASTIC TO TOP OF UPPER VALLEY PAN
- ⑥ CUT ROOF PANELS. REMOVE CUT BACK & FOAM AT HIGH RIB
- ⑦ FASTEN ASSEMBLY

* FIELD CUT ROOF PANELS FOR 4 1/4" OR 3" CUTBACK. CUTBACK SIZE
TO MATCH THE EAVE CONDITION

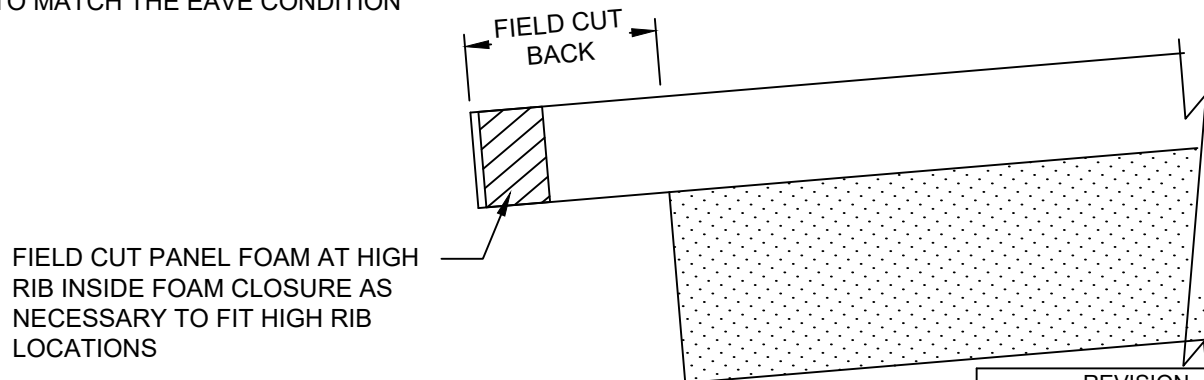

FIELD CUT PANEL FOAM AT HIGH
RIB INSIDE FOAM CLOSURE AS
NECESSARY TO FIT HIGH RIB
LOCATIONS

REVISION

REVISION #	DATE
0	01/01/21

VALLEY CONDITION

DETAIL #: CI-VL-01-KINGRIB

RELEASE: 2022

REGION: NORTH AMERICA

www.kingspanpanels.com



KINGRIB HR-3 / HR-5 SERIES ROOF PANEL

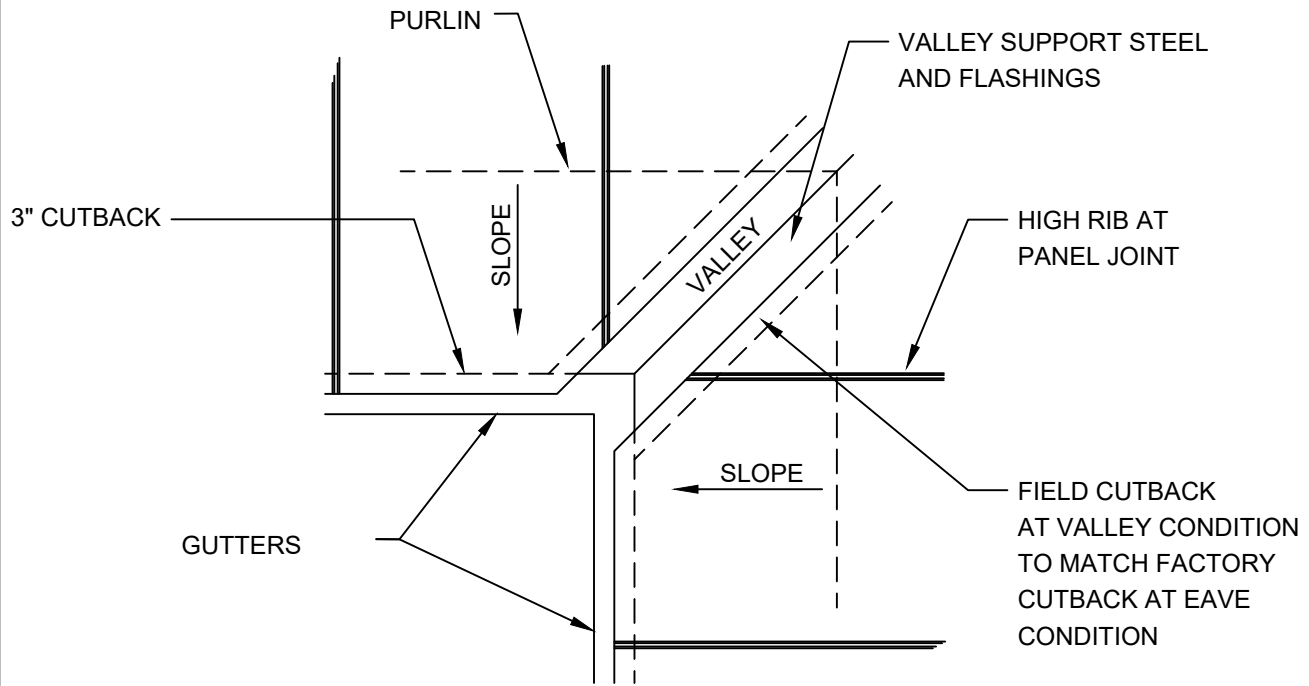

ROOF VALLEY PLAN

REVISION	
REVISION #	DATE
0	01/01/21

VALLEY ASSEMBLY

DETAIL #: CI-VL-02-KINGRIB
RELEASE: 2022
REGION: NORTH AMERICA
www.kingspanpanels.com



KINGRIB HR-3 / HR-5 SERIES ROOF PANEL

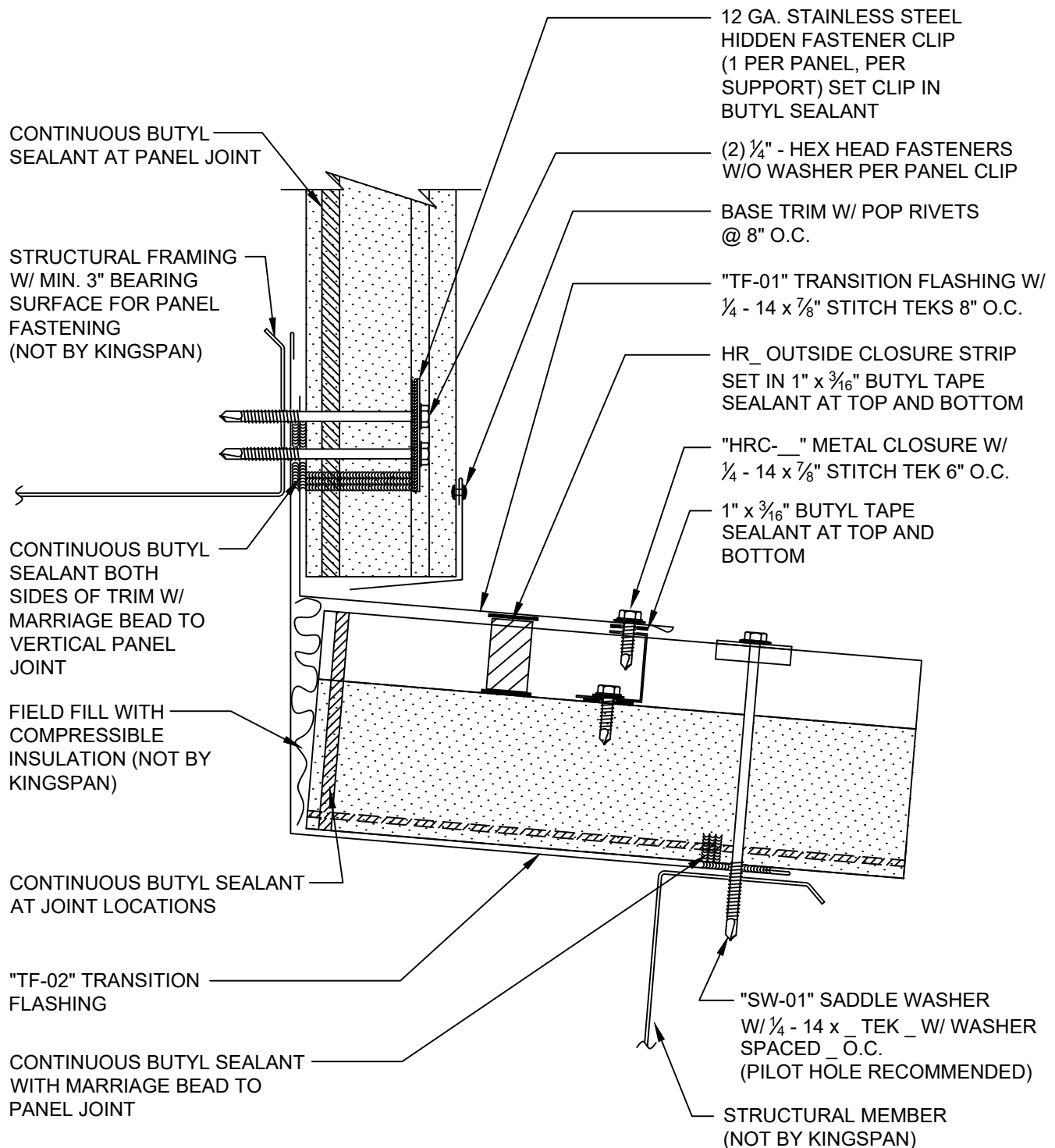

REVISION	
REVISION #	DATE
3	04/14/22

WALL TO ROOF
HIGH EAVE

DETAIL #: CI-WR-01-KINGRIB
RELEASE: 2022
REGION: NORTH AMERICA
www.kingspanpanels.com



KINGRIB HR-3 / HR-5 SERIES ROOF PANEL

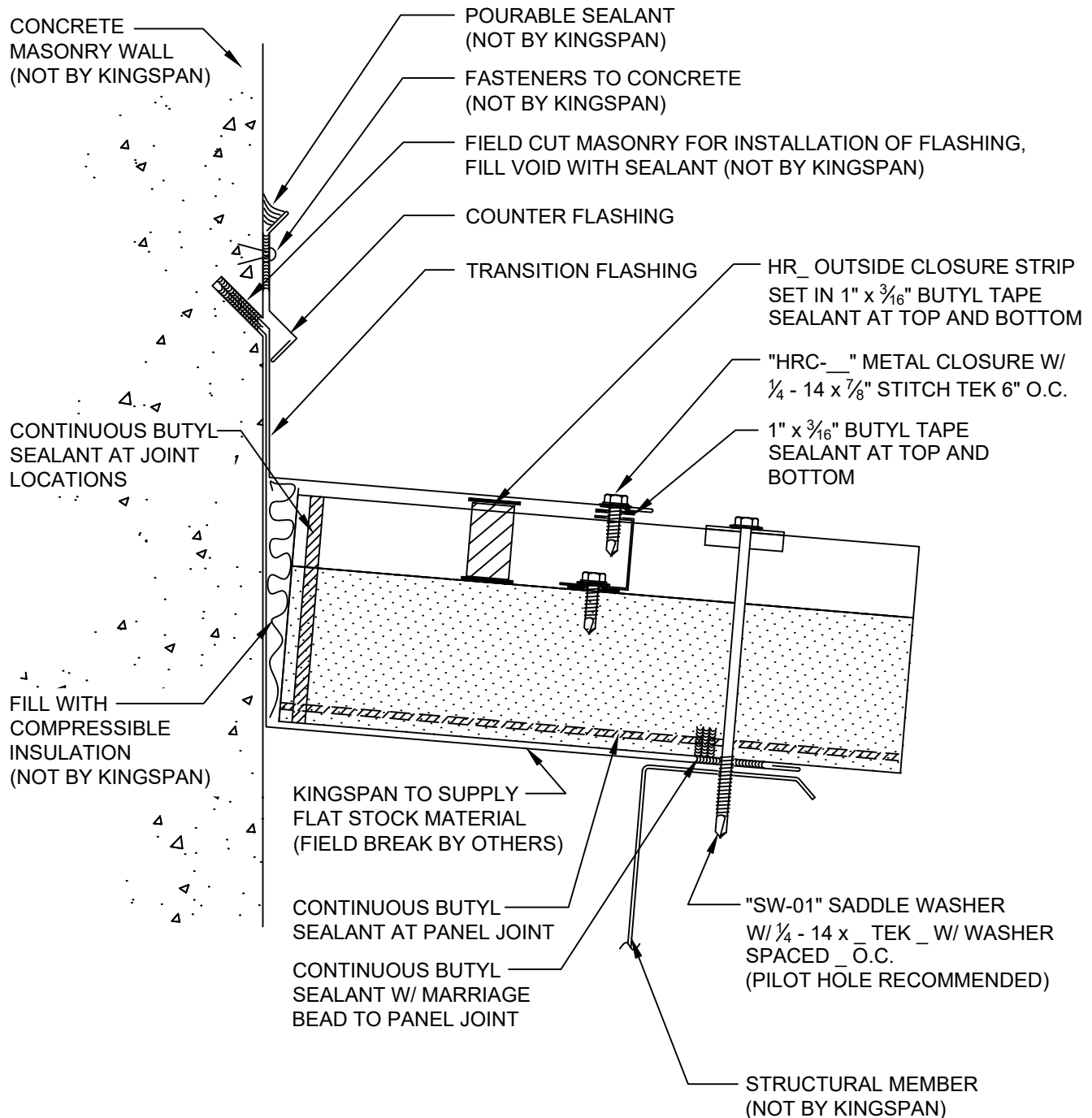

REVISION	
REVISION #	DATE
1	03/25/21

CONCRETE WALL
TO HIGH EAVE

DETAIL #: CI-WR-02-KINGRIB

RELEASE: 2022

REGION: NORTH AMERICA

www.kingspanpanels.com



KINGRIB HR-3 / HR-5 SERIES ROOF PANEL

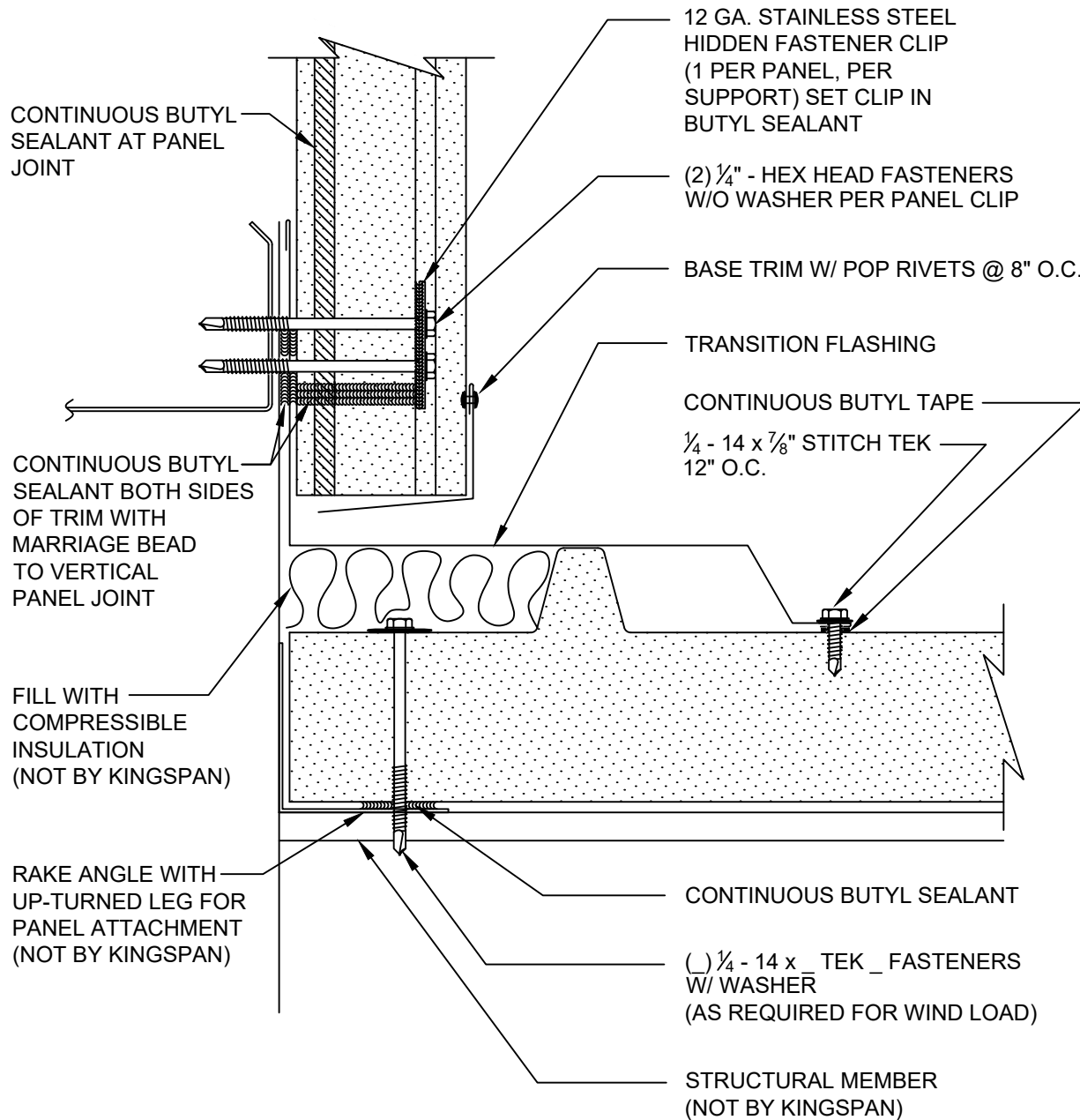

REVISION	
REVISION #	DATE
3	04/14/22

WALL TO RAKE

DETAIL #: CI-WR-03-KINGRIB

DATE: 2021



www.kingspanpanels.us
www.kingspanpanels.ca

KINGRIB HR-3 / HR-5 SERIES ROOF PANEL

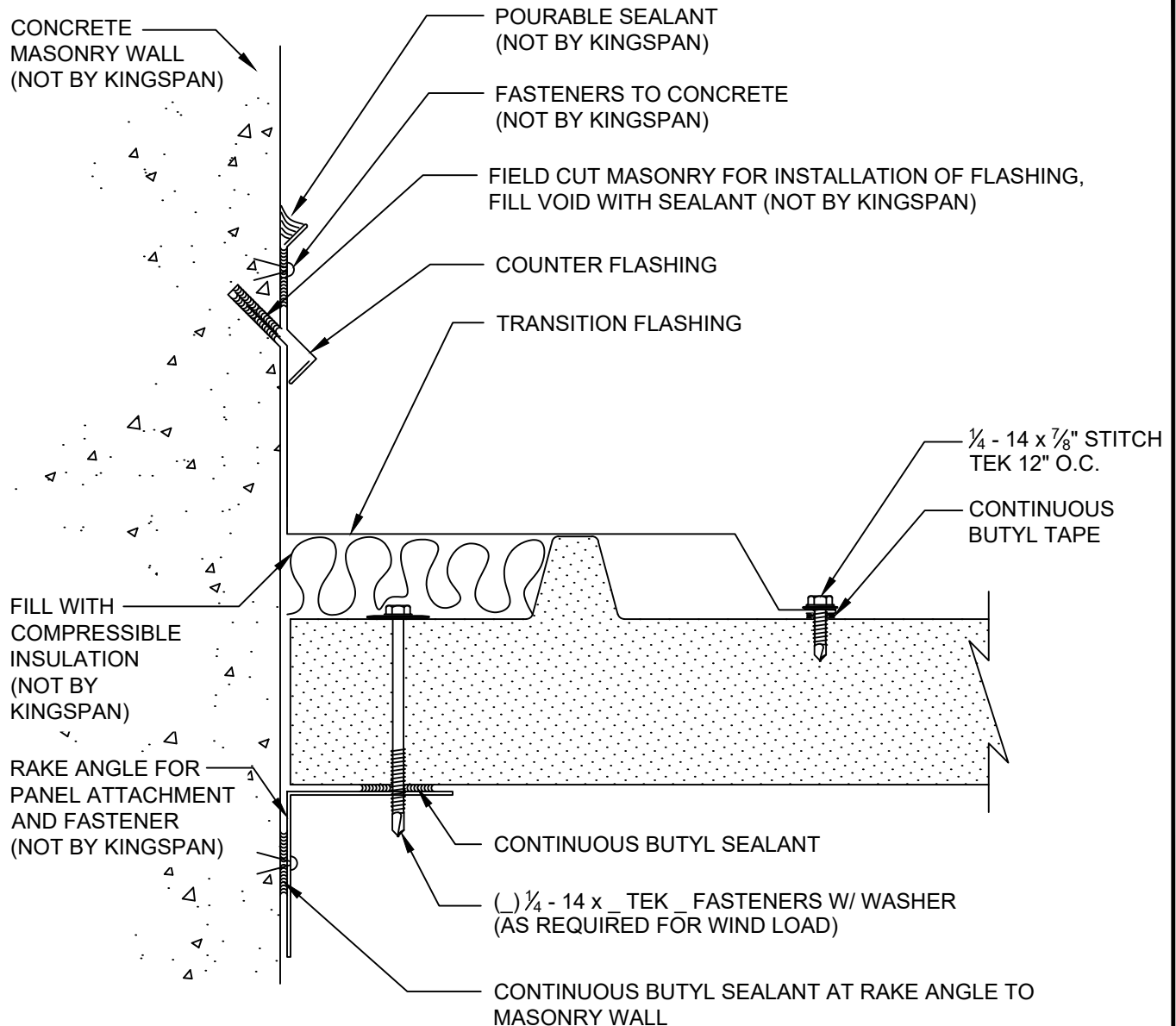

REVISION	
REVISION #	DATE
0	01/01/21

CONCRETE WALL TO
ROOF

DETAIL #: CI-WR-04-KINGRIB

DATE: 2021

Kingspan
Insulated Panels

www.kingspanpanels.us
www.kingspanpanels.ca