

KSMF SERIES - HORIZONTAL INSTALLATION

STANDARD DETAILS ASSUME NON-COMBUSTIBLE CONSTRUCTION

* NOTATES FIRE-RATED CONSTRUCTION ASSEMBLY DETAILS

CI-DS-01-KSMF	C & I DISCLAIMER
CI-PJ-01-KSMF	EXPANDED PANEL JOINT
CI-PJ-02-KSMF	ENGAGED PANEL JOINT
CI-PJ-03-KSMF	INTERMEDIATE SUPPORT
*CI-PJ-04-KSMF	BUTT (VERTICAL) JOINT - 4" - 1HR
*CI-PJ-05-KSMF	BUTT (VERTICAL) JOINT - 6" - 2HR
*CI-PJ-06-KSMF	BUTT (VERTICAL) JOINT - 8" - 3HR
*CI-PJ-07-KSMF	BUTT (VERTICAL) JOINT INTERMEDIATE FASTENING
*CI-PJ-08-KSMF	BUTT (VERTICAL) JOINT ISOMETRIC
CI-BS-01-KSMF	BASE DETAIL - FLUSH
CI-BS-02-KSMF	BASE DETAIL - FLUSH (FIELD CUT)
CI-BS-03-KSMF	BASE DETAIL - NOTCHED CONCRETE
CI-OC-01-KSMF	OUTSIDE CORNER WITH MITER JOINT
CI-OC-02-KSMF	OUTSIDE CORNER WITH BUTT JOINT
CI-OC-03-KSMF	OUTSIDE CORNER TRANSITION TO VERTICAL
CI-IC-01-KSMF	INSIDE CORNER WITH MITER JOINT
CI-IC-02-KSMF	INSIDE CORNER WITH BUTT JOINT
CI-IC-03-KSMF	INSIDE CORNER TRANSITION TO VERTICAL
CI-FO-01-KSMF	F.O. TWO PIECE HEAD
CI-FO-02-KSMF	F.O. HEAD WITH DRIP EDGE
CI-FO-03-KSMF	F.O. HEAD WITH W/ OPTIONAL DRIP EDGE
CI-FO-04-KSMF	F.O. TWO PIECE JAMB
CI-FO-05-KSMF	F.O. ONE PIECE JAMB
CI-FO-06-KSMF	F.O. ONE PIECE SILL
CI-FO-07-KSMF	O.H. DOOR TWO PIECE HEAD
CI-FO-08-KSMF	O.H. DOOR HEAD WITH DRIP EDGE
CI-FO-09-KSMF	O.H. DOOR TWO PIECE JAMB

INDEX SHEET 1

DETAIL #: XX-XX-XX-KSMF

DATE: 2020



www.kingspanpanels.us
www.kingspanpanels.ca

KSMF SERIES - HORIZONTAL INSTALLATION

CI-PR-01-KSMF	FIELD CUT PARAPET WITH FLUSH TRIM
CI-PR-02-KSMF	FIELD CUT PARAPET WITH PROFILED TRIM
CI-PR-03-KSMF	PARAPET WITH FLUSH TRIM
CI-PR-04-KSMF	PARAPET WITH PROFILED TRIM
*CI-IP-01-KSMF	INTERIOR PARTITION HEAD
CI-IP-02-KSMF	INTERIOR PARTITION BASE
*CI-IP-03-KSMF	INTERIOR PARTITION END WALL
CI-TL-01-KSMF	TRIM END LAP
CI-TL-02-KSMF	TRIM END LAP WITH HEM
CI-TL-03-KSMF	TRIM END LAP WITH LAP STRIP
CI-TL-04-KSMF	TRIM LAP AT F.O.
CI-TL-05-KSMF	MENDING PLATE "SHINGLE" LAP
CI-TL-06-KSMF	WALL PENETRATION
CI-PE-01-KSMF	PENETRATION DETAIL PIPE
CI-PE-02-KSMF	PENETRATION DETAIL TUBE/HSS
CI-PE-03-KSMF	PENETRATION DETAIL BEAM
CI-PE-04-KSMF	PENETRATION DETAIL BEAM SECTION

INDEX SHEET 2

DETAIL #: XX-XX-XX-KSMF

DATE: 2020



www.kingspanpanels.us
www.kingspanpanels.ca

KSMF SERIES - HORIZONTAL INSTALLATION

DISCLAIMERS:

THESE DETAILS ARE PROVIDED AS A GUIDELINE FOR PROPER PANEL AND ASSOCIATED COMPONENT INSTALLATION, AND ARE BASED ON INDUSTRY ACCEPTED PRACTICES.

LOCATION OF VAPOR BARRIERS AND ASSOCIATED SEALANTS IN THESE DETAILS ARE BASED ON TYPICAL DESIGN PRACTICES FOR MOST U.S. AND CANADIAN CLIMACTIC ZONES. (THE PRIMARY VAPOR BARRIER IS PLACED ON THE "WARM" SIDE IN WINTER).

PROJECTS LOCATED IN AREAS SUBJECT TO EXTREME COLD AND/OR HIGH SNOW LOADS MAY REQUIRE MODIFICATIONS TO THESE DETAILS - CONTACT KINGSPAN TECHNICAL SERVICES FOR SPECIFIC PROJECT RECOMMENDATIONS.

ALL STRUCTURAL SUPPORTS ARE NOT BY KINGSPAN AND ARE SHOWN FOR CLARIFICATION AND ILLUSTRATION PURPOSES ONLY.

CONTACT KINGSPAN TECHNICAL SERVICES FOR MAXIMUM ALLOWABLE PANEL SPANS AND FASTENING PATTERNS.

COMMERCIAL/INDUSTRIAL
DISCLAIMER

DETAIL #: CI-DS-01-KSMF

DATE: 2020



www.kingspanpanels.us
www.kingspanpanels.ca

KSMF SERIES - HORIZONTAL INSTALLATION

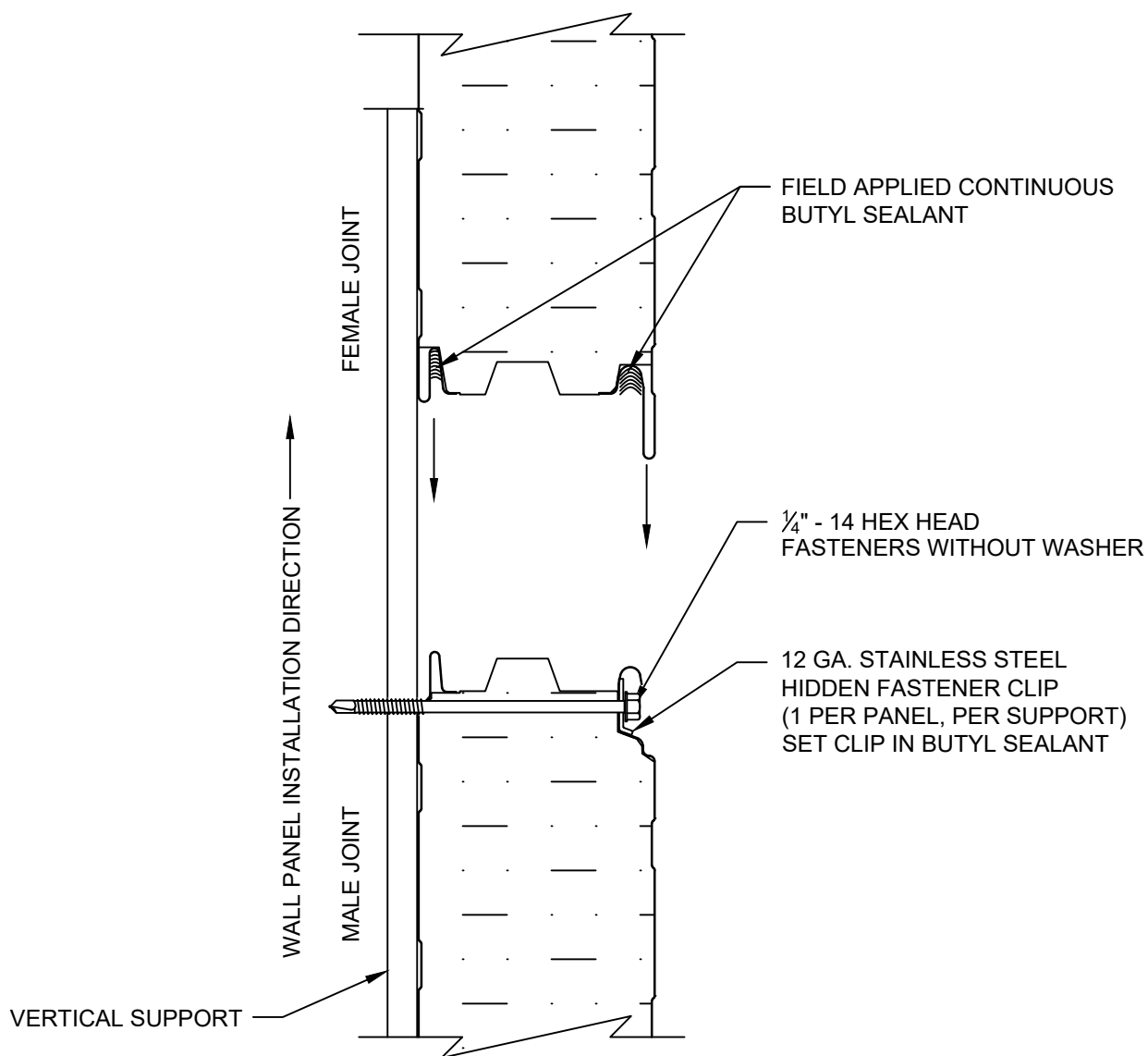

NOTES:

- 1) FACTORY CAULKING OF PANEL JOINTS NOT AVAILABLE WITH BUTYL SEALANT.
- 2) JOINT SEALANT NOT REQUIRED FOR FIRE RATING.

KSMF EXPANDED PANEL
JOINT

DETAIL #: CI-PJ-01-KSMF

DATE: 2020



www.kingspanpanels.us
www.kingspanpanels.ca

KSMF SERIES - HORIZONTAL INSTALLATION

FOR 3 HR RATING - 1 ½" LONG STEEL OR STAINLESS STEEL #13 FASTENER SHALL BE INSTALLED AT PANEL JOINTS ON BOTH SIDES OF THE WALL @ 12" O.C.

FOR 1 AND 2HR RATING - A 1 ½" LONG STEEL OR STAINLESS STEEL #13 FASTENER SHALL BE INSTALLED AT PANEL JOINTS ON BOTH SIDES OF THE WALL, RIGHT AND LEFT PANEL END ONLY.

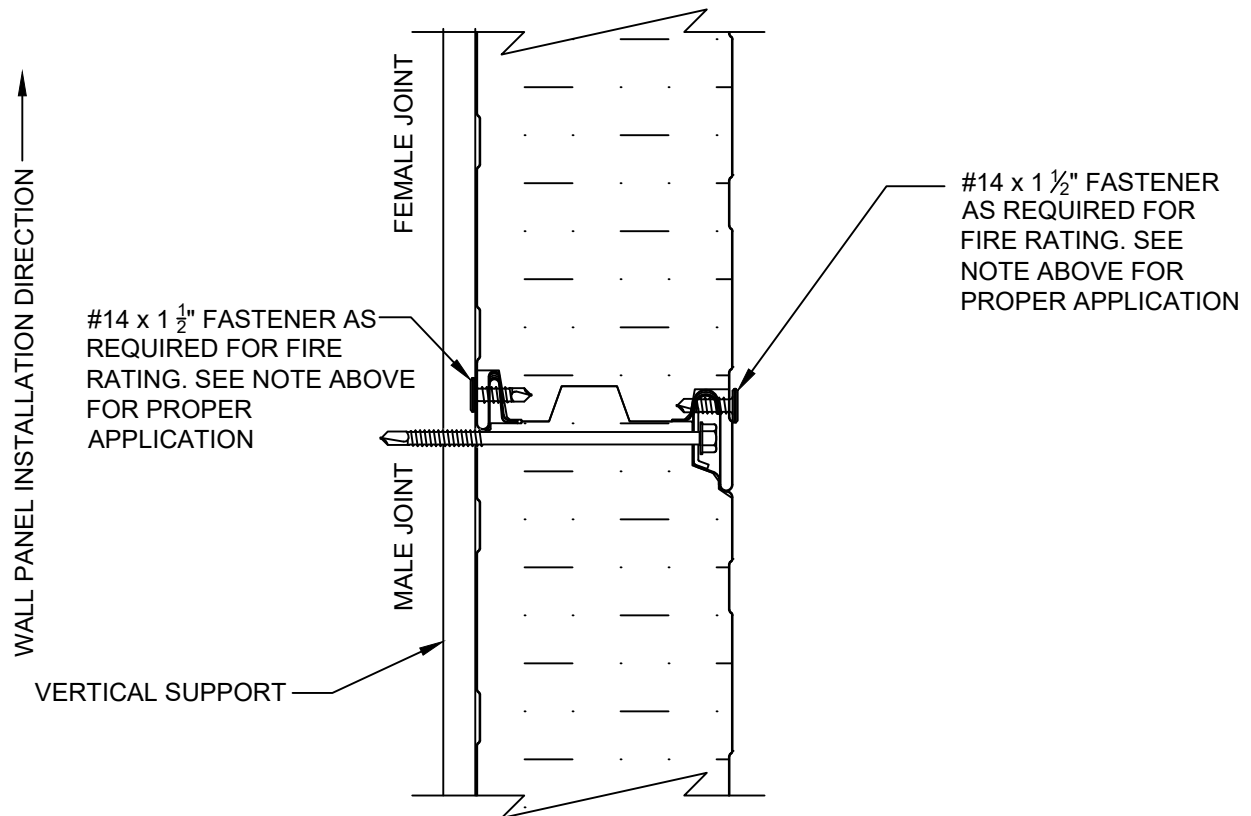

KSMF
ENGAGED PANEL JOINT

DETAIL #: CI-PJ-02-KSMF

DATE: 2020



Kingspan
Insulated Panels

www.kingspanpanels.us
www.kingspanpanels.ca

KS42 MF SERIES - HORIZONTAL INSTALLATION

FOR 3 HR RATING - 1 ½" LONG STEEL OR STAINLESS STEEL #13 FASTENER SHALL BE INSTALLED AT PANEL JOINTS ON BOTH SIDES OF THE WALL @ 12" O.C.

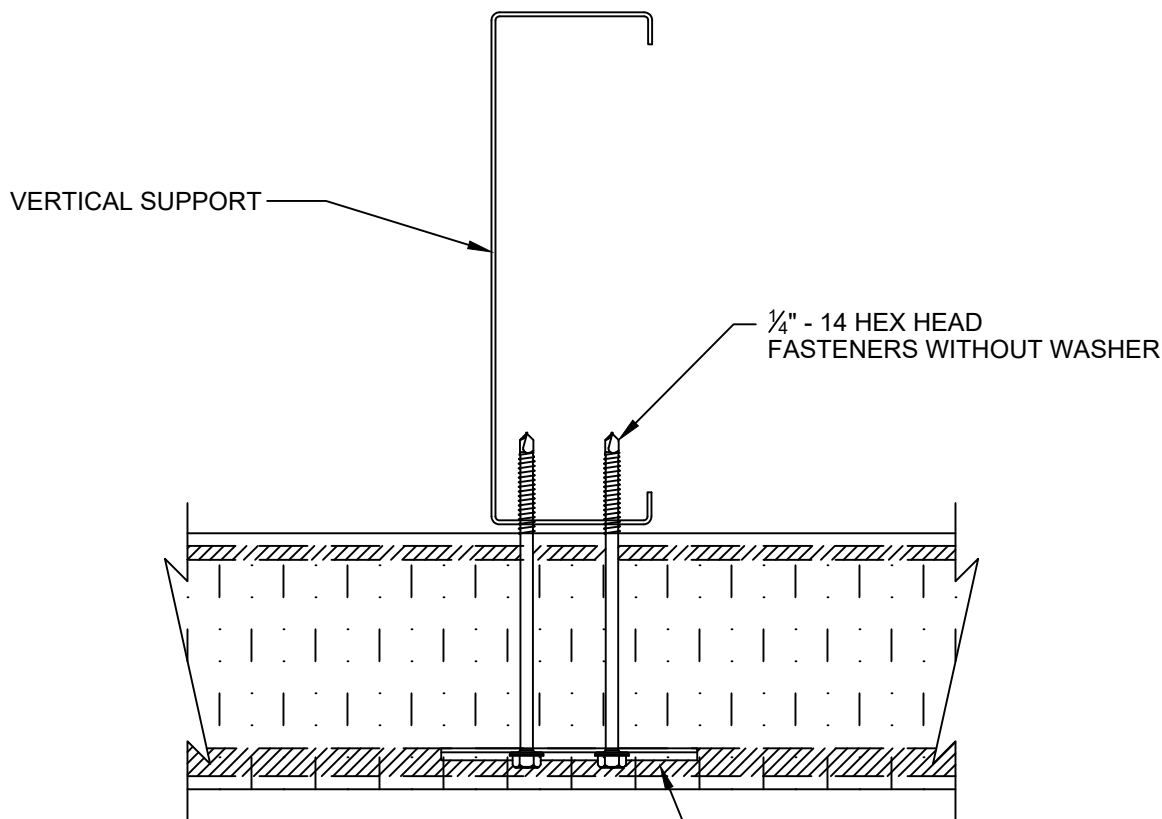
FOR 1 AND 2HR RATING - A 1 ½" LONG STEEL OR STAINLESS STEEL #13 FASTENER SHALL BE INSTALLED AT PANEL JOINTS ON BOTH SIDES OF THE WALL, RIGHT AND LEFT PANEL END ONLY.



NOTE: SEE NOTE ABOVE FOR PROPER FASTENER APPLICATION

12 GA. STAINLESS STEEL
HIDDEN FASTENER CLIP
(1 PER PANEL, PER SUPPORT)
SET CLIP IN BUTYL SEALANT

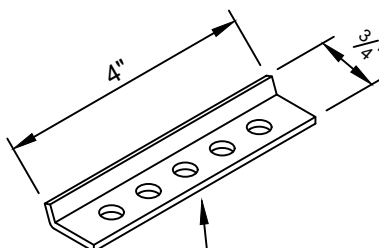

12 GA. STAINLESS STEEL
5-HOLE HIDDEN FASTENER CLIP
(1 PER PANEL, PER SUPPORT)

KSMF INTERMEDIATE
FASTENING

DETAIL #: CI-PJ-03-KSMF

DATE: 2020

Kingspan
Insulated Panels

www.kingspanpanels.us
www.kingspanpanels.ca

KSMF SERIES - HORIZONTAL INSTALLATION

ULC S101 REQUIREMENT

FOR 3 HR RATING - 1 ½" LONG STEEL OR STAINLESS STEEL#13 FASTENER SHALL BE INSTALLED AT PANEL JOINTS ON BOTH SIDES OF THE WALL @ 12" O.C.

FOR 1 AND 2HR RATING - A 1 ½" LONG STEEL OR STAINLESS STEEL#13 FASTENER SHALL BE INSTALLED AT PANEL JOINTS ON BOTH SIDES OF THE WALL, RIGHT AND LEFT PANEL END ONLY.

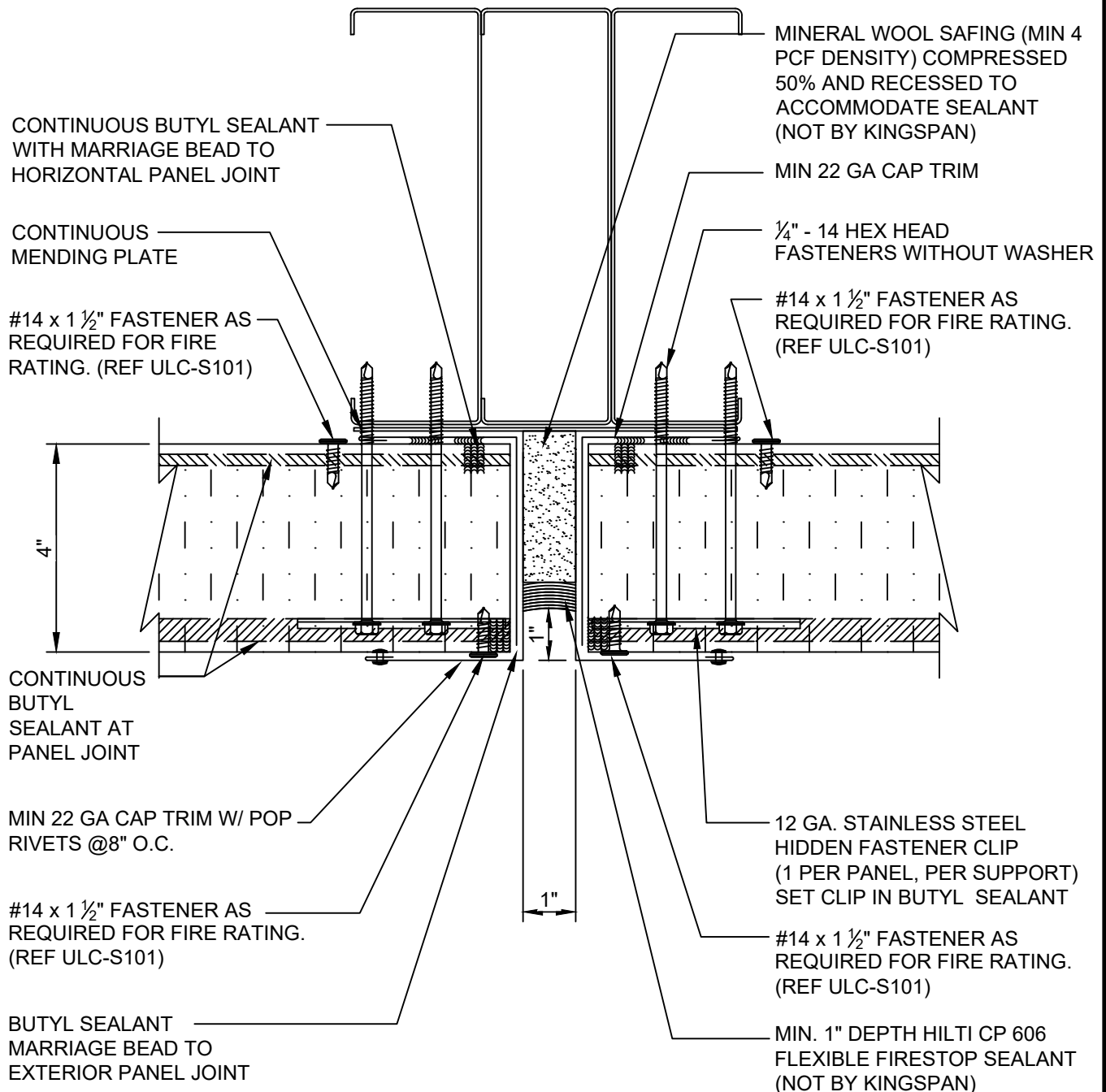

KS4MF BUTT JOINT
(1 HR RATED - 4")

DETAIL #: CI-PJ-04-KSMF

DATE: 2020



www.kingspanpanels.us
www.kingspanpanels.ca

KSMF SERIES - HORIZONTAL INSTALLATION

ULC S101 REQUIREMENT

FOR 3 HR RATING - 1 ½" LONG STEEL OR STAINLESS STEEL #13 FASTENER SHALL BE INSTALLED AT PANEL JOINTS ON BOTH SIDES OF THE WALL @ 12" O.C.

FOR 1 AND 2HR RATING - A 1 ½" LONG STEEL OR STAINLESS STEEL #13 FASTENER SHALL BE INSTALLED AT PANEL JOINTS ON BOTH SIDES OF THE WALL, RIGHT AND LEFT PANEL END ONLY.

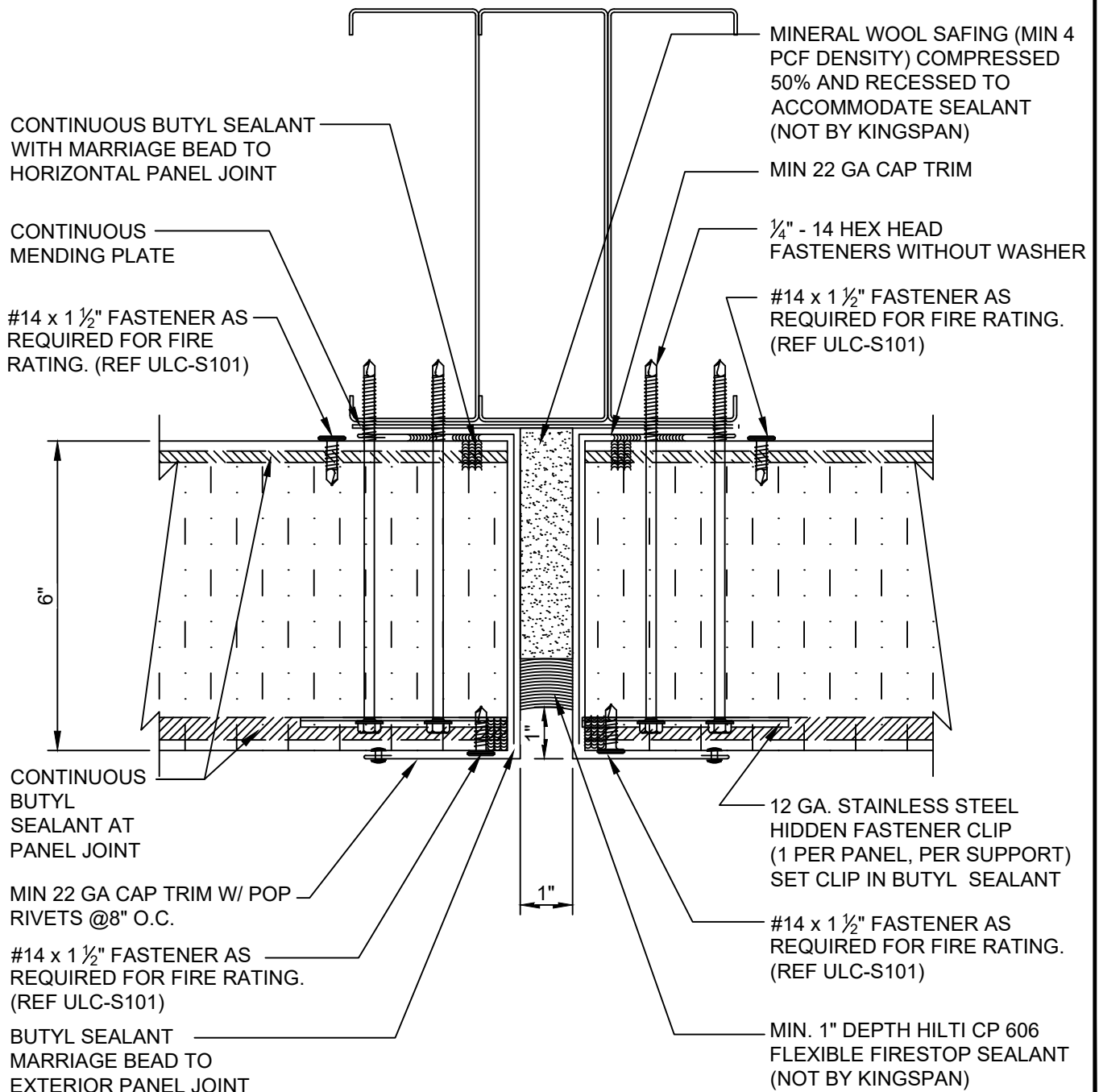

**KS4MF BUTT JOINT
(2 HR RATED - 6")**

DETAIL #: CI-PJ-05-KSMF

DATE: 2020

Kingspan
Insulated Panels

www.kingspanpanels.us
www.kingspanpanels.ca

KSMF SERIES - HORIZONTAL INSTALLATION

ULC S101 REQUIREMENT

FOR 3 HR RATING - 1 ½" LONG STEEL OR STAINLESS STEEL#13 FASTENER SHALL BE INSTALLED AT PANEL JOINTS ON BOTH SIDES OF THE WALL @ 12" O.C.

FOR 1 AND 2HR RATING - A 1 ½" LONG STEEL OR STAINLESS STEEL#13 FASTENER SHALL BE INSTALLED AT PANEL JOINTS ON BOTH SIDES OF THE WALL, RIGHT AND LEFT PANEL END ONLY.

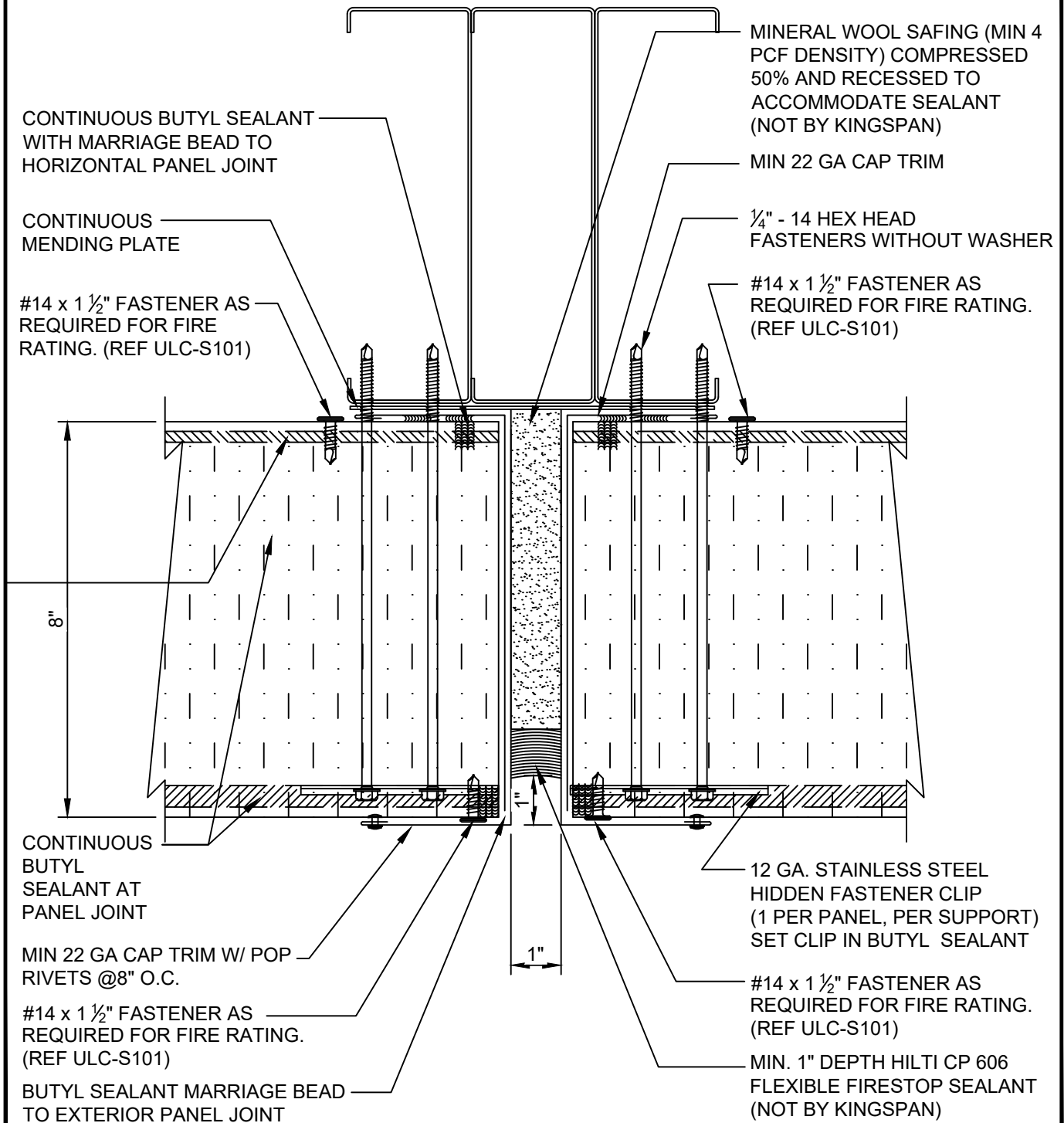

**KS4MF BUTT JOINT
(3 HR RATED - 8")**

DETAIL #: CI-PJ-06-KSMF

DATE: 2020



www.kingspanpanels.us
www.kingspanpanels.ca

KSMF SERIES - HORIZONTAL INSTALLATION

ULC S101 REQUIREMENT

FOR 3 HR RATING - 1 ½" LONG STEEL OR STAINLESS STEEL #13 FASTENER SHALL BE INSTALLED AT PANEL JOINTS ON BOTH SIDES OF THE WALL @ 12" O.C.

FOR 1 AND 2HR RATING - A 1 ½" LONG STEEL OR STAINLESS STEEL #13 FASTENER SHALL BE INSTALLED AT PANEL JOINTS ON BOTH SIDES OF THE WALL, RIGHT AND LEFT PANEL END ONLY.

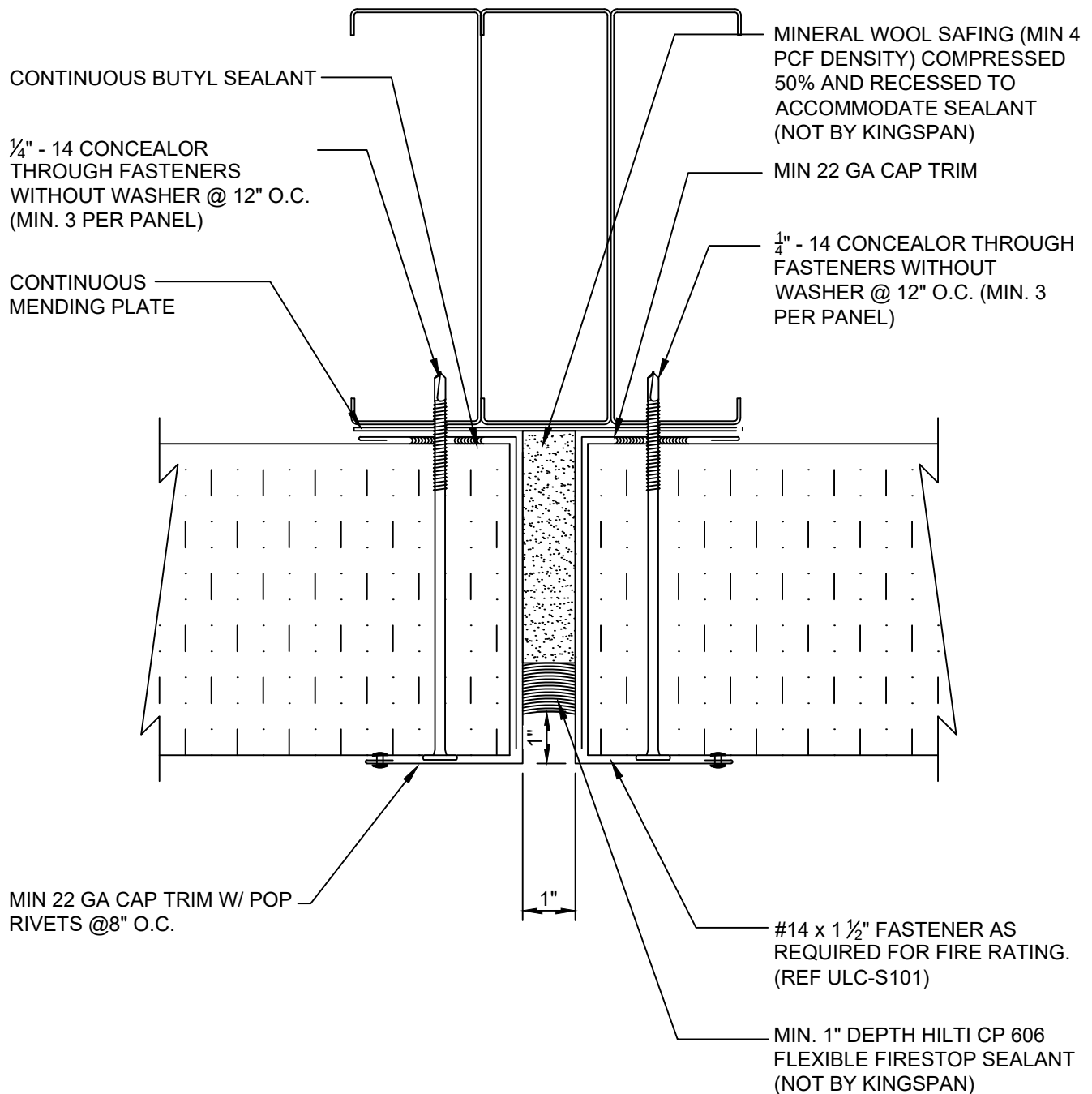

KS4MF
BUTT JOINT INTERMEDIATE
FASTENING

DETAIL #: CI-PJ-07-KSMF

DATE: 2020



www.kingspanpanels.us
www.kingspanpanels.ca

KSMF SERIES - HORIZONTAL INSTALLATION

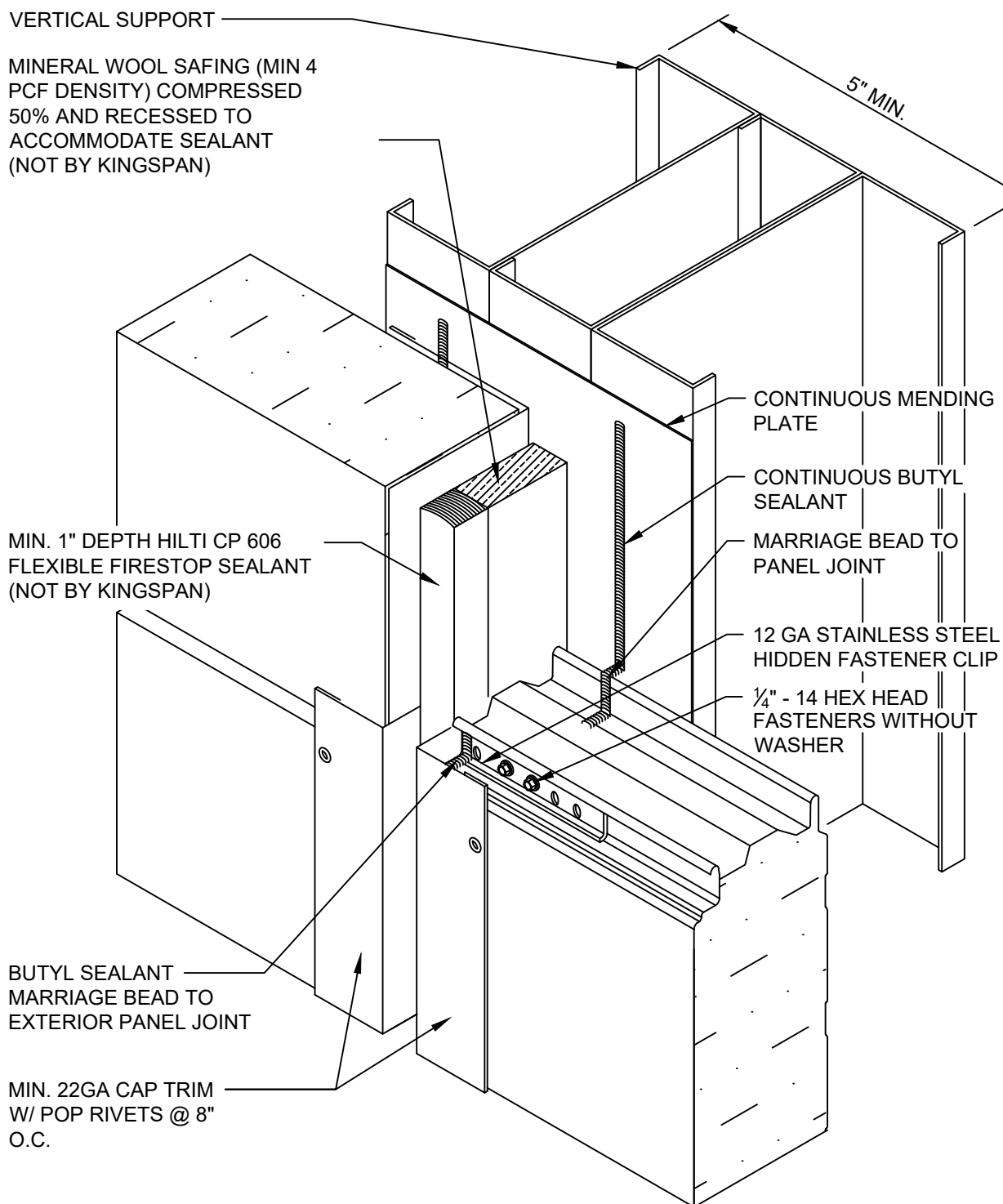

KSMF BUTT JOINT ISOMETRIC

DETAIL #: CI-PJ-08-KSMF

DATE: 2020



www.kingspanpanels.us
www.kingspanpanels.ca

KSMF SERIES - HORIZONTAL INSTALLATION

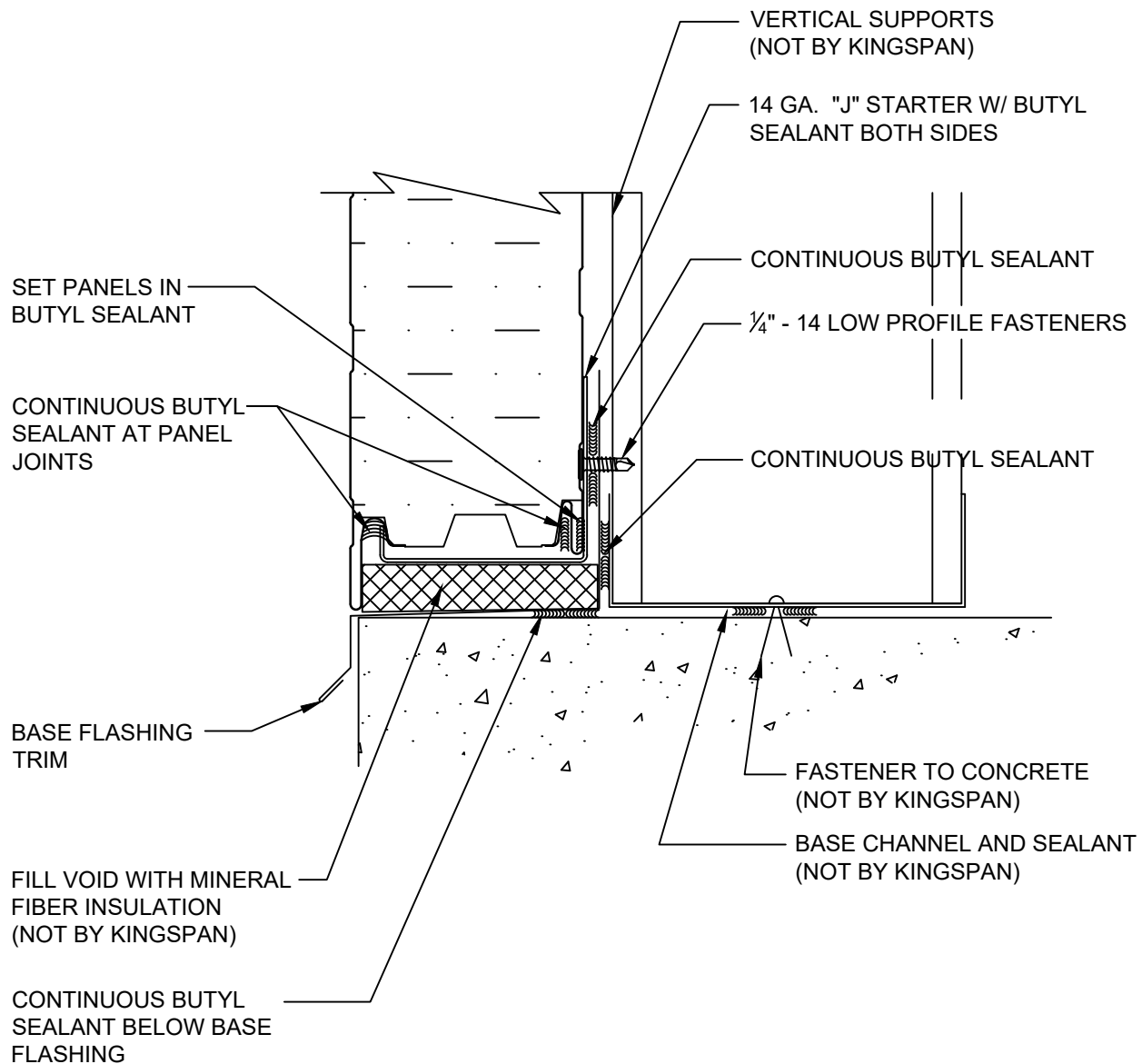

BASE DETAIL- FLUSH

DETAIL #: CI-BS-01-KSMF

DATE: 2020

Kingspan
Insulated Panels

www.kingspanpanels.us
www.kingspanpanels.ca

KSMF SERIES - HORIZONTAL INSTALLATION

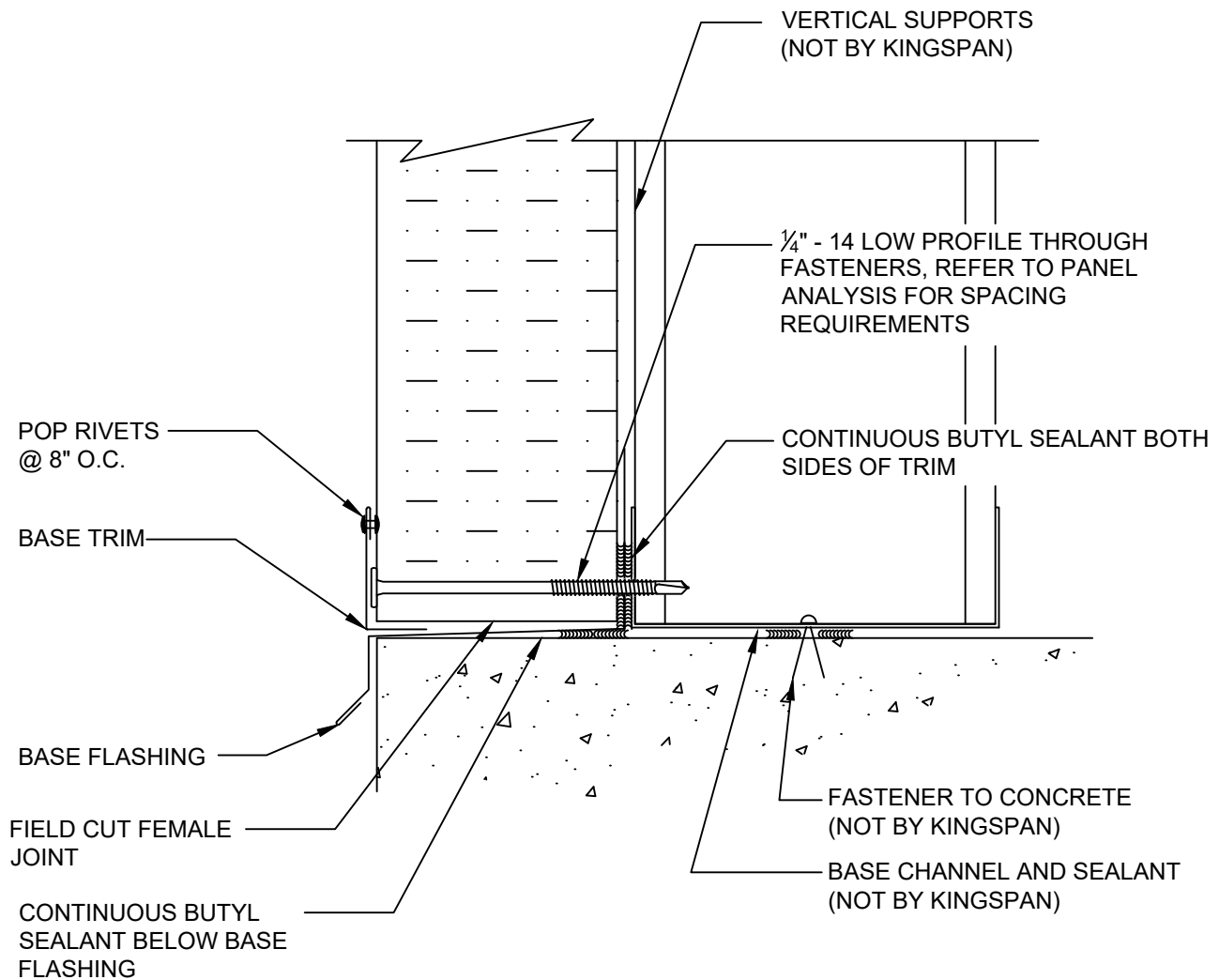

**BASE DETAIL - FLUSH
(FIELD CUT)**

DETAIL #: CI-BS-02-KSMF

DATE: 2020



www.kingspanpanels.us
www.kingspanpanels.ca

KSMF SERIES - HORIZONTAL INSTALLATION

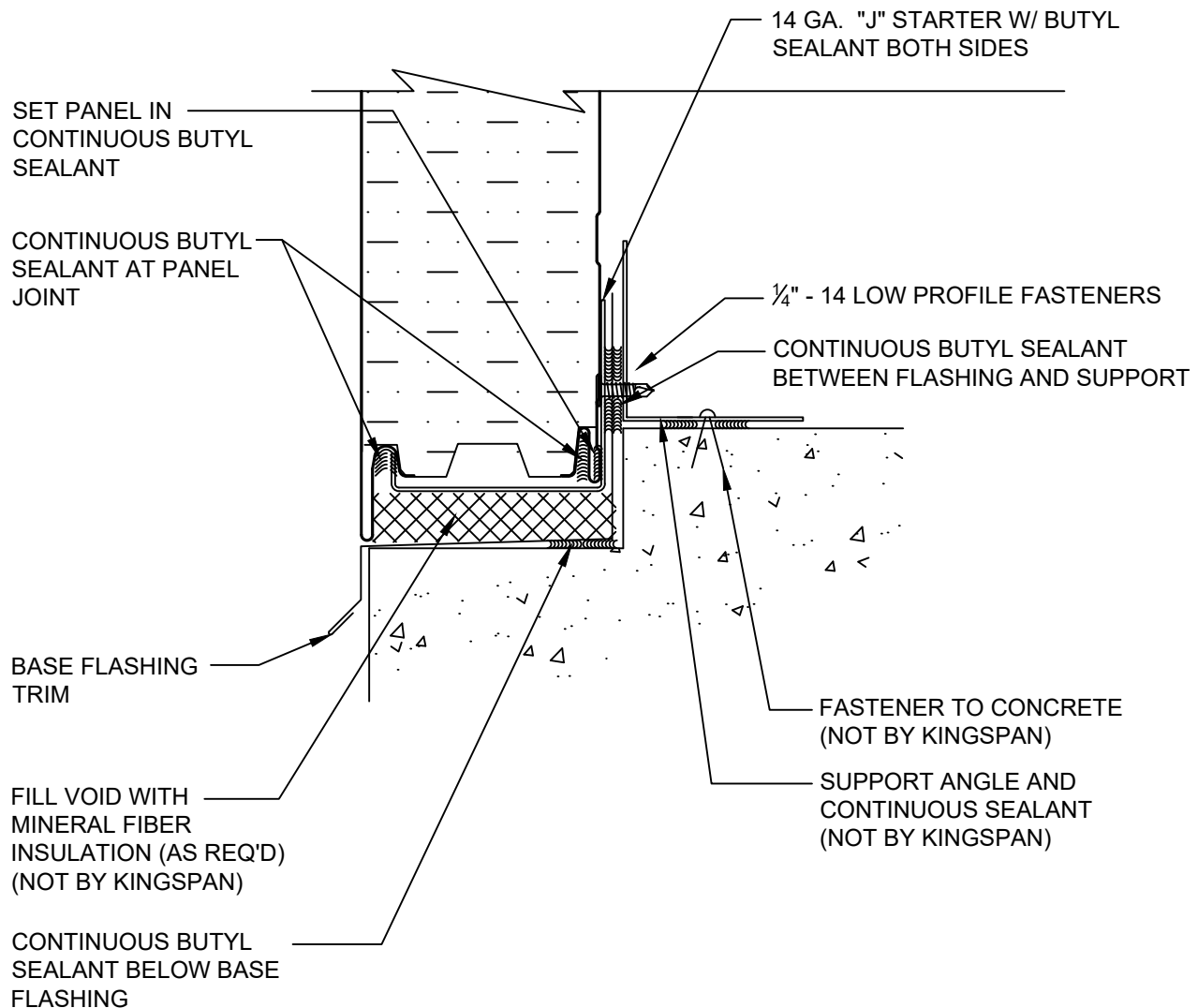

BASE DETAIL -
NOTCHED CONCRETE

DETAIL #: CI-BS-03-KSMF

DATE: 2020



Kingspan
Insulated Panels

www.kingspanpanels.us
www.kingspanpanels.ca

KSMF SERIES - HORIZONTAL INSTALLATION

FOR 3 HR RATING - 1 ½" LONG STEEL OR STAINLESS STEEL #13 FASTENER SHALL BE INSTALLED AT PANEL JOINTS ON BOTH SIDES OF THE WALL @ 12" O.C.

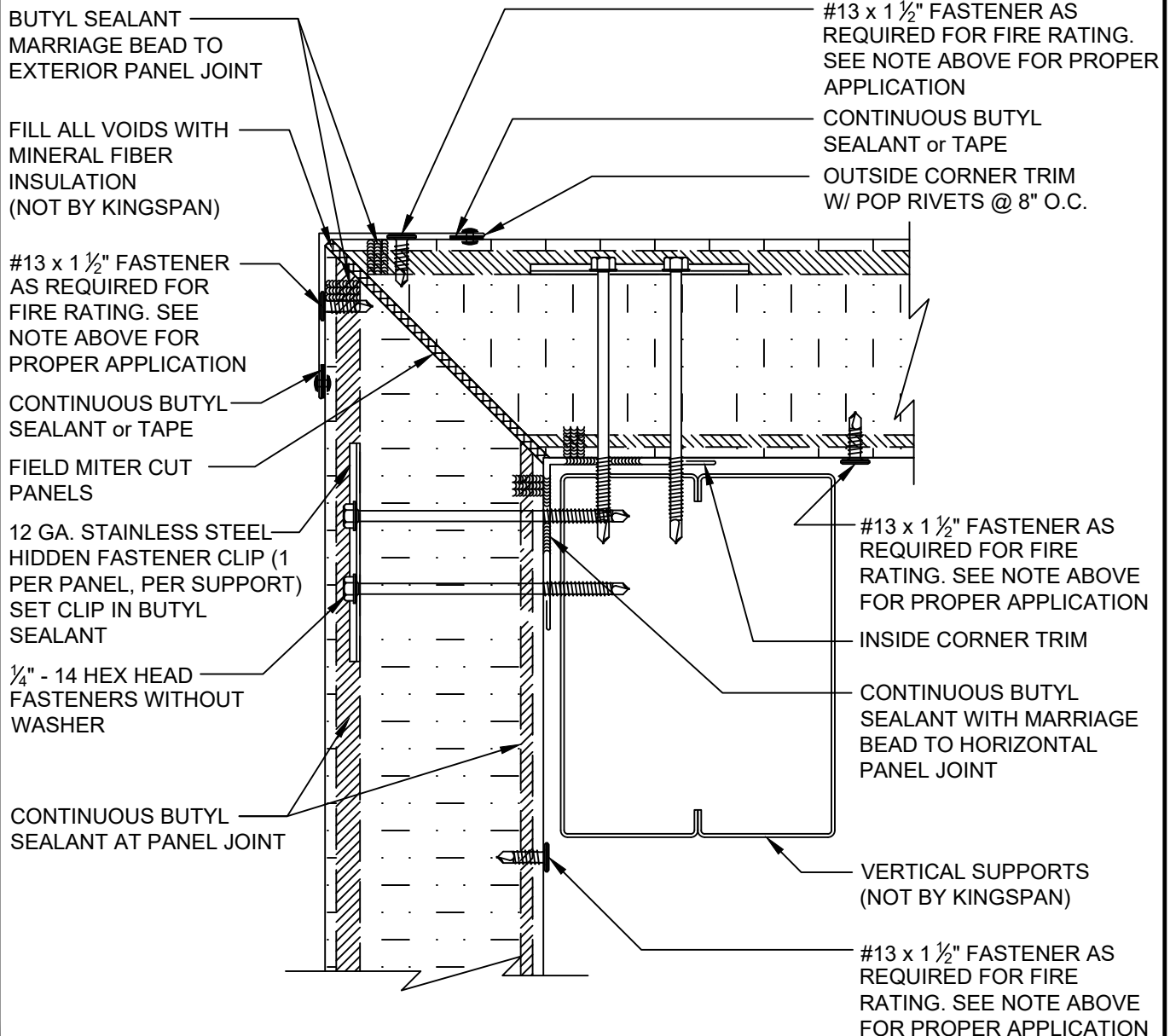
FOR 1 AND 2HR RATING - A 1 ½" LONG STEEL OR STAINLESS STEEL #13 FASTENER SHALL BE INSTALLED AT PANEL JOINTS ON BOTH SIDES OF THE WALL, RIGHT AND LEFT PANEL END ONLY.



OUTSIDE CORNER
W/ FIELD MITERED PANEL

DETAIL #: CI-OC-01-KSMF

DATE: 2020



www.kingspanpanels.us
www.kingspanpanels.ca

KSMF SERIES - HORIZONTAL INSTALLATION

FOR 3 HR RATING - 1 ½" LONG STEEL OR STAINLESS STEEL #13 FASTENER SHALL BE INSTALLED AT PANEL JOINTS ON BOTH SIDES OF THE WALL @ 12" O.C.

FOR 1 AND 2HR RATING - A 1 ½" LONG STEEL OR STAINLESS STEEL #13 FASTENER SHALL BE INSTALLED AT PANEL JOINTS ON BOTH SIDES OF THE WALL, RIGHT AND LEFT PANEL END ONLY.

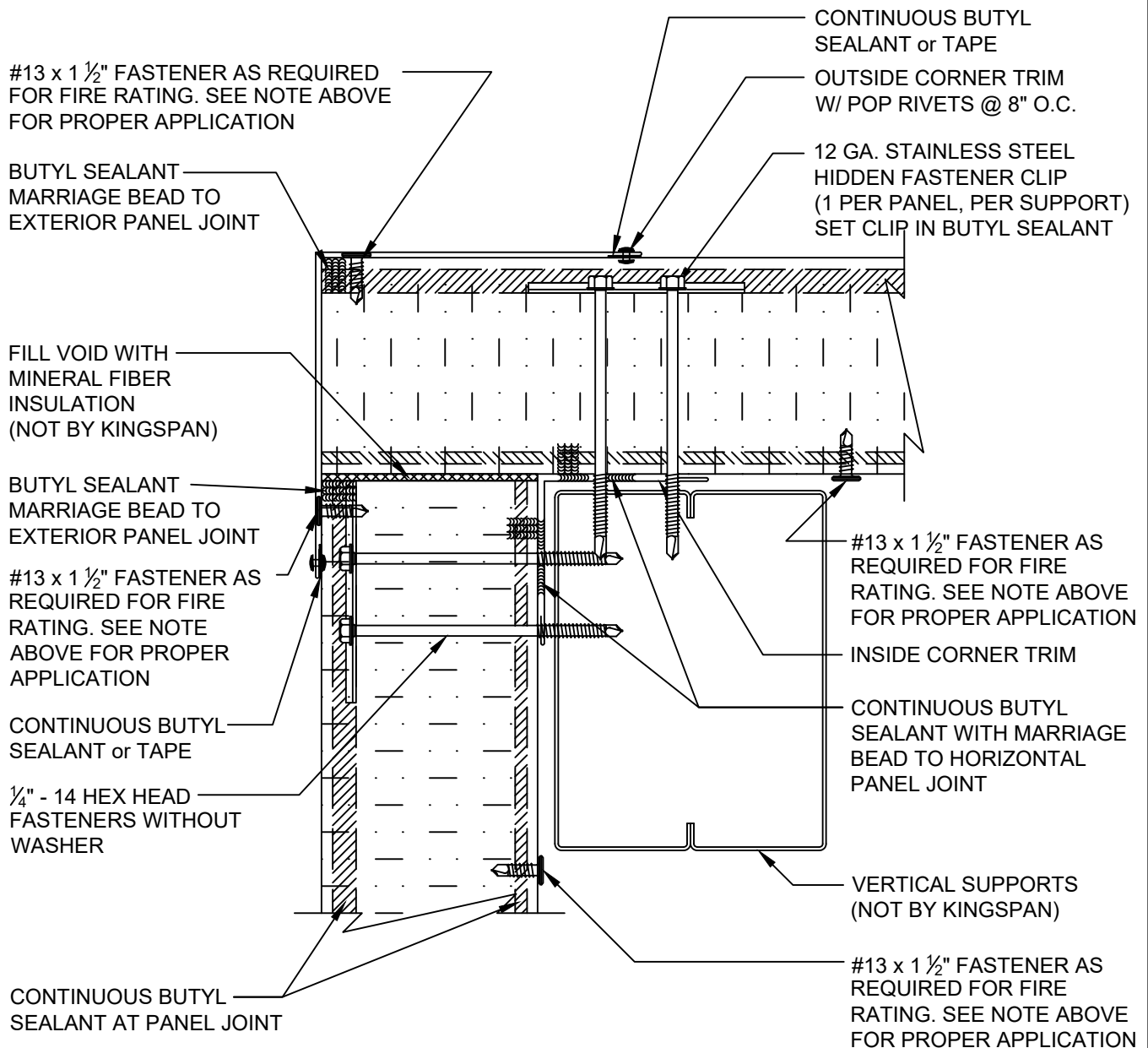

OUTSIDE CORNER -
BUTT JOINT

DETAIL #: CI-OC-02-KSMF

DATE: 2020



www.kingspanpanels.us
www.kingspanpanels.ca

KSMF SERIES - HORIZONTAL INSTALLATION

FOR 1 AND 2HR RATING - A 1 1/2" LONG STEEL OR STAINLESS STEEL #13 FASTENER SHALL BE INSTALLED AT PANEL JOINTS ON BOTH SIDES OF THE WALL, RIGHT AND LEFT PANEL END ONLY.

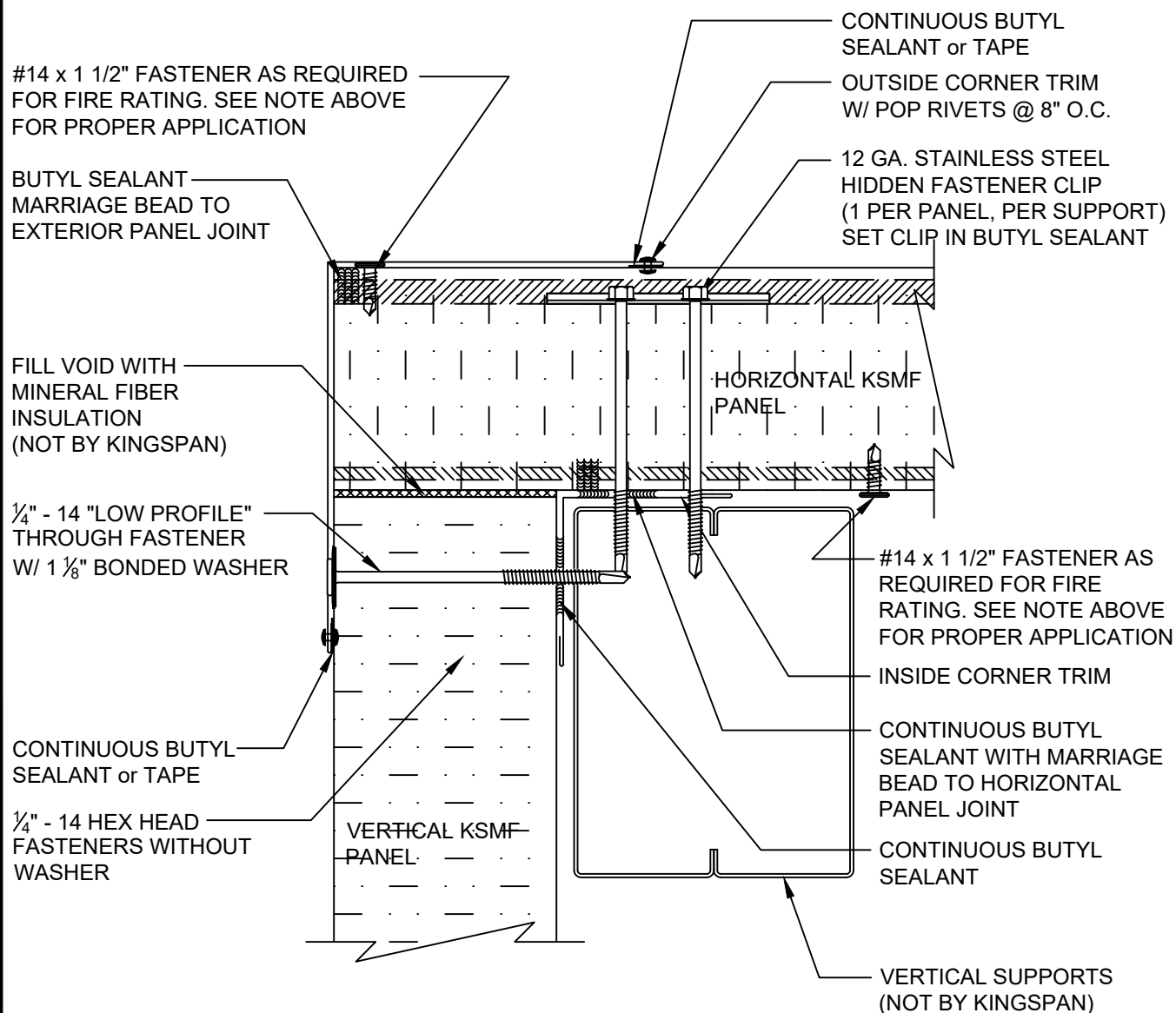

OUTSIDE CORNER TRANSITION TO VERTICAL PANEL

DETAIL #: CI-OC-03-KSMF

DATE: 2020



www.kingspanpanels.us
www.kingspanpanels.ca

KSMF SERIES - HORIZONTAL INSTALLATION

FOR 3 HR RATING - 1 ½" LONG STEEL OR STAINLESS STEEL #13 FASTENER SHALL BE INSTALLED AT PANEL JOINTS ON BOTH SIDES OF THE WALL @ 12" O.C.

FOR 1 AND 2HR RATING - A 1 ½" LONG STEEL OR STAINLESS STEEL #13 FASTENER SHALL BE INSTALLED AT PANEL JOINTS ON BOTH SIDES OF THE WALL, RIGHT AND LEFT PANEL END ONLY.

#13 x 1 ½" FASTENER AS REQUIRED FOR FIRE RATING. SEE NOTE ABOVE FOR PROPER APPLICATION

BUTYL SEALANT MARRIAGE BEAD TO EXTERIOR PANEL JOINT

MIN 8PCF COMPRESSED MINERAL FIBER (NOT BY KINGSPAN)

HILTI CFS-S SIL GG FIRESTOP SILICONE SEALANT MINIMUM 5/8" DEPTH (NOT BY KINGSPAN)

BUTYL SEALANT MARRIAGE BEAD TO EXTERIOR PANEL JOINT

#13 x 1 ½" FASTENER AS REQUIRED FOR FIRE RATING. SEE NOTE ABOVE FOR PROPER APPLICATION

CONTINUOUS BUTYL SEALANT or TAPE

¼" - 14 HEX HEAD FASTENERS WITHOUT WASHER

CONTINUOUS BUTYL SEALANT AT PANEL JOINT

CONTINUOUS BUTYL SEALANT or TAPE

OUTSIDE CORNER TRIM W/ POP RIVETS @ 8" O.C.

12 GA. STAINLESS STEEL HIDDEN FASTENER CLIP (1 PER PANEL, PER SUPPORT) SET CLIP IN BUTYL SEALANT

#13 x 1 ½" FASTENER AS REQUIRED FOR FIRE RATING. SEE NOTE ABOVE FOR PROPER APPLICATION

INSIDE CORNER TRIM

CONTINUOUS BUTYL SEALANT WITH MARRIAGE BEAD TO HORIZONTAL PANEL JOINT

VERTICAL SUPPORTS (NOT BY KINGSPAN)

#13 x 1 ½" FASTENER AS REQUIRED FOR FIRE RATING. SEE NOTE ABOVE FOR PROPER APPLICATION

OUTSIDE CORNER

DETAIL #: CI-OC-04-KSMF

DATE: 2020

Kingspan
Insulated Panels

www.kingspanpanels.us
www.kingspanpanels.ca

KSMF SERIES - HORIZONTAL INSTALLATION

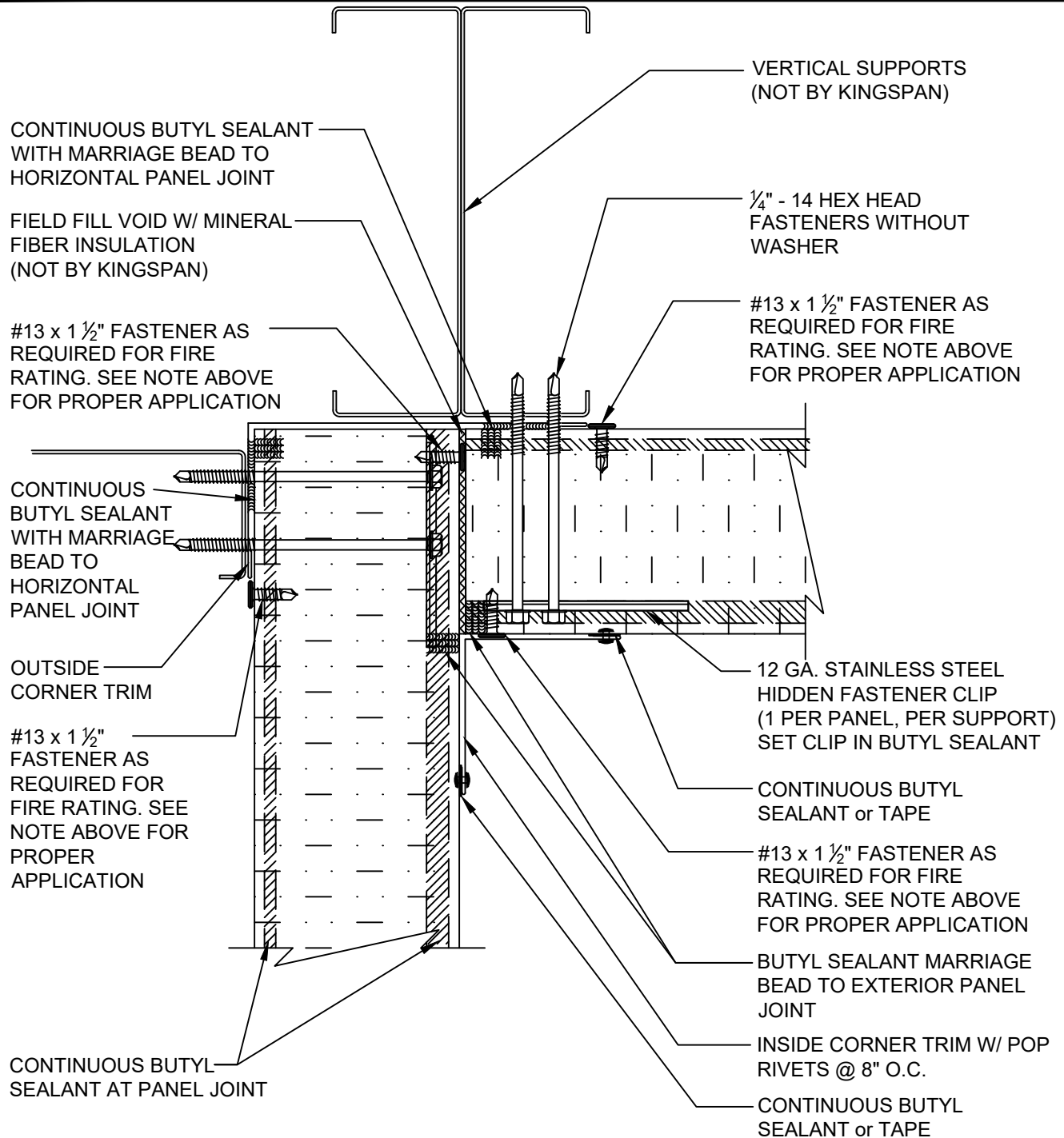

FOR 3 HR RATING - 1 1/2" LONG STEEL OR STAINLESS STEEL #13 FASTENER SHALL BE INSTALLED AT PANEL JOINTS ON BOTH SIDES OF THE WALL @ 12" O.C.

FOR 1 AND 2HR RATING - A 1 1/2" LONG STEEL OR STAINLESS STEEL #13 FASTENER SHALL BE INSTALLED AT PANEL JOINTS ON BOTH SIDES OF THE WALL, RIGHT AND LEFT PANEL END ONLY.

INSIDE CORNER W/
BUTT JOINT PANEL

DETAIL #: CI-IC-01-KSMF

DATE: 2020



www.kingspanpanels.us
www.kingspanpanels.ca

KSMF SERIES - HORIZONTAL INSTALLATION

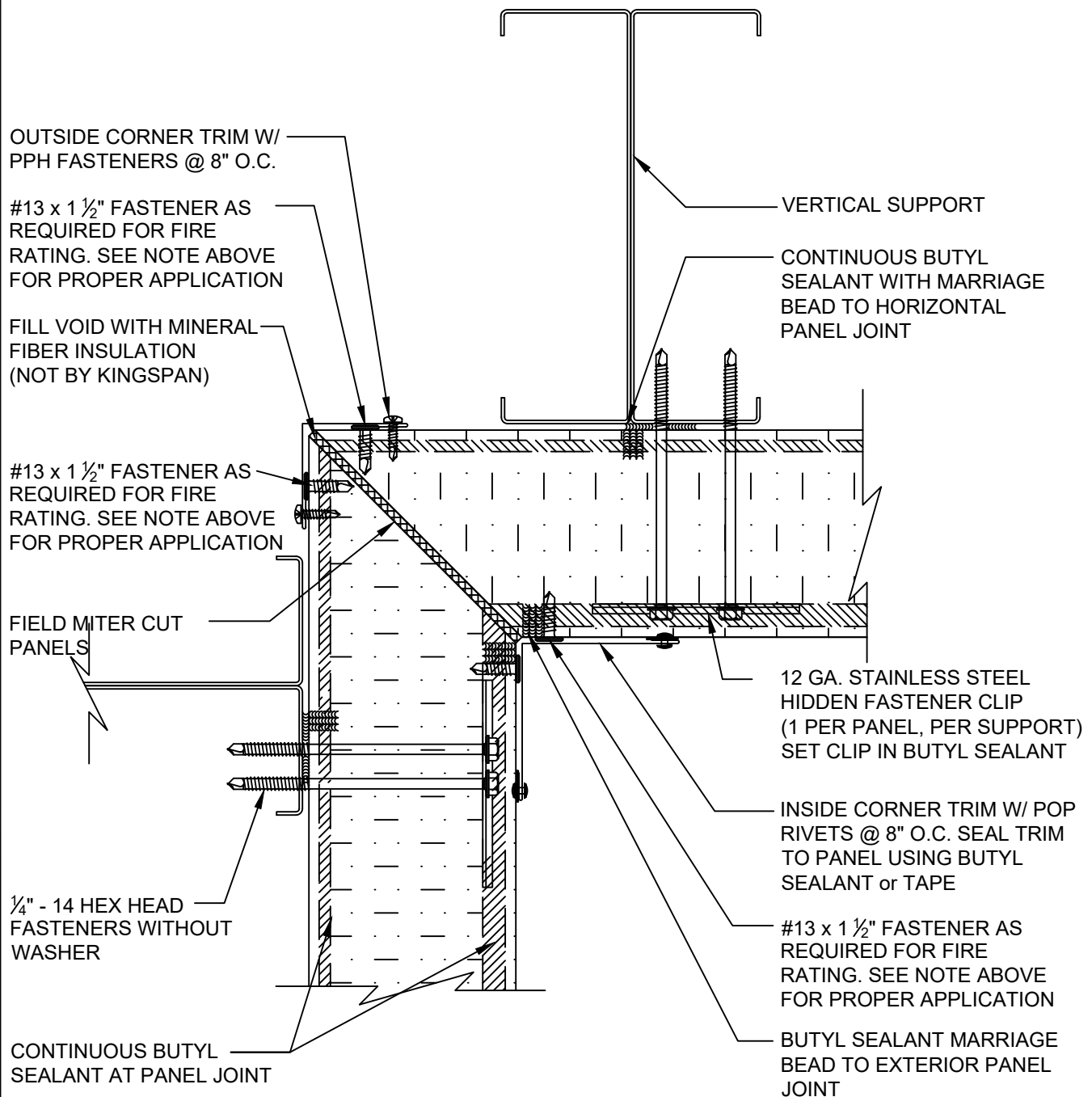

FOR 3 HR RATING - 1 1/2" LONG STEEL OR STAINLESS STEEL #13 FASTENER SHALL BE INSTALLED AT PANEL JOINTS ON BOTH SIDES OF THE WALL @ 12" O.C.

FOR 1 AND 2HR RATING - A 1 1/2" LONG STEEL OR STAINLESS STEEL #13 FASTENER SHALL BE INSTALLED AT PANEL JOINTS ON BOTH SIDES OF THE WALL, RIGHT AND LEFT PANEL END ONLY.

INSIDE CORNER W/
FIELD MITERED CORNER

DETAIL #: CI-IC-02-KSMF

DATE: 2020

Kingspan
Insulated Panels

www.kingspanpanels.us
www.kingspanpanels.ca

KSMF SERIES - HORIZONTAL INSTALLATION

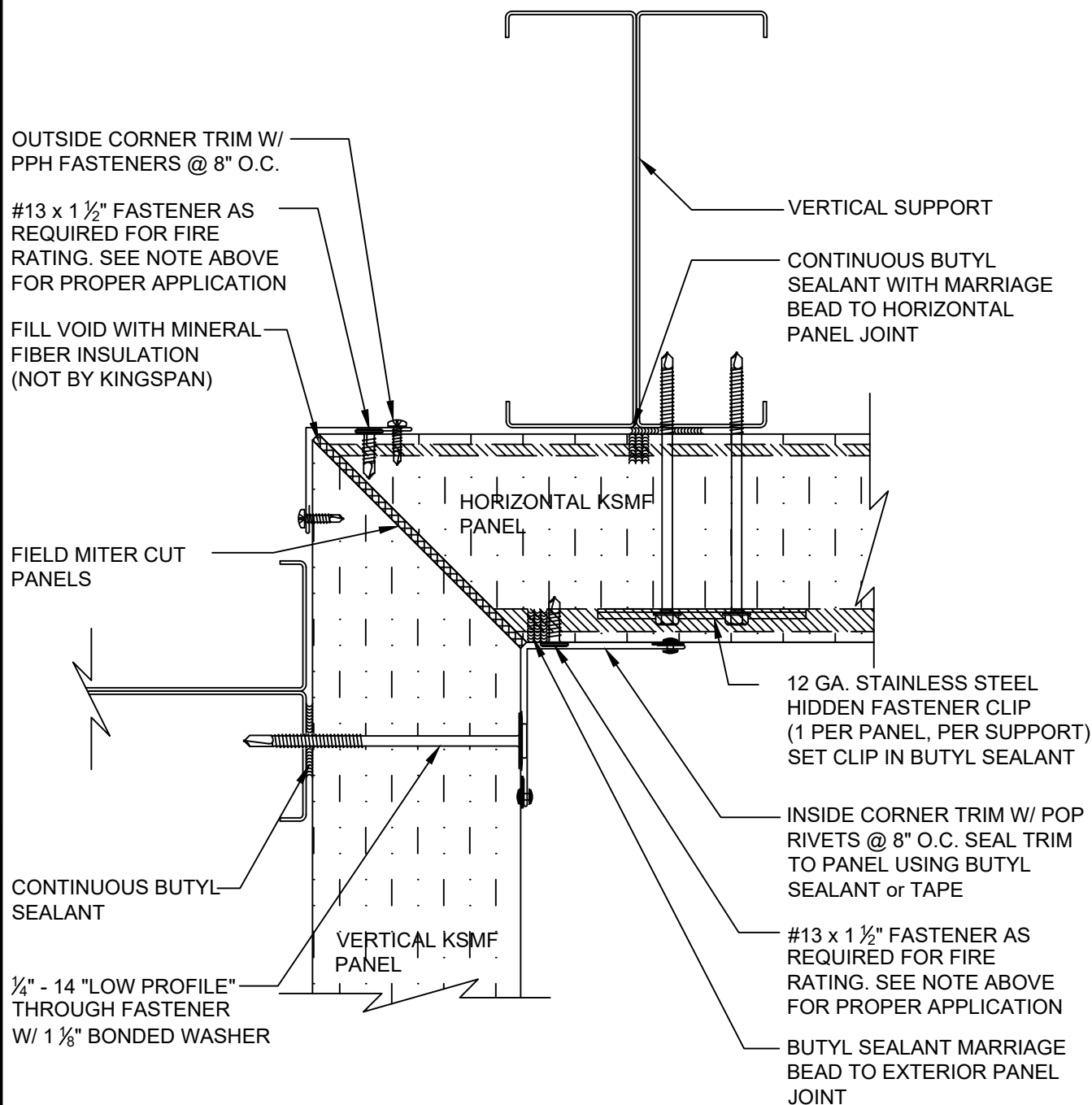

FOR 3 HR RATING - 1 1/2" LONG STEEL OR STAINLESS STEEL #13 FASTENER SHALL BE INSTALLED AT PANEL JOINTS ON BOTH SIDES OF THE WALL @ 12" O.C.

FOR 1 AND 2HR RATING - A 1 1/2" LONG STEEL OR STAINLESS STEEL #13 FASTENER SHALL BE INSTALLED AT PANEL JOINTS ON BOTH SIDES OF THE WALL, RIGHT AND LEFT PANEL END ONLY.

INSIDE CORNER
TRANSITION TO VERTICAL

DETAIL #: CI-IC-02-KSMF

DATE: 2020



www.kingspanpanels.us
www.kingspanpanels.ca

KSMF SERIES - HORIZONTAL INSTALLATION

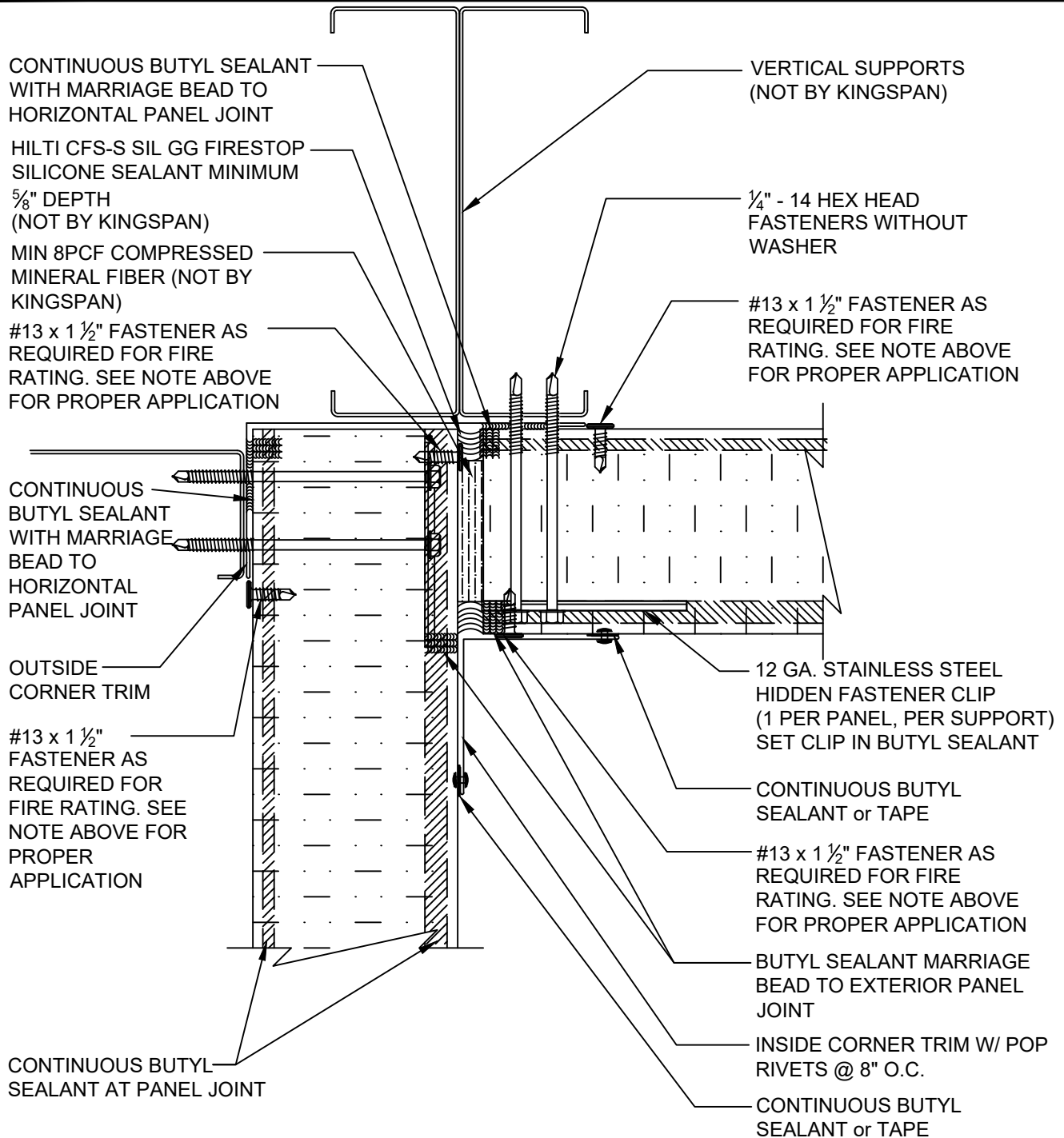

FOR 3 HR RATING - $1\frac{1}{2}$ " LONG STEEL OR STAINLESS STEEL #13 FASTENER SHALL BE INSTALLED AT PANEL JOINTS ON BOTH SIDES OF THE WALL @ 12" O.C.

FOR 1 AND 2HR RATING - A $1\frac{1}{2}$ " LONG STEEL OR STAINLESS STEEL #13 FASTENER SHALL BE INSTALLED AT PANEL JOINTS ON BOTH SIDES OF THE WALL, RIGHT AND LEFT PANEL END ONLY.

INSIDE CORNER

DETAIL #: CI-IC-04-KSMF

DATE: 2020



www.kingspanpanels.us
www.kingspanpanels.ca

KSMF SERIES - HORIZONTAL INSTALLATION

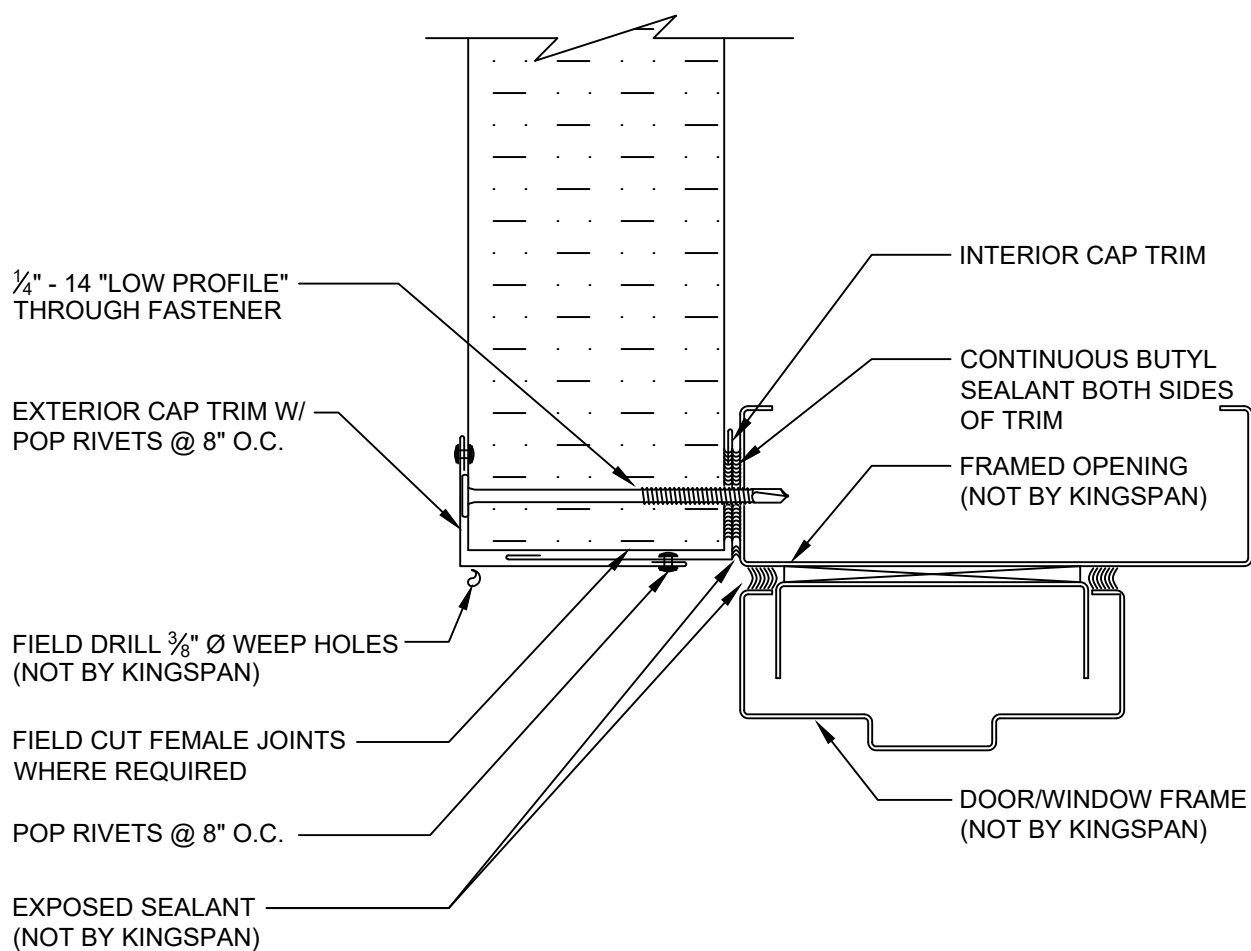

NOTE: SEE DETAIL CI-TL-01-KSMF, CI-TL-02-KSMF, AND CI-TL-04-KSMF
FOR TYPICAL TRIM LAP INSTRUCTIONS

FRAMED OPENING
HEAD - TWO PIECE

DETAIL #: CI-FO-01-KSMF

DATE: 2020



www.kingspanpanels.us
www.kingspanpanels.ca

KSMF SERIES - HORIZONTAL INSTALLATION

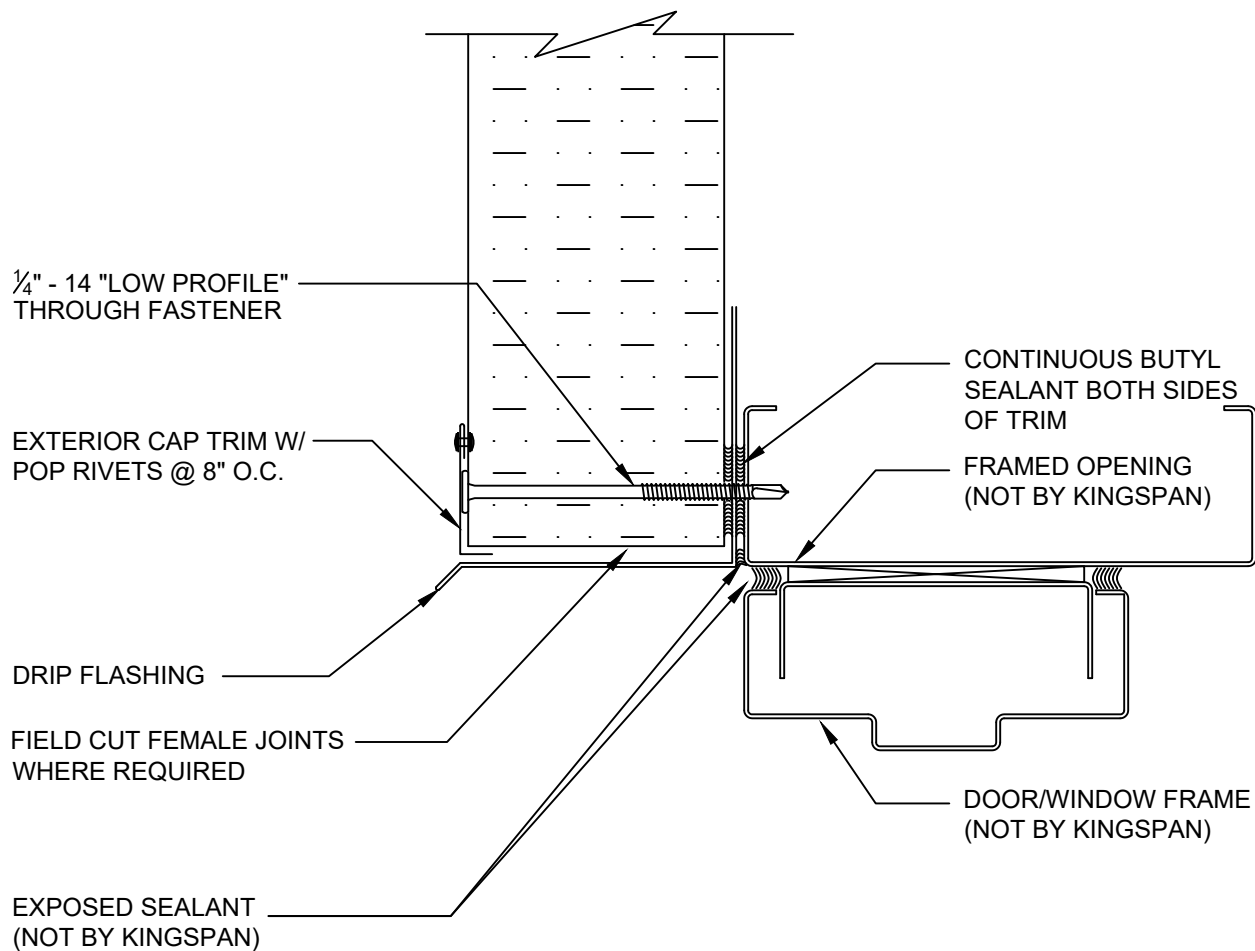

NOTE: SEE DETAIL CI-TL-01-KSMF, CI-TL-02-KSMF, AND CI-TL-04-KSMF
FOR TYPICAL TRIM LAP INSTRUCTIONS

**FRAMED OPENING HEAD
- DRIP FLASHING**

DETAIL #: CI-FO-02-KSMF

DATE: 2020



www.kingspanpanels.us
www.kingspanpanels.ca

KSMF SERIES - HORIZONTAL INSTALLATION

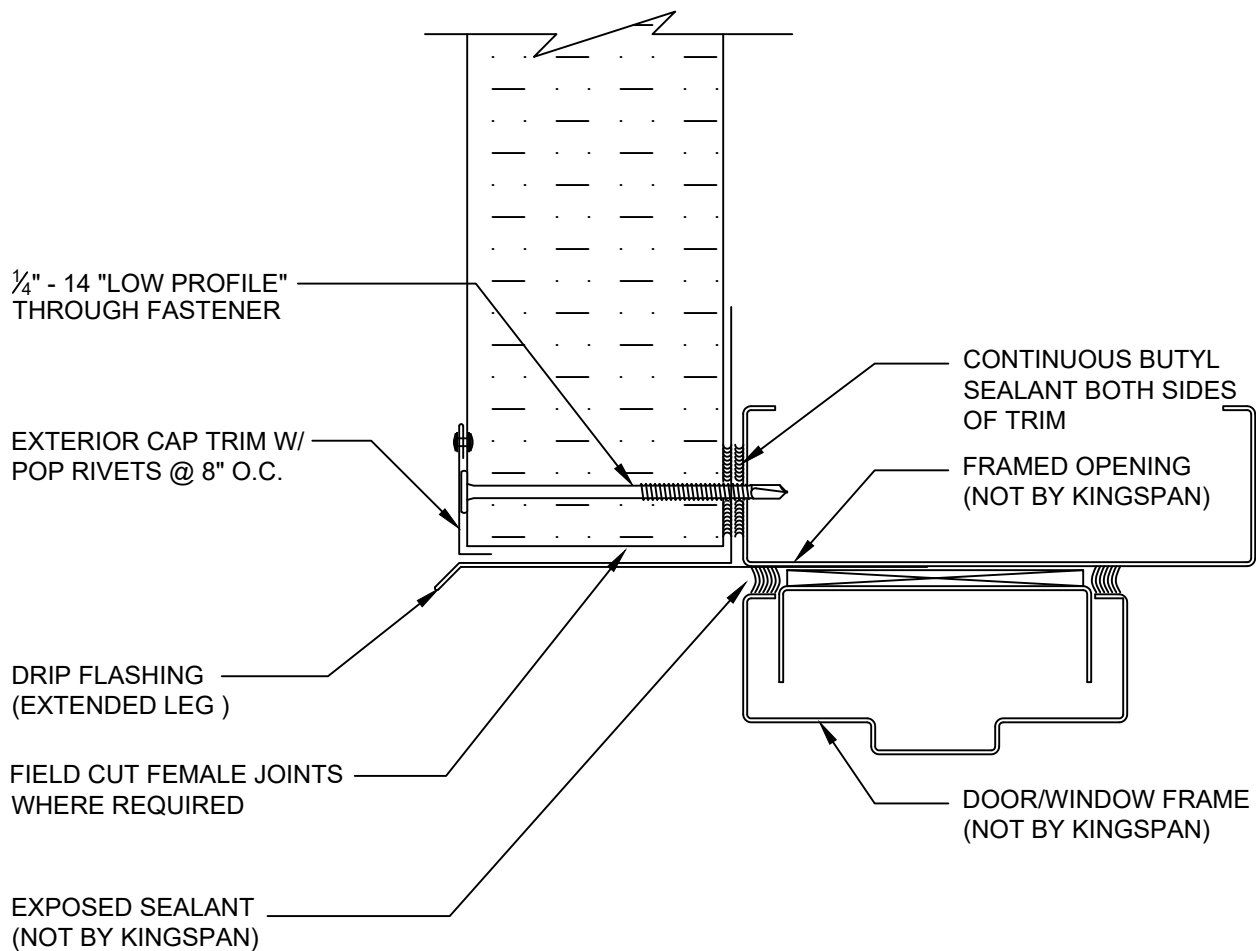

NOTE: SEE DETAIL CI-TL-01-KSMF, CI-TL-02-KSMF, AND CI-TL-04-KSMF
FOR TYPICAL TRIM LAP INSTRUCTIONS

**FRAMED OPENING HEAD
- W/ OPTIONAL DRIP
FLASHING**

DETAIL #: CI-FO-03-KSMF

DATE: 2020



www.kingspanpanels.us
www.kingspanpanels.ca

KSMF SERIES - HORIZONTAL INSTALLATION

FOR 3 HR RATING - 1 ½" LONG STEEL OR STAINLESS STEEL #13 FASTENER SHALL BE INSTALLED AT PANEL JOINTS ON BOTH SIDES OF THE WALL @ 12" O.C.

FOR 1 AND 2HR RATING - A 1 ½" LONG STEEL OR STAINLESS STEEL #13 FASTENER SHALL BE INSTALLED AT PANEL JOINTS ON BOTH SIDES OF THE WALL, RIGHT AND LEFT PANEL END ONLY.

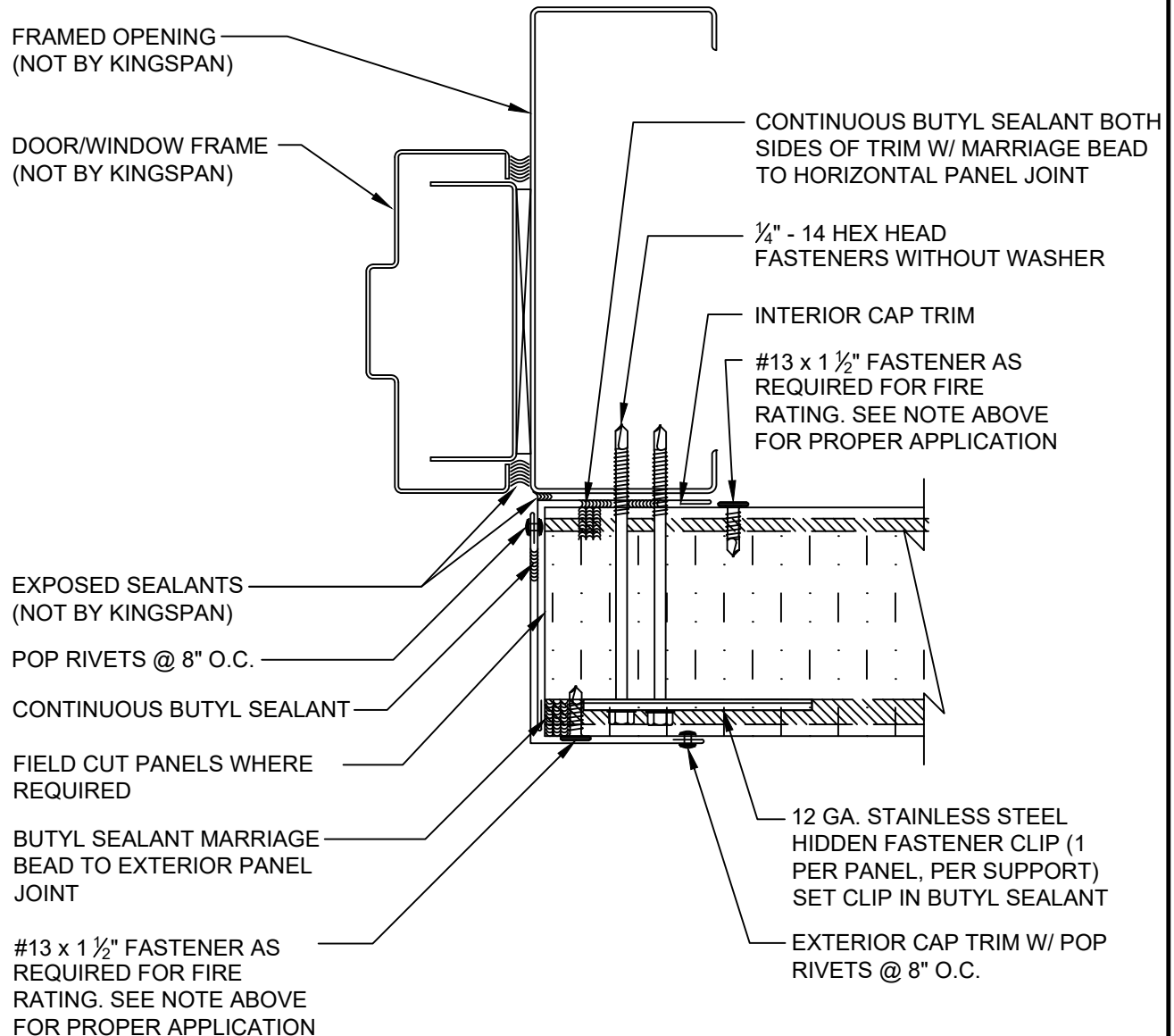

NOTE: SEE DETAIL CI-TL-01-KSMF, CI-TL-02-KSMF, AND CI-TL-04-KSMF
FOR TYPICAL TRIM LAP INSTRUCTIONS

FRAMED OPENING
JAMB - TWO PIECE

DETAIL #: CI-FO-04-KSMF

DATE: 2020



www.kingspanpanels.us
www.kingspanpanels.ca

KSMF SERIES - HORIZONTAL INSTALLATION

FOR 3 HR RATING - 1 ½" LONG STEEL OR STAINLESS STEEL #13 FASTENER SHALL BE INSTALLED AT PANEL JOINTS ON BOTH SIDES OF THE WALL @ 12" O.C.

FOR 1 AND 2HR RATING - A 1 ½" LONG STEEL OR STAINLESS STEEL #13 FASTENER SHALL BE INSTALLED AT PANEL JOINTS ON BOTH SIDES OF THE WALL, RIGHT AND LEFT PANEL END ONLY.

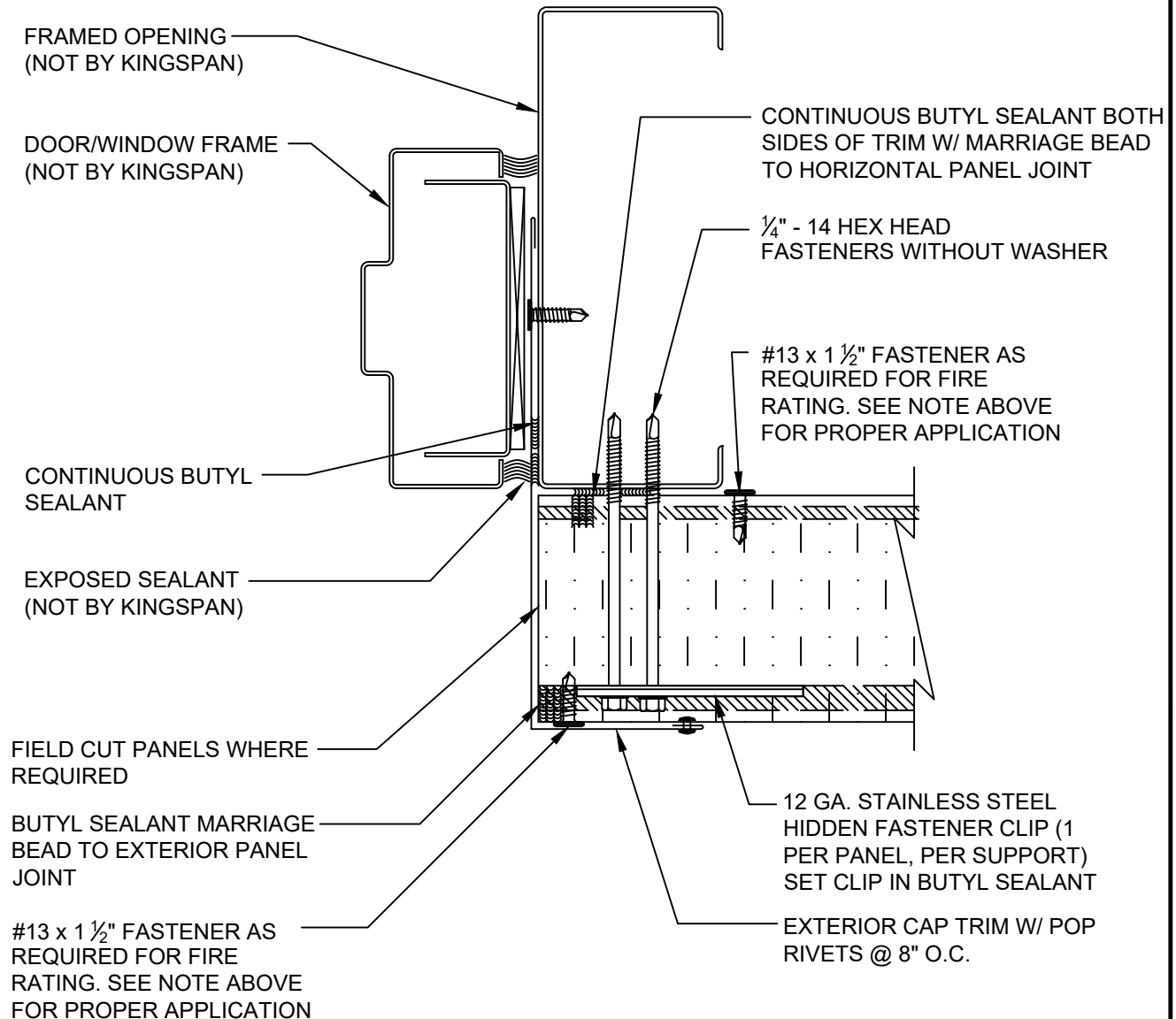

NOTE: SEE DETAIL CI-TL-01-KSMF, CI-TL-02-KSMF, AND CI-TL-04-KSMF FOR TYPICAL TRIM LAP INSTRUCTIONS

FRAMED OPENING JAMB -
ONE PIECE

DETAIL #: CI-FO-05-KSMF

DATE: 2020

Kingspan
Insulated Panels

www.kingspanpanels.us
www.kingspanpanels.ca

KSMF SERIES - HORIZONTAL INSTALLATION

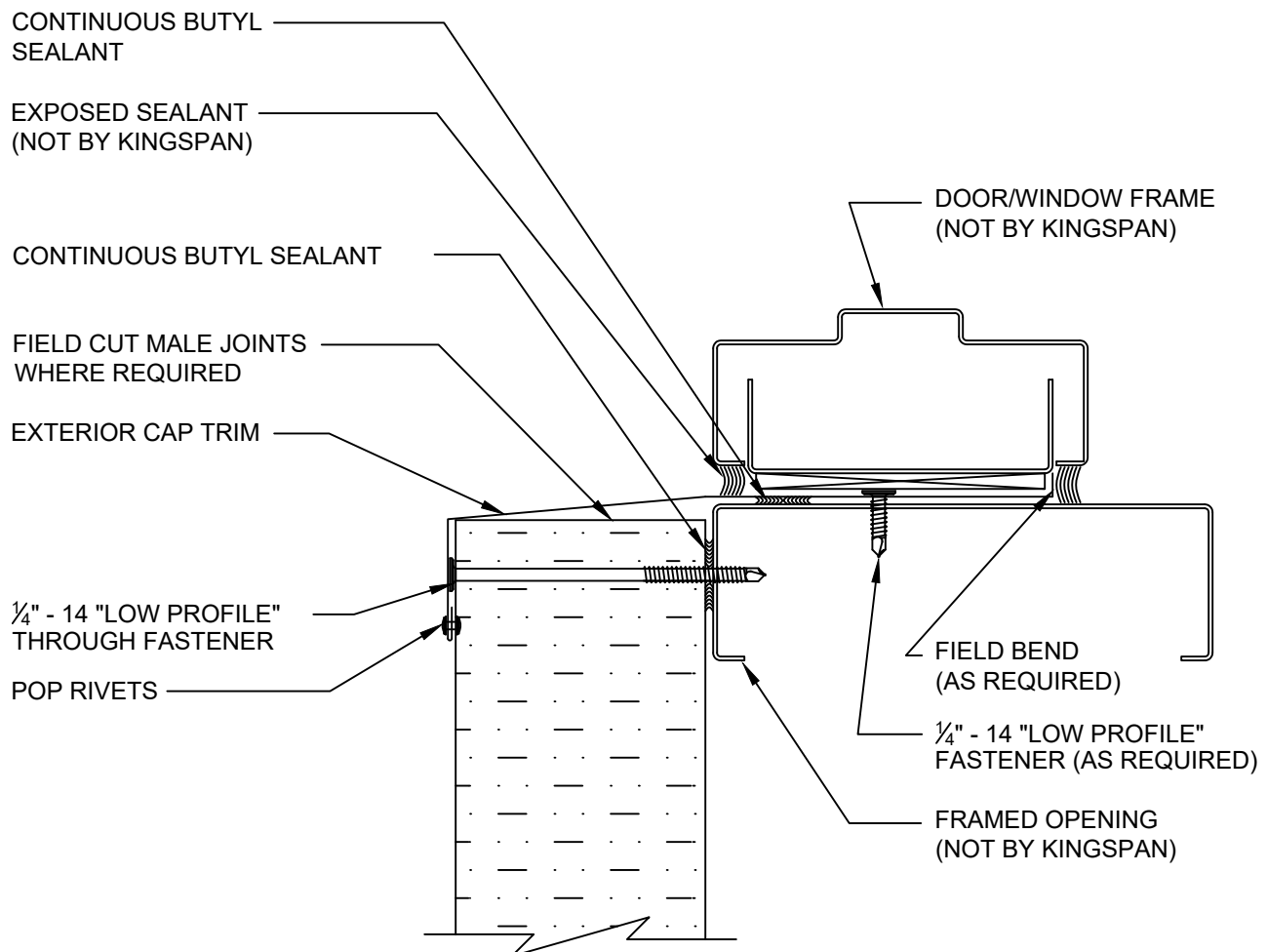

NOTE: SEE DETAIL CI-TL-01-KSMF, CI-TL-02-KSMF, AND CI-TL-04-KSMF
FOR TYPICAL TRIM LAP INSTRUCTIONS

**FRAMED OPENING SILL
- ONE PIECE**

DETAIL #: CI-FO-06-KSMF

DATE: 2020

Kingspan
Insulated Panels

www.kingspanpanels.us
www.kingspanpanels.ca

KSMF SERIES - HORIZONTAL INSTALLATION

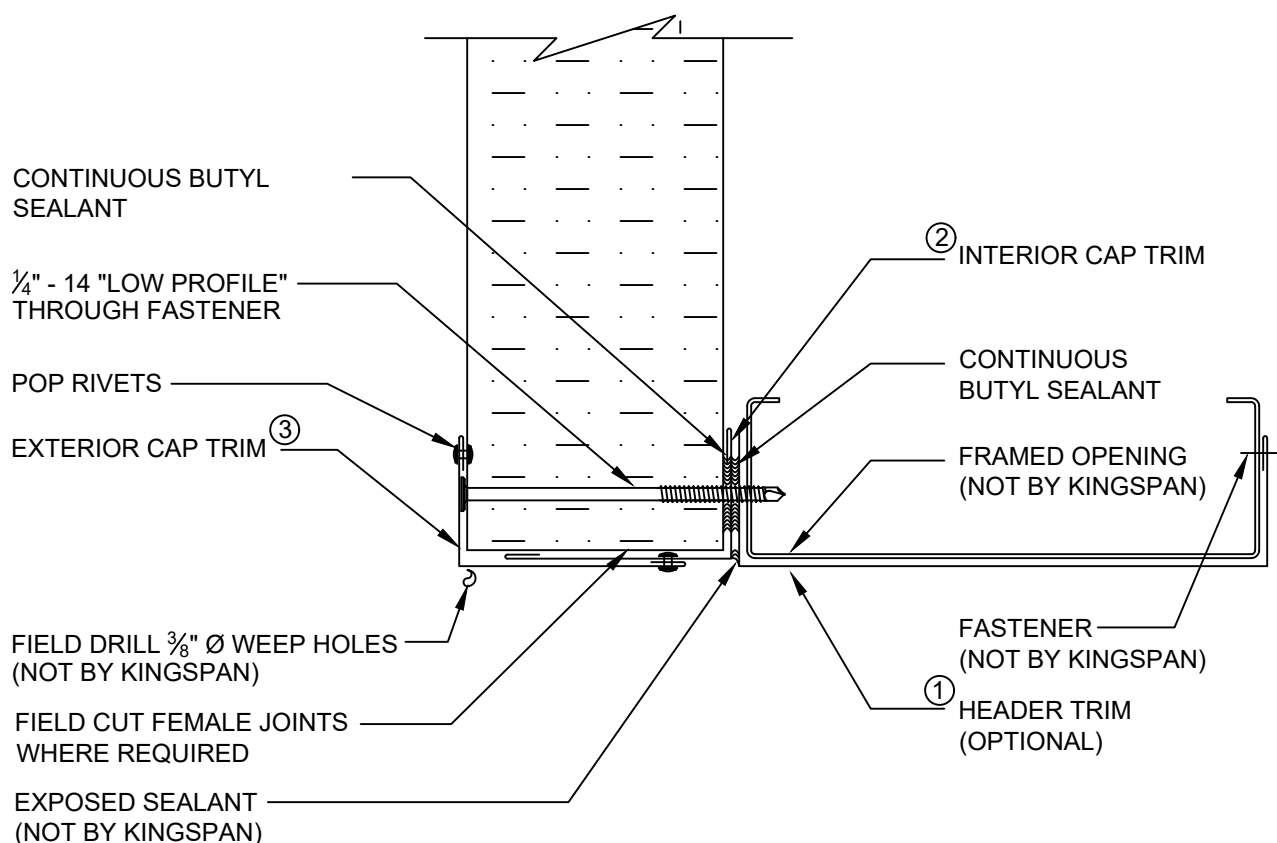

TRIM INSTALLATION SEQUENCE:

- ① HEADER TRIM (OPTIONAL) & ALL APPLICABLE SEALANTS
- ② INTERIOR CAP TRIM & ALL APPLICABLE SEALANTS PRIOR TO INSTALLING THE PANEL AND THROUGH FASTENERS
- ③ EXTERIOR CAP TRIM

NOTE: SEE DETAIL CI-TL-01-KSMF, CI-TL-02-KSMF, AND CI-TL-04-KSMF FOR TYPICAL TRIM LAP INSTRUCTIONS

FRAMED OPENING
HEAD - TWO PIECE w/
HEAD TRIM

DETAIL #: CI-FO-07-KSMF

DATE: 2020



www.kingspanpanels.us
www.kingspanpanels.ca

KSMF SERIES - HORIZONTAL INSTALLATION

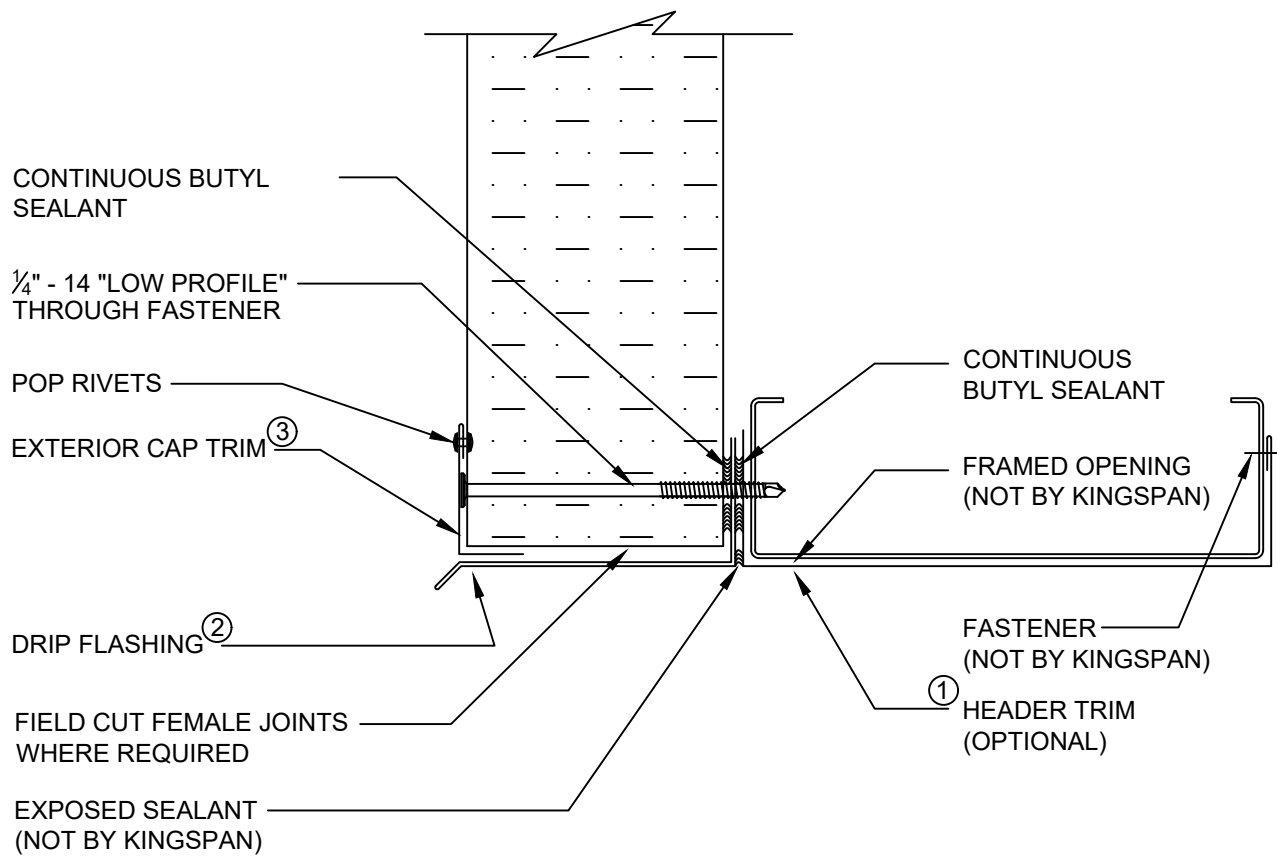

TRIM INSTALLATION SEQUENCE:

- ① HEADER TRIM (OPTIONAL) & ALL APPLICABLE SEALANTS
- ② DRIP FLASHING & ALL APPLICABLE SEALANTS PRIOR TO INSTALLING THE PANEL AND THROUGH FASTENERS
- ③ EXTERIOR CAP TRIM

NOTE: SEE DETAIL CI-TL-01-KSMF, CI-TL-02-KSMF, AND CI-TL-04-KSMF FOR TYPICAL TRIM LAP INSTRUCTIONS

**FRAMED OPENING HEAD
- DRIP FLASHING w/
OPTIONAL HEAD TRIM**

DETAIL #: CI-FO-08-KSMF

DATE: 2020



www.kingspanpanels.us
www.kingspanpanels.ca

KSMF SERIES - HORIZONTAL INSTALLATION

FOR 3 HR RATING - 1 ½" LONG STEEL OR STAINLESS STEEL #13 FASTENER SHALL BE INSTALLED AT PANEL JOINTS ON BOTH SIDES OF THE WALL @ 12" O.C.

FOR 1 AND 2HR RATING - A 1 ½" LONG STEEL OR STAINLESS STEEL #13 FASTENER SHALL BE INSTALLED AT PANEL JOINTS ON BOTH SIDES OF THE WALL, RIGHT AND LEFT PANEL END ONLY.

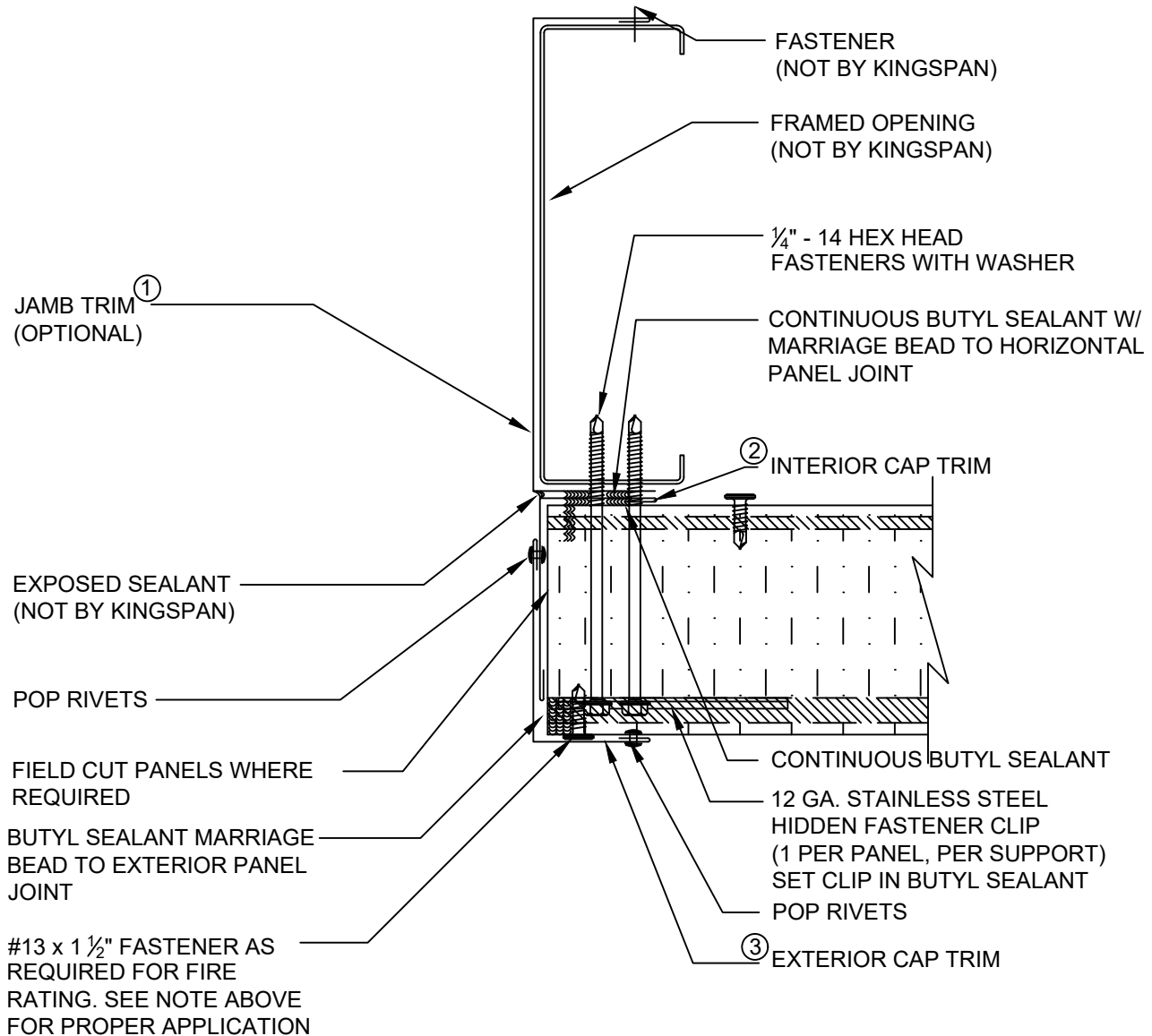

TRIM INSTALLATION SEQUENCE:

- ① JAMB TRIM (OPTIONAL) & ALL APPLICABLE SEALANTS
- ② INTERIOR CAP TRIM & ALL APPLICABLE SEALANTS PRIOR TO INSTALLING THE PANEL AND THROUGH FASTENERS
- ③ EXTERIOR CAP TRIM

NOTE: SEE DETAIL CI-TL-01-KSMF, CI-TL-02-KSMF, AND CI-TL-04-KSMF FOR TYPICAL TRIM LAP INSTRUCTIONS

**FRAMED OPENING
JAMB - TWO PIECE w/
OPTIONAL JAMB TRIM**

DETAIL #: CI-FO-09-KSMF

DATE: 2020



www.kingspanpanels.us
www.kingspanpanels.ca

KSMF SERIES - HORIZONTAL INSTALLATION

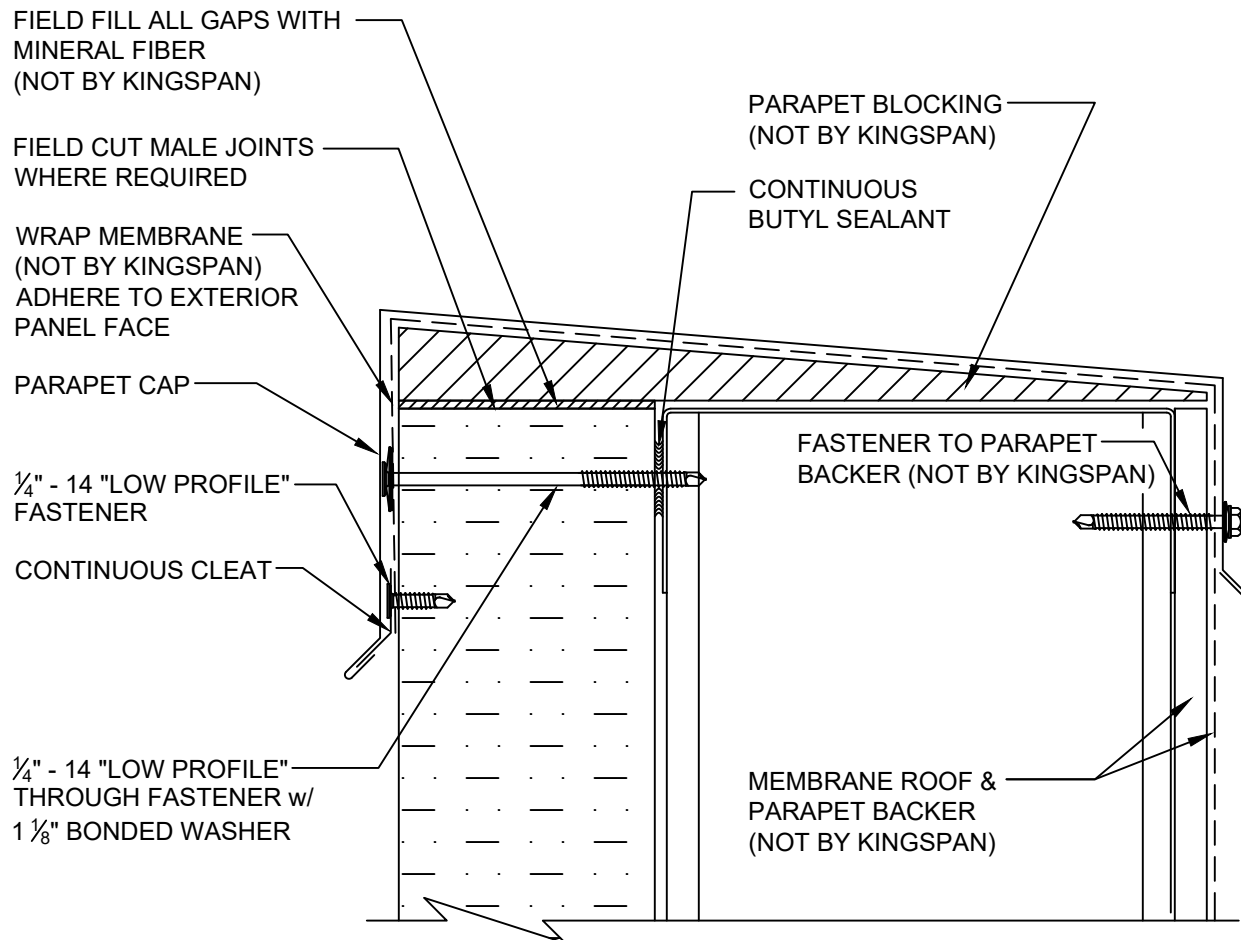

FIELD CUT PARAPET
WITH FLUSH TRIM

DETAIL #: CI-PR-01-KSMF

DATE: 2020



www.kingspanpanels.us
www.kingspanpanels.ca

KSMF SERIES - HORIZONTAL INSTALLATION

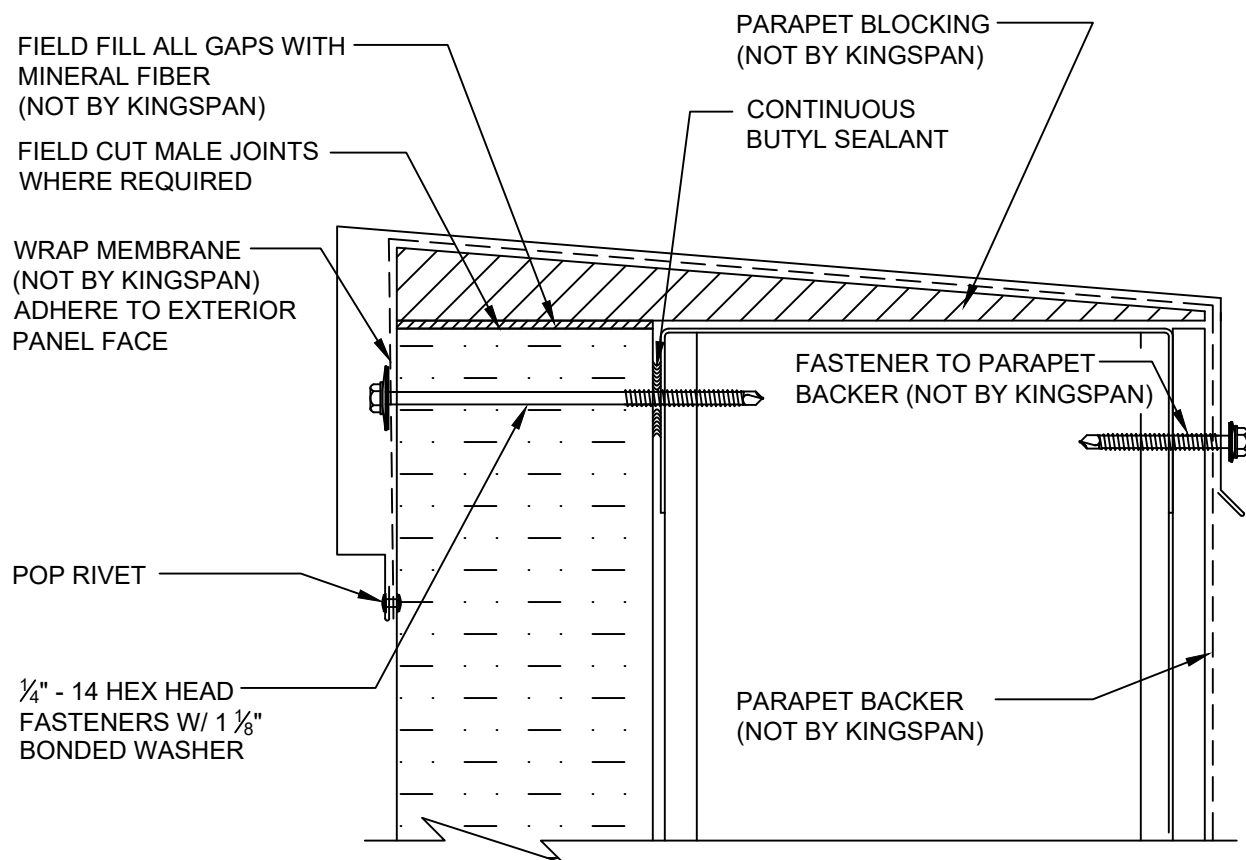

FIELD CUT PARAPET
WITH PROFILED TRIM

DETAIL #: CI-PR-02-KSMF

DATE: 2020



www.kingspanpanels.us
www.kingspanpanels.ca

KSMF SERIES - HORIZONTAL INSTALLATION

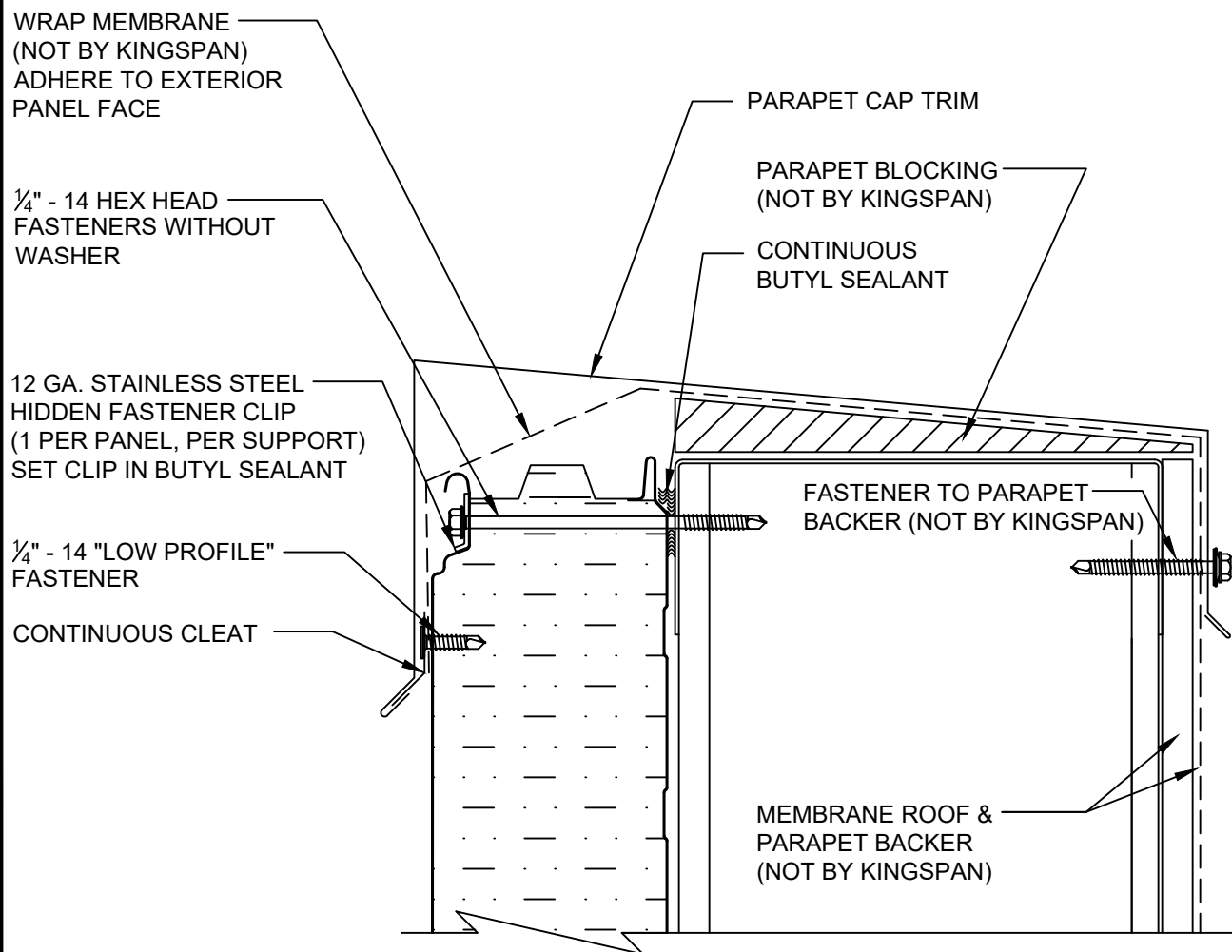

PARAPET
WITH FLUSH TRIM

DETAIL #: CI-PR-03-KSMF

DATE: 2020



www.kingspanpanels.us
www.kingspanpanels.ca

KSMF SERIES - HORIZONTAL INSTALLATION

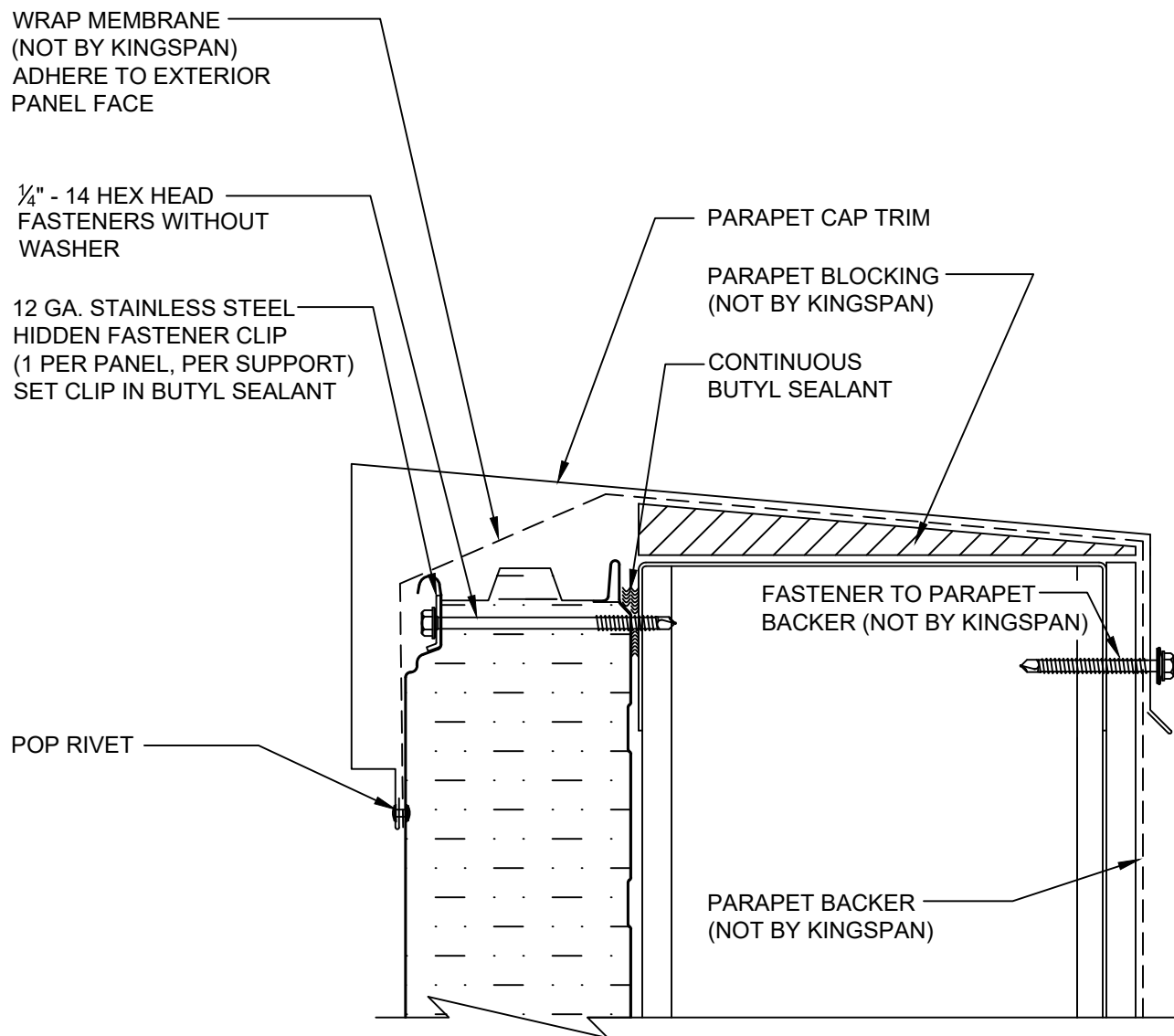

PARAPET
WITH PROFILED TRIM

DETAIL #: CI-PR-04-KSMF

DATE: 2020



www.kingspanpanels.us
www.kingspanpanels.ca

KSMF SERIES - HORIZONTAL INSTALLATION

FOR 3 HR RATING - 1 ½" LONG STEEL OR STAINLESS STEEL#13 FASTENER SHALL BE INSTALLED AT PANEL JOINTS ON BOTH SIDES OF THE WALL @ 12" O.C.

FOR 1 AND 2HR RATING - A 1 ½" LONG STEEL OR STAINLESS STEEL#13 FASTENER SHALL BE INSTALLED AT PANEL JOINTS ON BOTH SIDES OF THE WALL, TOP AND BOTTOM ONLY.

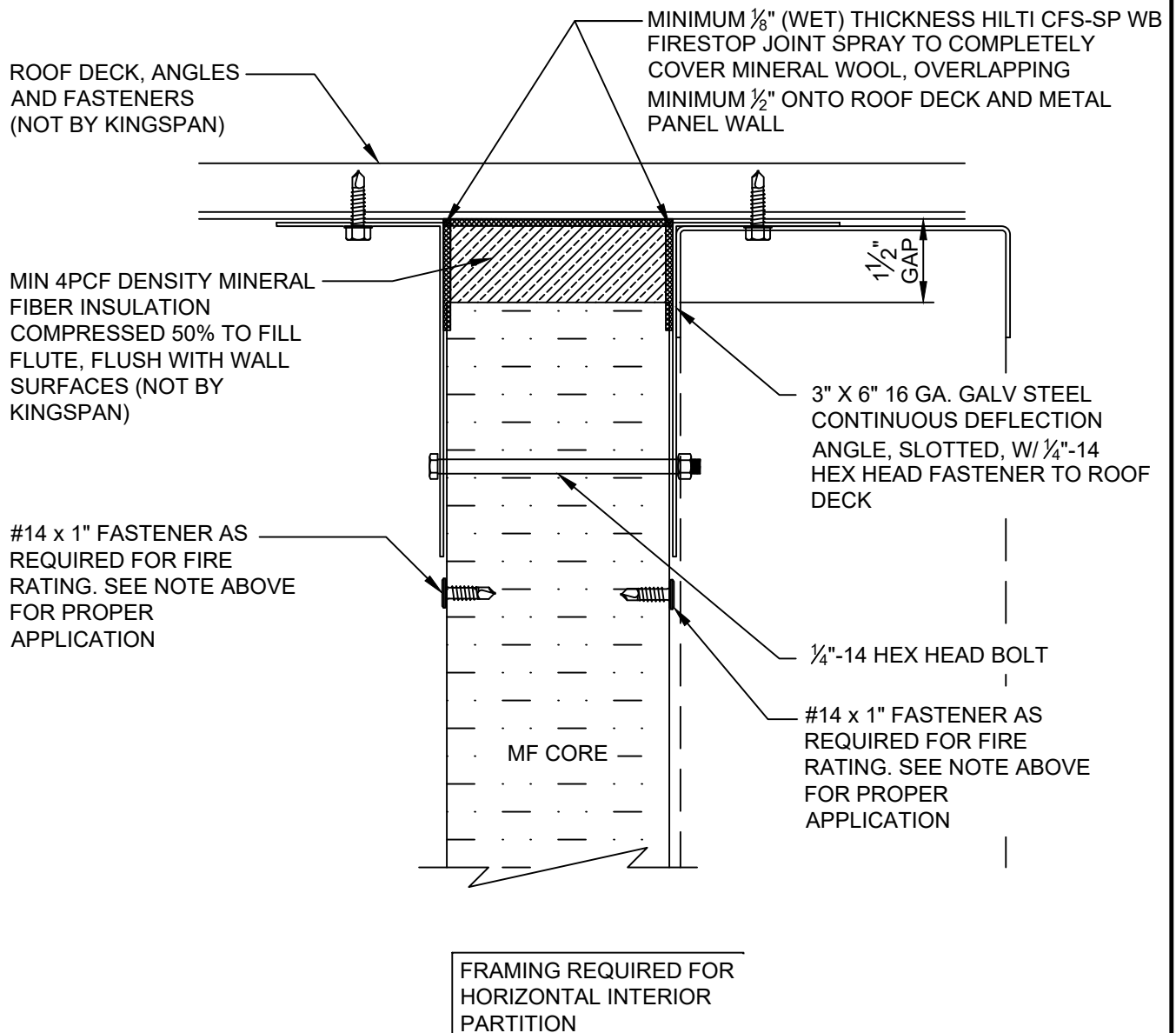

INTERIOR PARTITION
HEAD

DETAIL #: CI-IP-01-KSMF

DATE: 2020



Kingspan
Insulated Panels

www.kingspanpanels.us
www.kingspanpanels.ca

KSMF SERIES - HORIZONTAL INSTALLATION

FOR 3 HR RATING - 1 ½" LONG STEEL OR STAINLESS STEEL#13 FASTENER SHALL BE INSTALLED AT PANEL JOINTS ON BOTH SIDES OF THE WALL @ 12" O.C.

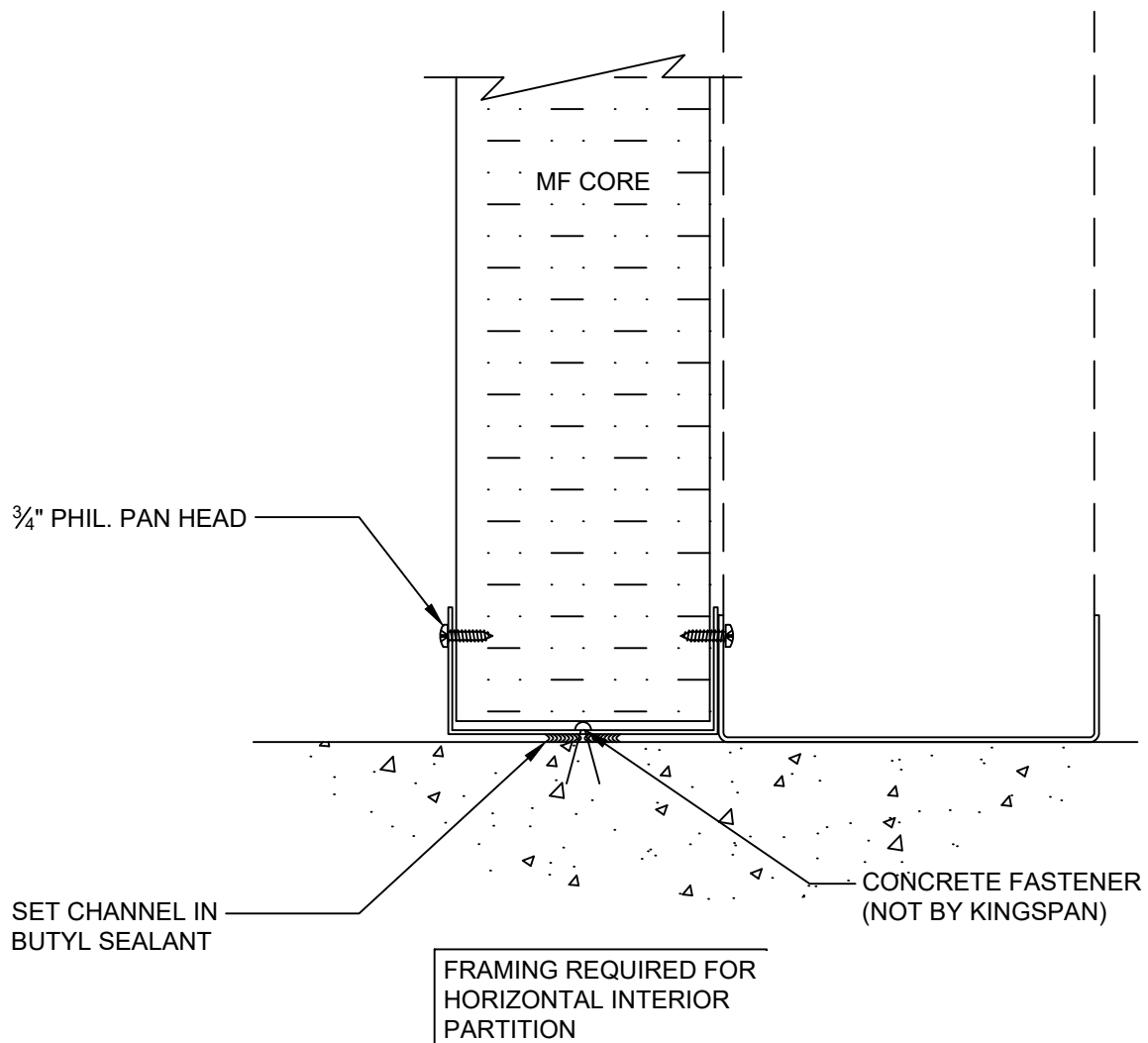
FOR 1 AND 2HR RATING - A 1 ½" LONG STEEL OR STAINLESS STEEL#13 FASTENER SHALL BE INSTALLED AT PANEL JOINTS ON BOTH SIDES OF THE WALL, TOP AND BOTTOM ONLY.



INTERIOR PARTITION
BASE

DETAIL #: CI-IP-02-KSMF

DATE: 2020

Kingspan
Insulated Panels

www.kingspanpanels.us
www.kingspanpanels.ca

KSMF SERIES - HORIZONTAL INSTALLATION

FOR 3 HR RATING - 1 ½" LONG STEEL OR STAINLESS STEEL#13 FASTENER SHALL BE INSTALLED AT PANEL JOINTS ON BOTH SIDES OF THE WALL @ 12" O.C.

FOR 1 AND 2HR RATING - A 1 ½" LONG STEEL OR STAINLESS STEEL#13 FASTENER SHALL BE INSTALLED AT PANEL JOINTS ON BOTH SIDES OF THE WALL, TOP AND BOTTOM ONLY.

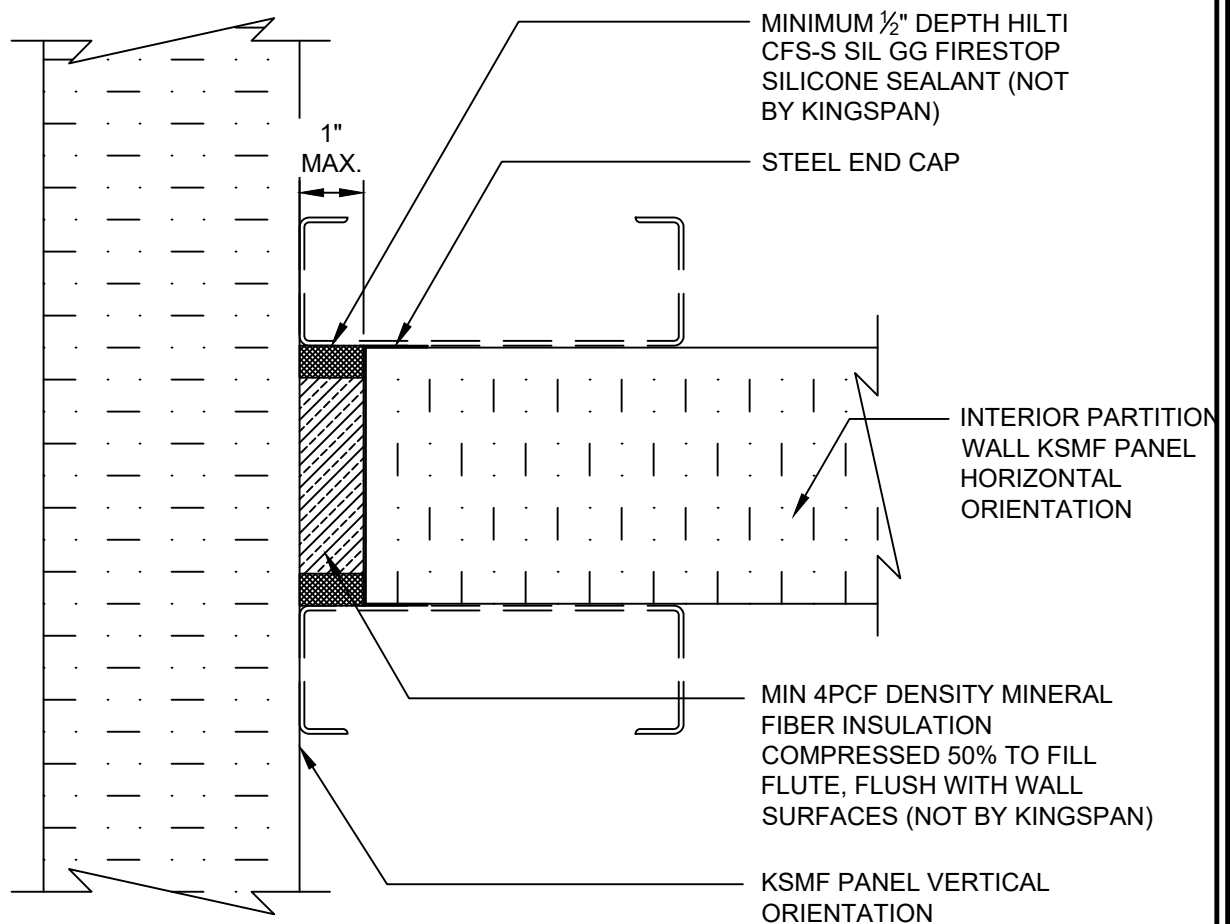

INTERIOR PARTITION
END WALL

DETAIL #: CI-IP-03-KSMF

DATE: 2020



www.kingspanpanels.us
www.kingspanpanels.ca

KSMF SERIES - HORIZONTAL INSTALLATION

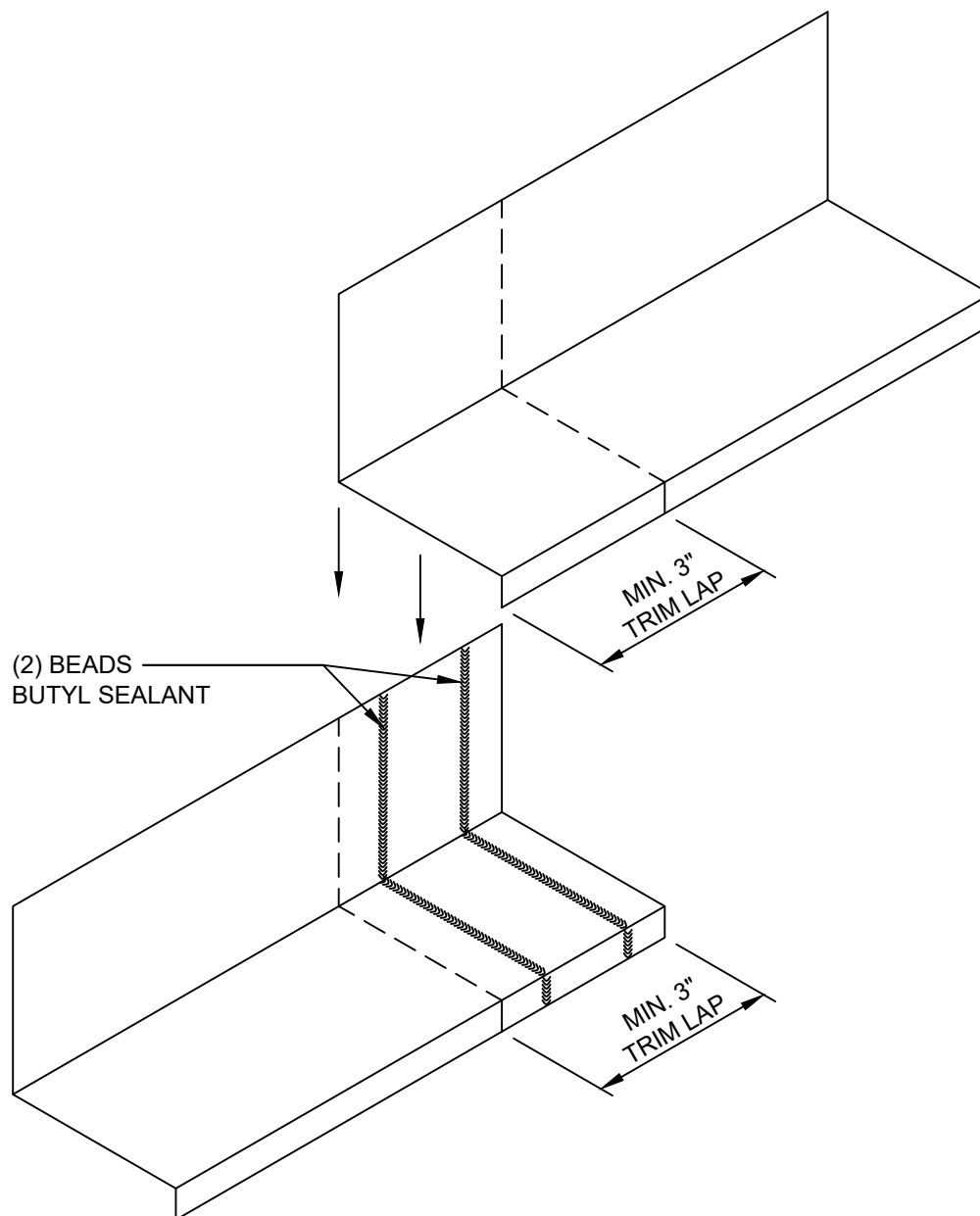

TRIM END LAP

DETAIL #: CI-TL-01-KSMF

DATE: 2020

Kingspan
Insulated Panels

www.kingspanpanels.us
www.kingspanpanels.ca

KSMF SERIES - HORIZONTAL INSTALLATION

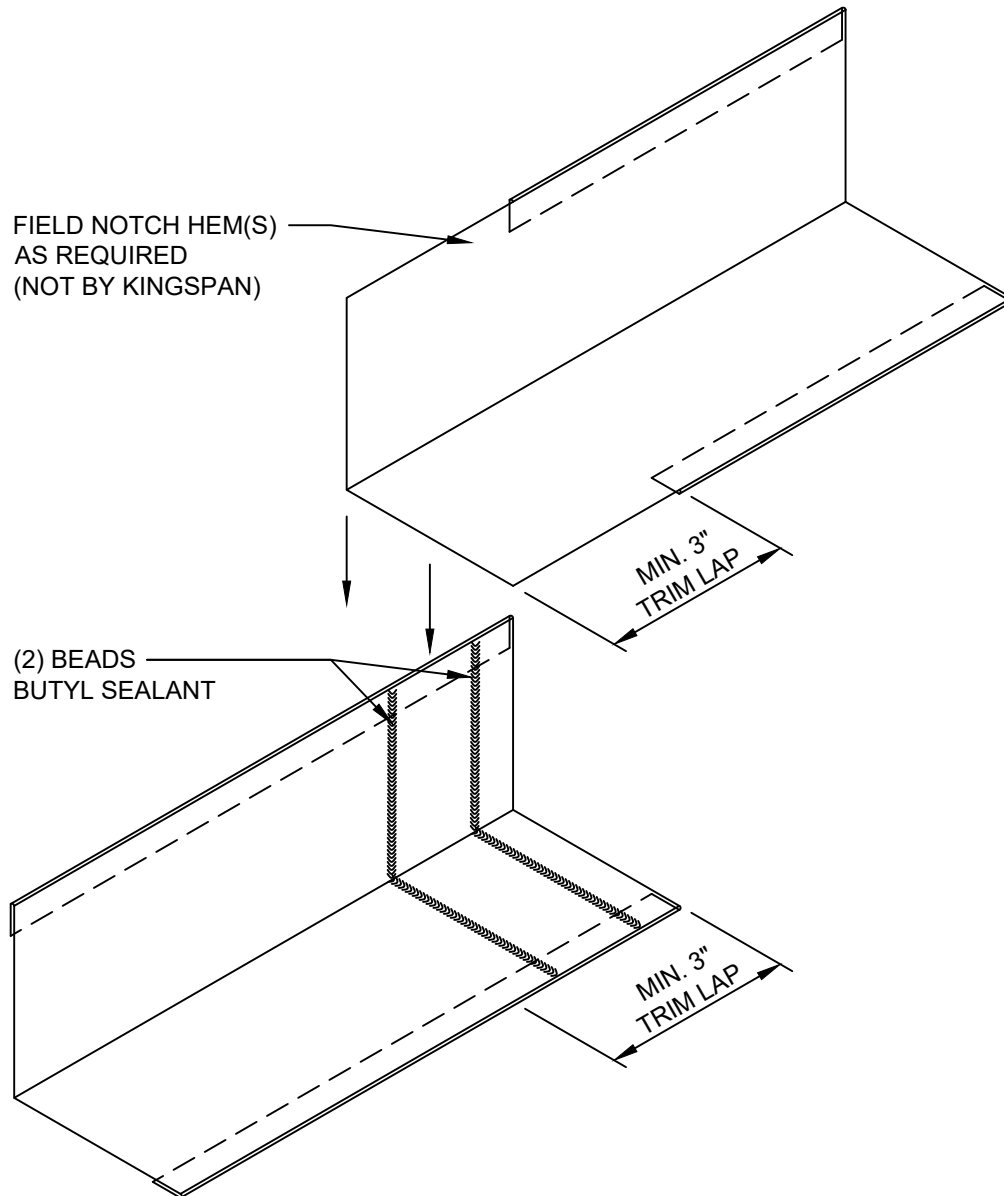

TRIM LAP WITH HEM

DETAIL #: CI-TL-02-KSMF

DATE: 2020

Kingspan
Insulated Panels

www.kingspanpanels.us
www.kingspanpanels.ca

KSMF SERIES - HORIZONTAL INSTALLATION

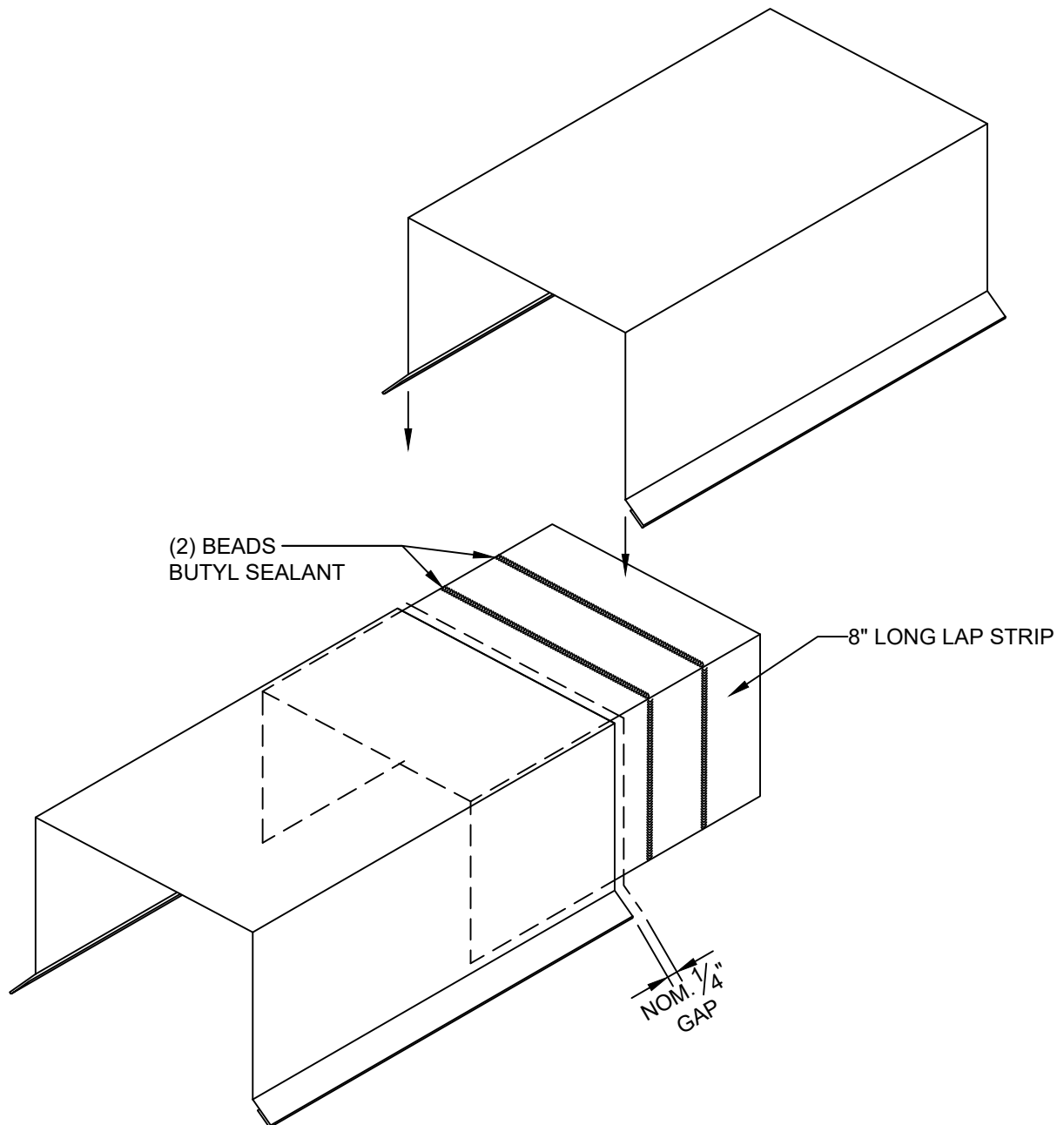

TRIM END LAP WITH
LAP STRIP

DETAIL #: CI-TL-03-KSMF

DATE: 2020

Kingspan
Insulated Panels

www.kingspanpanels.us
www.kingspanpanels.ca

KSMF SERIES - HORIZONTAL INSTALLATION

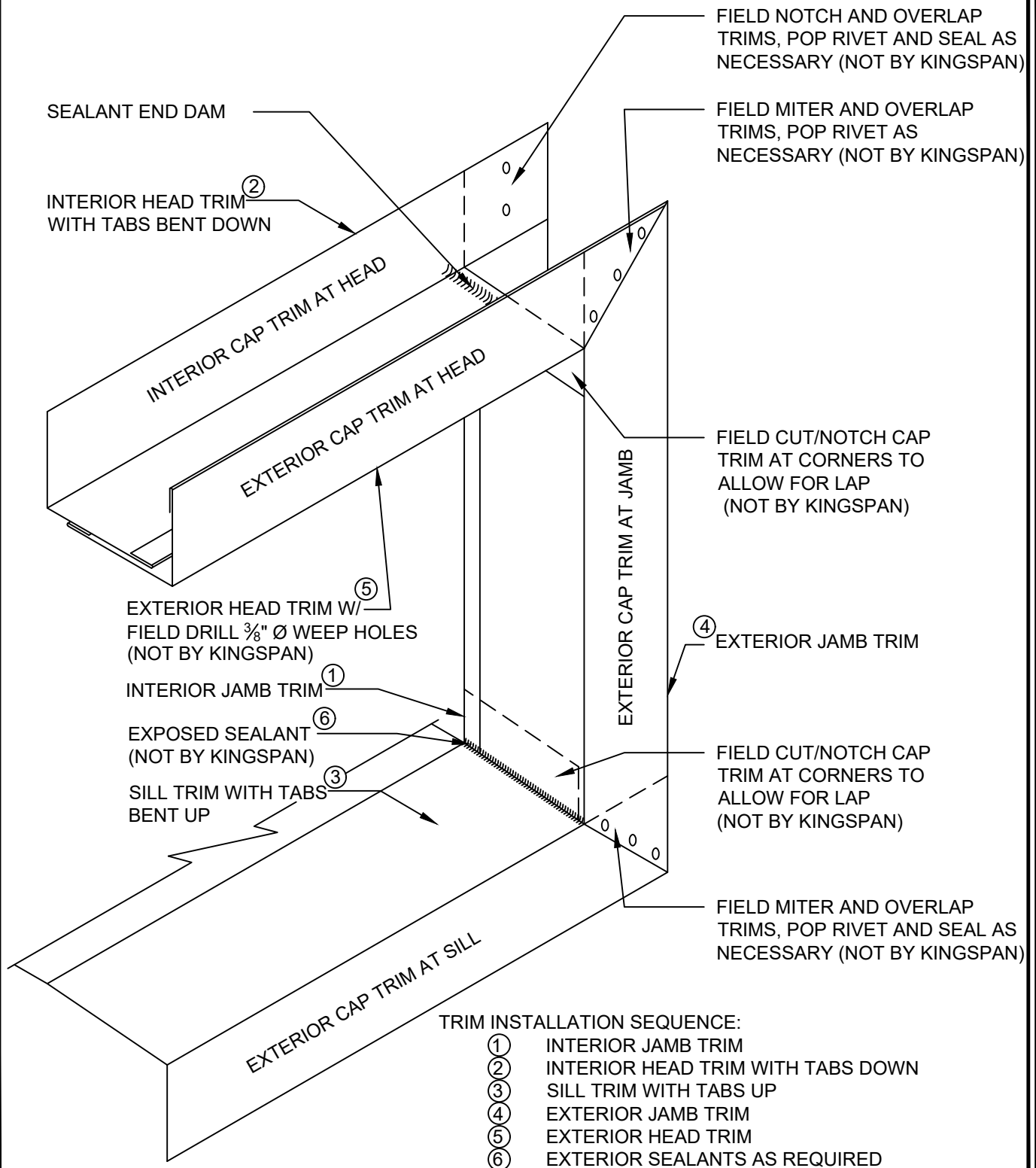

TRIM LAP AT
FRAMED OPENING

DETAIL #: CI-TL-04-KSMF

DATE: 2020



www.kingspanpanels.us
www.kingspanpanels.ca

KSMF SERIES - HORIZONTAL INSTALLATION

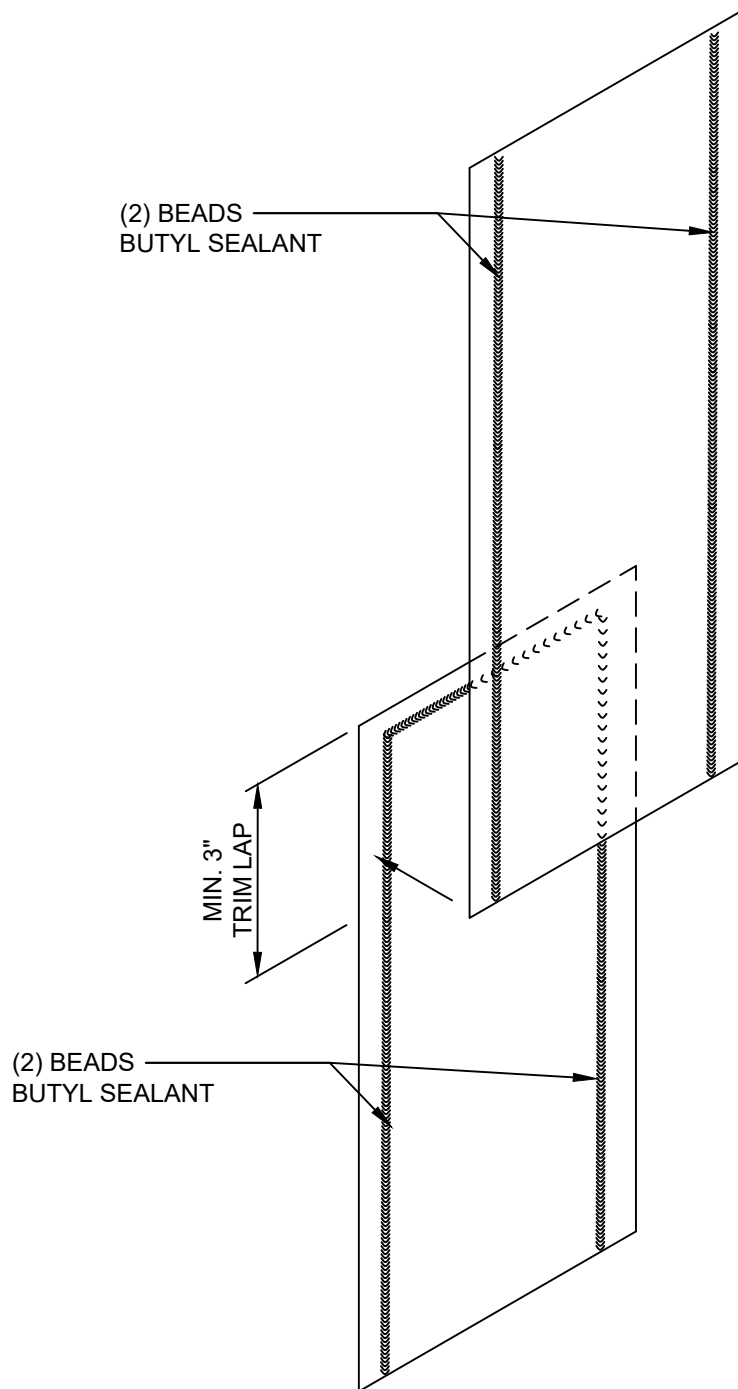

MENDING PLATE
"SHINGLE" LAP

DETAIL #: CI-TL-05-KSMF

DATE: 2020



www.kingspanpanels.us
www.kingspanpanels.ca

KSMF SERIES - HORIZONTAL INSTALLATION

NOTE:
KINGSPAN RECOMMENDS
PENETRATIONS DO NOT
OCCUR AT PANEL JOINTS

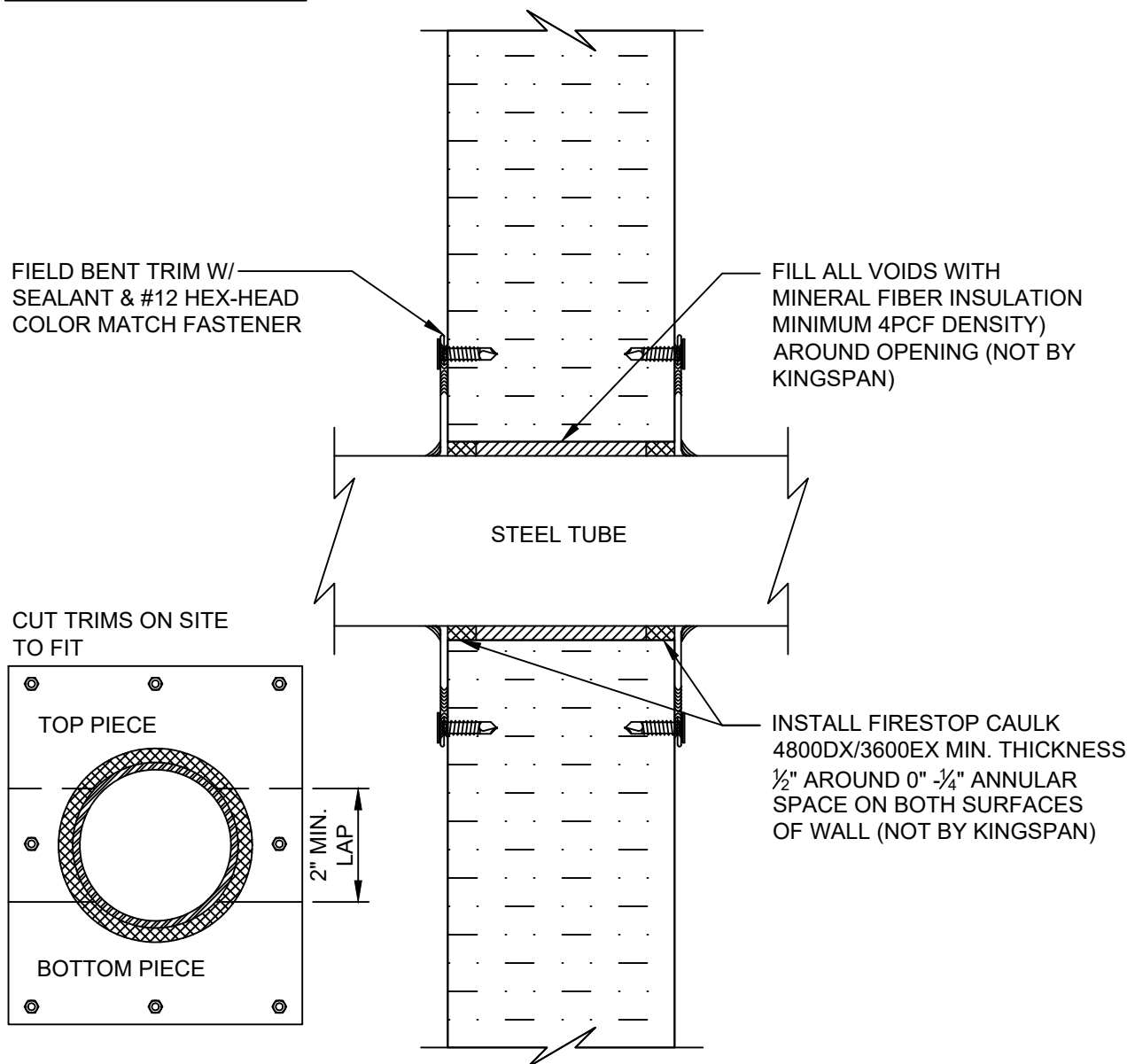

WALL PIPE
PENETRATION

DETAIL #: CI-PE-01-KSMF

DATE: 2020

Kingspan
Insulated Panels

www.kingspanpanels.us
www.kingspanpanels.ca

KSMF SERIES - HORIZONTAL INSTALLATION

AVOID LOCATING PENETRATIONS AT JOINT LOCATIONS

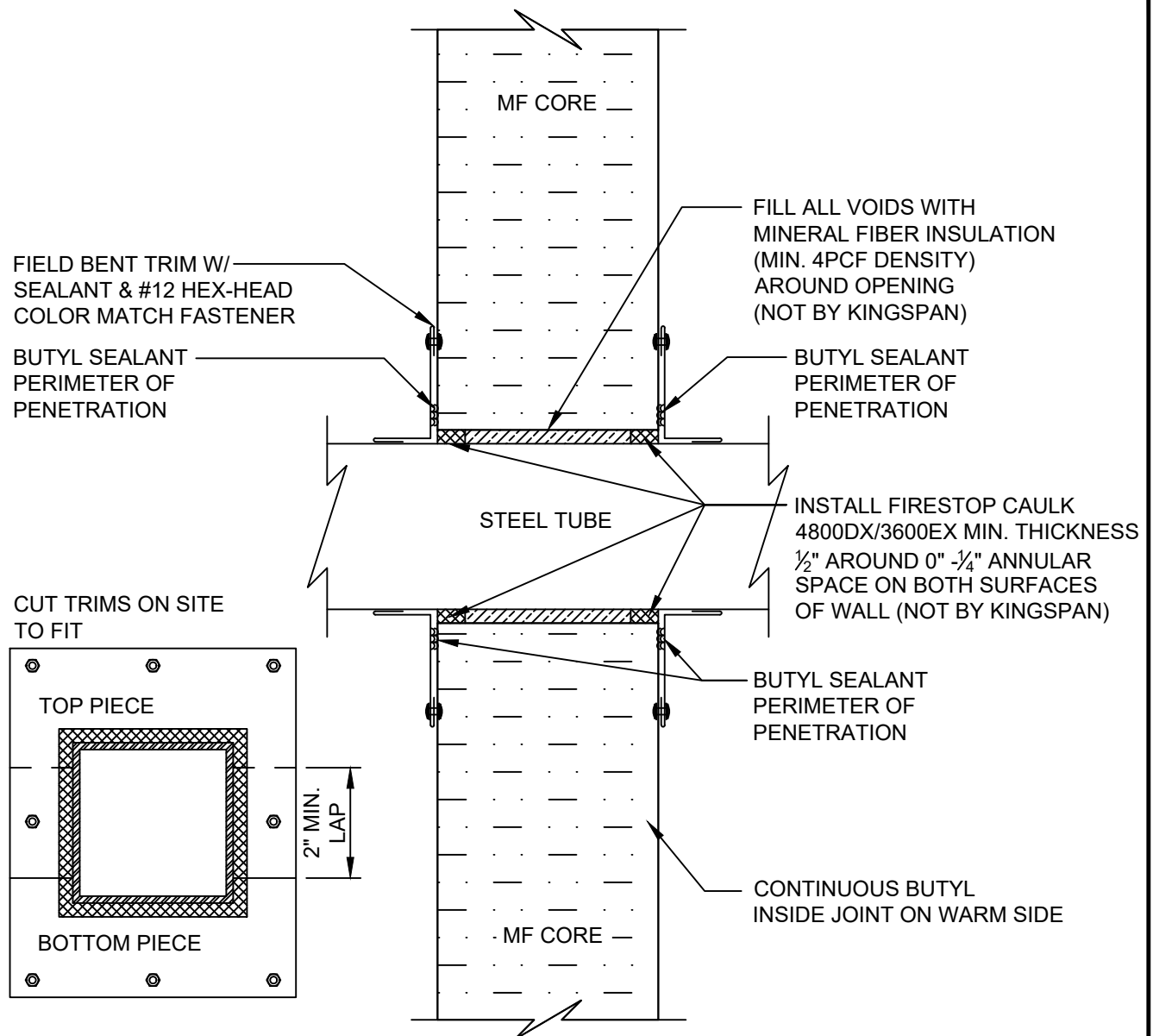

WALL TUBE /HSS
PENETRATION

DETAIL #: CI-PE-02-KSMF

DATE: 2020

Kingspan
Insulated Panels

www.kingspanpanels.us
www.kingspanpanels.ca

KSMF SERIES - HORIZONTAL INSTALLATION

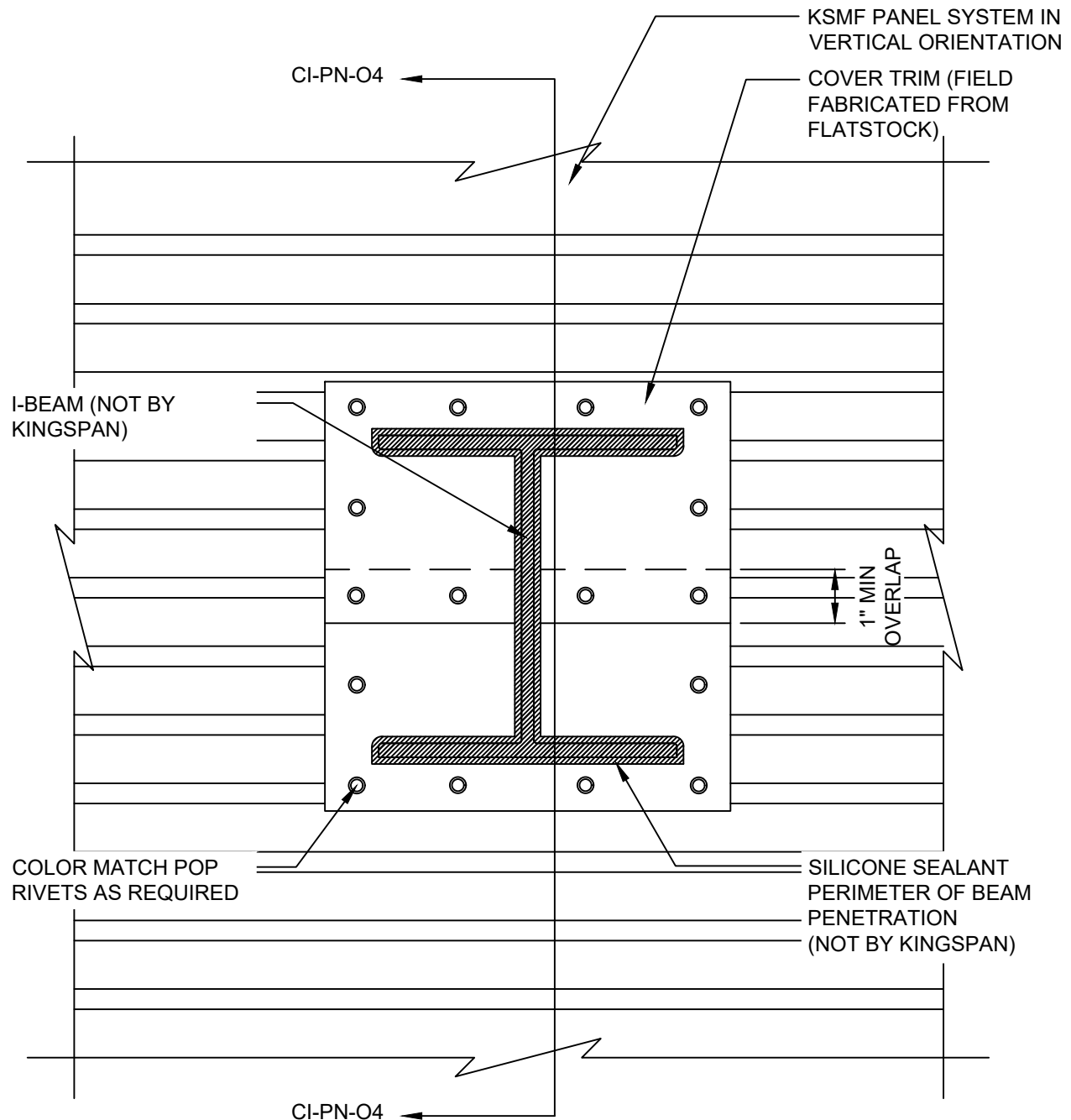

AVOID LOCATING PENETRATIONS AT JOINT LOCATIONS

WALL BEAM
PENETRATION

DETAIL #: CI-PE-03-KSMF

DATE: 2020

Kingspan
Insulated Panels

www.kingspanpanels.us
www.kingspanpanels.ca

KSMF SERIES - HORIZONTAL INSTALLATION

AVOID LOCATING PENETRATIONS AT JOINT LOCATIONS

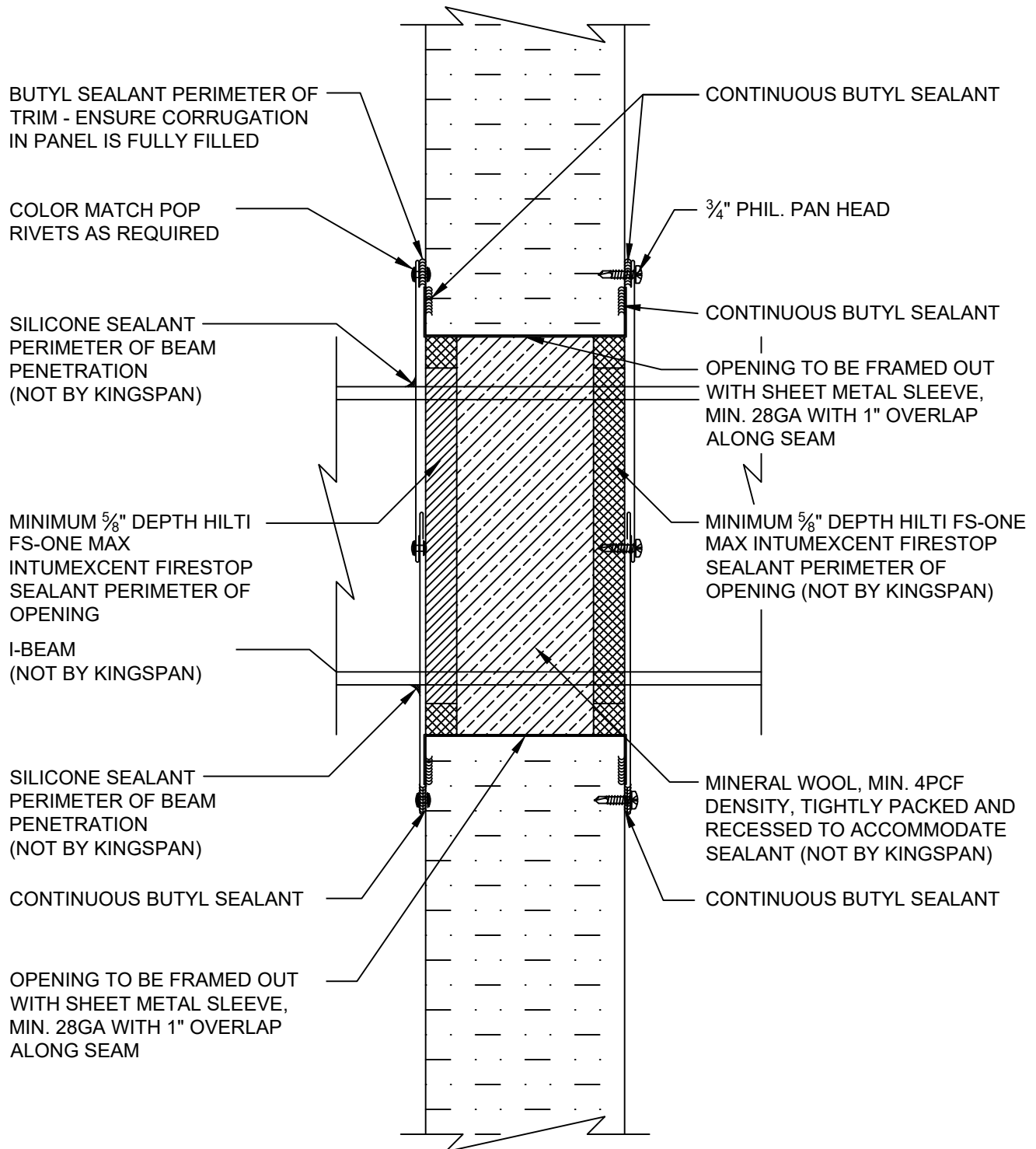

WALL BEAM PENETRATION
SECTION

DETAIL #: CI-PE-04-KSMF

DATE: 2020



www.kingspanpanels.us
www.kingspanpanels.ca