

☒ Select Desired Height

- ☐ 34" [863.6mm]
- ☐ 40" [1016.0mm]
- ☐ 46" [1168.4mm]
- ☐ 58" [1473.2mm]
- ☐ 70" [1778.0mm]

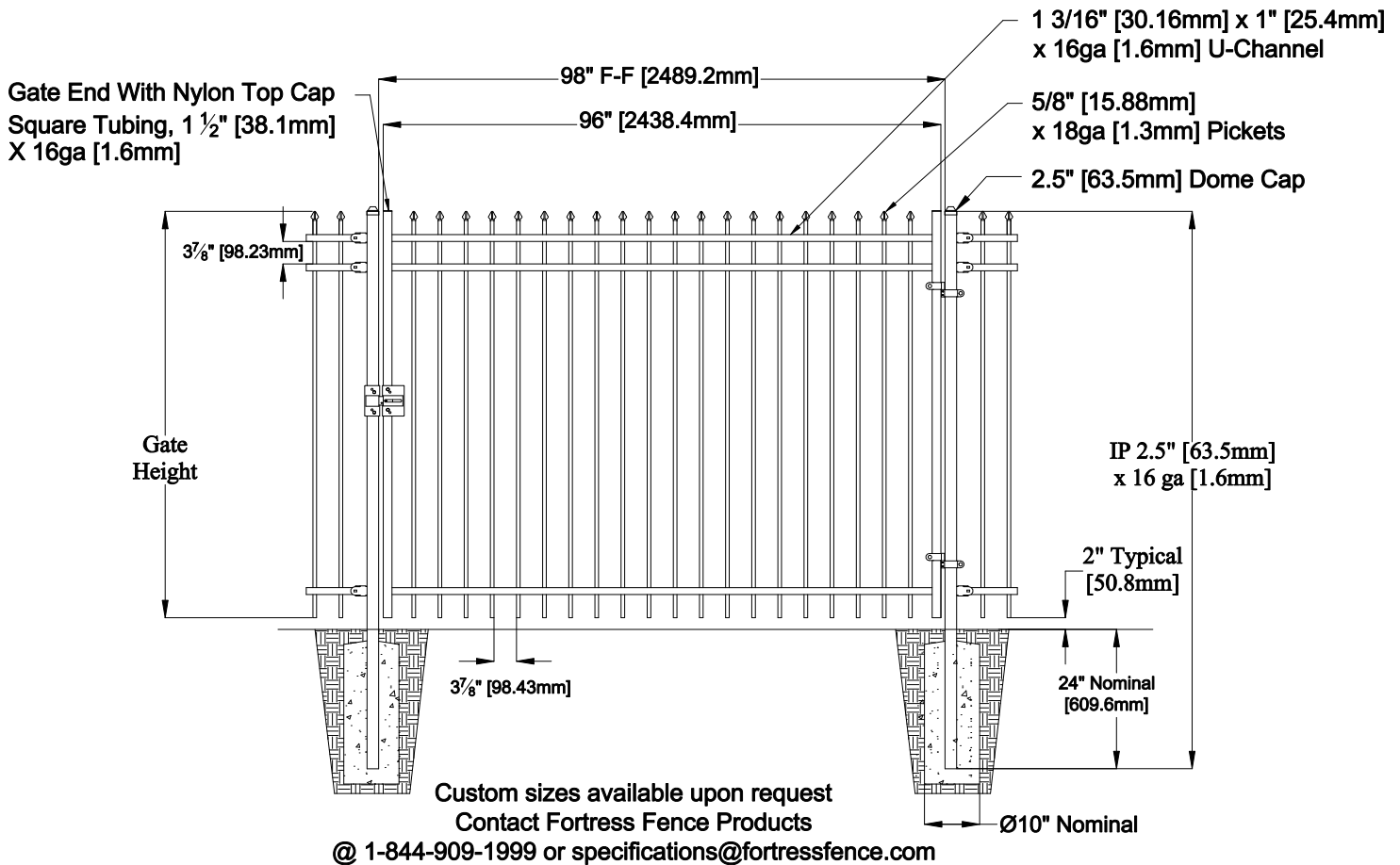

#### Applicable Hardware

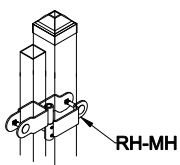
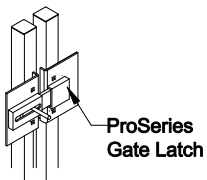

VERSAI RINGS-3D-RES  
for Level Installations  
(Optional)

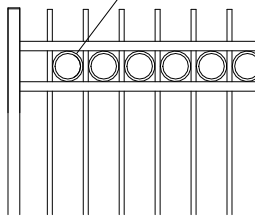

Architectural Grade Polyester Powder Coat

E-Coat

Zinc Phosphate Coating  
G-60 Pre-Galvanized Steel

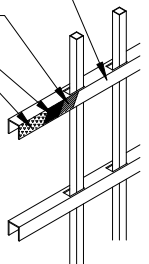

The product design contained on this drawing is proprietary to Fortress Iron, LP, Garland, Texas, USA, and is not to be copied electronically or manually, or reproduced in any manner, or divulged to other sources, without the expressed written permission of an authorized representative of Fortress Iron L.P. \*(Always consult local building codes)



Fortress Fence  
1720 North 1st Street  
Garland, TX 75040  
972-231-4132

Style: Pressed Spear

Height: 34", 46", 58", 70"

Gate Width: 96"

Class: Residential

Description: SP3-VERSAI-RES-08-DGP

Rev #:

Rev Date:

Scale: Do Not Scale

Drawn By: JS

Date: 3/31/17