

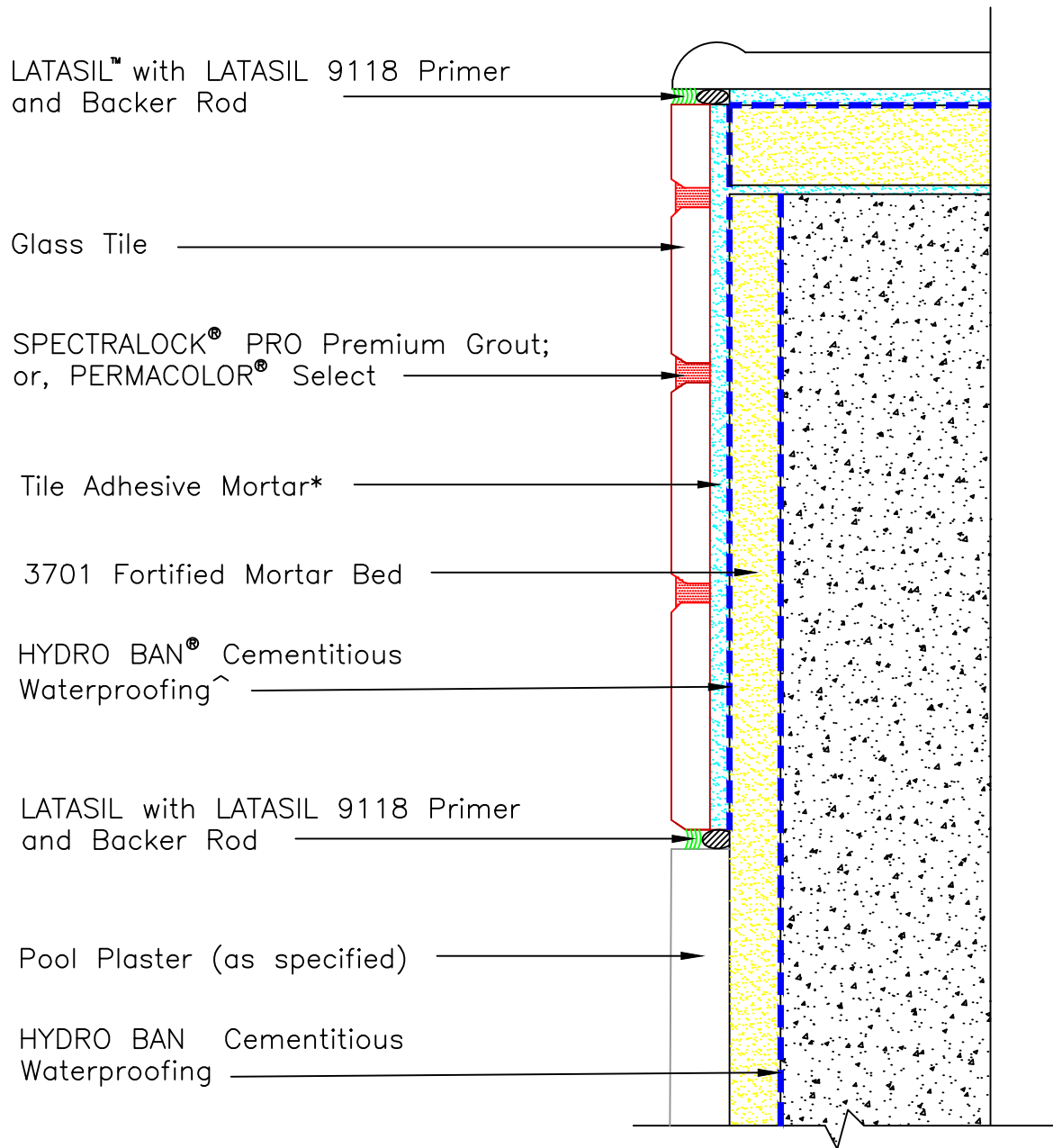

Drawing No. ES P602B Waterline Glass Tile



NOTE: Consult with pool plaster manufacturer on bond coat requirements under their material. * Tile Adhesive Mortar to be LATICRETE Glass Tile Adhesive Lite, 254 Platinum (White), 257 TITANIUM™ (White) or MULTIMAX™ LITE (White). ^ Check with glass tile manufacturer for requirement of cementitious waterproofing directly under their tile to prevent "ghosting".

Revision Date: 11/21

Scale: N.T.S.

AS A PROFESSIONAL COURTESY, LATICRETE OFFERS TECHNICAL SERVICES FREE OF CHARGE. THE USER MAINTAINS ALL RESPONSIBILITY FOR VERIFYING THE APPLICABILITY AND SUITABILITY OF THE TECHNICAL SERVICE OR INFORMATION PROVIDED.

(C)2021 LATICRETE INTERNATIONAL, INC. ALL RIGHTS RESERVED. THE RIGHT TO UTILIZE LATICRETE DETAILS FOR COMMERCIAL PURPOSES IS GRANTED EXCLUSIVELY TO CONTRACTORS, ARCHITECTS, QUANTITY SURVEYORS, ENGINEERS, AND SPECIFICATIONS WRITERS. ALL TRADEMARKS SHOWN ARE THE INTELLECTUAL PROPERTIES OF THEIR RESPECTIVE OWNERS.