



## Drawing No. ES RH122

Subfloor— Exterior Glue Plywood  
3/4" (19mm) or 23/32" (18mm)

Gypsum Underlayment poured (min. 3/4"  
[19mm] over tubes)

Hydronic Heating Tubes

HYDRO BAN<sup>®</sup> XP over hardened skim coat\*

Tile Installation Mortar\*

SPECTRALOCK<sup>®</sup> PRO  
Premium Grout; or,  
PERMACOLOR<sup>®</sup> Select

Ceramic Tile or Stone

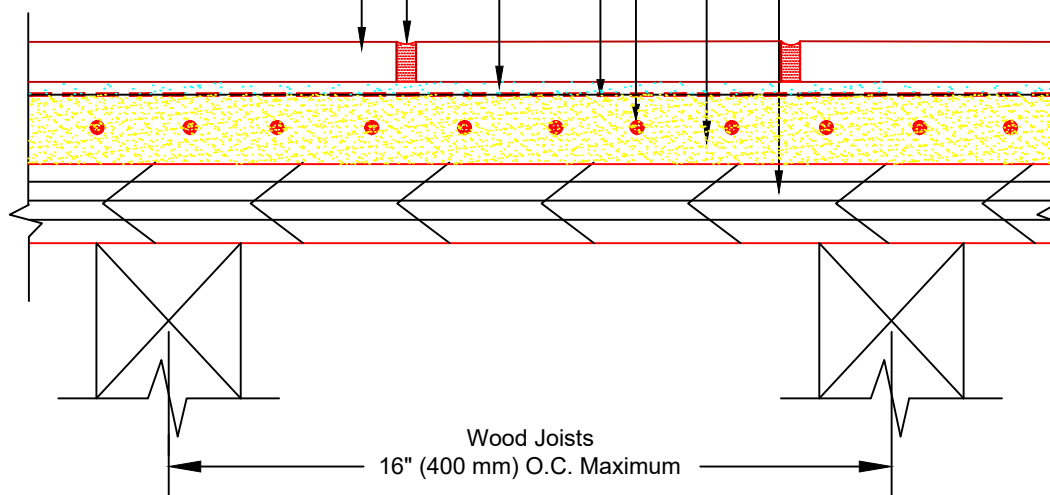

\* Skim coat and tile installation mortar to be either 254 Platinum, 257 TITANIUM<sup>™</sup> or MULTIMAX<sup>™</sup> LITE.

Revision Date: 11/21 Scale: N.T.S.

AS A PROFESSIONAL COURTESY, LATICRETE OFFERS TECHNICAL SERVICES FREE OF CHARGE. THE USER MAINTAINS ALL RESPONSIBILITY FOR VERIFYING THE APPLICABILITY AND SUITABILITY OF THE TECHNICAL SERVICE OR INFORMATION PROVIDED.

(C)2021 LATICRETE INTERNATIONAL, INC. ALL RIGHTS RESERVED. THE RIGHT TO UTILIZE LATICRETE DETAILS FOR COMMERCIAL PURPOSES IS GRANTED EXCLUSIVELY TO CONTRACTORS, ARCHITECTS, QUANTITY SURVEYORS, ENGINEERS, AND SPECIFICATIONS WRITERS. ALL TRADEMARKS SHOWN ARE THE INTELLECTUAL PROPERTIES OF THEIR RESPECTIVE OWNERS.