

LEGEND:

1: EXHAUST

GAS:

2: GAS INLET

3: 0.875" ELECTRICAL

ELECTRIC:

4: 2.5" ELECTRICAL

STEAM:

5: STEAM INLET

6: STEAM OUTLET

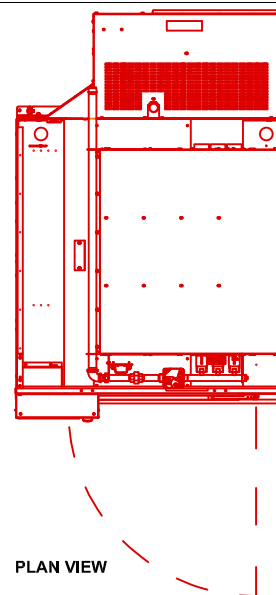

PLAN VIEW

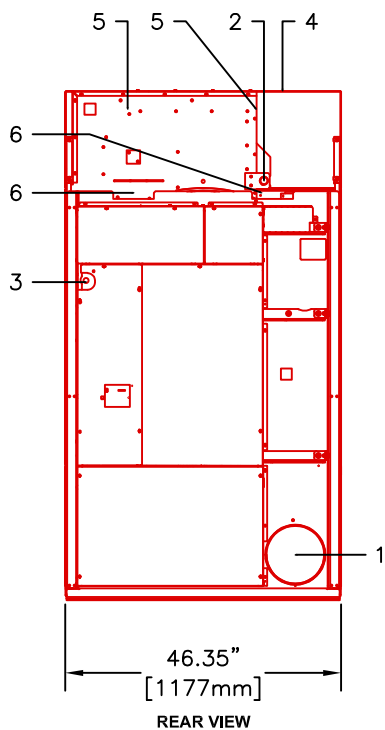

REAR VIEW

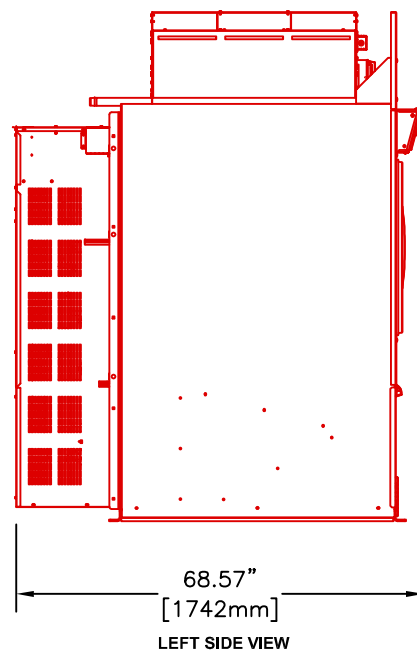

LEFT SIDE VIEW

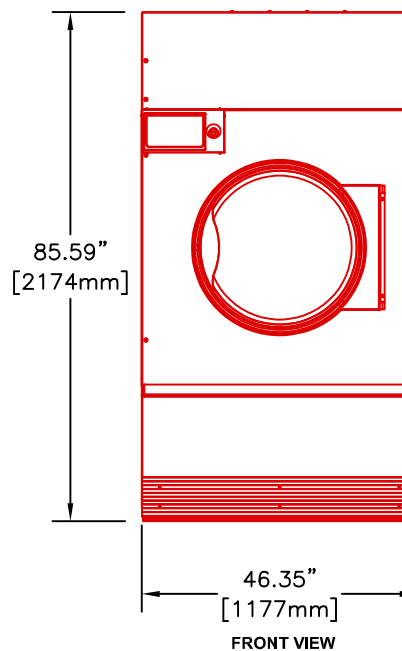

FRONT VIEW

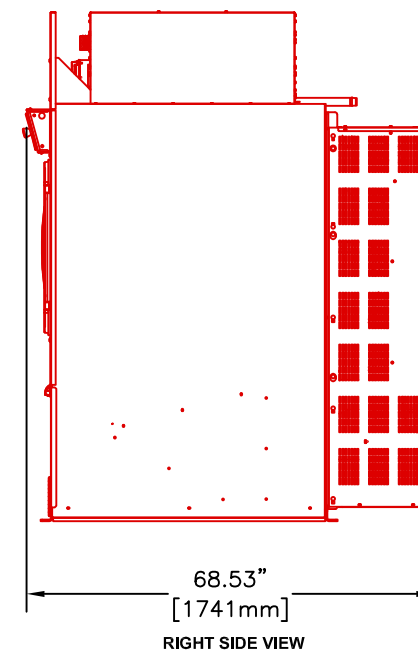

RIGHT SIDE VIEW

120 LB. TUMBLE DRYER (UT120)



Equipment specifications are subject to change without notice. Please use this drawing along with the installation manuals for updated equipment installation requirements.

KRP	CAD BLOCK	13-Apr-22
Drawn by	Description	Date