

a-fabco, Inc. Recommended Lead Lined Plywood Attachment Method

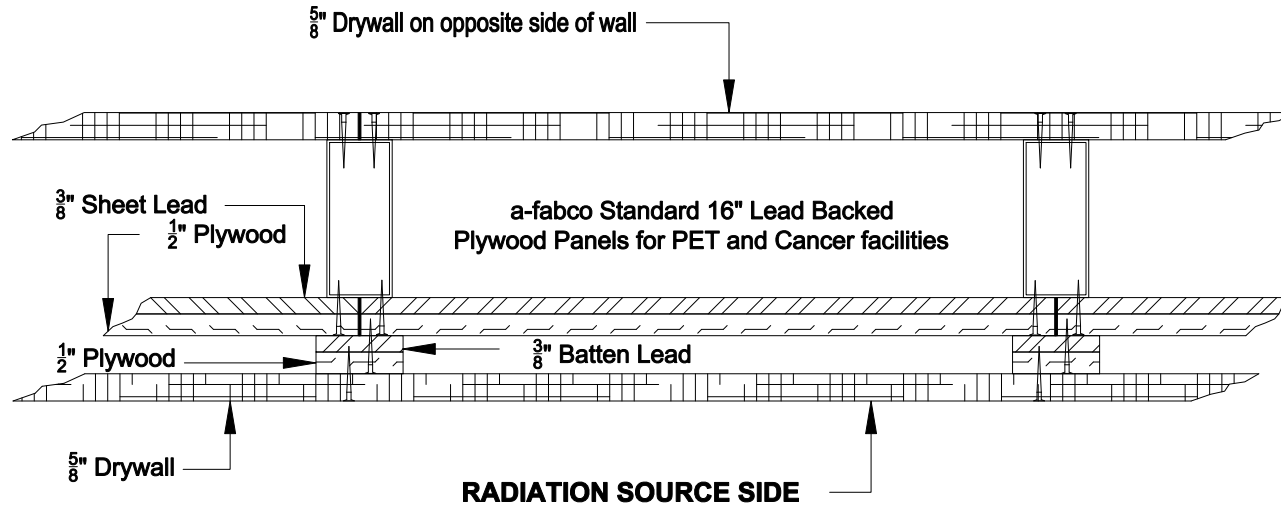

Above is a typical wall section using 16" wide lead plywood panels and 2" wide lead battens to physicist specified height.  
( Example )  $\frac{3}{8}$ " Lead on  $\frac{1}{2}$ " plywood. Panels are customarily used when lead thickness exceeds  $\frac{1}{8}$ " ( 3.175mm equiv.)  
Installation requires 16" stud centers up to  $\frac{3}{4}$ " lead. Decrease centers to 12" for  $\frac{3}{4}$ " and thicker lead.

1. All lead is glued to  $\frac{1}{2}$ " ,  $\frac{5}{8}$ " or  $\frac{3}{4}$ " plywood.
2. Battens are 2" wide. Lead thickness matches main panel lead thickness and lead height.
3. Panel and Batten combined thickness varies depending upon lead and plywood used and lead thickness specified.
4. Drywall screws should only penetrate drywall and batten plywood, not batten lead.
5. Custom wide throat door frames and borrow lite frames are required.

**a-fabco, inc. \* 800-330-5323**

**Gibsonton, FL 33534**

**DRAWN BY:** Allen Lynch

**CLIENT :** ARCAT AutoCAD Downloads

**PROJ:** X-ray & Radiation Protection - Sec. 13090

**SUBJ:** PET Plywood Panel Attachment

**DATE :** December 15, 2008