

5. PLACE INSIDE & OUTSIDE FRAMES INTO DOOR. INSERT THERMAL BREAK CLIPS AS SHOWN AROUND PERIMETER OF FRAME (NEAR EACH CORNER & APPROX. 8" - 10" ON CENTER.)

6. SQUARE CUT THE GLAZING BEAD TO LENGTHS REQUIRED. SNAP IN THE GLAZING BEAD PIECES AS SHOWN.

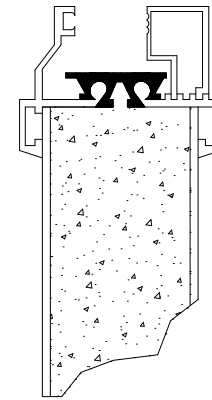

7. FOR FURTHER DETAILED INFORMATION REQUEST AMWELD FAB-A-FRAME DATA SHEET #5-53.