

NOTES:

- ① UL LISTED ARMORTEX BULLET RESISTANT COMPOSITES
  - ② UNFINISHED VENEER IS RED OAK OR BIRCH (ANY CUSTOM VENEER IS AVAILABLE)
  - ③ 16 GA. PRIMED PAINTED STEEL FRAME
  - ④ CORE - PARTICLE BOARD
- ⑤ CONTINUOUS GEAR HINGE
  - ⑥ ASTRAGAL (OPTIONAL)
  - ⑦ HARDWARE AS SPECIFIED (BY OTHERS) (UNLESS NOTED)

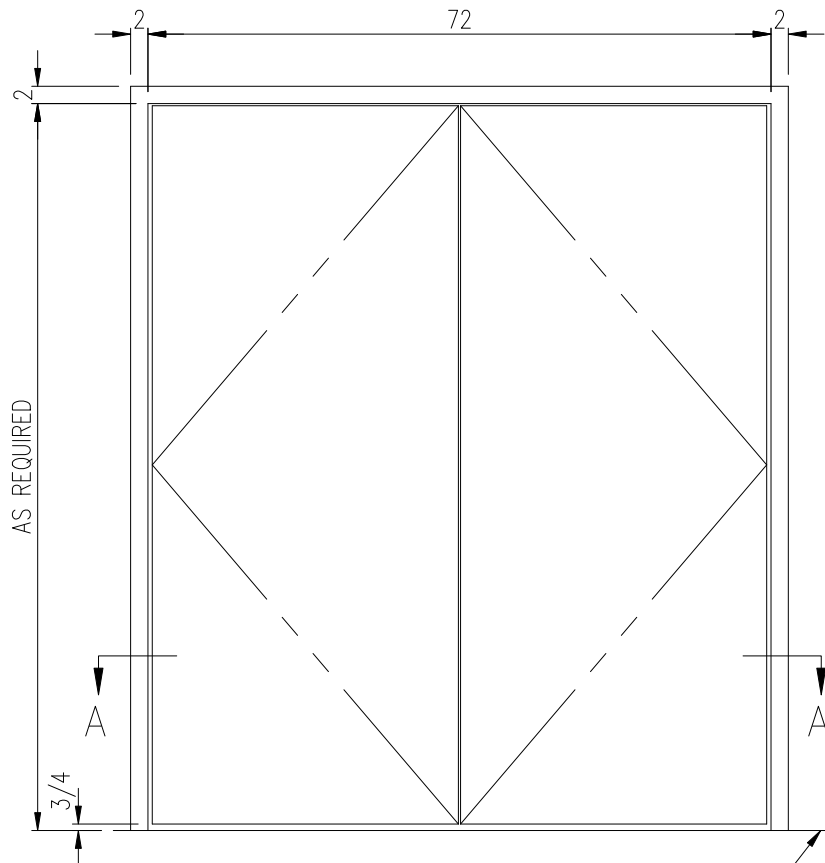

ELEVATION  
( — - REQUIRED)

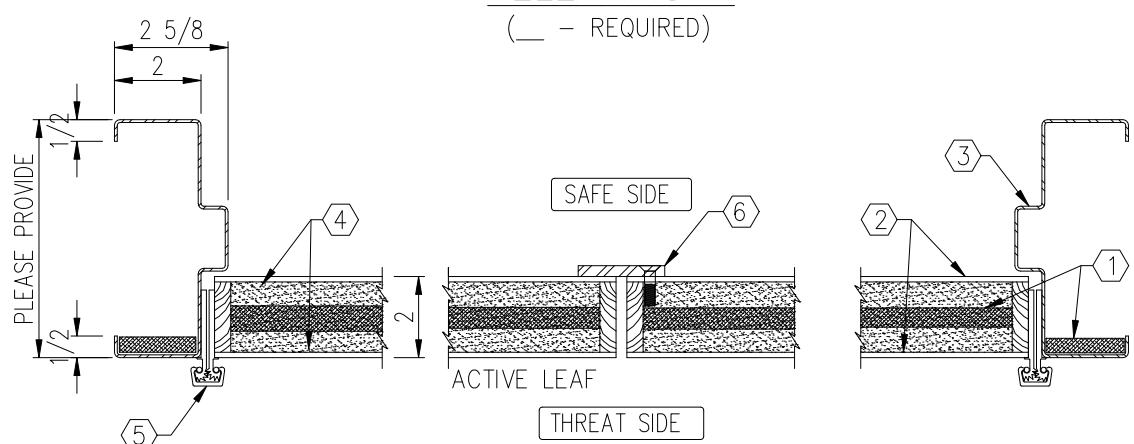

SECTION A-A

C:\ARMORTEX MASTERS - 2007\DOORS\D1012007.DWG.DWG 03/21/07 @ 10:41 User: operez

<b>REVISIONS</b>			<b>ARMORTEX</b> ® BULLET / BLAST RESISTANT PRODUCTS				<b>BALLISTIC LEVEL 4</b>	
No.	DESCRIPTION	DATE	5926 CORRIDOR PKWY SCHERTZ, TX 78154				DRN. BY:	DATE:
			TEL: 210-661-8306 800-880-8306 FAX: 210-661-8308				B. LEWIS	00-00-00
			TITLE:		PROJECT NAME:			
			ARMORTEX® BULLET RESISTANT DOUBLE WOOD DOOR					
			UNLESS OTHERWISE SPECIFIED ALL DIMENSIONS ARE IN INCHES		SCALE:	PROJECT No.	DRAWING No.	SHEET
					NONE		D1012007	1 OF 1