

(2) JAMB STUDS
BACK TO BACK.

CAP JAMB WITH 20GA. MIN.
TRACK FOR WINDOW ATTACHMENT.
EXTEND 6" ABOVE HEADER &
6" BELOW SILL CONNECTIONS

ATTACH JAMB MEMBERS USING
(2)#10-16 SCREWS @ 16"o.c.

OR

ATTACH JAMB MEMBERS USING
6" SECTION OF RUNNER TRACK,
20 GA. MINIMUM. USE (8)#10-16
SCREWS AS SHOWN.

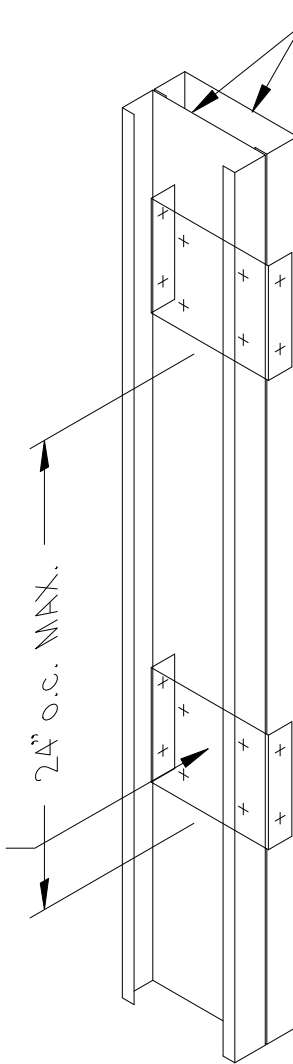

(2) JAMB STUDS

24" o.c. MAX.



CLARKWESTERN
DESIGN

East Coast - Atlanta, GA
20 Mansell Court East, Suite 350B
Roswell, GA 30076

West Coast - San Diego, CA
2035 Corte Del Nogal, Suite 165
Carlsbad, CA 92011

Toll Free Phone: 877-832-3206

TIED JAMB STUDS

JAMB STUDS ATTACHED USING
PIECES TRACK