

6 PLAN OF HALF CAPITAL  
SCALE 1/8" = 1'-0"

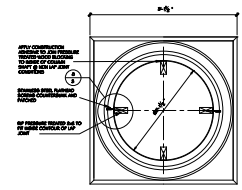

4 CAPITAL FROM BELOW  
SCALE 1/8" = 1'-0"

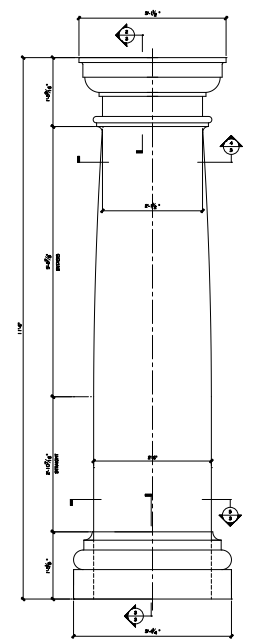

1 ELEVATION OF 30° COLUMN  
SCALE 1/8" = 1'-0"

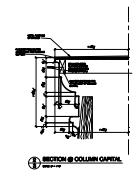

B SECTION B-C COLUMN CAPITAL

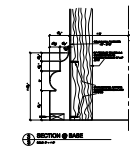

B SECTION B-B BASE

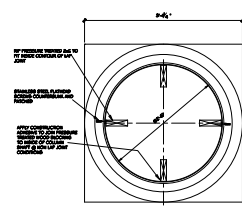

5 PLAN OF BASE  
SCALE 1/8" = 1'-0"

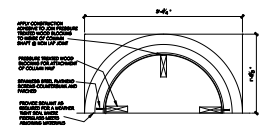

7 PLAN OF HALF BASE  
SCALE 1/8" = 1'-0"