

INSIDE PERIMETER DETAIL- 'L' TRIM

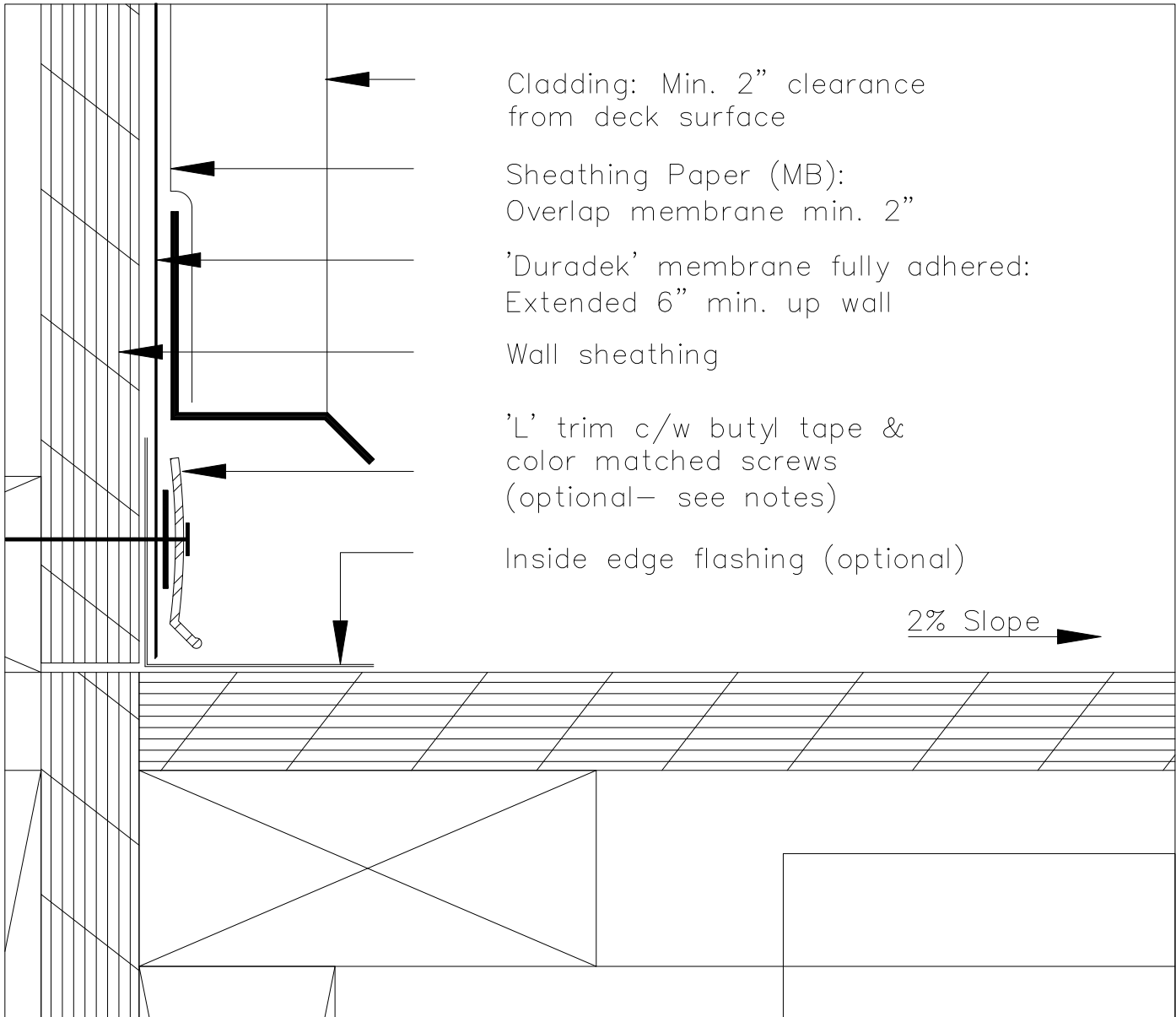

Cladding: Min. 2" clearance from deck surface

Sheathing Paper (MB):
Overlap membrane min. 2"

'Duradek' membrane fully adhered:
Extended 6" min. up wall

Wall sheathing

'L' trim c/w butyl tape & color matched screws (optional— see notes)

Inside edge flashing (optional)

2% Slope →

NOTE: 'Duradek' 'L' trim fixation bar not required if: field of membrane adhered with 'Duradek' acrylic latex adhesive, July 25% dry bulb temperature does not exceed 29 deg C (84.2 deg F), maximum basic wind speed does not exceed 80 mph (129 km/h) or maximum basic wind speed (3-second gust) does not exceed 100 mph (161 km/h). See 'Duradek' bulletin for details.

NOTE:

AS A SUPPLIER OF FINISHED PRODUCT ONLY, DURADEK LTD. DOES NOT ASSUME RESPONSIBILITY FOR ERRORS IN DESIGN, ENGINEERING, OR DIMENSIONS. THE ARCHITECT, ENGINEER, SPECIFIER, CONTRACTOR OR OWNERS' REPRESENTATIVE MUST VERIFY ALL DIMENSIONS, SIZES & SUITABILITY OF DETAILS.

DURADEK LTD.

CANADA
UNITED STATES

Bus: (604) 591-5594
Bus: (816) 421-5830

Fax: (604) 591-3100
Fax: (816) 421-2924

SYSTEM:
ALL ASSEMBLIES

DATE: 31/08/04
REV. DATE:

DRAWING No.:
IS-01

