

# INSIDE PERIMETER DETAIL- THROUGH WALL FLASHING

Positive tie in to building paper/ASM  
(by others)

Masonry Wall (by others)

Weep Holes (by others)

Metal thru-wall flashing  
(by others)

24 GA pre-finished metal c/w  
hemmed edge. Edge to be placed  
firmly on surface of deck membrane.  
Fasteners to have neoprene heads &  
be fastened through butyl tape.

If face of masonry wall irregular m/f  
 $\frac{1}{2}$ " 'Hardibacker' or ext. gr. plywood  
@ 8" O.C.- staggered.

'Duradek' membrane  
fully adhered

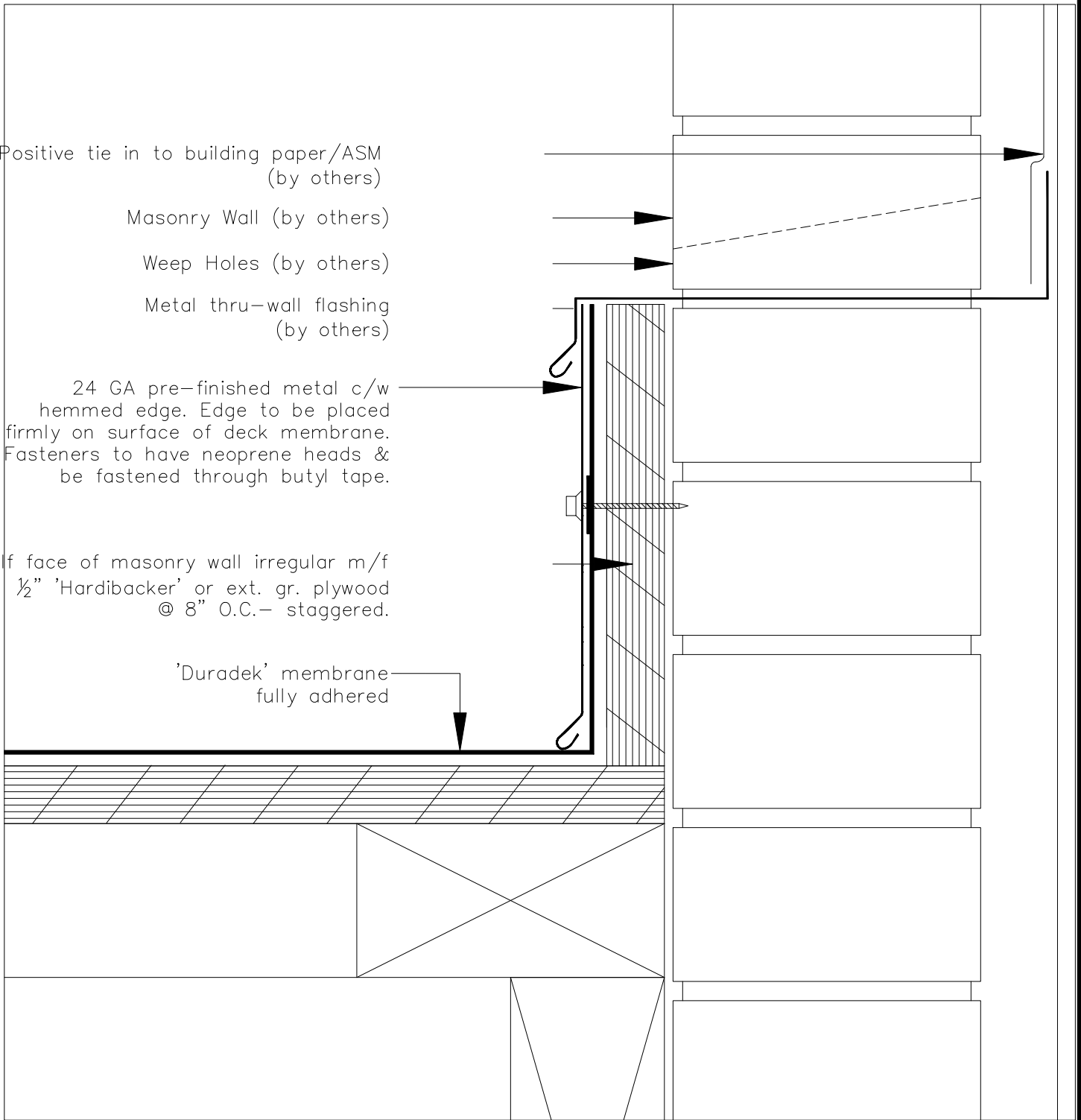

**NOTE:**

AS A SUPPLIER OF FINISHED PRODUCT ONLY, DURADEK LTD. DOES NOT ASSUME RESPONSIBILITY FOR ERRORS IN DESIGN, ENGINEERING, OR DIMENSIONS. THE ARCHITECT, ENGINEER, SPECIFIER, CONTRACTOR OR OWNERS' REPRESENTATIVE MUST VERIFY ALL DIMENSIONS, SIZES & SUITABILITY OF DETAILS.

**DURADEK LTD.**

CANADA  
UNITED STATES

Bus: (604) 591-5594  
Bus: (816) 421-5830

Fax: (604) 591-3100  
Fax: (816) 421-2924

SYSTEM:  
ALL ASSEMBLIES

DATE: 31/08/04  
REV. DATE:

DRAWING No.:  
IS-06

