

REVISIONS			
REV	DESCRIPTION	DATE	APPROVED

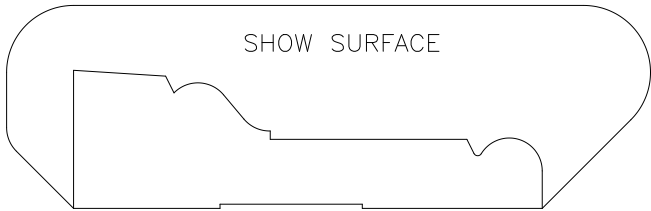
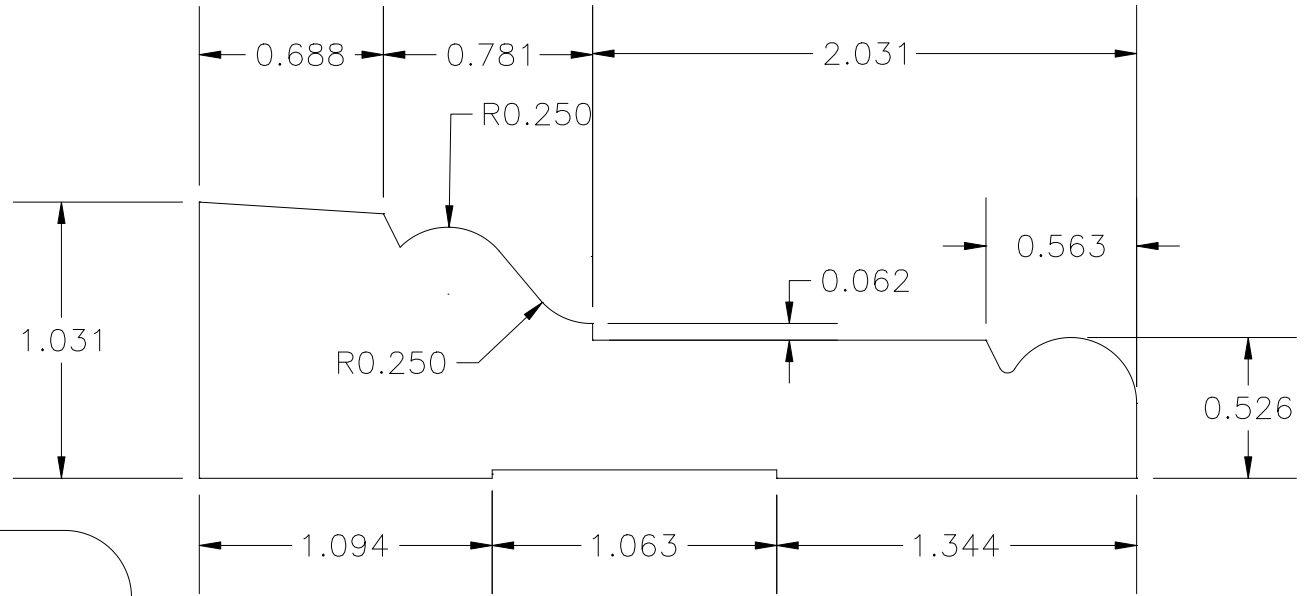

1:1

AREA CALCS = 2.308 IN<sup>2</sup>

SIGNATURES		TOLERANCES		WILLIAM & MARY ADAMS CASING						
DRAWN	DATE		<b>BOW TOLERANCE: +/- .375" OVER A DISTANCE OF 6"</b>	ALL TOLERANCES MEASURED IN INCHES		[Signature Box]				
CUSTOMER APPROVAL			<b>SKI TOLERANCE: +/- .500" OVER A DISTANCE OF 6"</b>	ALL TOLERANCES: +/- .030 UNLESS OTHERWISE SPECIFIED		SIZE <b>B</b>	SCALE <b>2:1</b>	DRAWING <b>P-0358</b>	DRAWN BY <b>J. PORTH JR.</b>	REV
FINAL APPROVAL			<b>CUP TOLERANCE: +/- .030"</b>			QUOTE	DATE <b>11-24-1998</b>		<b>A</b>	
				2030 W Bender Rd. Milwaukee, WI 53209 (414) 228-9800		THIS DOCUMENT AND DESIGN ARE THE PROPERTY OF GOSSEN CORP. UNAUTHORIZED USE, REPRODUCTION OR DISCLOSURE IS PROHIBITED WITHOUT PRIOR WRITTEN CONSENT				