

**SPECIFICATIONS**

UNITS  
 UNIT SIZE - 50 CM X 50 CM X 2.5 CM  
 (20" X 20" X 1")  
 AVAILABLE IN 9 STANDARD ROLL SIZES

UNIT WEIGHT - 558 GRAMS (19 OZ.)  
 OR 2.2 KG (4.8 POUNDS)

STRENGTH - 402 KG/CM (5720 PSI)

COLOR - BLACK (STANDARD)

RESIN - 95% POST-CONSUMER  
 RECYCLED HDPE/LDPE

FABRIC  
 WEIGHT - 2.25 OZ./SY ( 76.3 <sup>2</sup>GM/M )  
 TENSILE - 65 x 40 LB/FT (585 KG/M )

SLOPETAME2 CROSS-BRACING

SLOPETAME2 UNITS

SLOPETAME2 FABRIC

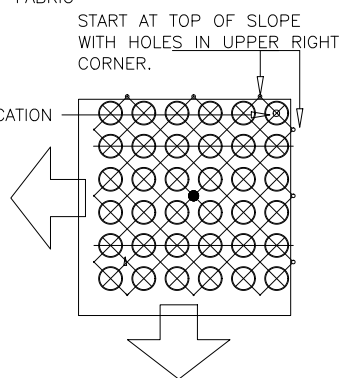
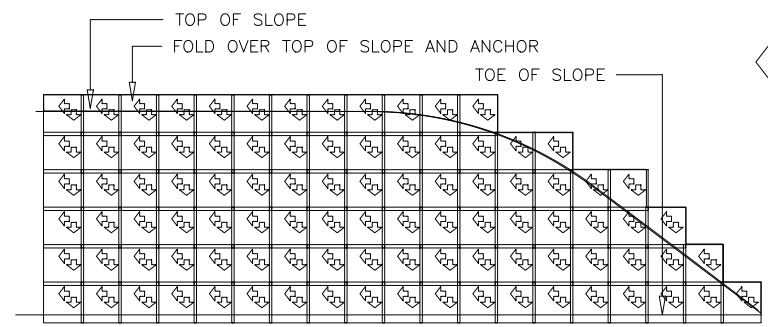

PLACE ROLLS GOING DOWN THE SLOPE WITH CROSS-BRACING RUNNING ACROSS THE SLOPE

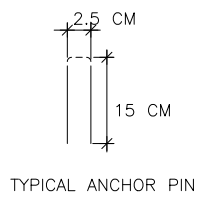
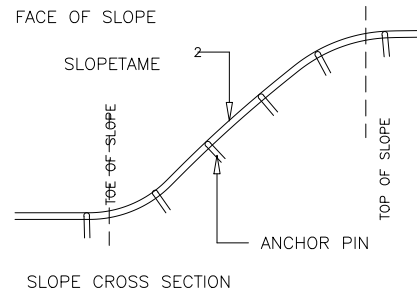

**TYPICAL SLOPETAME2 ASSEMBLY AND ANCHORAGE**