

**ROOF TO WALL SEAL SYSTEM. 6"**  
**(RW-6)**

	Movement	
	Expansion	Compression
<b>Top Seal</b>	<b>9"</b>	<b>To 1-1/4"</b>
<b>Gutter</b>	<b>12"</b>	<b>To 1-1/4"</b>

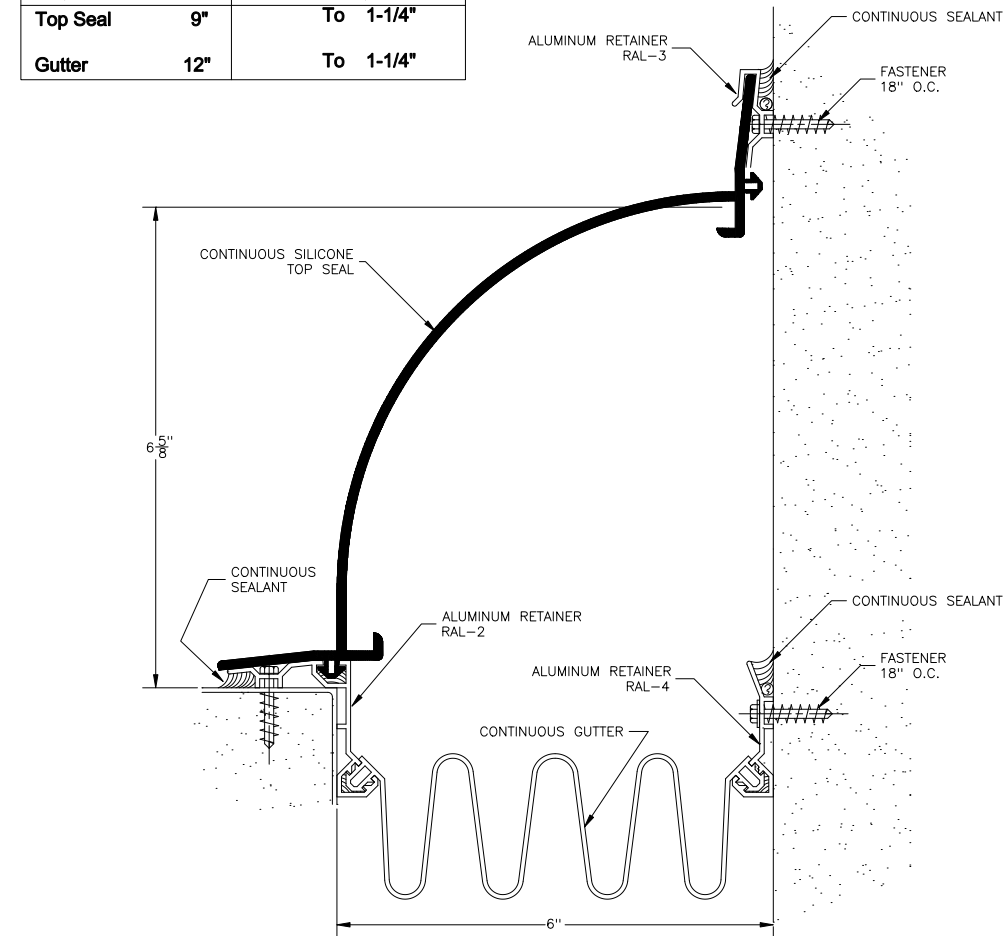

**GENERAL SPECIFICATIONS**  
 ROOF SEALS ARE SEISMIC EXPANSION JOINT SEALS EXTRUDED FROM SILICONE AND PRODUCED BY THE MICHAEL RIZZA CO. THE FACE AND ELASTOMERIC BACK SEAL ARE SECURED IN ALUMINUM RETAINERS USING A HIGH QUALITY SILICONE COMPATIBLE SEALANT. THE DESIGN OF THE BACK SEAL AND RETAINERS ALLOWS CONTINUOUS INSTALLATION THROUGH VERTICAL TRANSITIONS. CLOSED-CELL NEOPRENE IS USED FOR SUPPORT AT CORNERS, TEES AND CROSSES. DESIGN CAN UTILIZE UL AND ICBO FIRE RATED BARRIERS. ALUMINUM EXTRUSIONS ARE 6063-T5 ALLOY AND TEMPER. SILICONE EXTRUSIONS MEET ASTM D2000, 4GE, 709 M, ARE UV STABILIZED AND DO NOT PROPAGATE FLAME. COLOR, AS SELECTED BY THE ARCHITECT.

**FASTNERS**  
 MICHAEL RIZZA CO. RECOMMENDS THAT ALUMINUM RETAINERS BE MECHANICALLY FASTENED AT 18" O.C. INSTALLER SHALL DETERMINE APPROPRIATE FASTENERS (BY OTHERS) DEPENDENT ON STRUCTURAL MATERIAL. STRUCTURAL ADHESIVES (BY OTHERS) MAY BE USED IN CONJUNCTION WITH, OR IN PLACE OF, FASTENERS IF APPROVED BY ARCHITECT AND BE IN ACCORDANCE WITH SEALANT MANUFACTURER'S RECOMMENDATIONS.

NO PART OF THIS DESIGN MAY BE REPRODUCED OR COPIED IN ANY FORM OR BY ANY MEANS; GRAPHIC ELECTRONIC OR MECHANICAL, INCLUDING PHOTOCOPYING, WITHOUT WRITTEN PERMISSION OF THE DESIGNER.

MICHAEL RIZZA COMPANY CO. INC. P.O. BOX 545 BORING, OR 97009 PHONE: 503-663-2418 FAX: 503-663-9685	PROJECT	DATE:	JOB#:	DRG. NO.
JOB:		SCALE: NONE	DRAWN: JBD	