

# REPUBLIC'S DE SERIES EMBOSSED DOOR

DIMENSIONS IN ( ) ARE METRIC.

1 LB. TO 1.25 LB.  
DENSITY PCF  
REGULAR GRADE  
EXPANDED  
POLYSTYRENE  
CORE

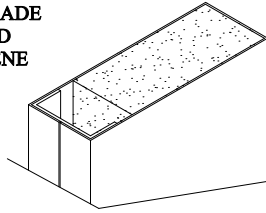

## DOOR CONSTRUCTION DETAILS

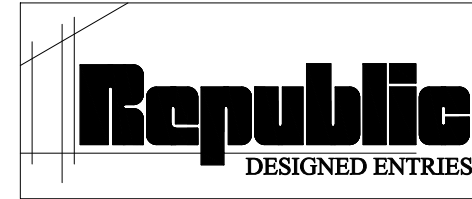

Flush Top Continuous  
16 Ga. Steel Channel

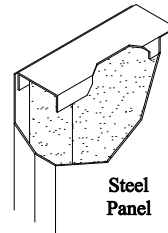

12 Ga. Closer  
Reinforcement (OPT.)

Steel  
Panel

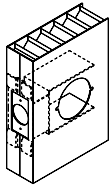

16 Ga. steel cylindrical lock reinforcement with provisions for Gov't Series 160 or 161 cylindrical lock sets (2-3/4" backset) and ANSI A115.2 lock front (1-1/8" x 2-1/4")

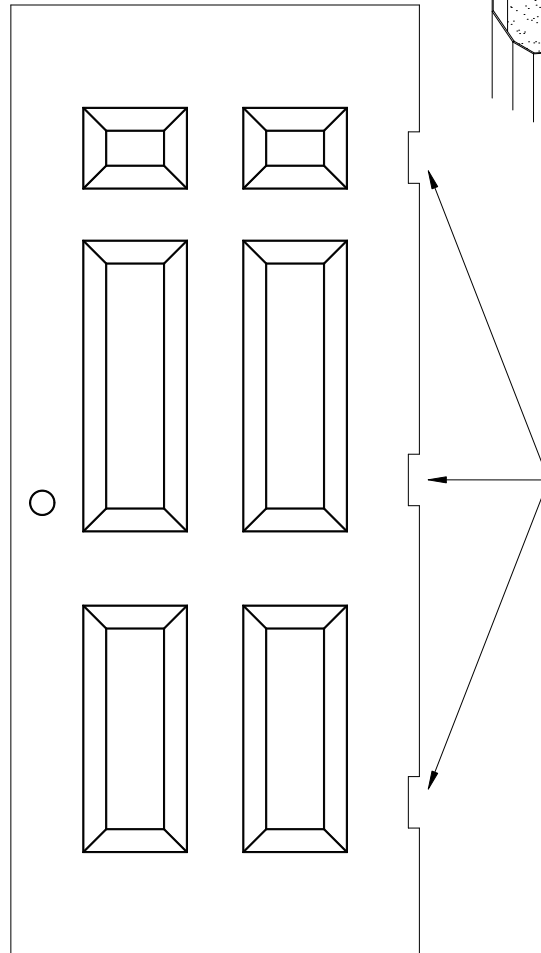

Lever Lock Prep -161 DT  
(Modified 161 Prep)  
Conforms with the ANSI  
115.18 161 lever lock  
Spec.

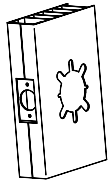

**WARNING:** Use ROSE TRIM with a minimum diameter of 3-5/16" to cover prep.

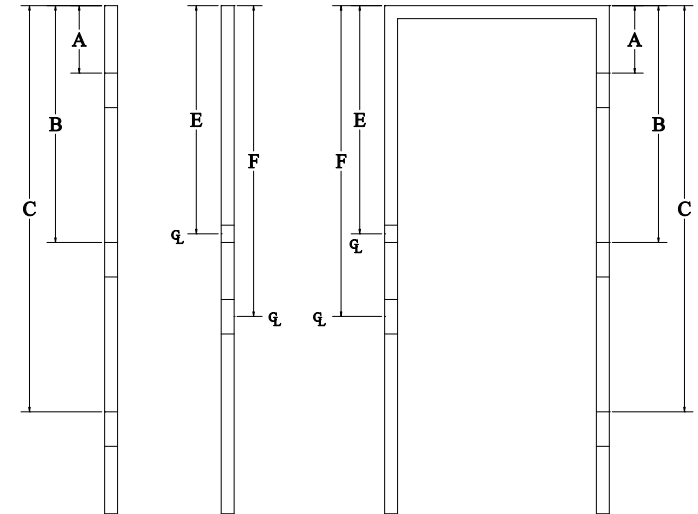

Continuous 11 gauge or segmented 16 gauge with integral 3/16"(5) reinforcement steel channel compatible with 4 1/2"(114) x 4 1/2"(114) full mortise template hinges

DOOR BOTTOM

Continuous  
16 Ga. Steel  
Channel

Steel Panel

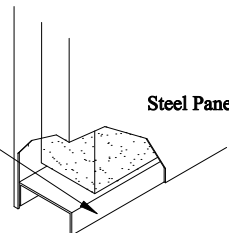

Cold-Rolled or Galvanized Steel.  
Available with Polystyrene Core Only.  
Available in 18 or 20 Gage.

U.L. Labelable Construction, 1-1/2" Hr. "B" Label.  
Maximum: 3472 Sgl. 6872 Dbl. Without Fire Exit Hardware.  
Size Limitations: Minimum - 2868 / Maximum - 3672

DIMENSIONS IN ( ) ARE METRIC

For Standard hardware Locations  
refer to Technical Data Sheet No. 502