

**SECTION - 1**  
**HANGER ROD LANDING SUPPORTS**  
**FOR STUDWALL/DRYWALL PARTITION AND**  
**HOLLOW MASONRY BLOCK WALL FRAMED STAIRWELLS**

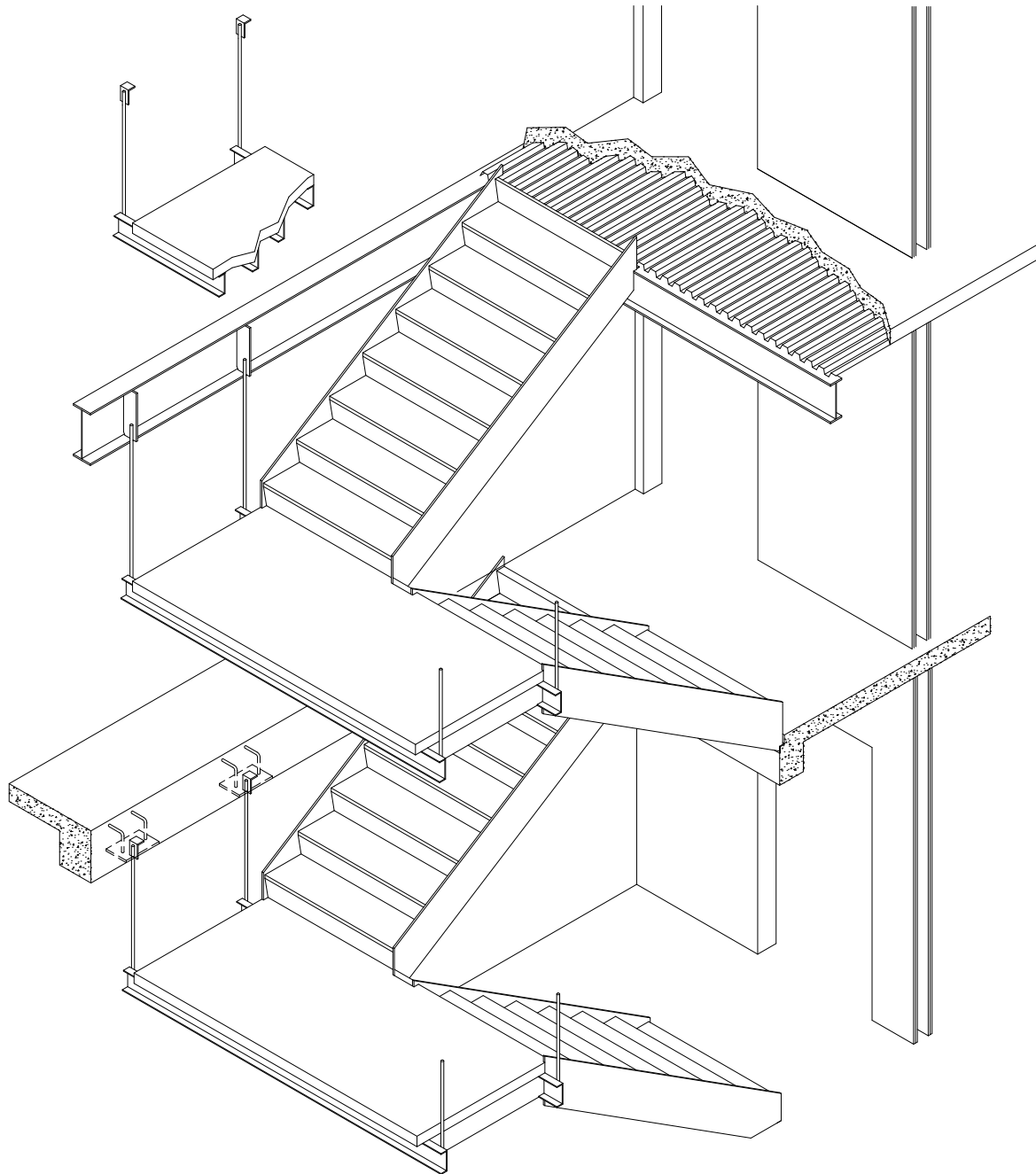

FOR A COMPLETE SET OF STRUCTURAL CONNECTION DETAILS PLEASE VISIT [WWW.SHARONSTAIR.COM](http://WWW.SHARONSTAIR.COM)



**SECTION 1**

HANGER ROD LANDING SUPPORTS

5TH EDITION

1-1