

DuraFLEX

PREMIUM FITNESS FLOORING

P.O. BOX 239, 4393 DISCOVERY LINE
 PETROLIA, ONTARIO
 N0N 1R0
 PHONE: (800) 263-2363
 PHONE: (519) 882-8799
 FAX: (519) 882-2697
 EMAIL: allinfo@sofsurfaces.com

INSTALLATION OF DuraFLEX® TILE AGAINST A VERTICAL SURFACE (CONCRETE CURB or WALL)

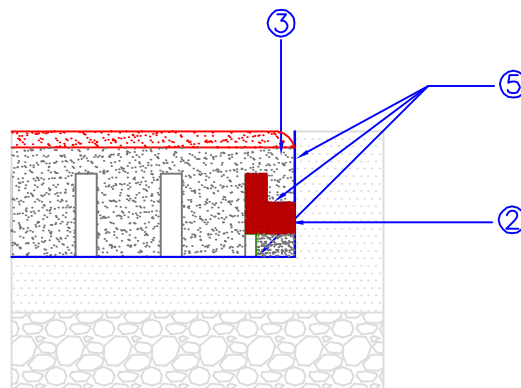
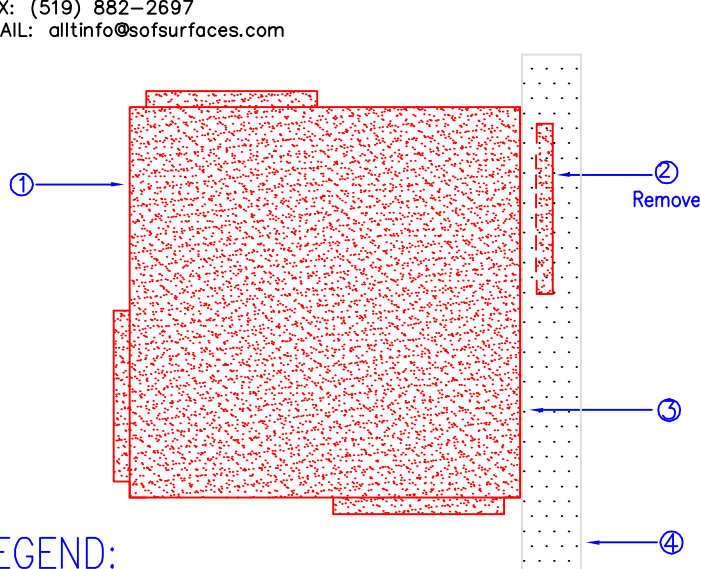

SECTION

Shows Outer Channel Inserted
 Underneath Inner Channel
 For Support.

LEGEND:

- ① DuraFLEX.®
- ② Outer Channel.
- ③ Inner Channel.
- ④ Vertical Surface (Curb, Wall or Timber) See Specifications for Details.
- ⑤ Applied Adhesive (See Installation Instructions Below).

INSTALLATION INSTRUCTIONS:

1. Cut Outer Channel ② Flush With Edge of Tile to Allow Installation Against Vertical Surface.
2. Rotate and Insert Outer Channel ② Underneath Adjacent Inner Channel ③.
3. Apply Sikaflex Adhesive to Hold Outer Channel in Place.

REVISIONS

REV	DESCRIPTION	DATE	APPR
0	ORIGINAL ISSUE	12/17/07	

SIZE A	FSCM NO.	DWG NO. 2000-005	REV 0
FILE NAME DuroFLEX	PREPARED BY B. GOSS	SCALE	SHEET 1