

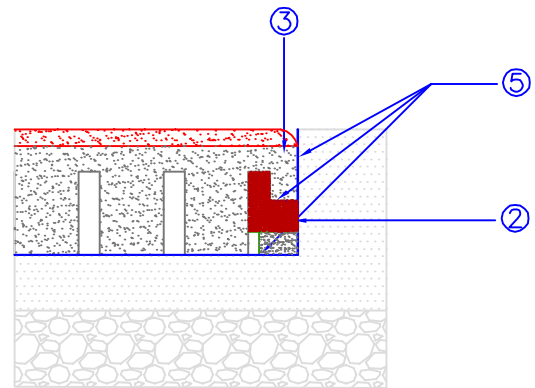

P.O. BOX 239, 4393 DISCOVERY LINE  
 PETROLIA, ONTARIO  
 NON 1R0  
 PHONE: (800) 263-2363  
 PHONE: (519) 882-8799  
 FAX: (519) 882-2697  
 EMAIL: alltinfo@sofsurfaces.com

## INSTALLATION OF KrosLOCK® TILE AGAINST A VERTICAL SURFACE (CONCRETE CURB, WALL OR TIMBER)

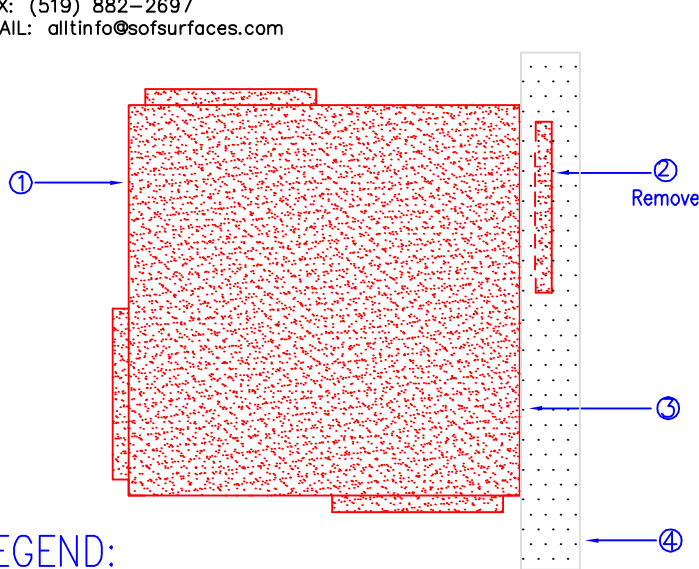

### SECTION

Shows Outer Channel Inserted  
 Underneath Inner Channel  
 For Support.

### LEGEND:

- ① SofTILE® (See Specifications for Thickness and Color).
- ② Outer Channel.
- ③ Inner Channel.
- ④ Vertical Surface (Curb, Wall or Timber) See Specifications for Details.
- ⑤ Applied Adhesive (See Installation Instructions Below).

### INSTALLATION INSTRUCTIONS:

1. Cut Outer Channel ② Flush With Edge of Tile to Allow Installation Against Vertical Surface.
2. Rotate and Insert Outer Channel ② Underneath Adjacent Inner Channel ③.
3. 1/2" Diameter Continuous Bead of SofTILE Adhesive at Each KrosLOCK Joint.
4. Apply SofTILE Adhesive to Hold Outer Channel in Place. In addition, adhere the edge of the SofTILE surface to the surrounding retainer wall as well as the first 12" of the SofTILE surface (bottom) around the perimeter of the area.

THICKNESS	CRITICAL FALL HEIGHT (FT)		REVISIONS			
	WITH 10 YEAR PERFORMANCE WARRANTY	WITH 10 YEAR PERFORMANCE WARRANTY	REV	DESCRIPTION	DATE	APPR
	PLUS SERIES	PREMIUM SERIES (EPDM)				
1.75"	3.0	3.0	0	ORIGINAL ISSUE	12/17/03	
2.00"	4.0	4.0	1	ADJUSTED ADHESIVE APPLICATION	10/20/04	
2.25"	5.0	5.0	2	REVISED	02/02/06	
2.50"	6.0	6.0				
2.75"	7.0	7.0				
3.75"	8.0	8.0				
4.00"	10.0	10.0				
			SIZE	FSCM NO.	DWG NO.	REV
			A		1SK5	2
			SCALE		NTS	SHEET

FILE NAME **A0001SK5** PREPARED BY **B.GOSS**