

VersiWeld[®] ROOFING SYSTEM

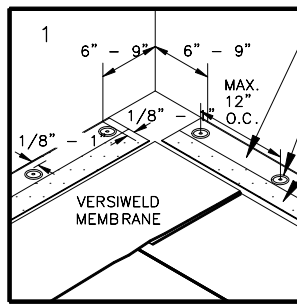

6" WIDE TPO PRESSURE-SENSITIVE RUSS

VERSICO PLATE AND FASTENER, MAX. 12" O.C.

PRE-APPLIED QA TAPE

INSTALL TPO PRESSURE-SENSITIVE RUSS AND FASTEN TO ROOF DECK WITH APPROVED VERSICO FASTENERS AND PLATES, MAX. 12" O.C.

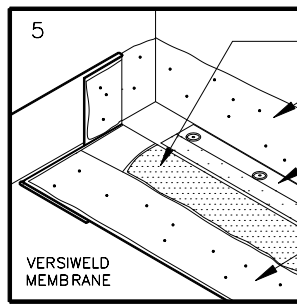

V-150 PRIMER

BONDING ADHESIVE

6" WIDE TPO PRESSURE-SENSITIVE RUSS

BONDING ADHESIVE

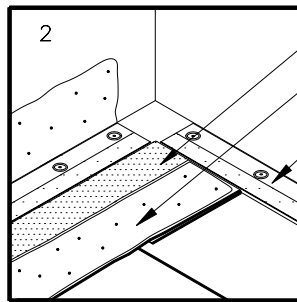

V-150 PRIMER

BONDING ADHESIVE

6" WIDE TPO PRESSURE-SENSITIVE RUSS

FOR RUSS SECUREMENT, REFER TO DETAIL VWC-12.3 OR VWC-12.4.

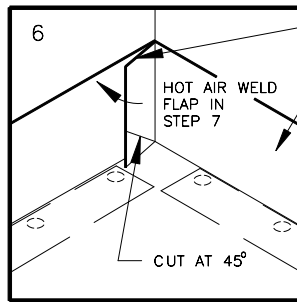

1-1/2" (40 mm) WIDE MIN.

VERSIWELD MEMBRANE

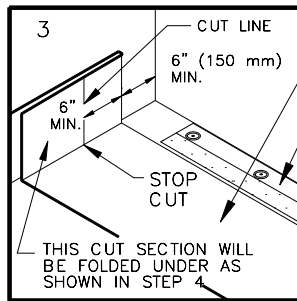

VERSIWELD MEMBRANE

6" WIDE TPO PRESSURE-SENSITIVE RUSS

THE CUT SECTION OF VERTICAL MEMBRANE WILL BE FOLDED UNDER THE FIELD MEMBRANE AS SHOWN IN STEP 4.

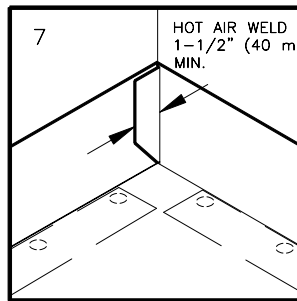

HOT AIR WELD 1-1/2" (40 mm) MIN.

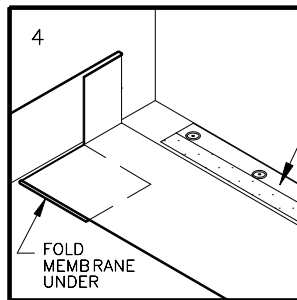

6" WIDE TPO PRESSURE-SENSITIVE RUSS

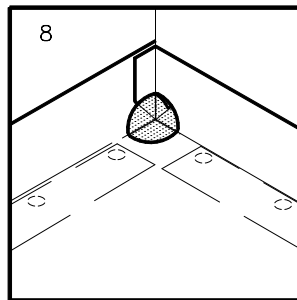

APPLY VERSICO INSIDE CORNER IN ACCORDANCE WITH VERSICO DETAIL VWC-15.1 OR VWC-15.2

APPLY CUT-EDGE SEALANT TO CUT EDGES OF VERSIWELD REINFORCED MEMBRANE.

VWC-15.5
INSIDE CORNER
TPO PRESSURE-SENSITIVE (PS) RUSS

VERSICO
INCORPORATED



A subsidiary of Carlisle SynTec Incorporated
© 2006 VERSICO INCORPORATED