

Model APF5436 BF .75 5P R

SIDE VIEW

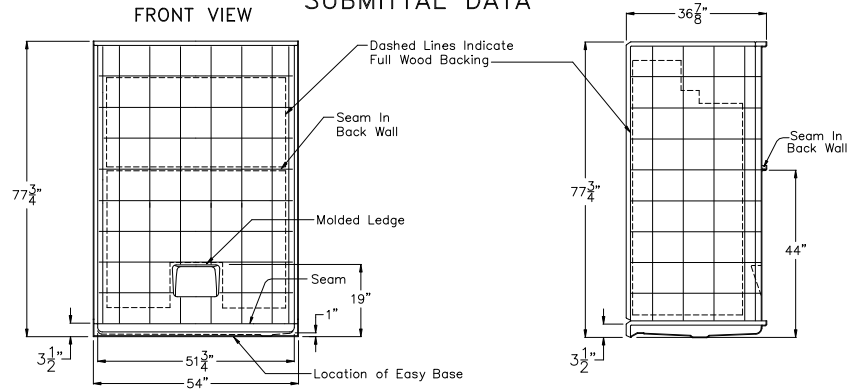

The sectional shower shall be APF5436 BF 1.0 5 Piece right drain. Finished surface shall be of a sanitary-grade polyester Gelcoat exhibiting a minimal thickness of 15 dry mils, and a finished cured Barcol hardness of 80-90 as tested with ASTM D-2583. Unit construction shall be of molded reinforced fiberglass with a minimum 15% fiberglass content.

The enclosure shall be equipped with the following installed accessories:

- 1) Low entry 1" Threshold,
- 2) Tile Finish,
- 3) Low Molded Shelf,
- 4) Five Piece Sectional Design,
- 5) Two Piece Back Wall,
- 6) Right Hand Drain Location,
- 7) Full Wood Backing On Walls,
- 8) Factory installed Easy Base self sustaining bottom.

Diagram illustrating the profile of a finished floor and base. The finished floor is shown with a 1/4" slope per foot. The base is labeled "Easy Base". Dimensions include a 1.0" height for the finished floor, a 1/4" height for the base, and a 3/4" height for the base. The base is shown with a 1/8" gap from the wall and a 5/8" gap from the floor.

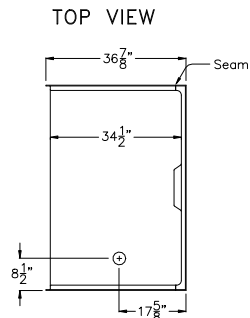

STATE HANDING WHEN ORDERING
HANDED BY THE DRAIN.
Right Hand Shown, Left Available

DUE TO THE NATURE OF THE MATERIALS INVOLVED
UNIT DIMENSIONS MAY VARY $\pm 1/2$ INCH

Drawing#: APF5436 BF .75 5P FWB
Easy Base Right

Approved By Print Name:	Date Approved:	Date: 3-31-09	Revised: 1-15-14
Approved By Signature:	Wholesaler:	Quote No.	

ACCESSIBILITY PROFESSIONALS
4 ALLIANCE BLVD. UNIT 123 BARRIE, ONTARIO CANADA L4M 7G3
1 (877) 947-7769 - www.AccessibilityPro.com

Model APF5436 BF .75 5P R-BP

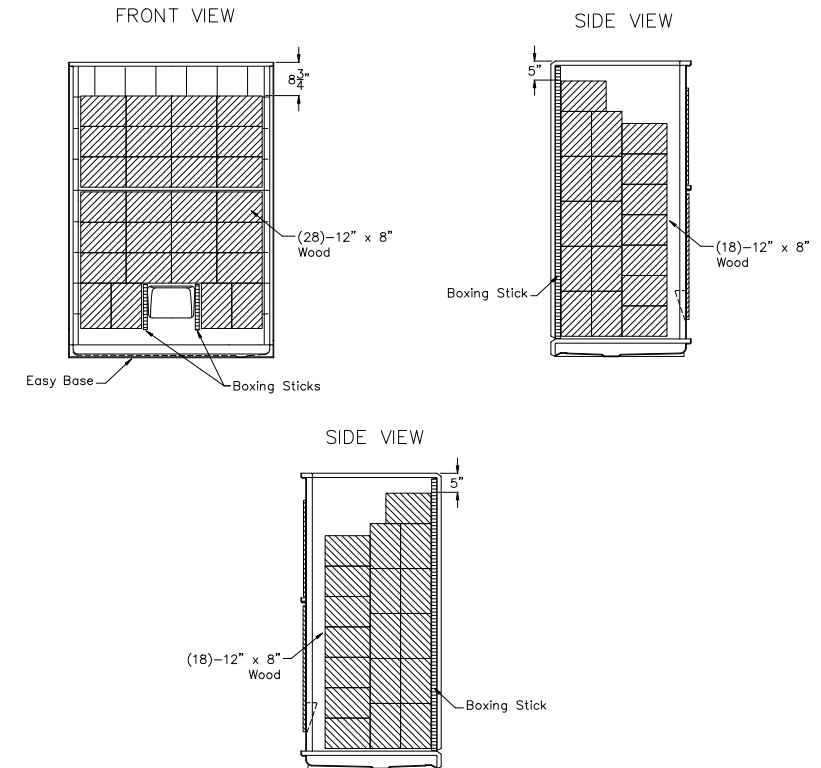

DUE TO THE NATURE OF THE MATERIALS INVOLVED
UNIT DIMENSIONS MAY VARY $\pm 1/2$ INCH

Job Name:		ACCESSIBILITY PROFESSIONALS	
Model No.:		Drawing#: APF5436 BF .75 5P FWB Easy Base Right-BP	
Approved by:	Date Approved:	Date: 3-31-09	Revised: 1-15-14
Rep.:	Wholesaler:	Quote No.:	

ACCESSIBILITY PROFESSIONALS
4 ALLIANCE BLVD. UNIT 123 BARRIE, ONTARIO CANADA L4M 7G3
1 (877) 947-7769 - www.AccessibilityPro.com