

Freedom Showers

SUBMITTAL DATA

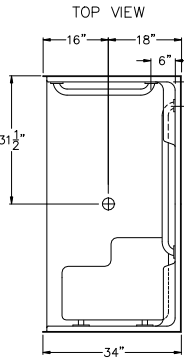
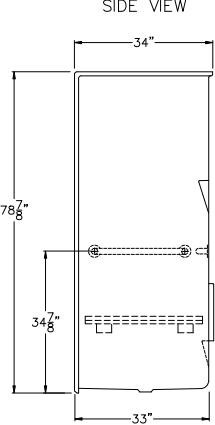
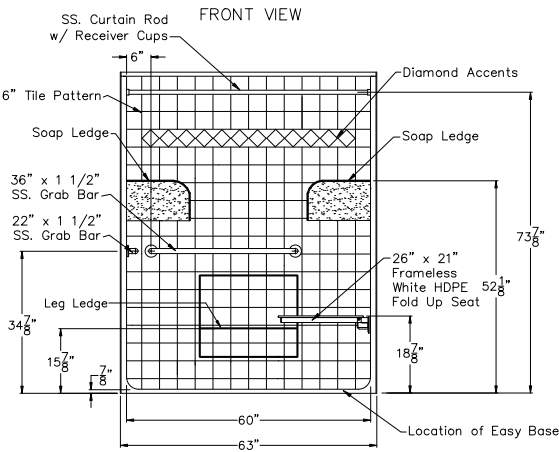

Roll-In Shower Stall

The shower enclosure shall be Model APF 6333 BF right. Finished surface shall be of an applied acrylic. The base shall be attached to the sump of the unit in such a manner to form an integral part with an inner and outer coating of polyester resin. The unit shall have outside dimensions of 63" x 34" x 78 7/8". The unit meets IPMO2124.1.2, CSA B45.5, HUD-UM73, ADA, ANSI A117.1, and Home Innovation Research Lab.

This enclosure shall be equipped with the following installed accessories:

1) One 36" x 1 1/2" diameter stainless steel horizontal grab bar on the back wall, 2) One 22" x 1 1/2" diameter stainless steel horizontal grab bar opposite the seat, both with 1 1/2" statute clearance, mounted with stainless steel bolts, and secured from the rear with 3" x 3" x 11 gauge metal mounting plates, 3) 26" x 21" frameless white HDPE fold up seat, 4) One inch diameter stainless steel curtain rod with receiver cups, 5) Molded soap ledges, 6) Tile finish, 7) Diamond accents 8) Full wall reinforced backing on all walls, 9) Armor Core Easy Base, 10) 7/8" threshold.

NOTE: OPTIONAL RECESSED SOAP DISH AND VALVE PACKAGE REQUIRED FOR ADA. SOAP DISH AND VERTICAL GRAB BAR OPPOSITE SEAT REQUIRED FOR ICC/ANSI A117.1

Available Options: 11) Valve package, 12) Recessed soap dish, 13) Vertical grab bar, 14) Green anti-bacterial shower curtain and hooks, 15) White shower curtain and hooks, 16) Nurses call box drilling.

This unit features the outside dimensions of 62" of overall width. This does not allow for full enclosure of the bolts that are used to secure the bars and seat in place. This may require the need to notch studs to allow for bolt clearance for installation. For a dry wall enclosed fire wall installation, adjustment of the wallboard may be necessary to provide clearance of the bolts while maintaining the integrity of the drywall fire wall enclosure.

NOTE: THIS UNIT WILL NOT ACCEPT A DOOR.

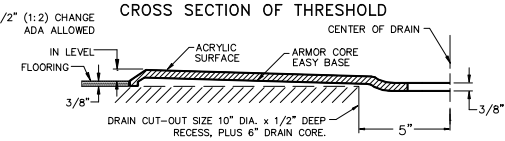

STATE HANDING WHEN ORDERING
HANDED BY THE SEAT
Right Hand Shown, Left Available

DUE TO THE NATURE OF THE MATERIALS
DIMENSIONS MAY VARY ± 1/2"

ACCESSIBILITY PROFESSIONALS

Drawing#: APF 6333 BF .875 HBW HSW FHDP
CR FWB Easy Base Right

Date: 7-16-99 Revised: 4-13-18

Quote No.:

ACCESSIBILITY PROFESSIONALS
4 ALLIANCE BLVD. UNIT 123 BARRIE, ONTARIO CANADA L4M 7G3
1 (877) 947-7769 - www.FreedomShowers.com

Backing Placement

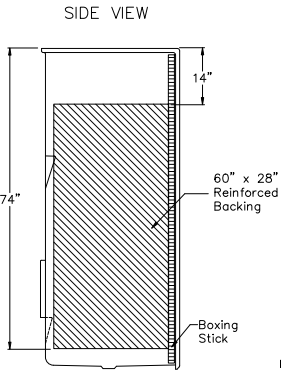
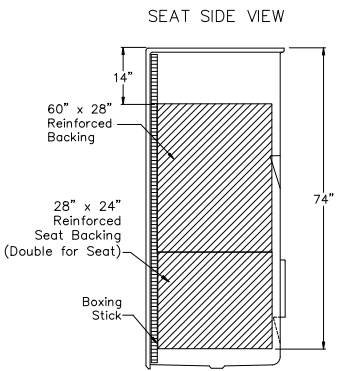
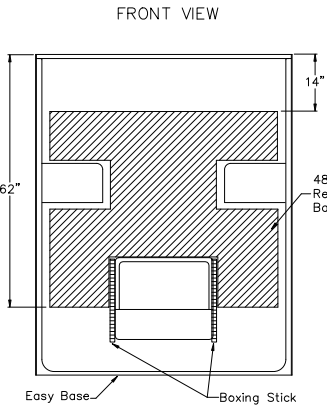

DUE TO THE NATURE OF THE MATERIALS
INVOLVED UNIT DIMENSIONS MAY VARY
± 1/2 INCH

Job Name:	ACCESSIBILITY PROFESSIONALS	
Approved by Print Name:	Drawing#: APF6333 BF .875 HBW HSW FHDP CR FWB Easy Base Right-BP	
Approved by Signature	Date:	Date: 3-31-09 Revised: 4-13-18
Rep.:	Wholesaler:	Quote No.
ACCESSIBILITY PROFESSIONALS 4 ALLIANCE BLVD. UNIT 123 BARRIE, ONTARIO CANADA L4M 7G3 1 (877) 947-7769 - www.FreedomShowers.com		