

Freedom Showers

SUBMITTAL DATA

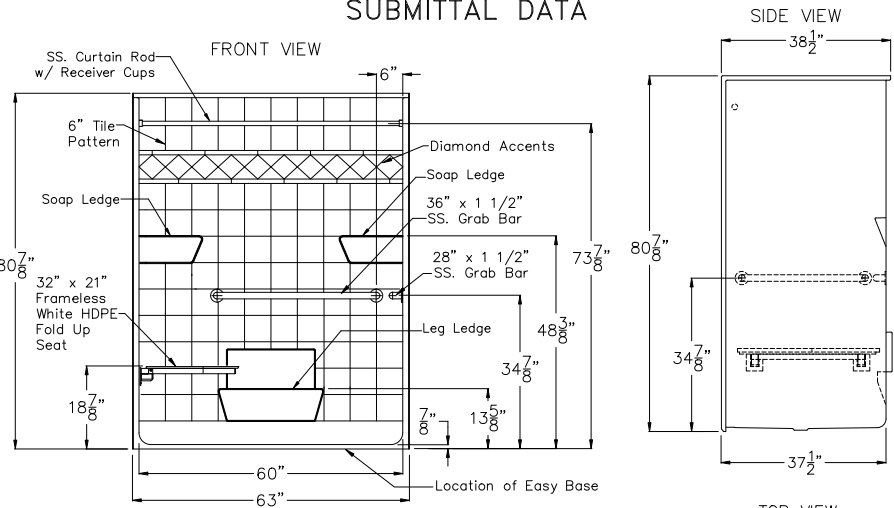

Roll-In Shower Stall

The shower enclosure shall be Model APF 6337 BF left. Finished surface shall be of an applied acrylic. The base shall be attached to the sump of the unit in such a manner to form an integral part with an inner and outer coating of polyester resin. The unit shall have outside dimensions of 63" x 38 1/2" x 80 7/8". The unit meets ADA, ANSI A117.1, IAPMOZ124, CSA B45.5, HUD-UM73, and Home Innovation Research Lab.

This enclosure shall be equipped with the following installed accessories:

1) One 36" x 1 1/2" diameter stainless steel horizontal grab bar on the back wall, 2) One 28" x 1 1/2" diameter stainless steel horizontal grab bar on the side wall, both with 1 1/2" statute clearance, mounted with stainless steel bolts, and secured from the rear with 3" x 3" x 11 gauge metal mounting plates, 3) 32" x 21" frameless white HDPE fold up seat, 4) One inch diameter stainless steel curtain rod with receiver cups, 5) Full reinforced backing on all walls, 6) Factory installed Armor Core Easy Base bottom, 7) 7/8" threshold.

NOTE: VERTICAL GRAB BAR, RECESSED SOAP DISH, REQUIRED FOR ICC-ANSIA117.1, VALVE PACKAGE REQUIRED FOR ICC-ANSI A117.1, AND ADA.

Available Options: 8) Green anti-bacterial shower curtain and hooks, 9) Vertical grab bar, 10) White shower curtain and hooks, 11) Nurses call box drilling, 12) Valve package.

This unit features the outside dimensions of 63" of overall width. This does not allow for full enclosure of the bolts that are used to secure the bars and seat in place. This may require the need to notch studs to allow for bolt clearance for installation. For a dry wall enclosed fire wall installation, adjustment of the wallboard may be necessary to provide clearance of the bolts while maintaining the integrity of the drywall fire wall enclosure.

NOTE: THIS UNIT WILL NOT ACCEPT A DOOR.

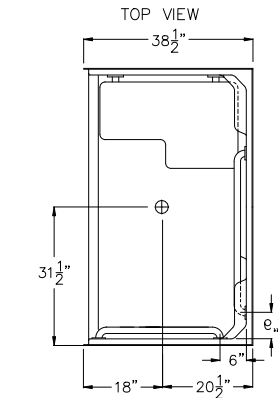

STATE HANDING WHEN ORDERING
HANDED BY THE SEAT
Left Hand Shown, Right Available

DUE TO THE NATURE OF THE MATERIALS
DIMENSIONS MAY VARY ± 1/2"

ACCESSIBILITY PROFESSIONALS

Drawing#: APF 6337 BF .875 HBW HSW
FHDP CR FWB Easy Base Left

Date: 8-19-99 Revised: 4-13-18

Quote No.:

ACCESSIBILITY PROFESSIONALS
4 ALLIANCE BLVD. UNIT 123 BARRIE, ONTARIO CANADA L4M 7G3
1 (877) 947-7769 – www.FreedomShowers.com

Backing Placement Drawing

SUBMITTAL DATA

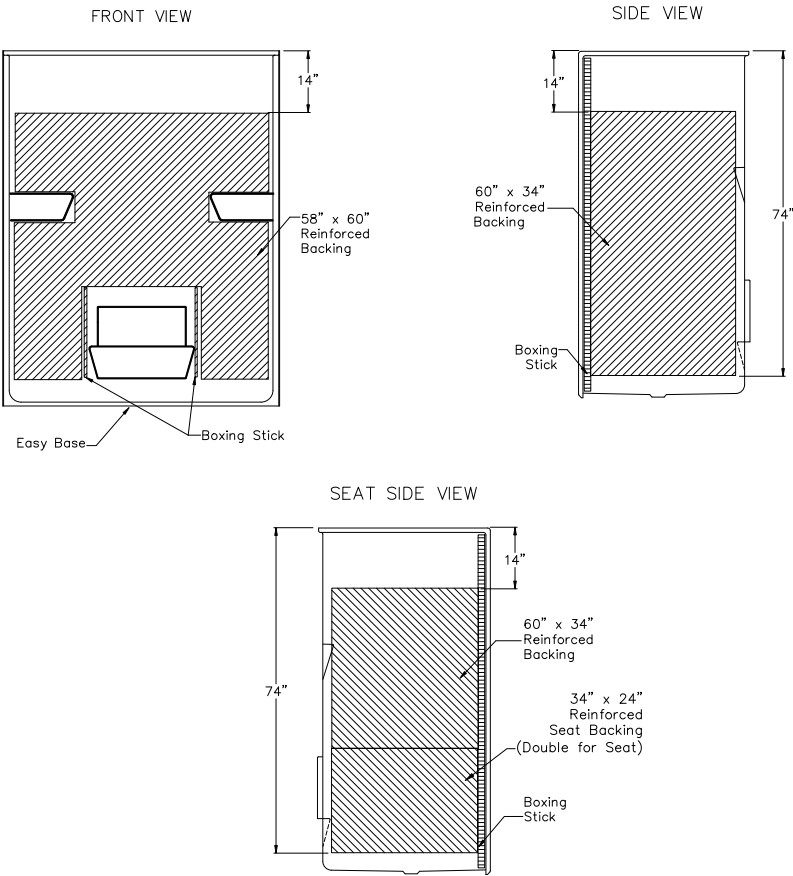

DUE TO THE NATURE OF THE MATERIALS
DIMENSIONS MAY VARY ± 1/2"

Job Name:	ACCESSIBILITY PROFESSIONALS	
Approved by Print Name:	Drawing#: APF 6337 BF .875 HBW HSW FHDP CR FWB Easy Base Left-BP	
Approved by Signature:	Date:	Date: 5-23-07 Revised: 4-12-18
Rep.:	Wholesaler:	Quote No.:
ACCESSIBILITY PROFESSIONALS 4 ALLIANCE BLVD. UNIT 123 BARRIE, ONTARIO CANADA L4M 7G3 1 (877) 947-7769 – www.FreedomShowers.com		