

1 EXAMPLE POST LAYOUT PLAN VIEW
SCALE: NONE

LEGEND

- DETAIL NUMBER
- SHEET NUMBER
- ELEVATION NUMBER
- SHEET NUMBER
- SECTION NUMBER
- SHEET NUMBER
- TOP MOUNT POST
- CENTERLINE
- FINISHED FLOOR
- TYPICAL CONDITION; APPLIES ELSEWHERE AT SIMILAR LOCATIONS

NOTES:

1. TOP RAIL NOT SHOWN FOR CLARITY.

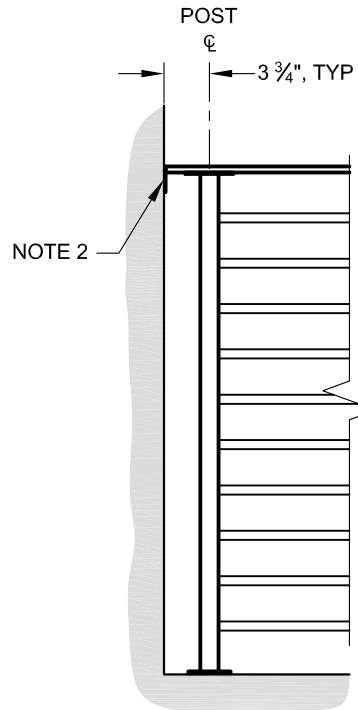

NOTE 2

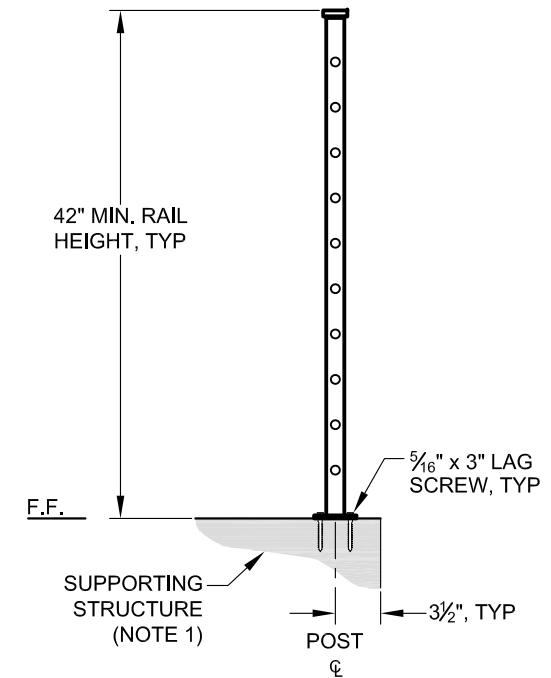
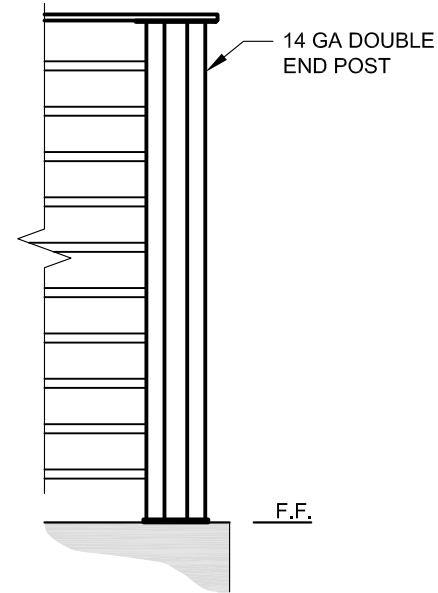
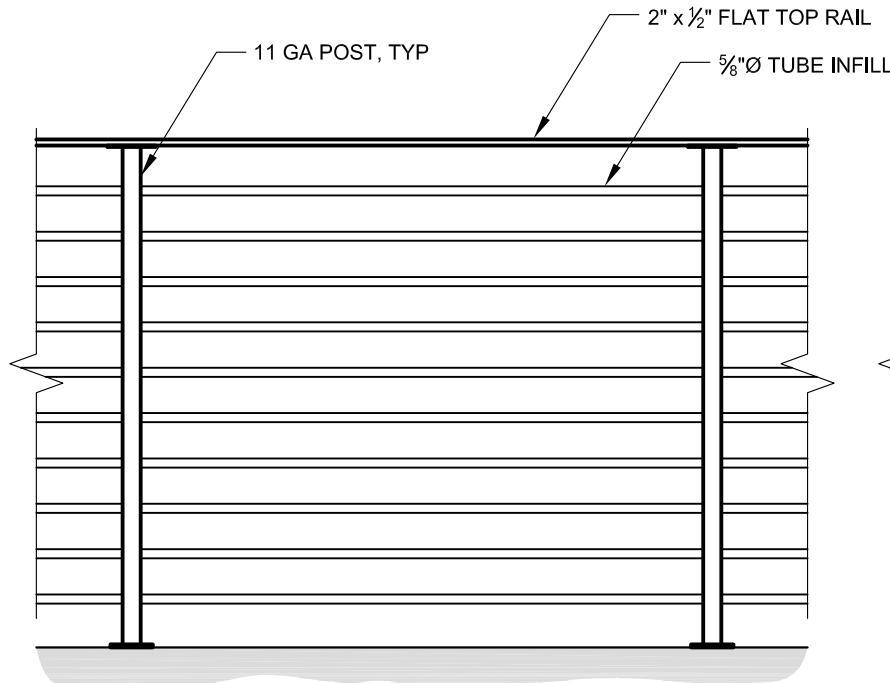

1 END POST - WALL CONNECTION
ELEVATION
SCALE: NONE

2 TYPICAL INTERMEDIATE POST
ELEVATION
SCALE: NONE

3 END POST - FREE STANDING
ELEVATION
SCALE: NONE

4 RAILING SECTION
SCALE: NONE

NOTES:

1. DECK STRUCTURE CAN VARY GREATLY. IT IS THE RESPONSIBILITY OF THE CUSTOMER TO VERIFY THAT THE SUPPORTING STRUCTURE IS ADEQUATE TO MEET THE LOAD REQUIREMENTS OF THE GOVERNING BUILDING CODE(S). *AGS Stainless Inc.* RECOMMENDS CONSULTING A DESIGN OR CONSTRUCTION PROFESSIONAL TO ADDRESS THESE ISSUES.
2. POSITIVE CONNECTION TO ADJACENT STRUCTURE IS REQUIRED.

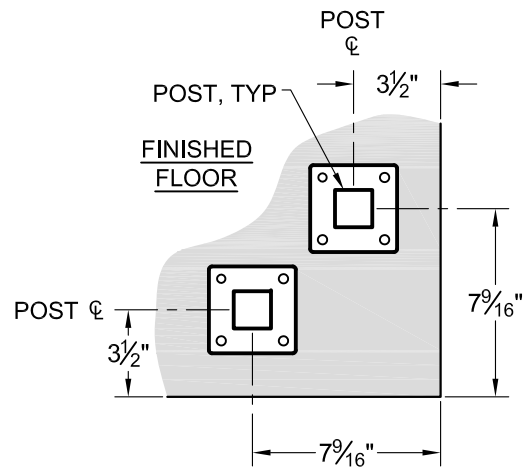

A OUTSIDE CORNER POST LAYOUT - 90°
SCALE: NONE

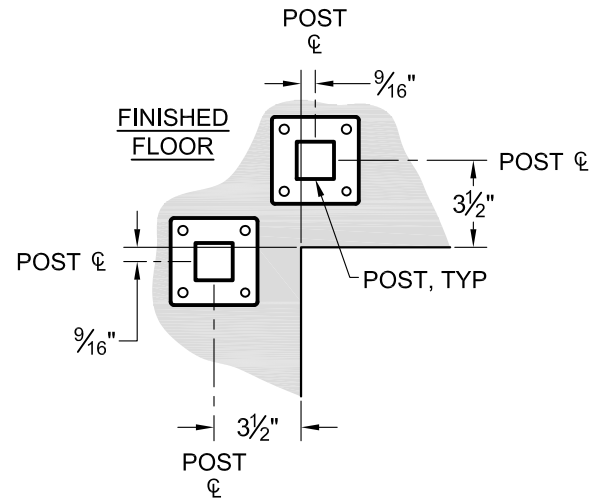

B INSIDE CORNER POST LAYOUT - 90°
SCALE: NONE

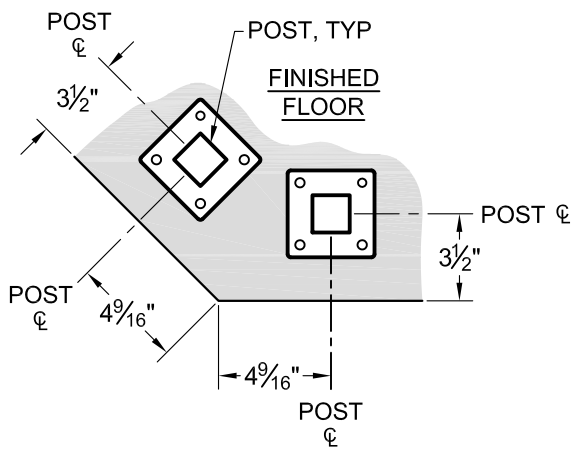

C OUTSIDE CORNER POST LAYOUT - 45°
SCALE: NONE

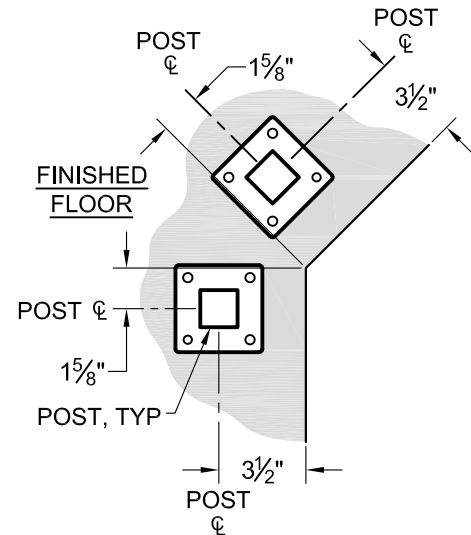

D INSIDE CORNER POST LAYOUT - 45°
SCALE: NONE

1 TYPICAL CORNER LAYOUT
SCALE: NONE

NOTE:

THE LAYOUTS SHOWN MAY VARY AS THE ANGLE CHANGES. MAKE SURE YOU CHOOSE A POST LAYOUT SO THAT TWO CLOSEST POINTS OF THE ADJACENT POSTS IS LESS THAN 4".