

**1** EXAMPLE POST LAYOUT PLAN VIEW  
SCALE: NONE

## LEGEND

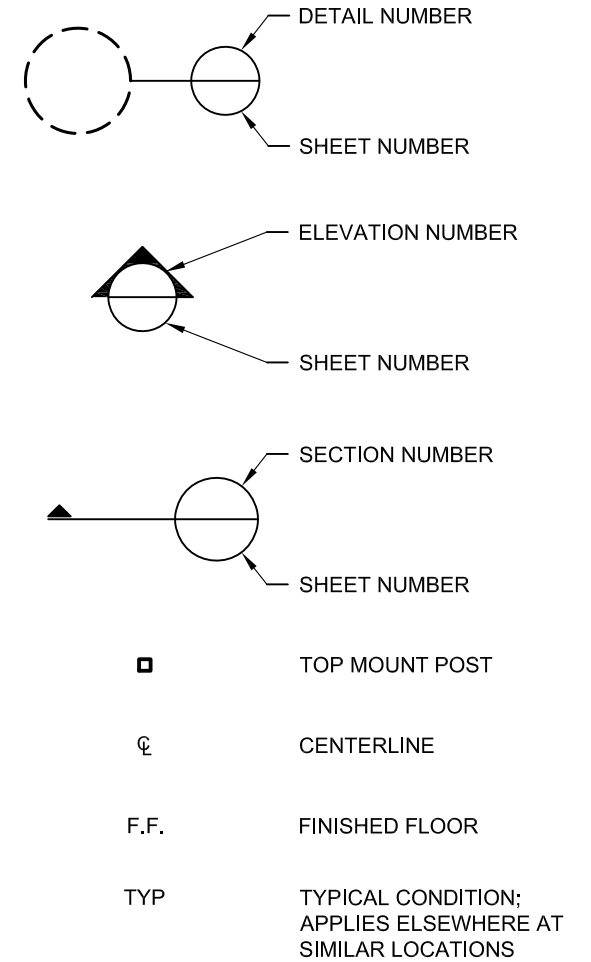

## NOTES:

1. TOP RAIL NOT SHOWN FOR CLARITY.

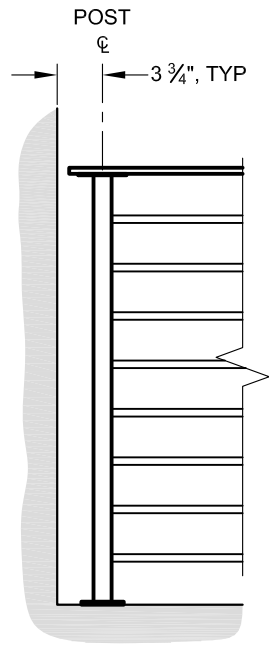

**1** TYPICAL END POST ELEVATION  
SCALE: NONE

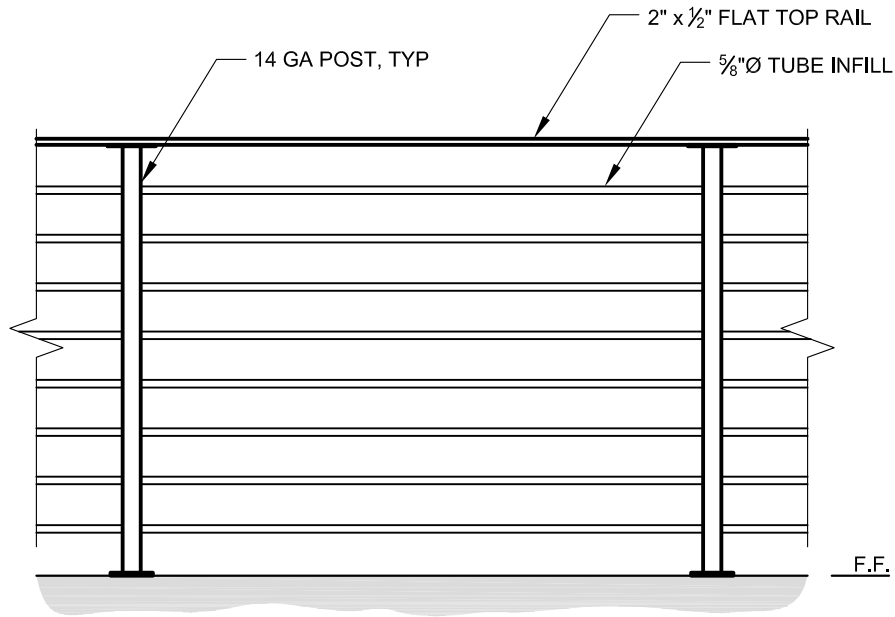

**2** TYPICAL INTERMEDIATE POST ELEVATION  
SCALE: NONE

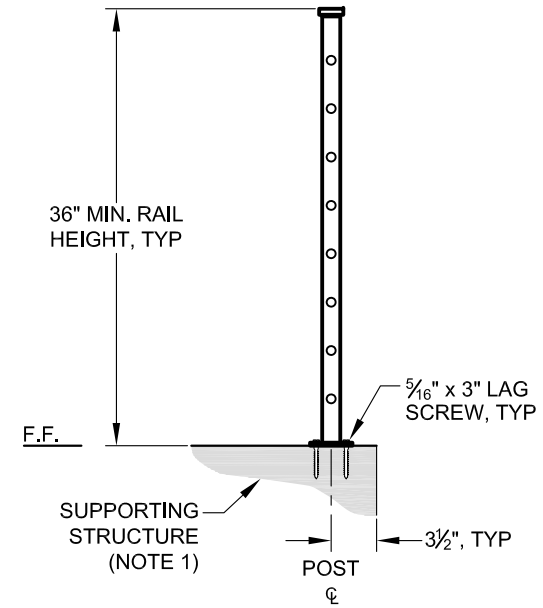

**3** RAILING SECTION  
SCALE: NONE

**NOTES:**

1. DECK STRUCTURE CAN VARY GREATLY. IT IS THE RESPONSIBILITY OF THE CUSTOMER TO VERIFY THAT THE SUPPORTING STRUCTURE IS ADEQUATE TO MEET THE LOAD REQUIREMENTS OF THE GOVERNING BUILDING CODE(S). *AGS Stainless Inc.* RECOMMENDS CONSULTING A DESIGN OR CONSTRUCTION PROFESSIONAL TO ADDRESS THESE ISSUES.

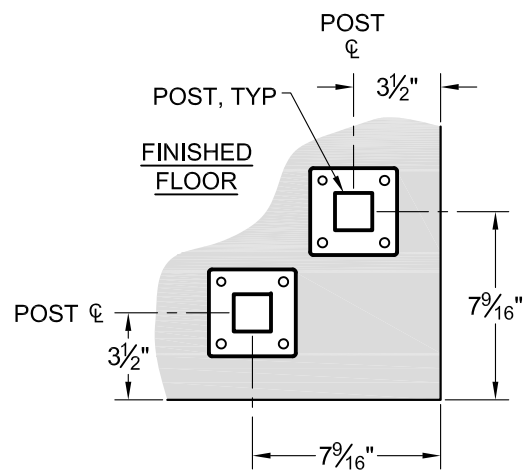

**A** OUTSIDE CORNER POST LAYOUT - 90°  
SCALE: NONE

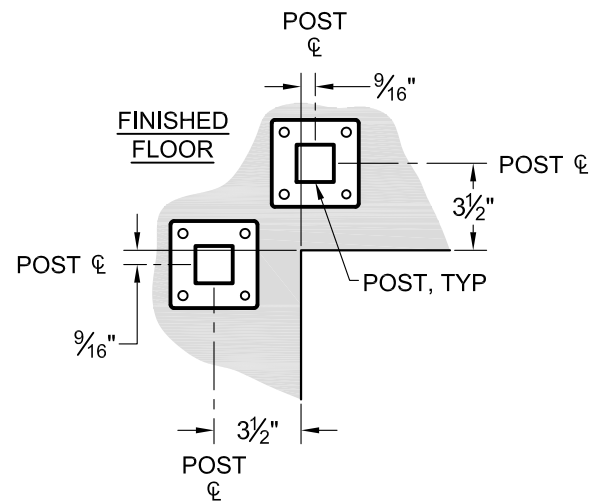

**B** INSIDE CORNER POST LAYOUT - 90°  
SCALE: NONE

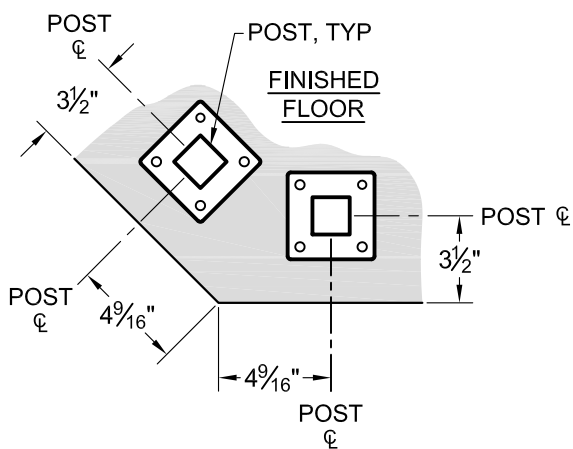

**C** OUTSIDE CORNER POST LAYOUT - 45°  
SCALE: NONE

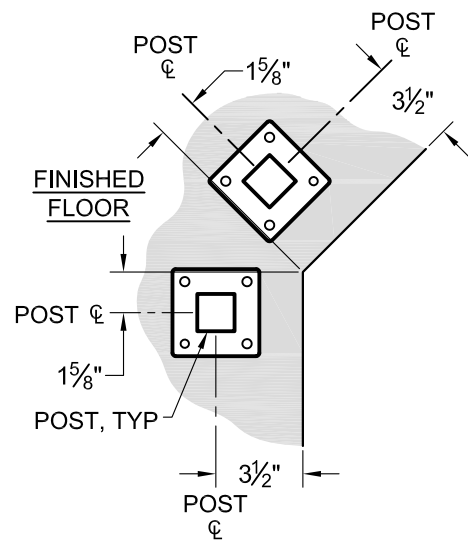

**D** INSIDE CORNER POST LAYOUT - 45°  
SCALE: NONE

**1** TYPICAL CORNER LAYOUT  
SCALE: NONE

**NOTE:**

THE LAYOUTS SHOWN MAY VARY AS THE ANGLE CHANGES. MAKE SURE YOU CHOOSE A POST LAYOUT SO THAT TWO CLOSEST POINTS OF THE ADJACENT POSTS IS LESS THAN 4".