

 RECOMMENDED FOR MAINTENANCE.

NOTE:

- A. FOR WINDOW CONFIGURATION AND QUANTATY REFER TO DOOR QUOTE.
- B. WIDTH GAUGE SUPPORT BRACKET ATTACHMENT MAY BE REQUIRED DEPENDING ON DOOR WIDTH.

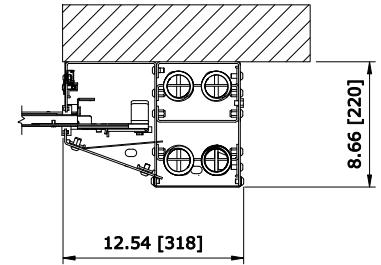
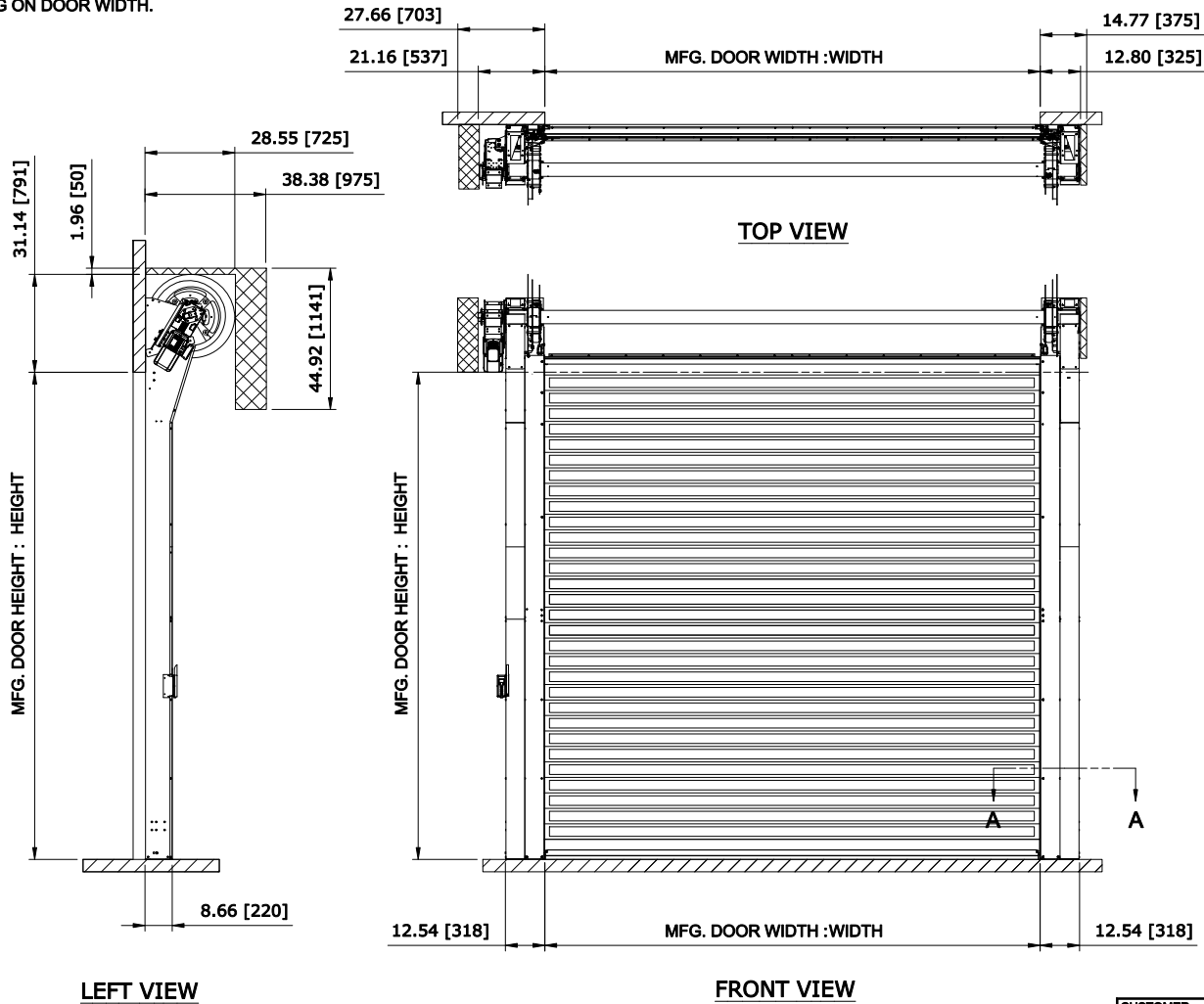

DRIVE SIDE	<input type="checkbox"/> RIGHT	<input type="checkbox"/> LEFT
SIDE COLUMN	<input type="checkbox"/> GALVANIZED	<input type="checkbox"/> RAL # _____
SLAT COLOR	<input type="checkbox"/> ANODIZED CLEAR ALUMINUM	<input type="checkbox"/> RAL # _____
INSULATED SLATS	<input type="checkbox"/> YES	<input type="checkbox"/> NO
DISENGAGEMENT	<input type="checkbox"/> FRONT SIDE	<input type="checkbox"/> BOTH SIDES
LOCKABLE DISENGAGEMENT	<input type="checkbox"/> YES	<input type="checkbox"/> NO
HOOD FINISH	<input type="checkbox"/> GALVANIZED	<input type="checkbox"/> RAL # _____

<input type="checkbox"/> 208V	<input type="checkbox"/> 230V	<input type="checkbox"/> 480V	<input type="checkbox"/> 575V
-------------------------------	-------------------------------	-------------------------------	-------------------------------

<input type="checkbox"/> ACS100 - STEEL	<input type="checkbox"/> ACS100 - STAINLESS STEEL
---	---

<input type="checkbox"/> MOTION DETECTOR	<input type="checkbox"/> PULL CORD
<input type="checkbox"/> PUSH BUTTON	<input type="checkbox"/> FLOOR LOOP
<input type="checkbox"/> _____	<input type="checkbox"/> _____
<input type="checkbox"/> _____	<input type="checkbox"/> _____

<input type="checkbox"/> HORN	<input type="checkbox"/> RED
<input type="checkbox"/> AMBER STROBE	<input type="checkbox"/> GREEN
<input type="checkbox"/> TRAFFIC LIGHT	<input type="checkbox"/> LED SET

RR3000 / VISION - DIRECT DRIVE LH NO COVER
 CONTROL PANEL:
 CONTROLS

CUSTOMER:		APPROVED BY:	
LOCATION:		APPROVED WITH CHANGES BY:	
SALESMAN / DEALER:		DATE:	SCALE = NTS
DESCRIPTION:			
RR3000 / VISION APPROVAL DRAWINGS			
A	ENCODER / TITLE	12/06/18	JTF
Rev	Change	Date	Name
DRAWING NO:		DESIGNER:	DATE:
8300T0043		J. REITZ	10/24/2016