

3/4" J-CHANNEL

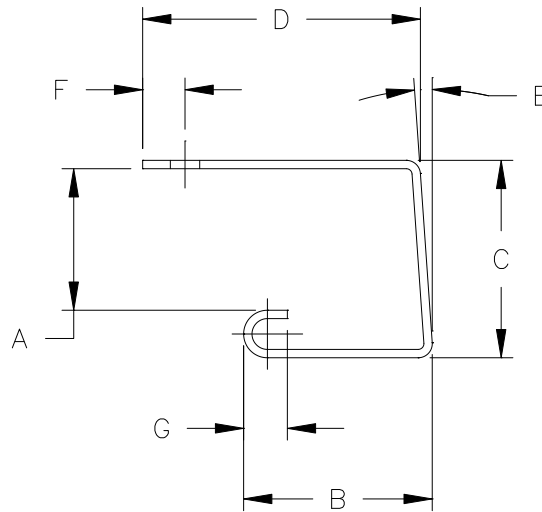

- A. SIDING POCKET WIDTH = 0.750 ± 0.020
- B. SIDING POCKET DEPTH = 1.000 ± 0.040
- C. TOTAL PROFILE THICKNESS = 1.049 ± 0.040
- D. TOTAL PANEL WIDTH = 1.500 ± 0.050
- E. ANGLE = 4 DEG.
- F. NAIL SLOT CENTER LINE = 0.225 ± 0.025
- G. BEAD DEPTH = $0.250 +0.020 -0.010$

WALL THICKNESS EXPOSED = $.044 \pm .002$
 WALL THICKNESS HANGER = N/A
 WEIGHT PER FOOT - - - = .091 LBS.
 OVERALL LENGTH - - - = $12'-6" \pm 1/8"$
 WEEP HOLE - - - - - = N/A
 WARP - - - - - = .125"
 NAIL CENTER - - - - - = 16"

Alside®
 First On America's Homes