

AMBICO LIMITED

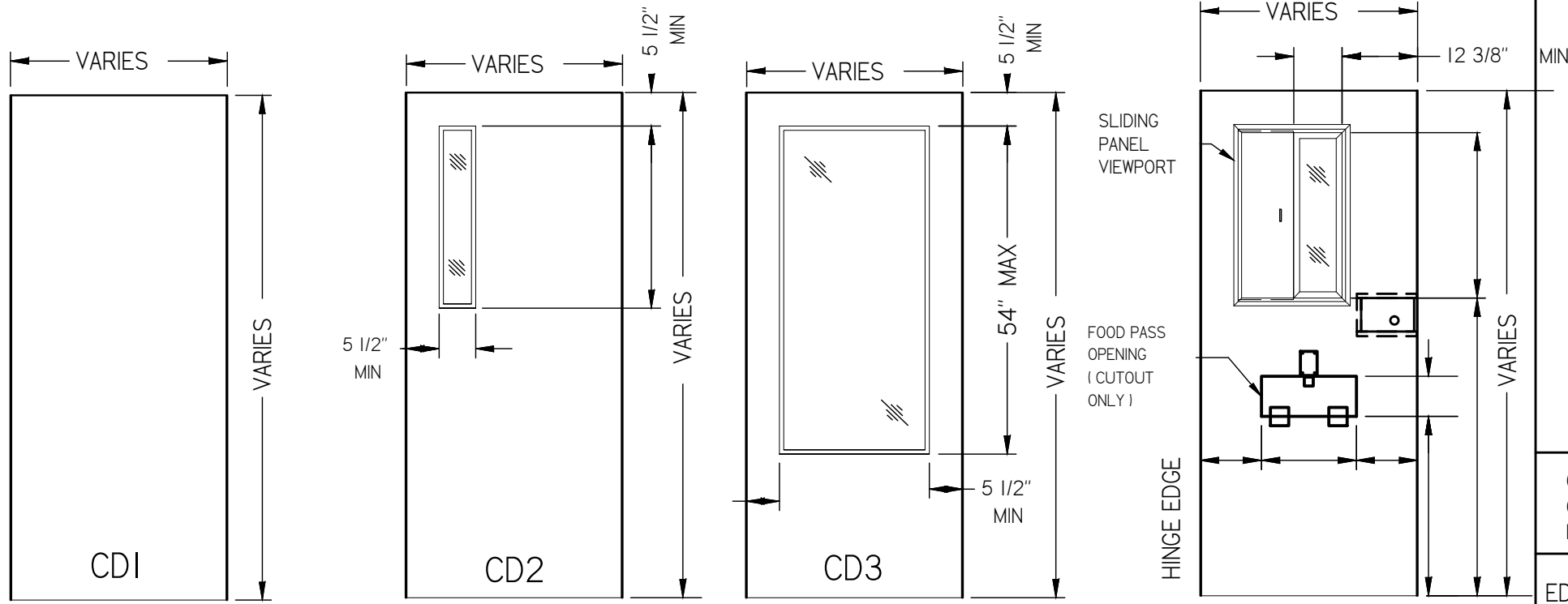

FIRE RATED TO 3HR

FIRE RATED TO 90MIN
IF VISION PANEL IS
100IN.SQ MAX

FIRE RATED TO 45
MIN IF VISION
PANELS 1296IN.SQ MAX

SLIDING
PANEL
VIEWPORT

FOOD PASS
OPENING
(CUTOUT
ONLY)

HINGE EDGE

CD4

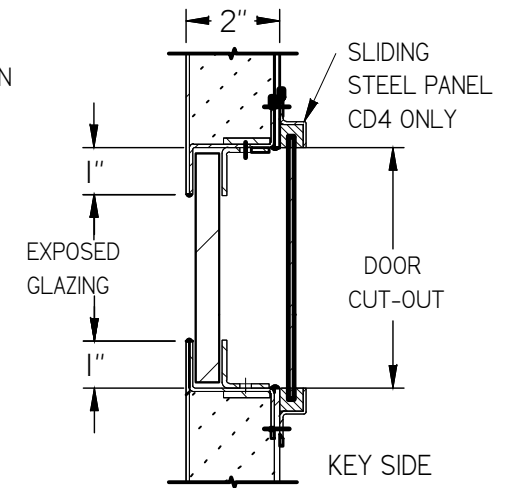

LIGHT KIT SECTION

GLAZING BY : _____
GLAZING THICKNESS : _____
HARDWARE BY : _____

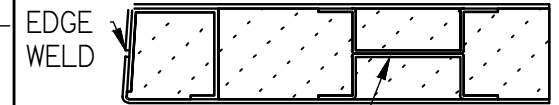

ARCWELD
TOP & BOTTOM
HORIZONTAL SECTION

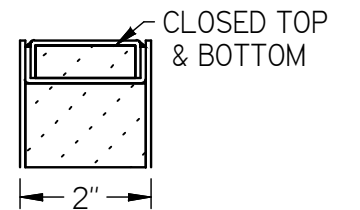

TOP & BOTTOM SECTION

NOTES :

- DOORS FABRICATED USING 14GA OR 12GA GALV. SKINS AND CORE IN ACCORDANCE WITH OUR HMMA 863 TESTED CONSTRUCTION METHODS AND PROCEDURES.
- PERFORMANCE: 14,000LB STATIC LOAD, 7,500LB RACK TEST.
- EDGES SHALL BE BUTT JOINT FULLY WELDED, GROUND AND FINISHED SMOOTH.
- CONTINUOUS CHANNEL REINFORCING ON LOCK AND HINGE EDGES TO BE 10GA THICK.
- TOPS AND BOTTOMS SHALL BE 10GA WITH 16GA INVERTED FLUSH AND WELDED CHANNELS
- VISION LITE CUTOUTS SHALL HAVE INTERNAL 12GA CHANNELS AND TIGHTLY FITTED REMOVABLE STOPS WITH MITERED CORNERS SECURED USING #8 M/S TORX SCREWS.
- DOOR SHALL BE FACTORY REINFORCED, DRILL AND TAPPED FOR MORTISED HARDWARE IN ACCORDANCE WITH THE APPROVED HARDWARE SCHEDULE AND MANUFACTURER'S TEMPLATES. ALL REINFORCING SHALL BE 12GA CONSTRUCTED AND FIXED IN ACCORDANCE WITH OUR HMMA 863 TESTED CONSTRUCTION METHODS AND PROCEDURES.
- HOLLOW METAL DOOR UNDERCUT IS 3/4". ARCHITECT & GENERAL CONTRACTOR TO ADVISE ANY OPENINGS WHERE ADDITIONAL UNDERCUT IS REQUIRED
- GLAZING DIMENSIONS REFER TO CUT-OUT.
- THE FOOD PASS OPENING SHALL BE A FLUSH OPENING FABRICATED USING INTERIOR 12GA CHANNELS, WELDED TO BOTH DOOR SKINS THE FOUR CORNER SEAMS SHALL BE CONTINUOUSLY WELDED AND DRESSED SMOOTH.



TITLE : **AMBICO DETENTION METAL DOOR SPECIFICATION SHEET**

JOB NO: _____ REVIEWED BY BEN - 2013/12/09

SHEET: 1 OF: 2

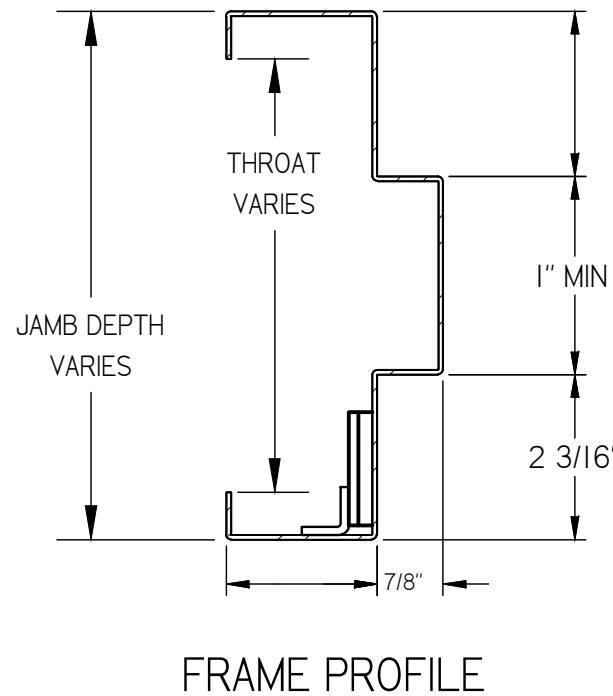
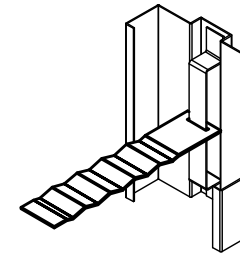
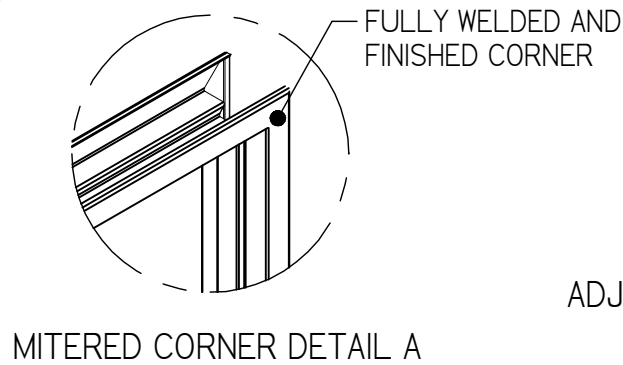
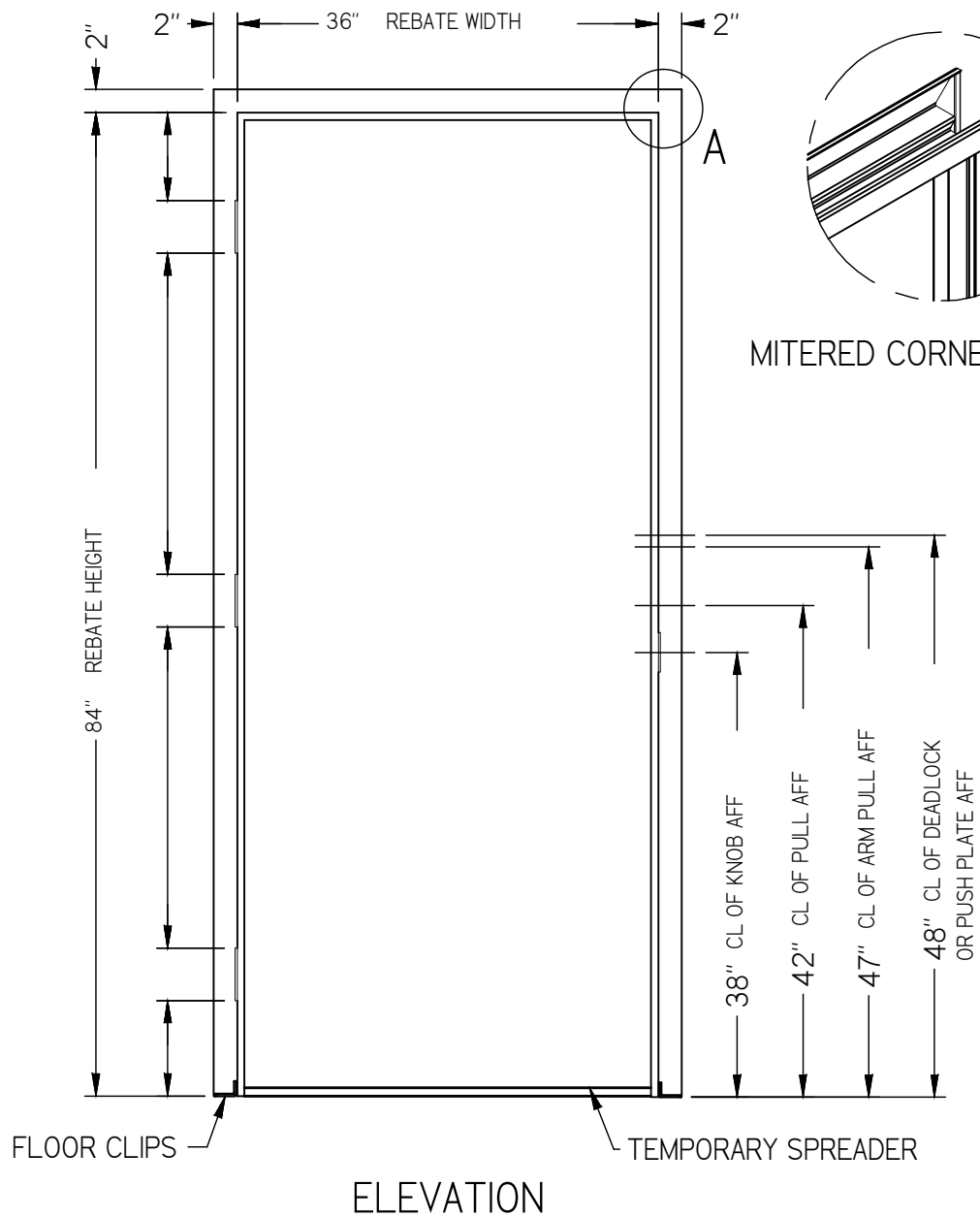

DETENTION STEEL FRAMES

FRAMES SHALL BE TEMPLATED AND REINFORCED FOR HARDWARE AS REQUIRED.
 FRAMES SHALL BE COMPLETE WITH BUMPERS, ANCHORS AND TEMPORARY SPREADERS.

STEEL SHALL BE :
 12 GA. FOR FIRE RATED FRAME AND NON-FIRE RATED FRAME

FINISH SHALL BE :

- GALVANEAL
- GALV-G90
- PRIMED
- TOUCH UP

GLAZING BY : _____
 GLAZING THICKNESS : _____
 HARDWARE BY : _____

NOTES :

-