

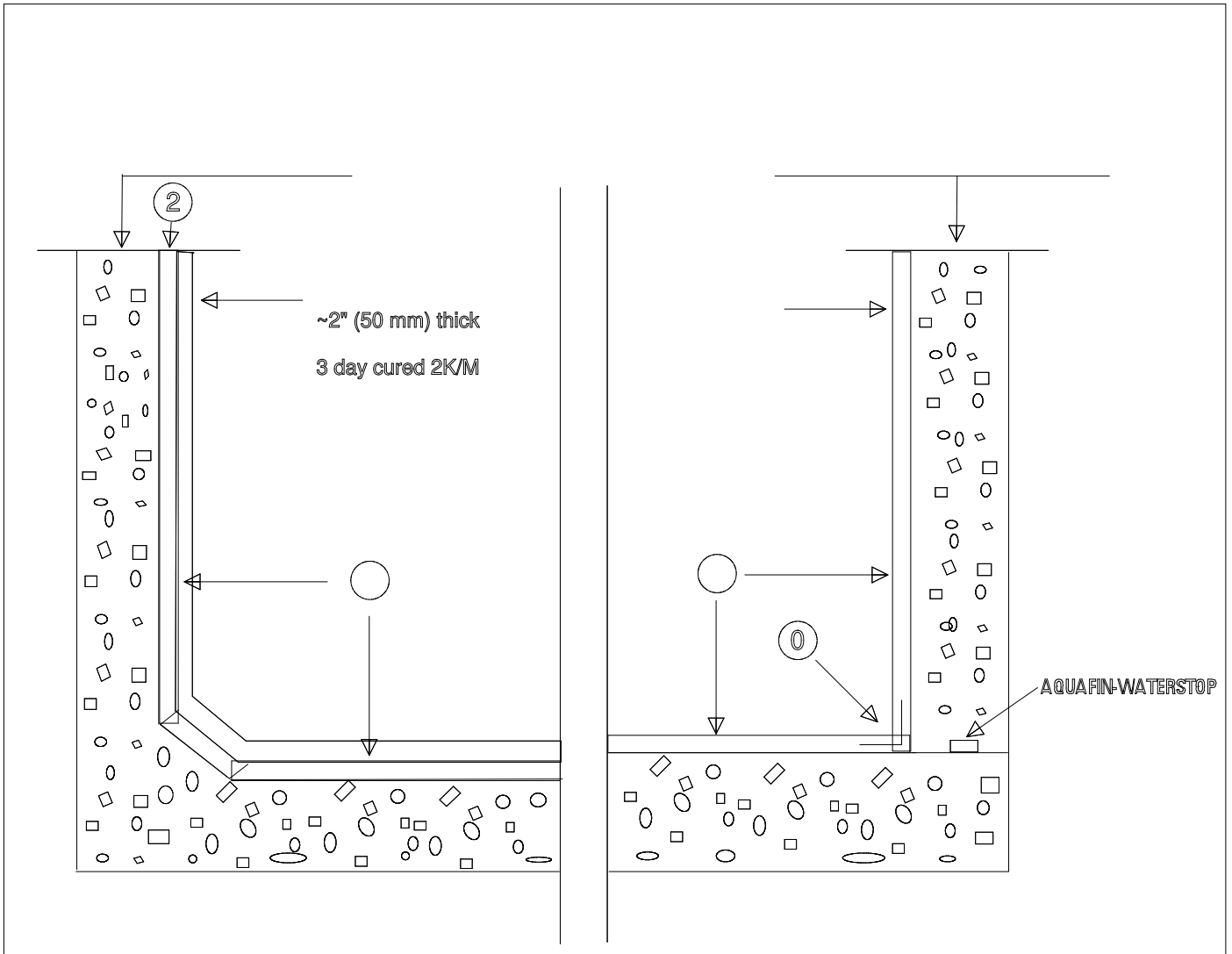

Schematic sketches



- ② or CRACK SEALING TAPE on expected joint movement. Refer to No. 1.1.3-15 for details. Use in all horizontal and vertical joints and cracks (4.75" wide tape).
- ① Apply AQUAFIN-2K/M to walls and slabs at 3/32" [90 mils] (2.4 mm) total thickness. Let cure for minimum 3 days if a texture coat or other topping is to be applied. If a primer is used, apply over dry 2K/M. Prevent texture coat or topping from

For cast-in-place tanks, apply 1st coat AQUAFIN-1K at 60 mils (1.6 mm) and 2nd coat AQUAFIN-2K/M at 60 mils (1.6 mm) thickness to walls and floor, wherever rain or groundwater (negative side) pressure can be expected (i.e. inground structures, etc.). See application rates on AQUAFIN-2K/M data sheet. Call Aquafin for guidance regarding possible use of AQUAFIN-4x4-MESH.
- ② For added protection, incorporate AQUAFIN-IG-ADMIX Refer to standard specifications and product data sheet for further information.