

Schematic sketches

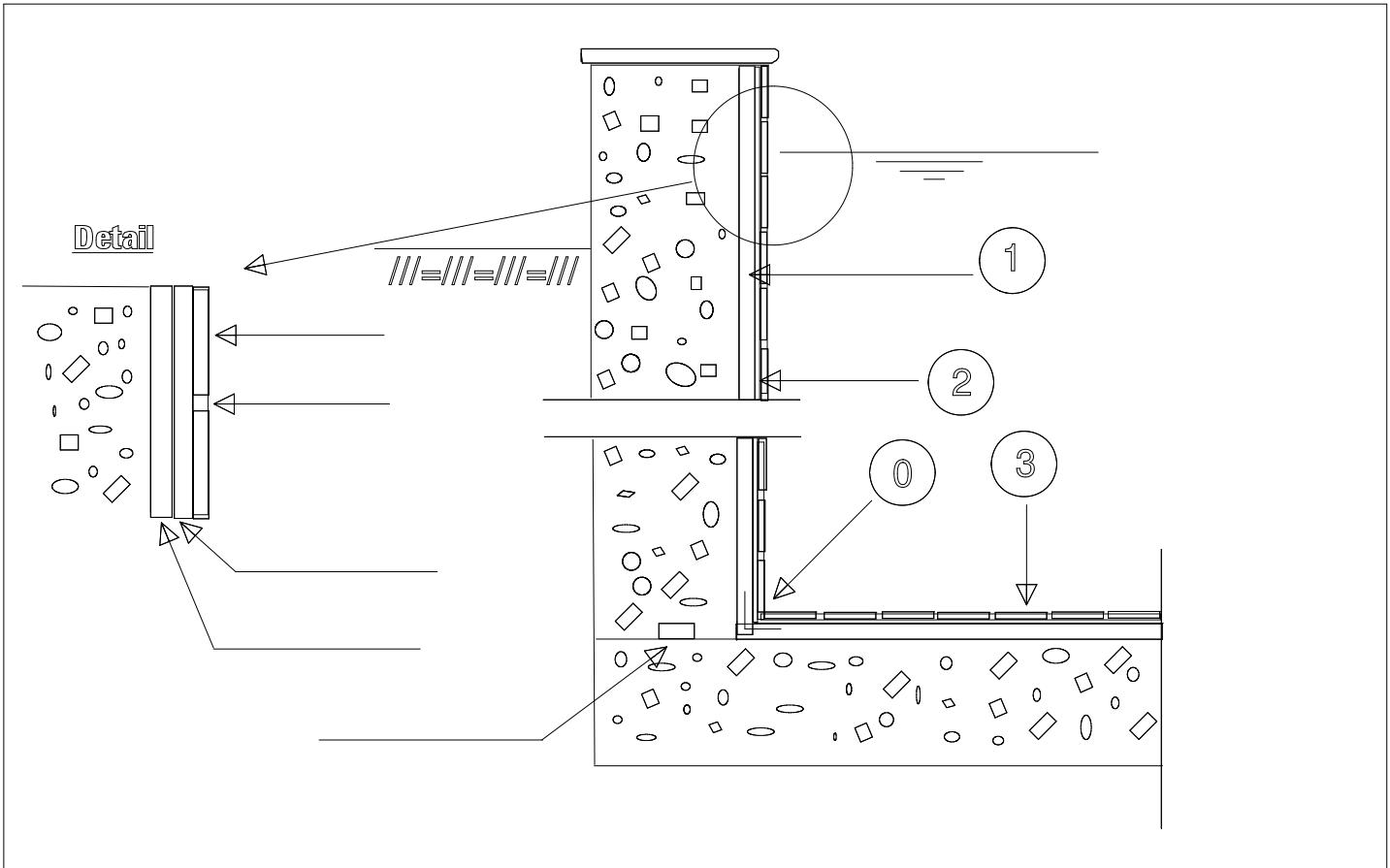

① or CRACK SEALING TAPE, to seal wall/slab construction joint and JOINT SEALING TAPE-2000-S to seal expansion joints. Refer to No. 1.1.3-15 for details.

② Above ground + elevated:
[1/16"] (1.6 mm).

Inground:

Application rates on AQUAFIN-2K/M data sheet.

Note: Install leveling coats (i.e. "mud bed", "brown coat", plaster, etc.,) prior to the application of AQUAFIN-1K and/or AQUAFIN-2K/M.

③

Install ceramic or glass tiles and tile grout as per tile manufacturer. Observe TCNA Guidelines for movement joint spacing.