

Note: 500x500mm inspection hatches to be provided to balcony for facilitating the clearance of leaves & debris

DWELLING

TERRACE

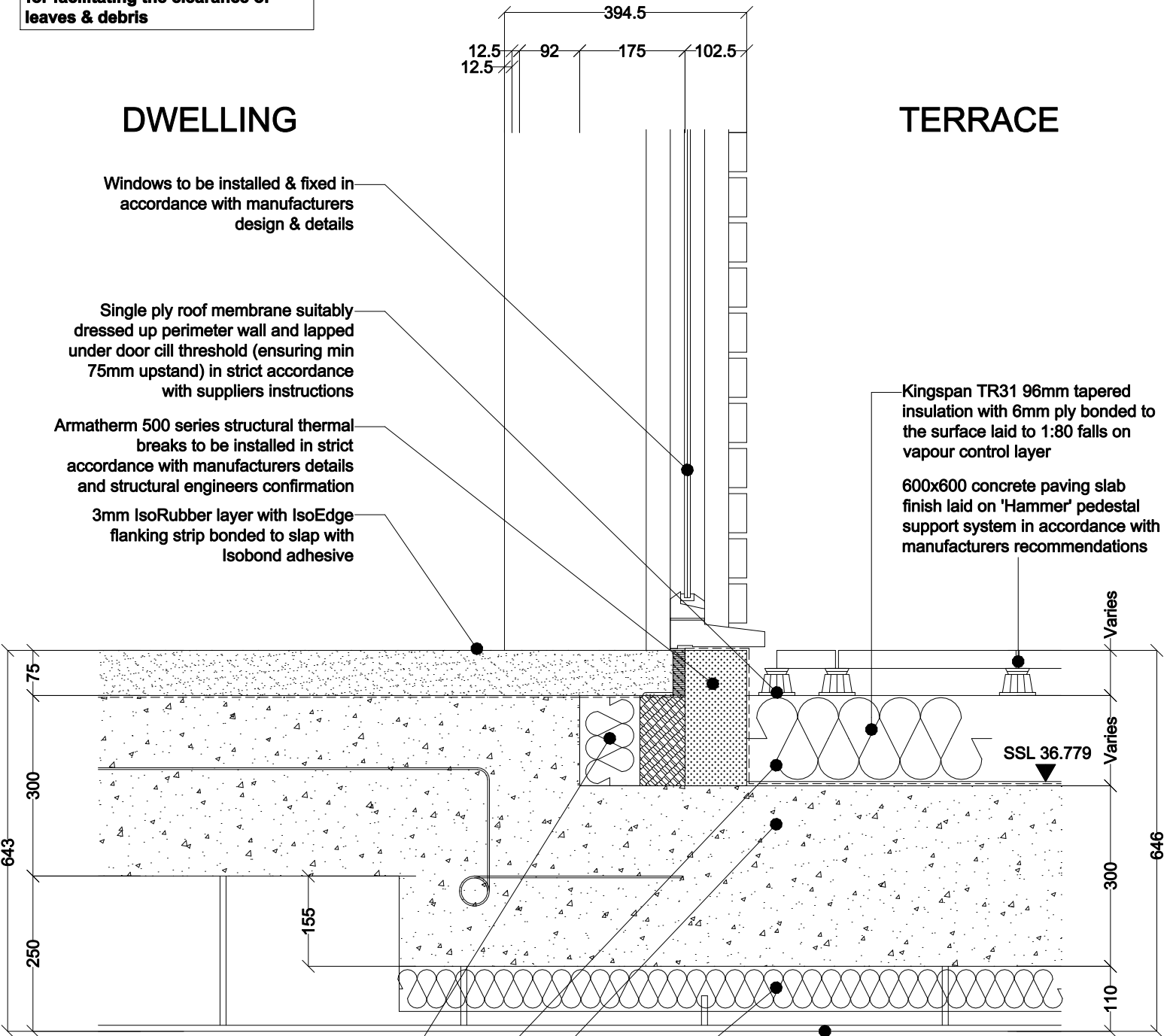

Windows to be installed & fixed in accordance with manufacturers design & details

Single ply roof membrane suitably dressed up perimeter wall and lapped under door cill threshold (ensuring min 75mm upstand) in strict accordance with suppliers instructions

Armatherm 500 series structural thermal breaks to be installed in strict accordance with manufacturers details and structural engineers confirmation

3mm IsoRubber layer with IsoEdge flanking strip bonded to slab with Isobond adhesive

Kingspan TR31 96mm tapered insulation with 6mm ply bonded to the surface laid to 1:80 falls on vapour control layer

600x600 concrete paving slab finish laid on 'Hammer' pedestal support system in accordance with manufacturers recommendations

Insulated cavity stop with all voids filled with mineral wool insulation (density 33-60kg/m²)

Vapour control layer to be dressed up thermal breaks and overlap with DPM

300mm reinforced concrete slab in accordance with structural engineers details

Additional 75mm mineral wool insulation (density 33-60kg/m²) laid between suspended ceiling system

Gyproc casoline MF (or similar) suspended ceiling system with 1 No. layer of 15mm Gyproc soundbloc plasterboard (minimum 10kg/m²). No window opening recess suitable in this location

DETAIL F (1:10)

FOURTH FLOOR SOUTH TERRACE / DOOR THRESHOLD DETAIL