

ASCENSION CLARITY MODEL SERIES VERTICAL PLATFORM WHEELCHAIR LIFT FOR SHAFTWAY INSTALLATION, SAME-SIDE ENTRY/EXIT

1. CODE COMPLIANCE: ASME A18.1, ASME A17.5, ANSI A117.1, ADAAG, NFPA 70 (NEC).
2. RATINGS
 - 2.1 CAPACITY: 750 LB
 - 2.2 SPEED: 20 FT/MIN
 - 2.3 DUTY: 168 CYCLE-FT/HOUR (12 CYCLES/HOUR MINIMUM)
 - 2.4 TRAVEL: 34.00 TO 168.00 AS ALLOWED BY AHJ.
3. DRIVE & ELECTRICAL
 - 3.1 DRIVE TYPE: 2:1 CHAIN HYDRAULIC
 - 3.2 SUSPENSION: 4X #50 ANSI ROLLER CHAINS
 - 3.3 MOTOR: 24VDC, 3 HP
 - 3.4 ELECTRICAL: 120VAC, 60 HZ, 6A, 1-PHASE.
 - 3.5 ALL CONTROL CIRCUITS 24VDC.
 - 3.6 FULL-TIME BATTERY OPERATION WITH CHARGING.
4. SITE CONSIDERATIONS
 - 4.1 DO NOT PROVIDE PIT OR RAMP. LOW-PROFILE PLATFORM FLOOR MEETS ADA REQUIREMENTS AS ENTRY THRESHOLD.
 - 4.2 REFER TO ASCENSION CLARITY STRUCTURAL LOADING DOCUMENT FOR STRUCTURAL AND ANCHORING REQUIREMENTS.
 - 4.3 2X HOISTWAY DOORS BY OTHERS. CONTACT ASCENSION FOR RECOMMENDATION. INSTALLATION IN BUILDING WALL MUST MEET ALL APPLICABLE CODES.
 - 4.4 SHAFT DIMENSIONS PROVIDED FOR REFERENCE ONLY. CLEARANCES MUST MEET ASME A18.1 AND APPLICABLE LOCAL CODES.
 - 4.5 MANUAL LOWERING PULL HANDLE WITH LOCKED ENCLOSURE PROVIDED FOR REMOTE MOUNTING.
 - 4.6 UP/DOWN OPERATING SWITCHES PROVIDED IN SINGLE-GANG BOXES FOR REMOTE MOUNTING IAW APPLICABLE CODES AND REGULATIONS.
 - 4.7 ALARM PROVIDED FOR REMOTE MOUNTING ON WALL.
5. LIGHTING AND COMMUNICATIONS
 - 5.1 PRIMARY LIGHTING TO BE PROVIDED BY OTHERS IAW ALL APPLICABLE CODES AND REGULATIONS.
 - 5.2 ACCENT AND AUXILIARY LIGHTING PROVIDED STANDARD ON PLATFORM CONTROLS AND FLOOR.
 - 5.3 OPTIONAL HANDS-FREE AUTODIALING TELEPHONE ON PLATFORM.
6. ALTERNATE DOOR HANDING AVAILABLE. CONTACT ASCENSION FOR PROJECT-SPECIFIC DRAWINGS.

<small>INTERPRET DIMENSIONS AND TOLERANCES IAW ANSI Y14.5M-1994 UNLESS OTHERWISE SPECIFIED DIMENSIONS ARE IN INCHES (MM) TOLERANCES ANGLES ± .4°</small> <small>DECIMALS .001 + .002 .004 + .025</small> <small>DO NOT SCALE DRAWING.</small>	<small>DESIGNER</small> S APPELBY	<small>DATE</small> 6-17-19	<small>P.O. BOX 4000 TUCSON, ARIZONA 85717-0000</small>
	<small>CHECKED</small> APPROVED <small>By Philip Brobeck at 3:31 pm, Jun 20, 2019</small>	<small>SCALE</small> 1/16	<small>REV</small> D 08992
<small>PROJECT</small> CLARITY VERTICAL PLATFORM LIFT SHAFTWAY, SAME-SIDE ENTRY/EXIT		<small>FSCM NO.</small> 08992	<small>REV</small> A
<small>SCALE</small> 1/16		<small>RELEASED</small> 1 OF 1	<small>SCALE</small> 1 OF 1

CLARITY LOADING - SAME SIDE ENTRY & EXIT (16C, 16D)

(GENERIC APPLICATION DEPICTED; ENCLOSURE AND PLATFORM NOT SHOWN)

FRONT VIEW

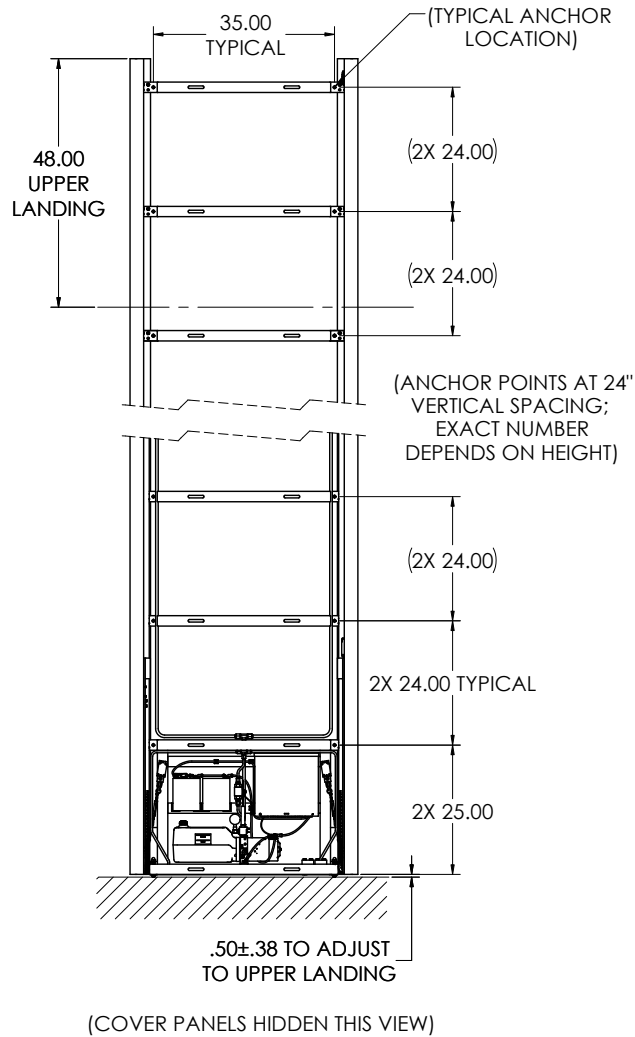

SIDE VIEW

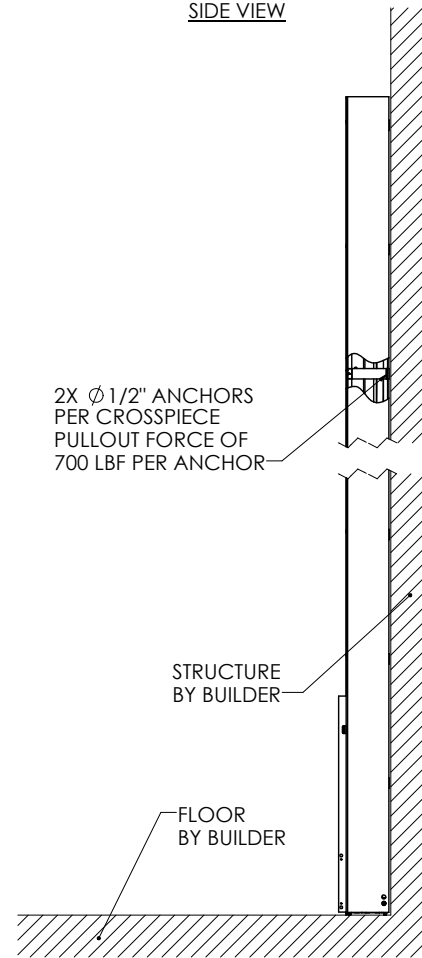

TOTAL UNIT WEIGHT
 16C: 1300 LB MAX
 16D: 2200 LB MAX
 (EXCLUDING 750 LB RATED LOAD AND COMPONENTS BY OTHERS)

16D ONLY:

ADDITIONAL FASTENING POINTS LOCATED AT LOWER LANDING FOR ENCLOSURE BASE AND AT UPPER LANDING FOR MOUNTED GATE/DOOR:

LOWER LANDING: 2X Ø 1/2" ANCHORS
 SHEAR FORCE OF 100 LBF PER ANCHOR

UPPER LANDING: 2X Ø 1/4" FLAT HEAD ANCHORS
 SHEAR FORCE OF 100 LBF PER ANCHOR

GENERAL INFORMATION

1. LOADS LISTED ASSUME STATIC LOADING AND DO NOT INCLUDE CONSIDERATIONS FOR WIND, SEISMIC, OR SAFETY FACTOR.
2. VERIFY ALL ANCHOR LOCATIONS IN FIELD PRIOR TO DRILLING. DRILL AFTER POSITIONING CABINET.

<small>INTERPRET DIMENSIONS AND TOLERANCES IN ACCORDANCE WITH ASME Y14.5M-1994 UNLESS OTHERWISE SPECIFIED DIMENSIONS ARE IN INCHES TOLERANCES</small> <small>DECIMALS .XXX ± .004 .XXX ± .004 .XXX ± .004</small>		<small>DATE</small> 6-17-19	<small>P.O. BOX 40020 TUCSON, ARIZONA 85717-0020</small>
<small>DRAWN BY</small> S. APPLEBY	<small>CHECKED BY</small> APPROVED By Philip Brobeck at 9:44 am, Jun 20, 2019	ASCENSION®	
DO NOT SCALE DRAWING.		CLARITY LOADING SAME SIDE	
<small>SCALE</small> 1/12	<small>FSCM NO.</small> 08992	<small>DWG. NO.</small> CLARITY LOADING SS	<small>REV</small> -
<small>RELEASE DATE</small> 1 OF 1		<small>SHEET</small> 1 OF 1	