

ELEVATION

SECTION-A-A

JAMB BRUSH SEAL DETAIL

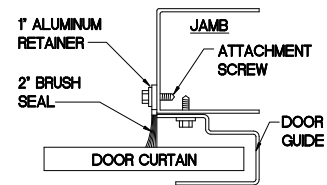

TOP DRAFT STOP DETAIL

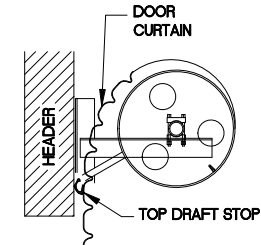

GUIDE DETAILS

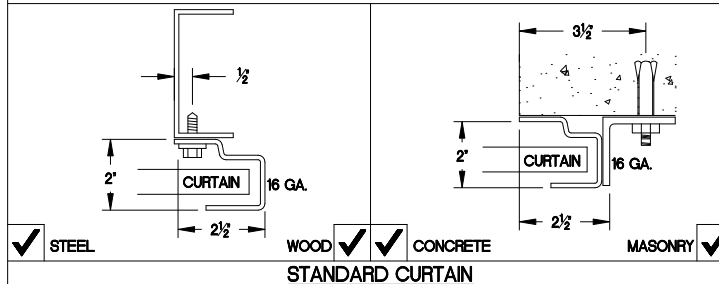

STANDARD CURTAIN

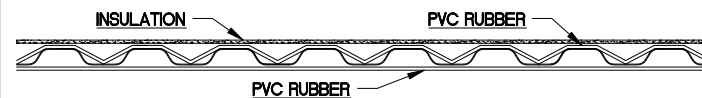

GENERAL NOTES:

CURTAIN:

- 26 GAUGE GALVANIZED STEEL WITH BAKED ON EPOXY PRIMER AND POLYESTER TOP COAT

GUIDES:

- ROLL FORMED 16 GAUGE GALVANIZED STEEL

OPERATION:

- RIGHT HAND SHOWN, LEFT HAND OPPOSITE

INSULATION:

- MYLAR AND POLYETHYLENE INSULATION LAMINATED TO BACK OF CURTAIN.

OTHER SURFACES:

- GALVANIZED OR SHOP COAT PRIMER

| SIDE ROOM REQUIREMENTS | | SEE 'ELEVATION' | |
|-------------------------------------|--------------------------------|-----------------|-----|
| <input checked="" type="checkbox"/> | CHOOSE TYPE OF OPERATION BELOW | A-1 | A-2 |
| <input checked="" type="checkbox"/> | HAND-ROPE PULL | 6" | 6" |
| <input checked="" type="checkbox"/> | REDUCTION GEAR CHAIN HOIST | 10" | 6" |
| <input checked="" type="checkbox"/> | ELECTRIC MOTOR OPERATOR KIT | 10" | 6" |

| MRK. | QTY. | OPENING SIZE | | OPERATION | R.H. | CLEARANCES | | OPTION |
|------|------|--------------|------------|-----------|------|------------|-----|--------|
| | | WIDTH 'W' | HEIGHT 'H' | | | L.H. | 'X' | |
| | | | | | | | | |
| | | | | | | | | |
| | | | | | | | | |
| | | | | | | | | |

| | | |
|--|--|--|
| PROJECT: | S:\ASTA Auto Cad Drawings 5_29_08\ASTA logo\REV1.jpg | 4255 McEver Industrial Dr. Acworth, GA 30101 PH:(770) 924-2600 Fax:(770) 974-1455 www.astadoor.com |
| ARCHITECT: | | |
| CONTRACTOR: | | |
| DISTRIBUTOR: | | |
| DATE: | SHEET: OF: BY: REF.# | |
| MODEL 202 INSULATED COMMERCIAL SHEET DOOR | | |

Asta Door Corporation is not responsible for the use of improper installation procedures, structural supports as well as field inspection prior to manufacturing and installation.

APPROVAL SIGNATURE: _____

DATE: _____