

ELEVATION

SECTION-A-A

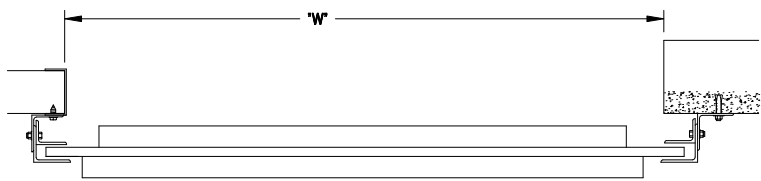

PLAN VIEW

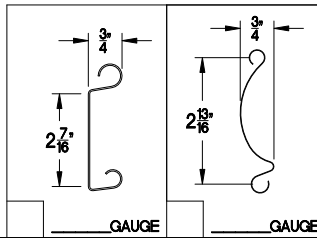

GAUGE

GAUGE

GUIDE DETAIL (NON-WINDLOCK)

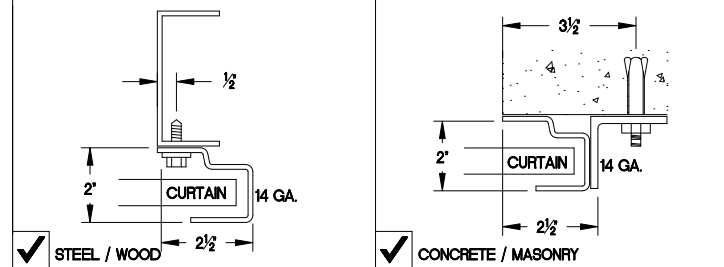

GUIDE DETAIL (NON-WINDLOCK)

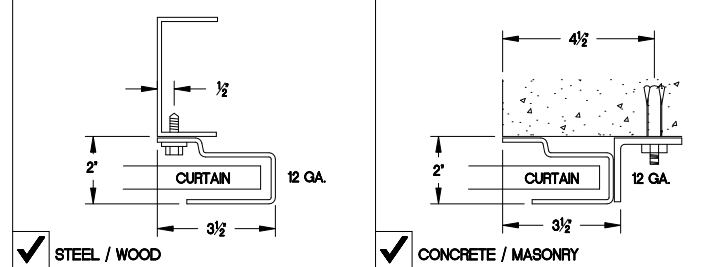

SIDEROOM REQUIREMENTS
(CHOOSE TYPE OF OPERATION)

HEADROOM REQUIREMENTS
(SEE ELEVATION)

	ROPE PULL	CHAIN HOIST	MOTOR OPERATION	HEIGHT	'X'	'V'
*A-1	6"	10"	9"	UP TO 8'-0"	20"	20"
*A-2	6"	6"	6"	UP TO 10'-0"	21"	21"
				OVER 10'-0"	23"	23"

- * NOTE: ALL DOORS GREATER THAN OR EQUAL TO 14' WIDE A-1 AND A-2 = 7' MINIMUM
- * NOTE: UPGRADE TO STRUCTURAL STEEL GUIDES A-1 AND A-2 = 7' MINIMUM
- * NOTE: ALL DIMENSIONS ON CHART BASED ON INSIDE FACING OUT

GENERAL NOTES

SLATS/HOOD: SELECT FINISH OPTION BELOW:

- GALVANIZED ONLY
- GRAY POLYESTER TOP COAT
- WHITE POLYESTER TOP COAT

OTHER SURFACES:

- SHOP COAT BLACK PRIMER

OPERATION:

- RIGHT HAND SHOWN, LEFT HAND OPPOSITE

MRK.	QTY.	OPENING SIZE		OPERATION	R.H.	OPTION	PROJECT:												
		WIDTH 'W'	HEIGHT 'H'				ARCHITECT:	CONTRACTOR:	DISTRIBUTOR:	DATE:	SHEET:	OF:	BY:	REF.#					
					LH.														

Asta Door Corporation is not responsible for the use of improper installation procedures, structural supports as well as field inspection prior to manufacturing and installation.

APPROVAL SIGNATURE:

DATE:

300 SERIES-COMMERCIAL SLAT DOOR (CHAIN HOIST)

4255 McEver Industrial Dr.
Acworth, GA 30101
PH:(770) 924-2600
Fax:(770) 974-1455
www.astadoor.com

SVASTA Auto Cad Drawings 5_29_08VASTA logo(NEW).jpg