



Creating Unique Products
for Your Market Needs

TS-324™ Roof System Architectural Details

Dwg. No.

E_TS0_001R01BRS

Date

AUGUST 2021

Index

Details Index.....	1
General Notes.....	2
Detail Locator.....	3
Roof Panel Sections - RollLok Seam.....	4
Roof Panel Sections - TripleLok Seam.....	5
Roof Panel Sections - QuadLok Seam.....	6
Eave Section - Eave Trim.....	7
Eave Section - Southern Style Eave Gutter.....	8
Eave Section - Northern Style Eave Gutter.....	9
Roof Panel Endlap Section.....	10
Ridge Section.....	11
High Eave Section - High Eave Trim.....	12
High Eave Section - Transition Flashing.....	13
Starting Rake Section - Rake Trim.....	14
Finish Rake Section - Rake Trim.....	15
Finish Rake Section - Alternate - On-Module Rake Trim.....	16
Rake Section - Transition Flashing.....	17
Rake Section - Alternate On-Module Transition Flashing.....	18
Hip Section.....	19
Valley Section.....	20
Valley Gutter Section.....	21
Interior Eave Gutter Section.....	22
Roof Sections - Fiberglass Insulation.....	23
Roof Sections - Fiberglass Insulation With Thermal Spacers.....	24
Roof Sections - Rigid Foam Insulation.....	25

Details Index

This drawing, as well as the designs and illustrations shown and described are furnished under licence and may be used or copied only in accordance with the terms of such licence. The content of this drawing is furnished to the Building Research Systems, Inc. (BRS) licensee only and is subject to change without notice and should not be construed as a commitment by BRS.

Printed in the United States of America. All rights reserved. This drawing may not be produced, stored in a retrieval system, or transmitted in any form without the written permission of Building Research Systems, Inc.



Creating Unique Products
for Your Market Needs

TS-324™ Roof System Architectural Details

Dwg. No.

E_TS0_002R00BRS

Date

JUNE 07

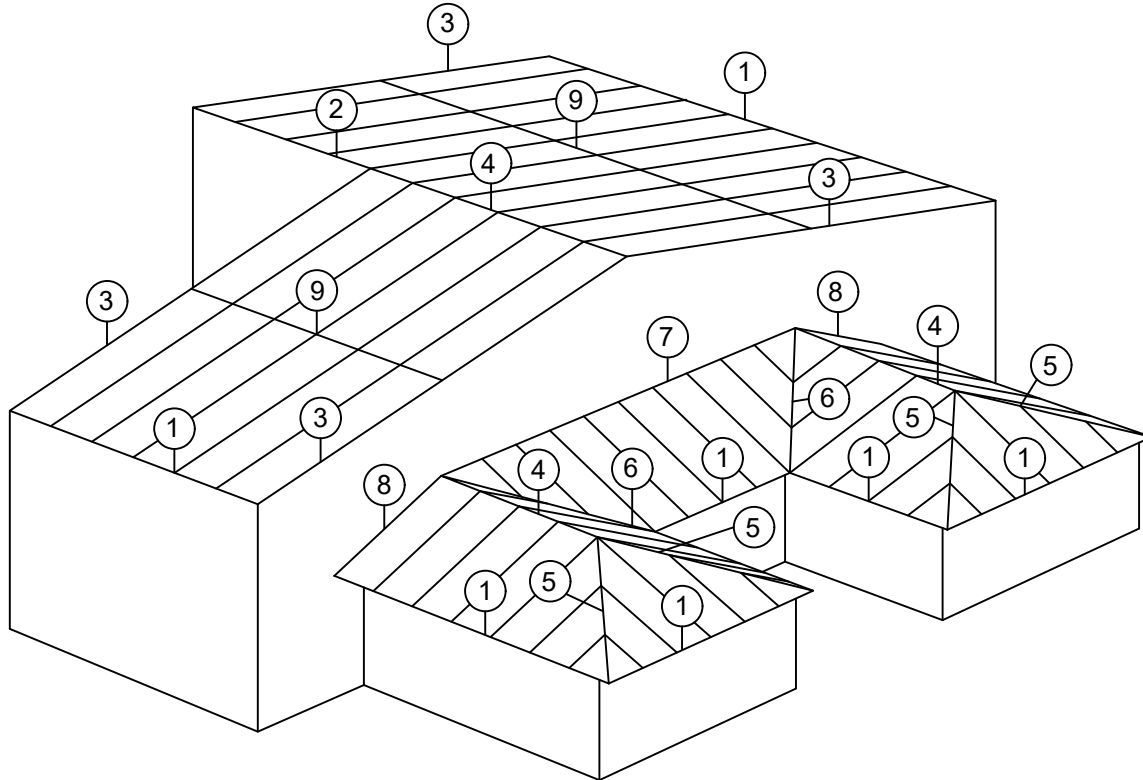

DETAIL LEGEND

- ①EAVE
- ②HIGH EAVE
- ③RAKE
- ④RIDGE
- ⑤HIP
- ⑥VALLEY
- ⑦HIGH EAVE TRANSITION
- ⑧RAKE TRANSITION
- ⑨ROOF PANEL ENDLAP

Detail Locator

This drawing, as well as the designs and illustrations shown and described are furnished under licence and may be used or copied only in accordance with the terms of such licence. The content of this drawing is furnished to the Building Research Systems, Inc. (BRS) licensee only and is subject to change without notice and should not be construed as a commitment by BRS.

Printed in the United States of America. All rights reserved. This drawing may not be produced, stored in a retrieval system, or transmitted in any form without the written permission of Building Research Systems, Inc.



Creating Unique Products
for Your Market Needs

TS-324™ Roof System Architectural Details

Dwg. No.

E_TS0_003R02BRS

Date

AUGUST 2021

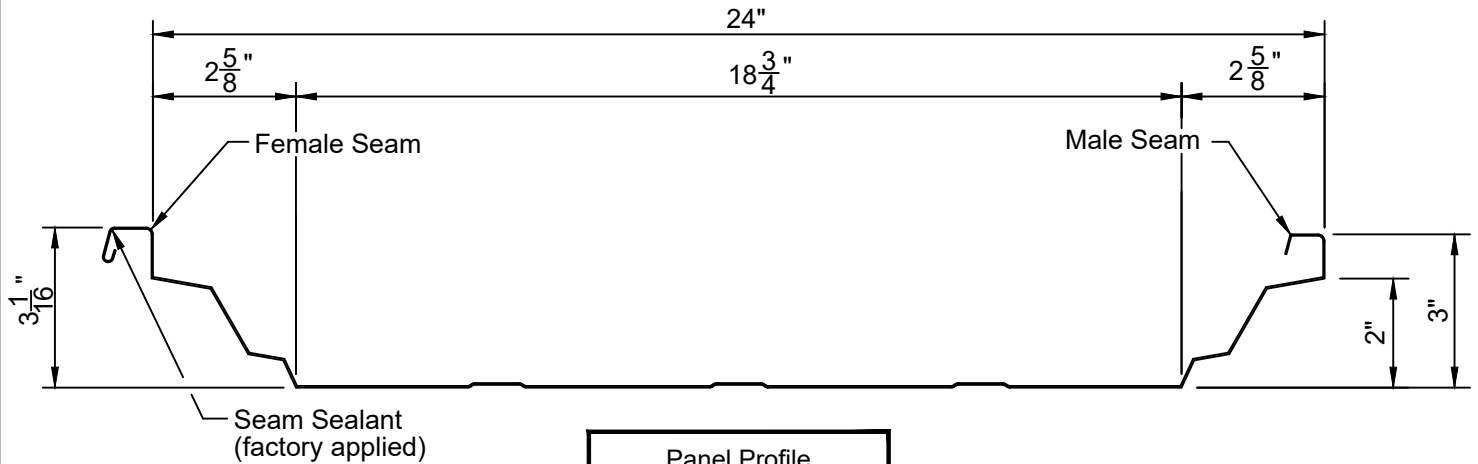

Seam Hand Crimped at Clips, Eaves, End Laps, Ridges, & High Sides

Note: For Clarity Of Detail, Roof Insulation Is Not Shown

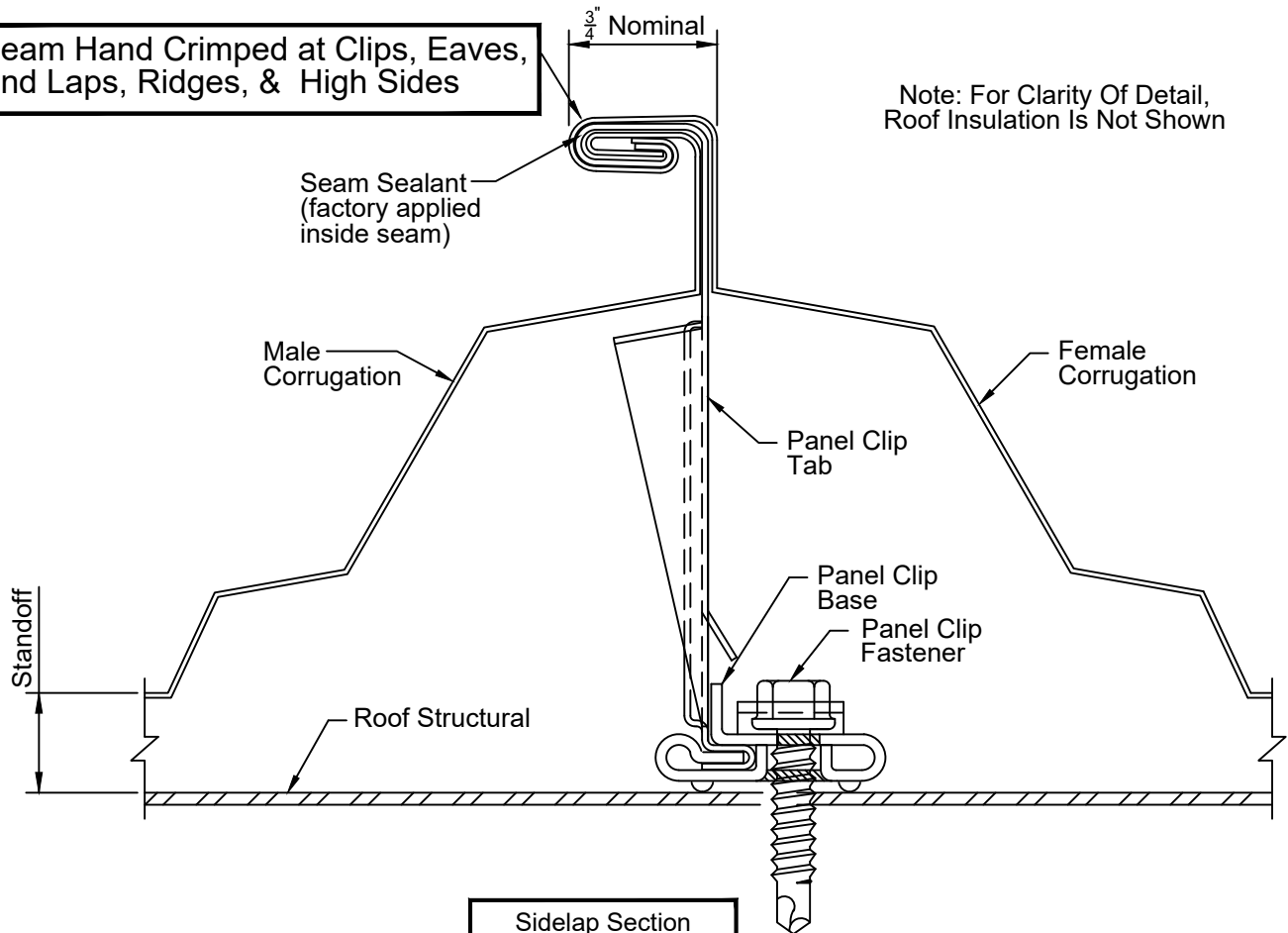

Roof Panel Sections-RollLok® Seam

This drawing, as well as the designs and illustrations shown and described are furnished under licence and may be used or copied only in accordance with the terms of such licence. The content of this drawing is furnished to the Building Research Systems, Inc. (BRS) licensee only and is subject to change without notice and should not be construed as a commitment by BRS.

Printed in the United States of America. All rights reserved. This drawing may not be produced, stored in a retrieval system, or transmitted in any form without the written permission of Building Research Systems, Inc.



Creating Unique Products
for Your Market Needs

TS-324™ Roof System Architectural Details

Dwg. No.

E_TS0_004R02BRS

Date

AUGUST 2021

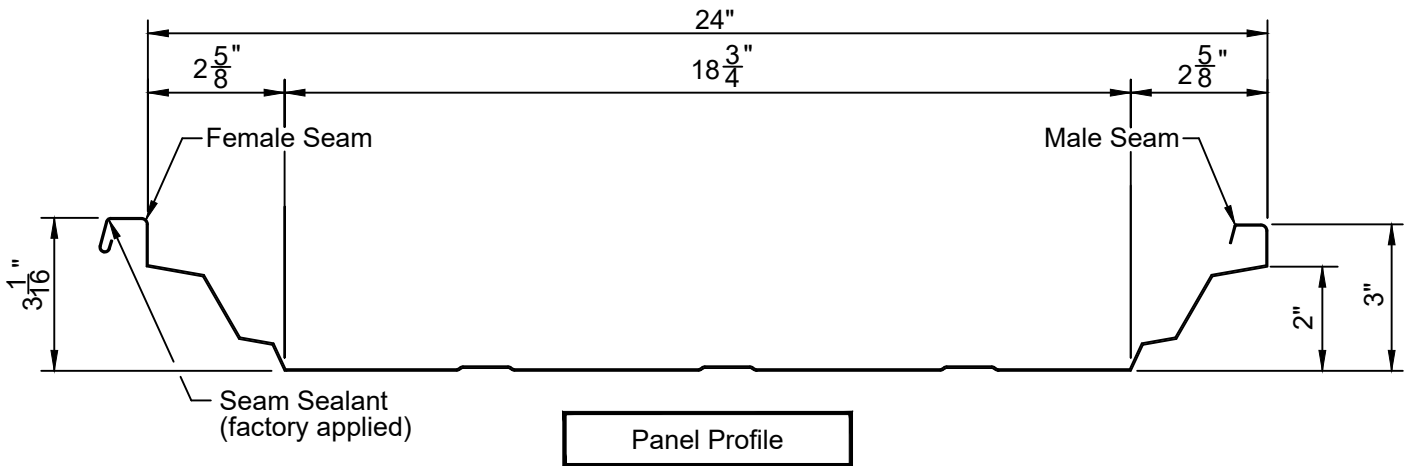

Mechanically Seamed - Full Length of Seam. Hand Crimp at Start of Seam Only.

Note: For Clarity Of Detail, Roof Insulation Is Not Shown

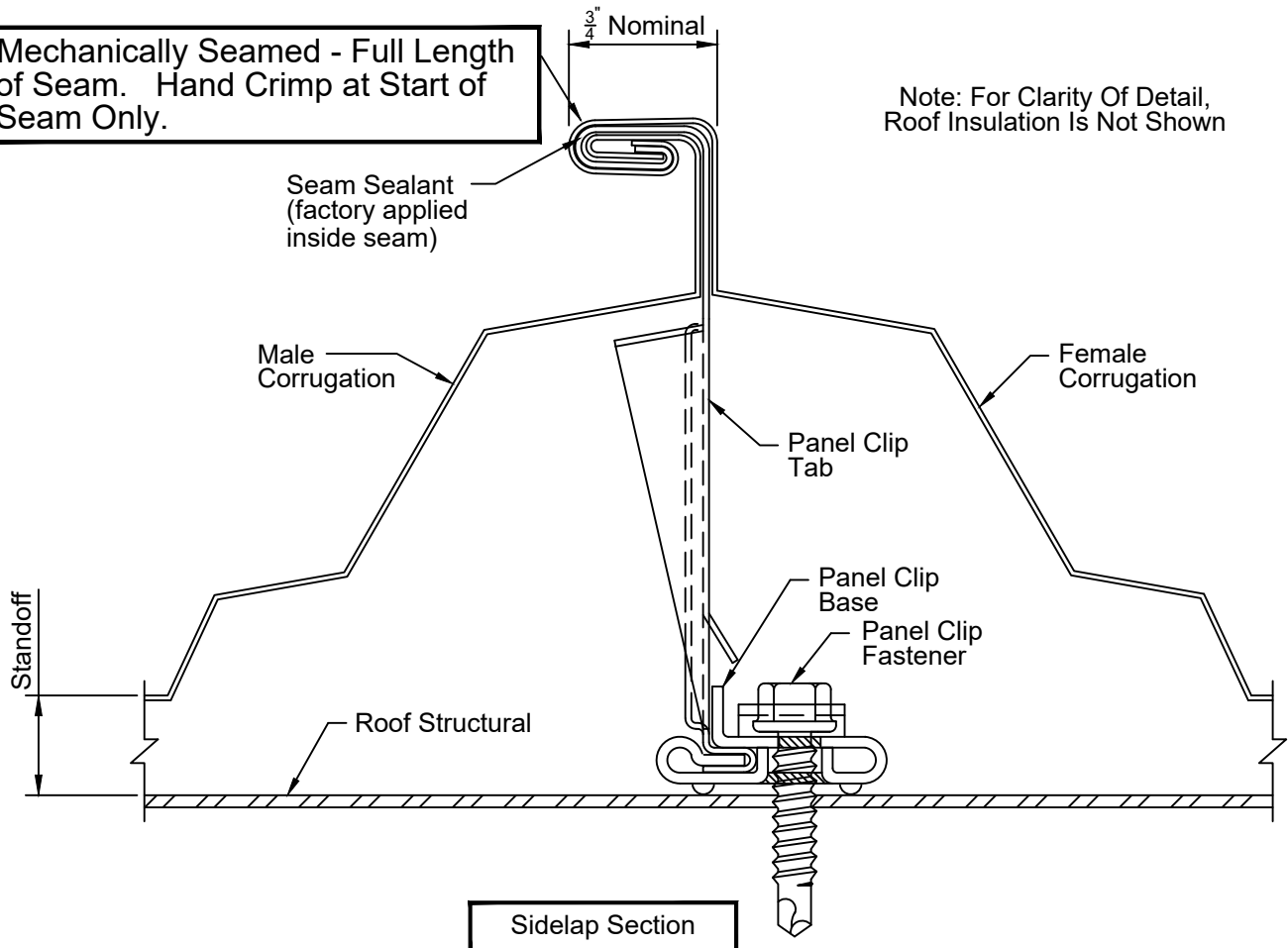

Roof Panel Sections-TripleLok® Seam

This drawing, as well as the designs and illustrations shown and described are furnished under licence and may be used or copied only in accordance with the terms of such licence. The content of this drawing is furnished to the Building Research Systems, Inc. (BRS) licensee only and is subject to change without notice and should not be construed as a commitment by BRS.

Printed in the United States of America. All rights reserved. This drawing may not be produced, stored in a retrieval system, or transmitted in any form without the written permission of Building Research Systems, Inc.



Creating Unique Products
for Your Market Needs

TS-324™ Roof System Architectural Details

Dwg. No.

E_TS0_005R02BRS

Date

AUGUST 2021

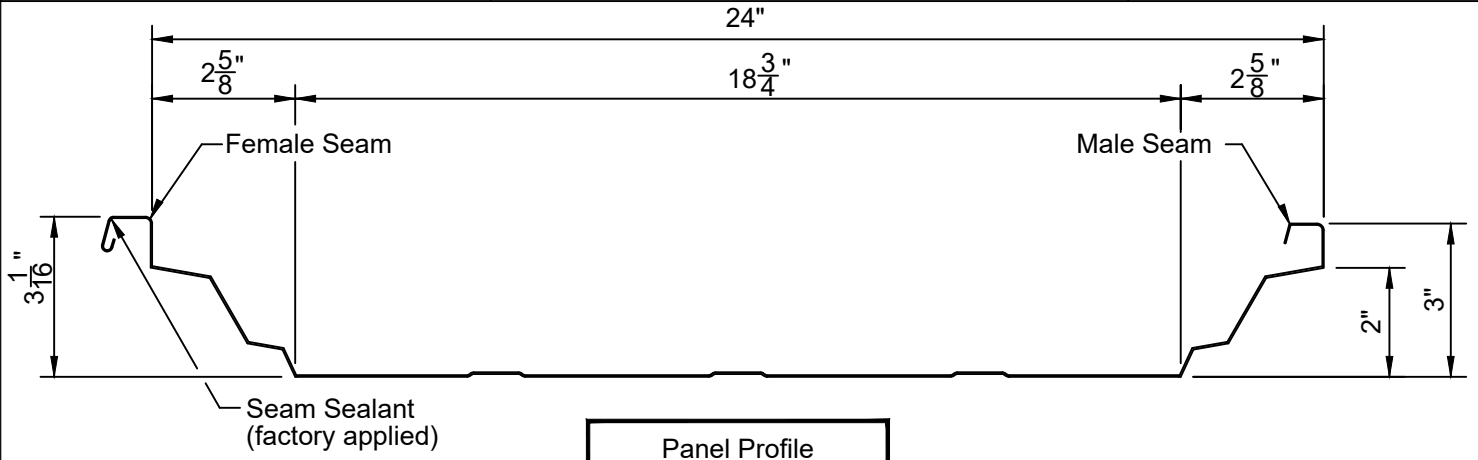

Mechanically Seamed - Full Length of Seam. Hand Crimp at Start of Seam Only.

Note: For Clarity Of Detail, Roof Insulation Is Not Shown

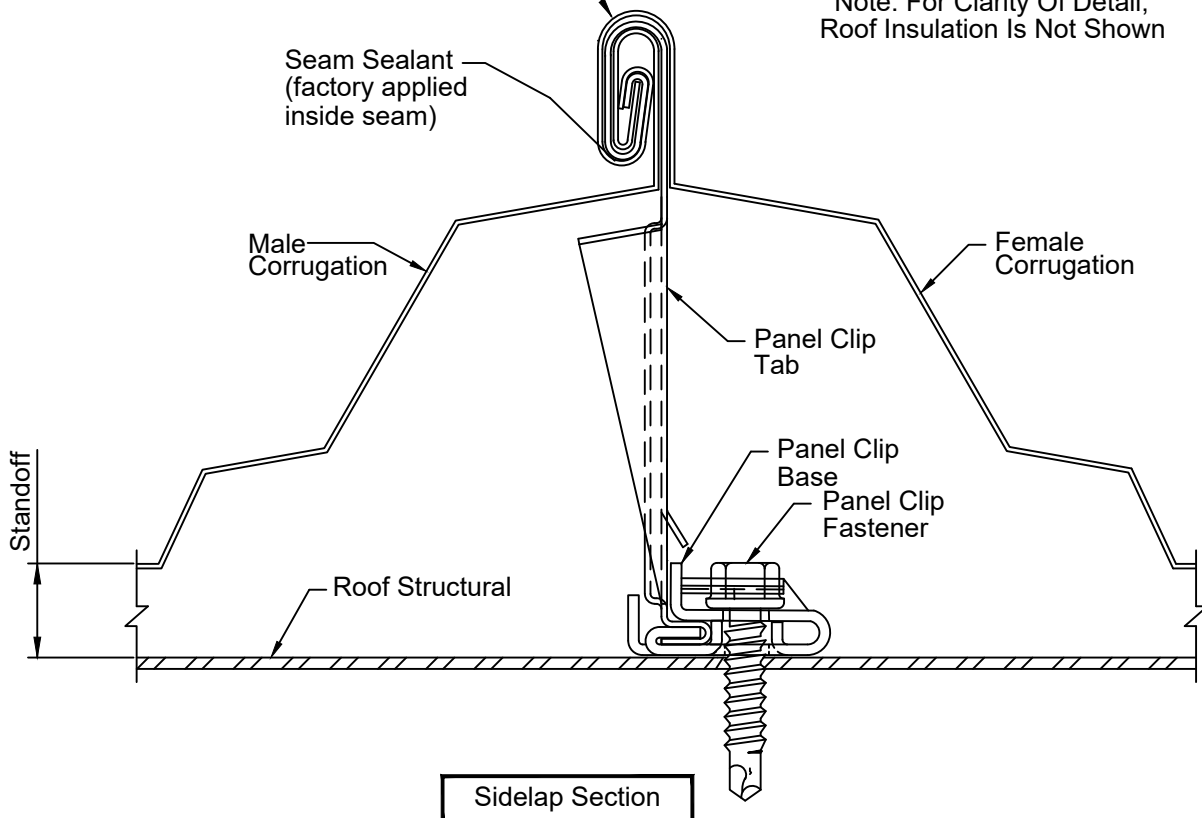

Roof Panel Sections-QuadLok® Seam

This drawing, as well as the designs and illustrations shown and described are furnished under licence and may be used or copied only in accordance with the terms of such licence. The content of this drawing is furnished to the Building Research Systems, Inc. (BRS) licensee only and is subject to change without notice and should not be construed as a commitment by BRS.

Printed in the United States of America. All rights reserved. This drawing may not be produced, stored in a retrieval system, or transmitted in any form without the written permission of Building Research Systems, Inc.



Creating Unique Products
for Your Market Needs

TS-324™ Roof System Architectural Details

Dwg. No.

E_TS0_006R02BRS

Date

AUGUST 2021

Note: For Clarity Of Detail,
Roof Insulation Is Not Shown

* Determined By Manufacturer.

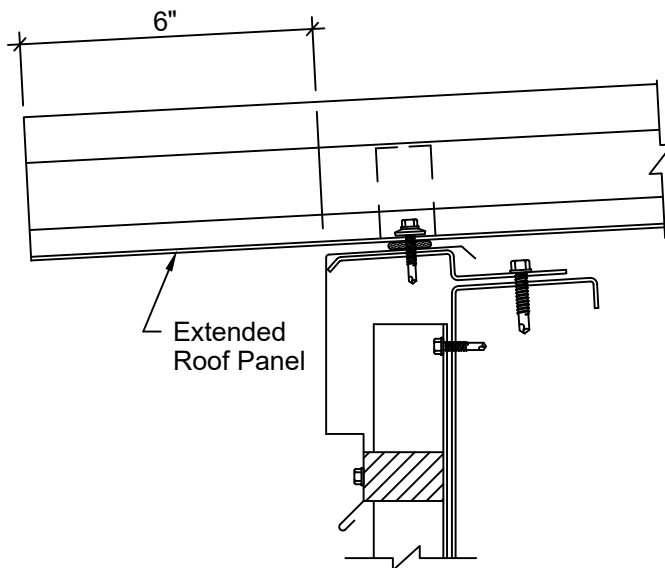
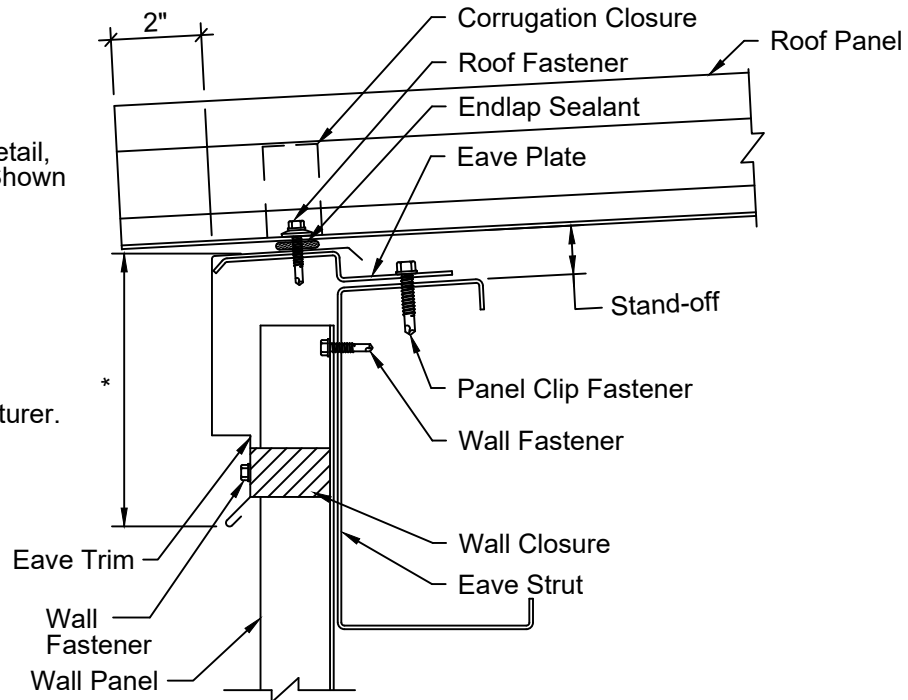

Extended Roof (For Heavy
Snow And Ice Areas)

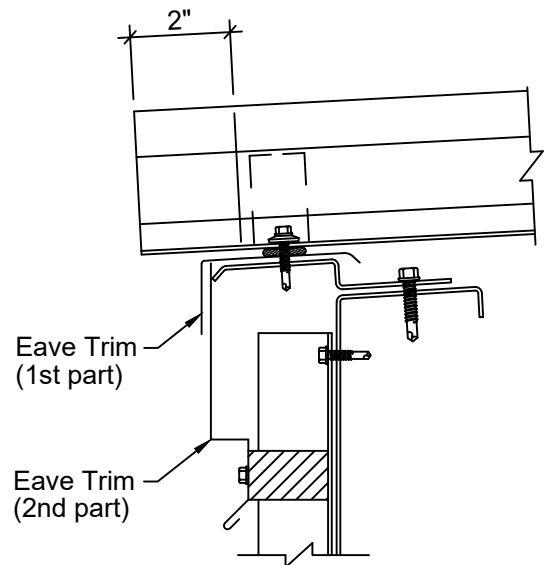

Alternate
Two Part Eave Trim (To Allow
Installation Of Wall Panel After
Roof Is In Place)

Eave Section - Eave Trim

This drawing, as well as the designs and illustrations shown and described are furnished under licence and may be used or copied only in accordance with the terms of such licence. The content of this drawing is furnished to the Building Research Systems, Inc. (BRS) licensee only and is subject to change without notice and should not be construed as a commitment by BRS.

Printed in the United States of America. All rights reserved. This drawing may not be produced, stored in a retrieval system, or transmitted in any form without the written permission of Building Research Systems, Inc.



Creating Unique Products
for Your Market Needs

TS-324™ Roof System Architectural Details

Dwg. No.

E_TS0_007.5R00BRS

Date

AUGUST 2021

Note: For Clarity Of Detail,
Roof Insulation Is Not Shown

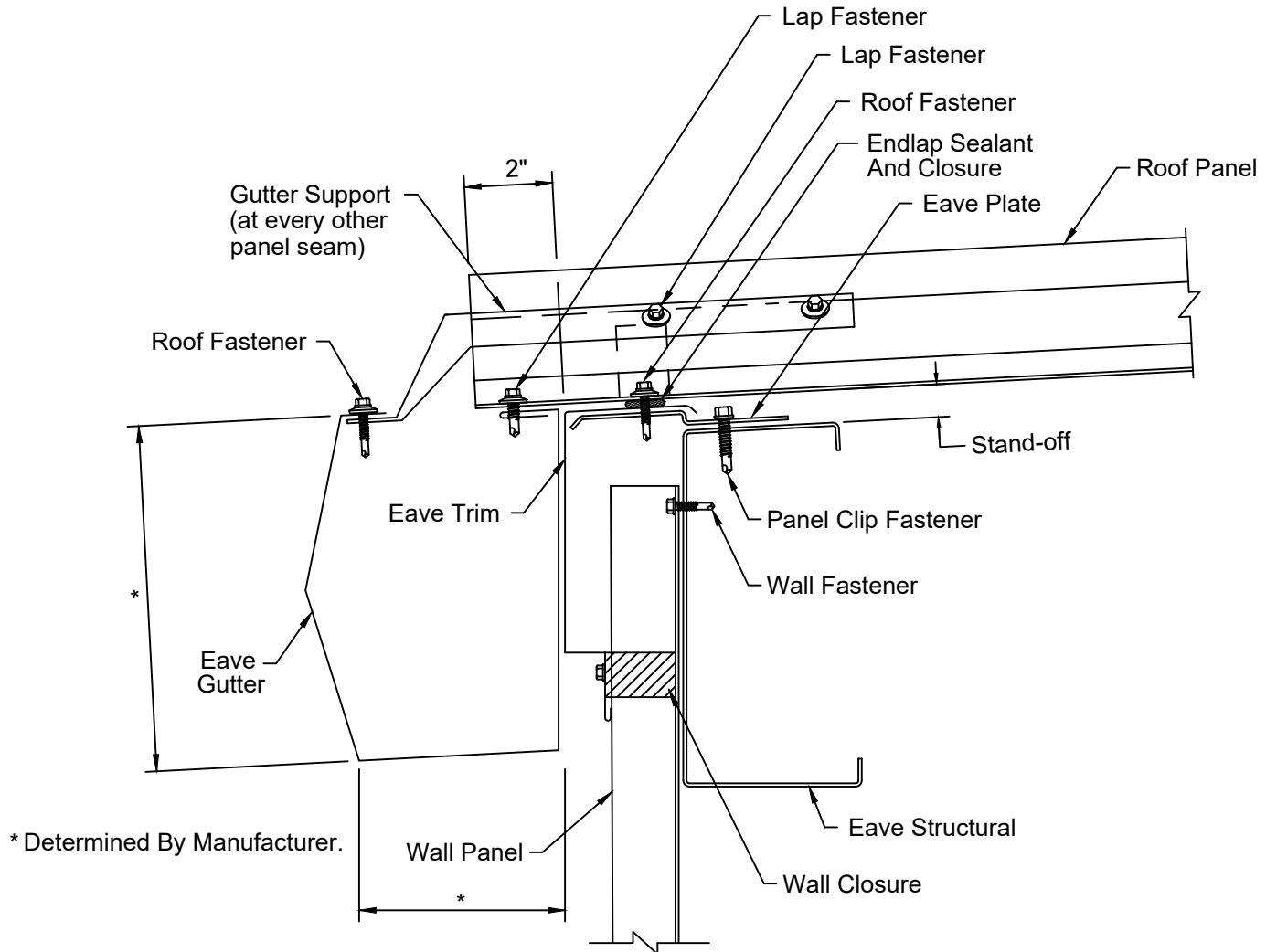

CAUTION
Northern Style Gutter May Not Be Suitable
For Areas That Experience Heavy Snow,
Ice, Extreme Rainfall Or Damming Conditions

Eave Section - Northern Style Eave Gutter

This drawing, as well as the designs and illustrations shown and described are furnished under licence and may be used or copied only in accordance with the terms of such licence. The content of this drawing is furnished to the Building Research Systems, Inc. (BRS) licensee only and is subject to change without notice and should not be construed as a commitment by BRS.

Printed in the United States of America. All rights reserved. This drawing may not be produced, stored in a retrieval system, or transmitted in any form without the written permission of Building Research Systems, Inc.



Creating Unique Products
for Your Market Needs

TS-324™ Roof System Architectural Details

Dwg. No.

E_TS0_008R02BRS

Date

AUGUST 2021

Note: For Clarity Of Detail,
Roof Insulation Is Not Shown

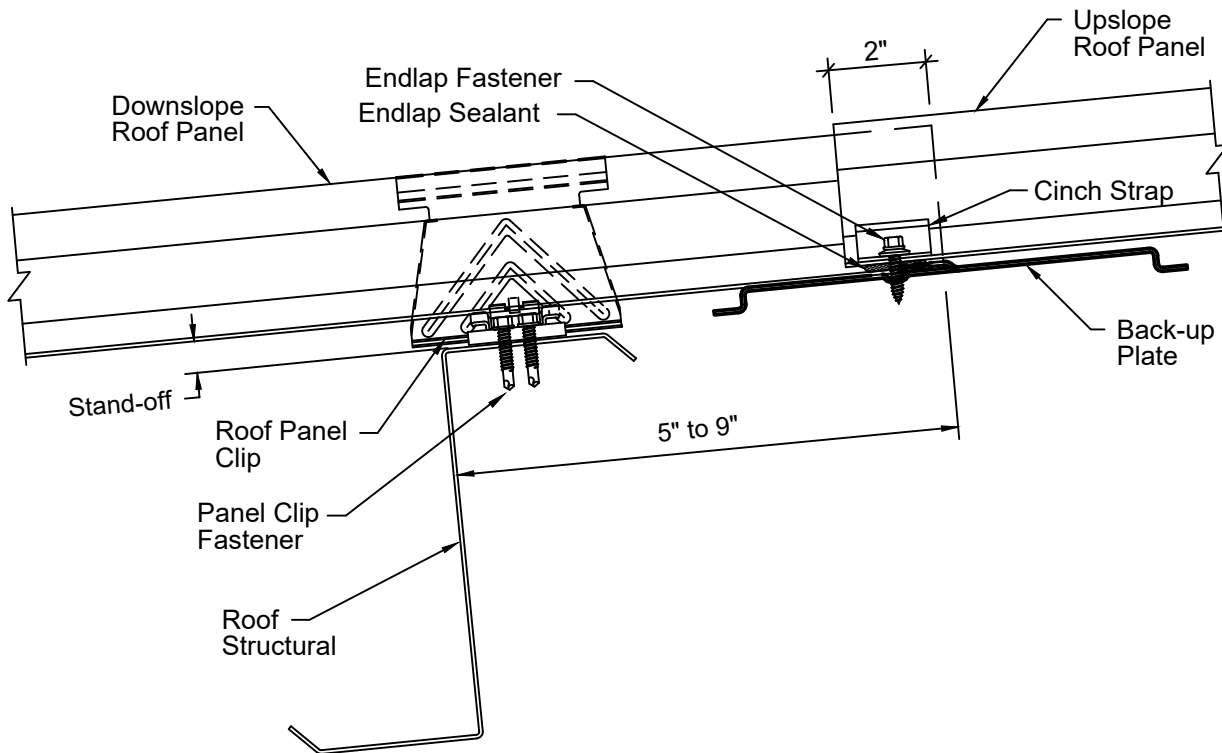

Roof Panel Endlap Section

This drawing, as well as the designs and illustrations shown and described are furnished under licence and may be used or copied only in accordance with the terms of such licence. The content of this drawing is furnished to the Building Research Systems, Inc. (BRS) licensee only and is subject to change without notice and should not be construed as a commitment by BRS.

Printed in the United States of America. All rights reserved. This drawing may not be produced, stored in a retrieval system, or transmitted in any form without the written permission of Building Research Systems, Inc.



Creating Unique Products
for Your Market Needs

TS-324™ Roof System Architectural Details

Dwg. No.

E_TS0_009R03BRS

Date

AUGUST 2021

Note: For Clarity Of Detail,
Roof Insulation Is Not Shown

- * Determined By Manufacturer
- ** As Required for Expansion

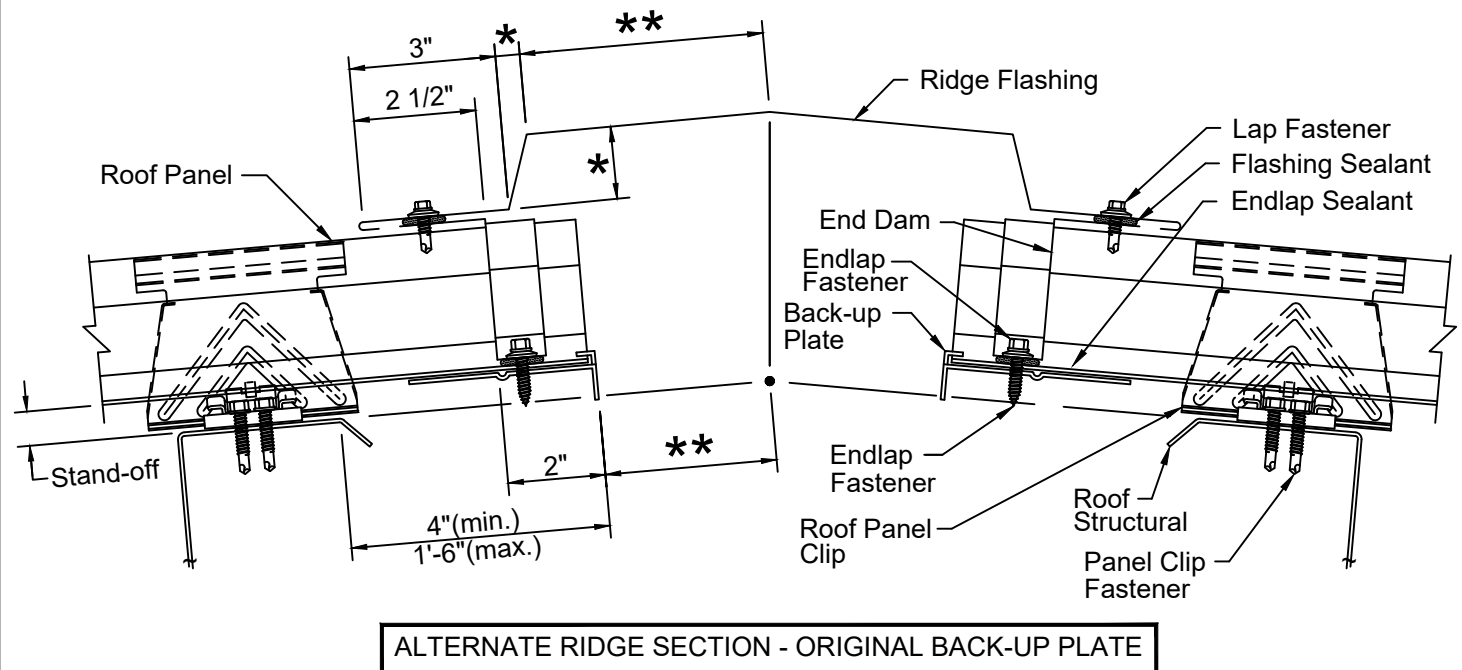
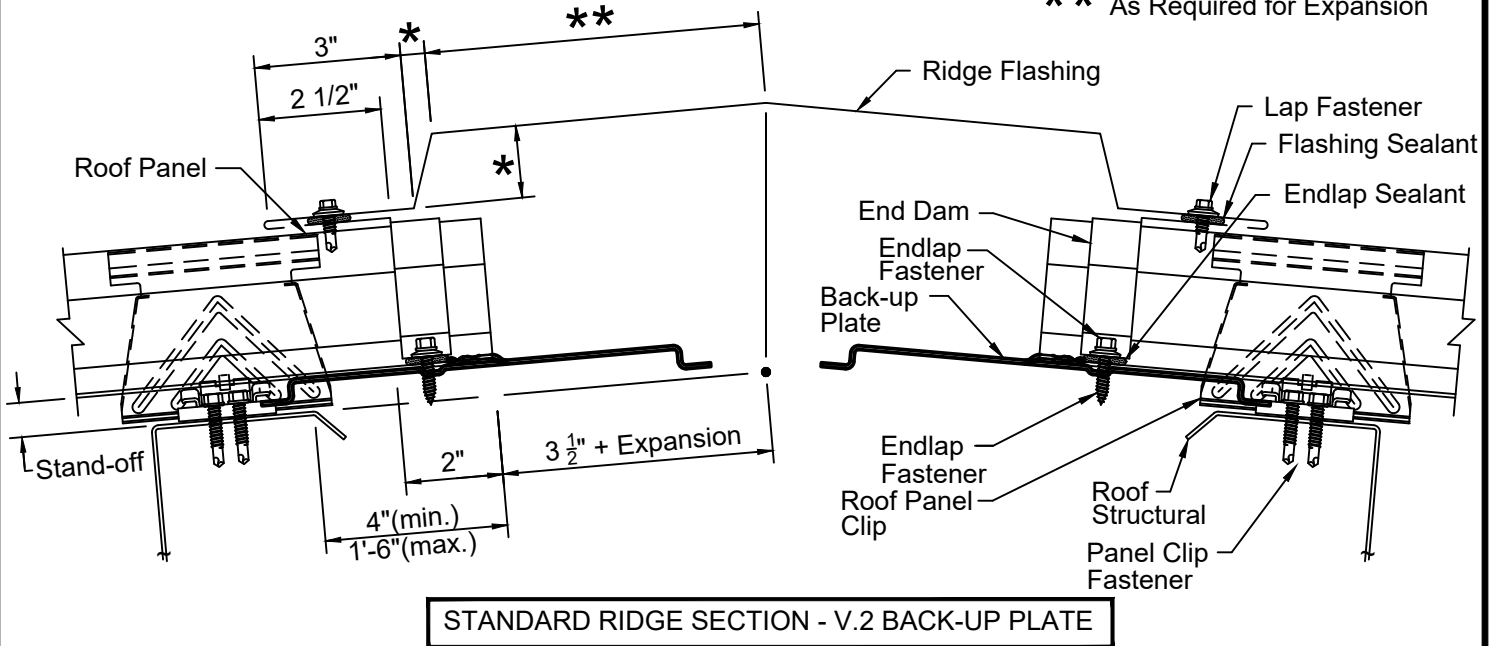

Ridge Section

This drawing, as well as the designs and illustrations shown and described are furnished under licence and may be used or copied only in accordance with the terms of such licence. The content of this drawing is furnished to the Building Research Systems, Inc. (BRS) licensee only and is subject to change without notice and should not be construed as a commitment by BRS.

Printed in the United States of America. All rights reserved. This drawing may not be produced, stored in a retrieval system, or transmitted in any form without the written permission of Building Research Systems, Inc.



Creating Unique Products
for Your Market Needs

TS-324™ Roof System Architectural Details

Dwg. No.

E_TS0_010R03BRS

Date

AUGUST 2021

Note: For Clarity Of Detail,
Roof Insulation Is Not Shown

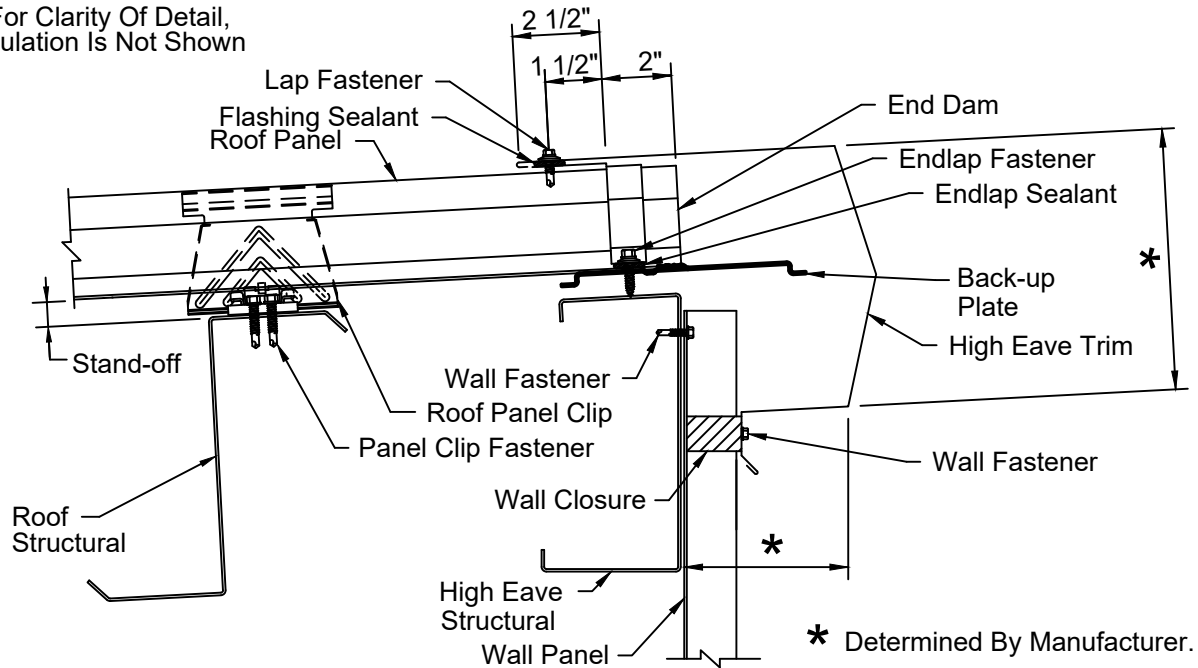

STANDARD HIGH EAVE SECTION - V.2 BACK-UP PLATE

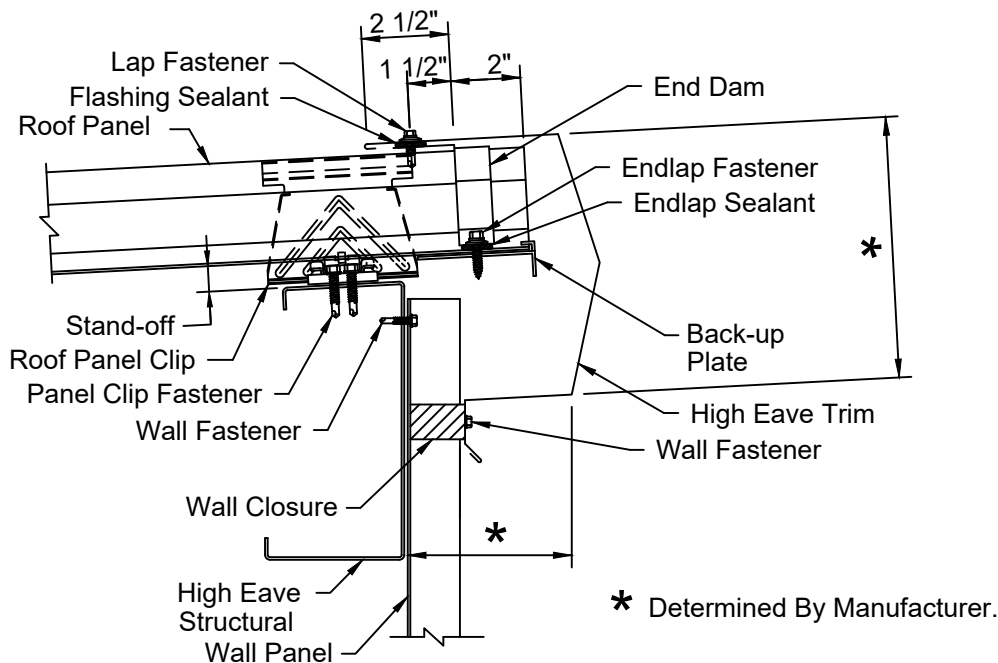

ALTERNATE HIGH EAVE SECTION - ORIGINAL BACK-UP PLATE

High Eave Section - High Eave Trim

This drawing, as well as the designs and illustrations shown and described are furnished under licence and may be used or copied only in accordance with the terms of such licence. The content of this drawing is furnished to the Building Research Systems, Inc. (BRS) licensee only and is subject to change without notice and should not be construed as a commitment by BRS.

Printed in the United States of America. All rights reserved. This drawing may not be produced, stored in a retrieval system, or transmitted in any form without the written permission of Building Research Systems, Inc.



Creating Unique Products
for Your Market Needs

TS-324™ Roof System Architectural Details

Dwg. No.

E_TS0_011R03BRS

Date

AUGUST 2021

Note: For Clarity Of Detail,
Roof Insulation Is Not Shown

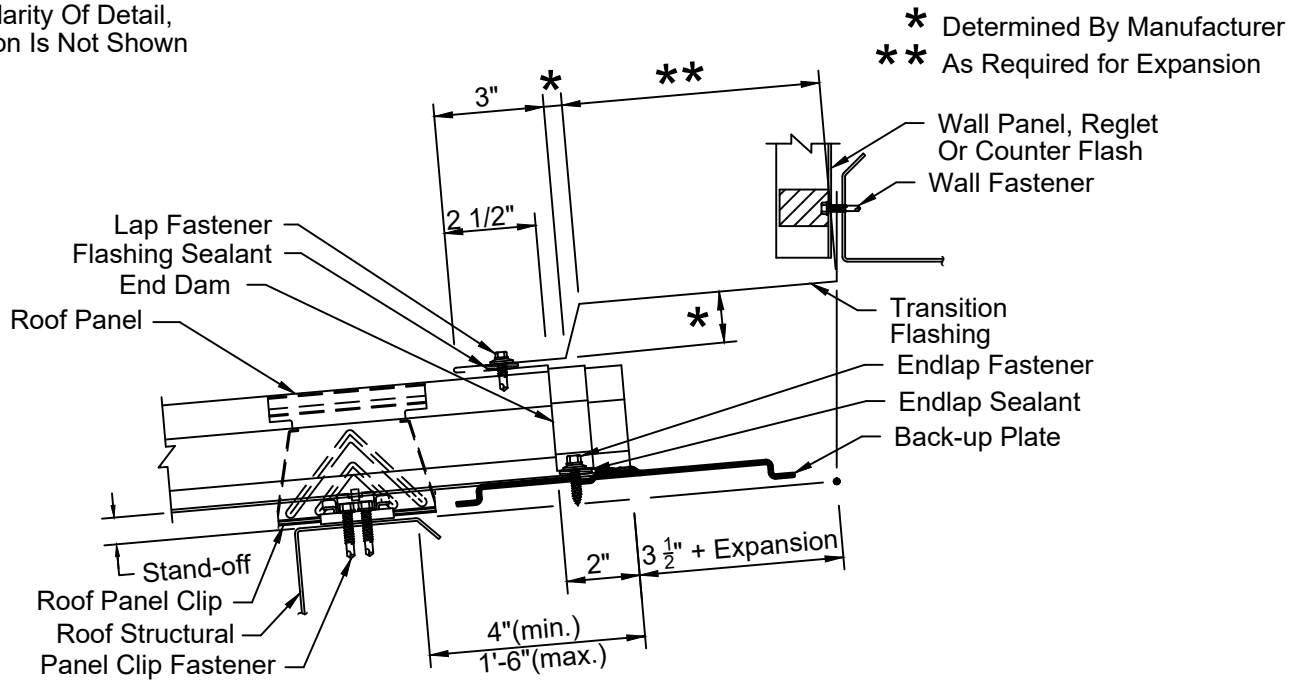

STANDARD HIGH EAVE TRANSITION - V.2 BACK-UP PLATE

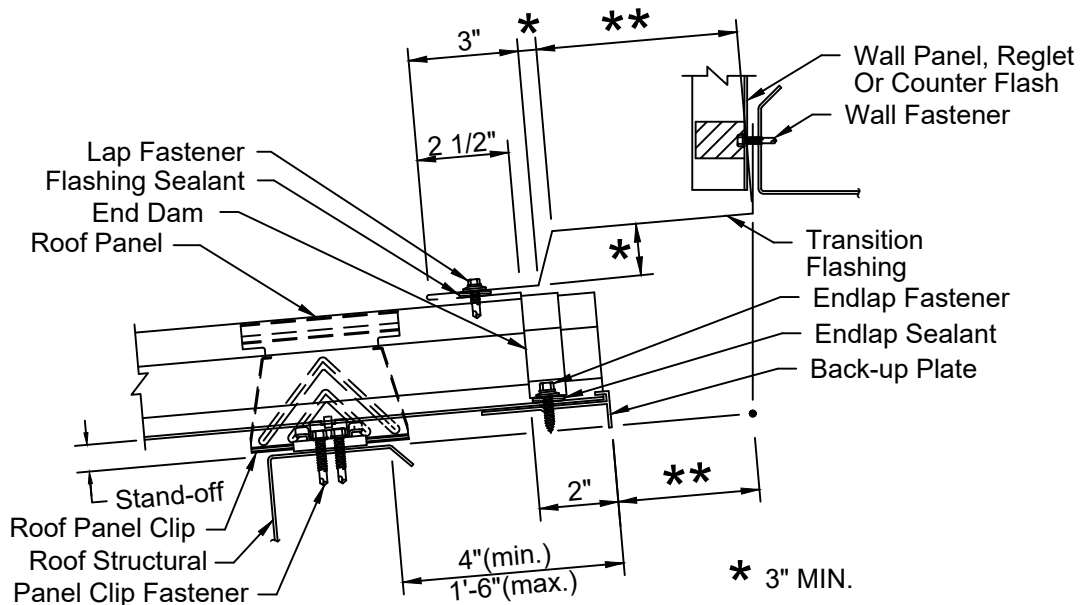

ALTERNATE HIGH EAVE TRANSITION - ORIGINAL BACK-UP PLATE

High Eave Section - Transition Flashing

This drawing, as well as the designs and illustrations shown and described are furnished under licence and may be used or copied only in accordance with the terms of such licence. The content of this drawing is furnished to the Building Research Systems, Inc. (BRS) licensee only and is subject to change without notice and should not be construed as a commitment by BRS.

Printed in the United States of America. All rights reserved. This drawing may not be produced, stored in a retrieval system, or transmitted in any form without the written permission of Building Research Systems, Inc.



Creating Unique Products
for Your Market Needs

TS-324™ Roof System Architectural Details

Dwg. No.

E_TS0_012R02BRS

Date

AUGUST 2021

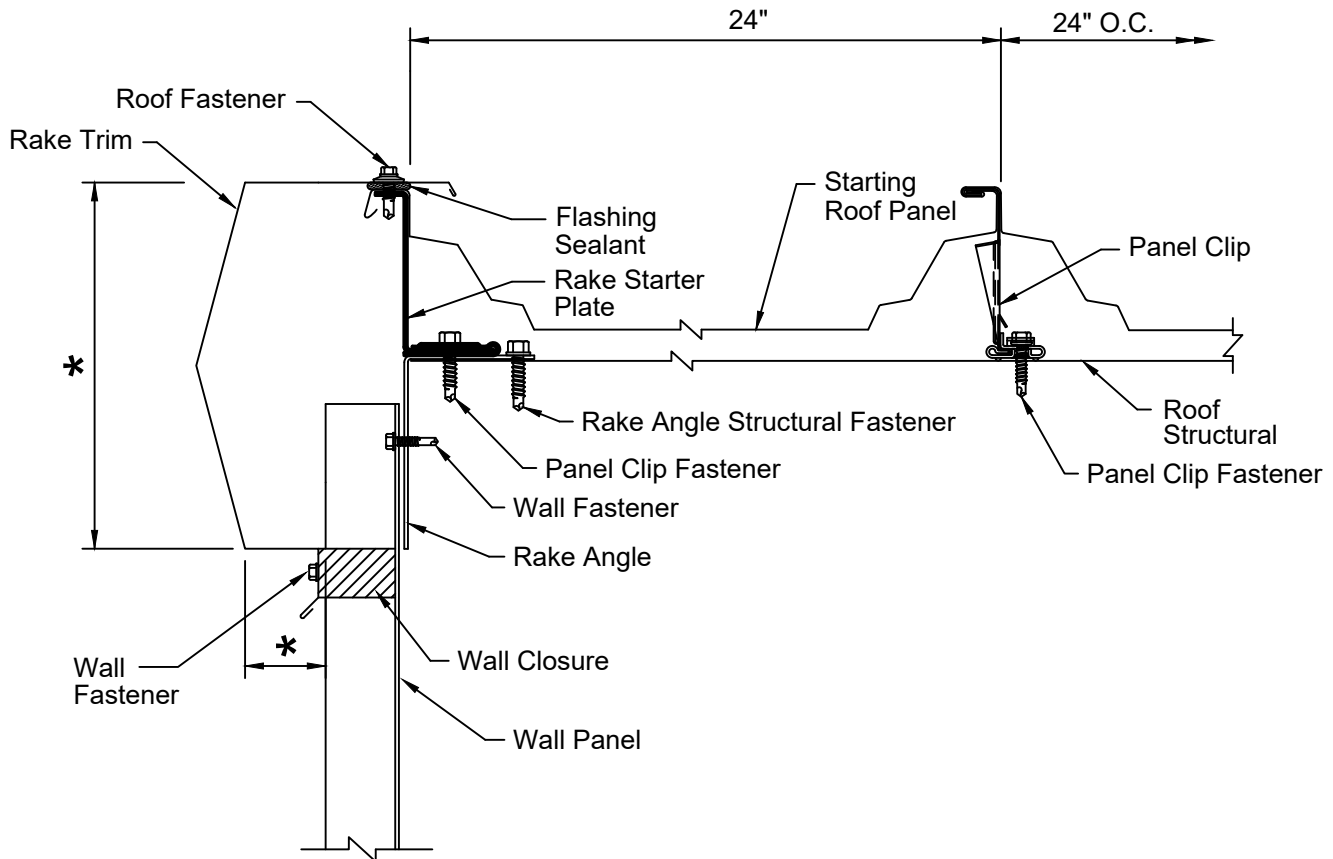

* Determined By Manufacturer.

Note: For Clarity Of Detail,
Roof Insulation Is Not Shown

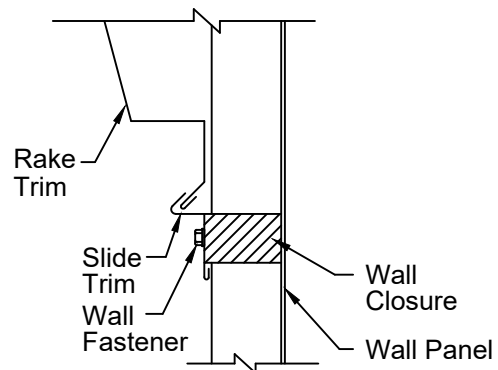

Alternate
Sliding Rake
Trim (Allows Expansion Movement Of Rake
Trim, Required When Roof Run Exceeds 25')

Starting Rake Section - Rake Trim

This drawing, as well as the designs and illustrations shown and described are furnished under licence and may be used or copied only in accordance with the terms of such licence. The content of this drawing is furnished to the Building Research Systems, Inc. (BRS) licensee only and is subject to change without notice and should not be construed as a commitment by BRS.

Printed in the United States of America. All rights reserved. This drawing may not be produced, stored in a retrieval system, or transmitted in any form without the written permission of Building Research Systems, Inc.



Creating Unique Products
for Your Market Needs

TS-324™ Roof System Architectural Details

Dwg. No.

E_TS0_013R03BRS

Date

AUGUST 2021

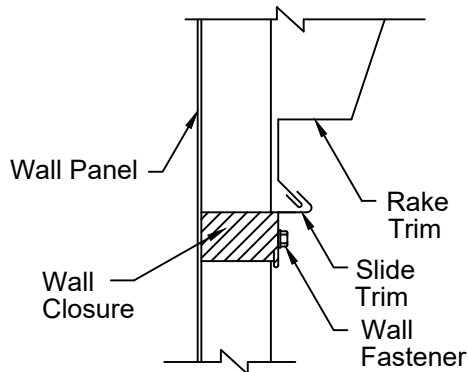
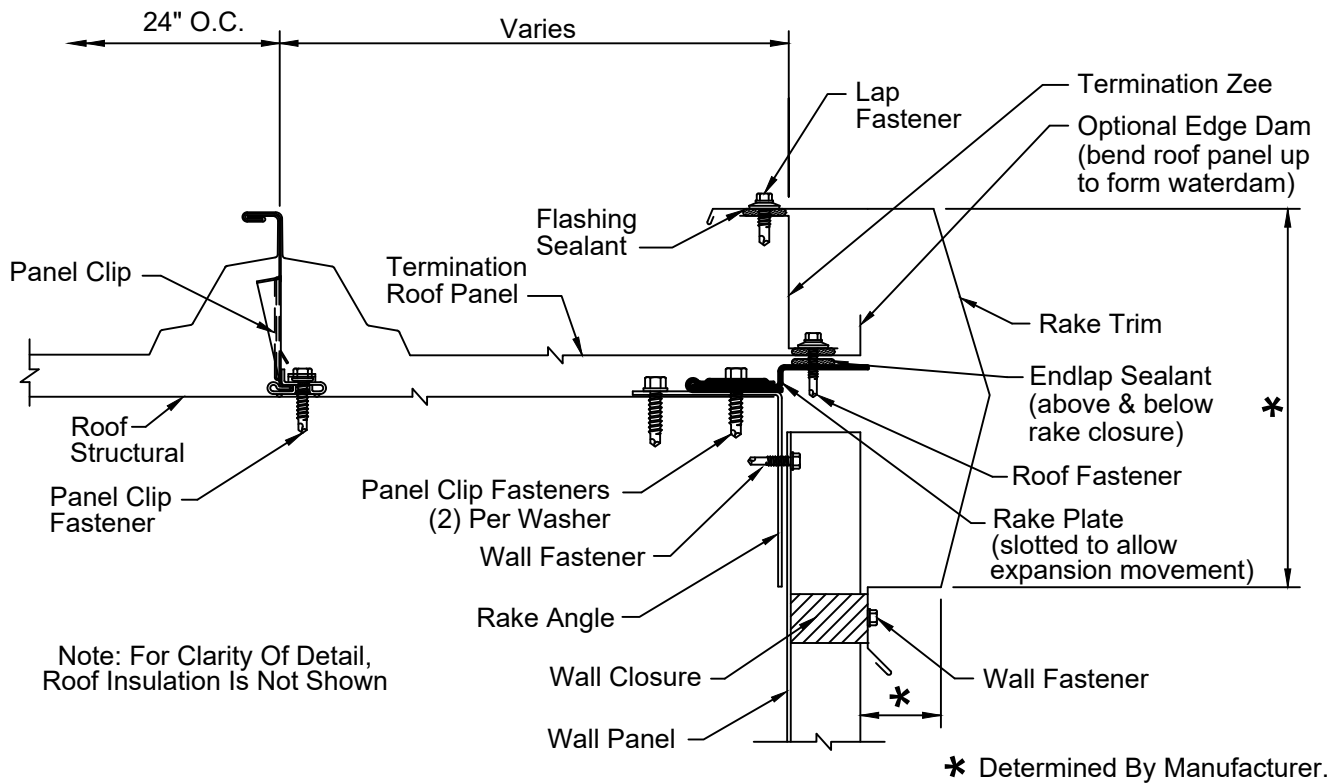

Alternate
Sliding Rake
Trim (Allows Expansion Movement Of Rake
Trim Required When Roof Run Exceeds 25')

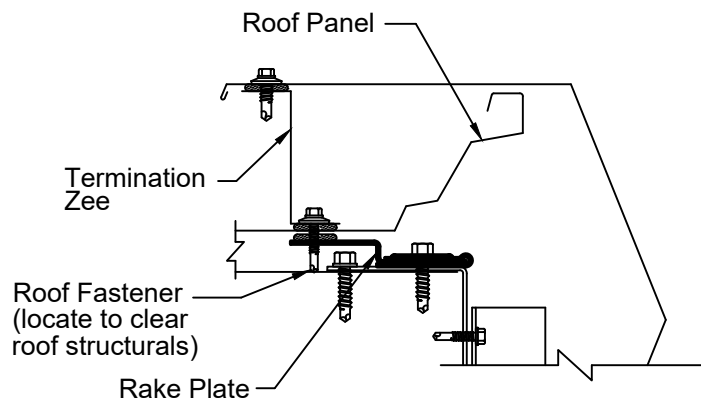

Alternate
Rake Plate Orientation

Finish Rake Section - Rake Trim

This drawing, as well as the designs and illustrations shown and described are furnished under licence and may be used or copied only in accordance with the terms of such licence. The content of this drawing is furnished to the Building Research Systems, Inc. (BRS) licensee only and is subject to change without notice and should not be construed as a commitment by BRS.

Printed in the United States of America. All rights reserved. This drawing may not be produced, stored in a retrieval system, or transmitted in any form without the written permission of Building Research Systems, Inc.



Creating Unique Products
for Your Market Needs

TS-324™ Roof System Architectural Details

Dwg. No.

E_TS0_013.5R00BRS

Date

AUGUST 2021

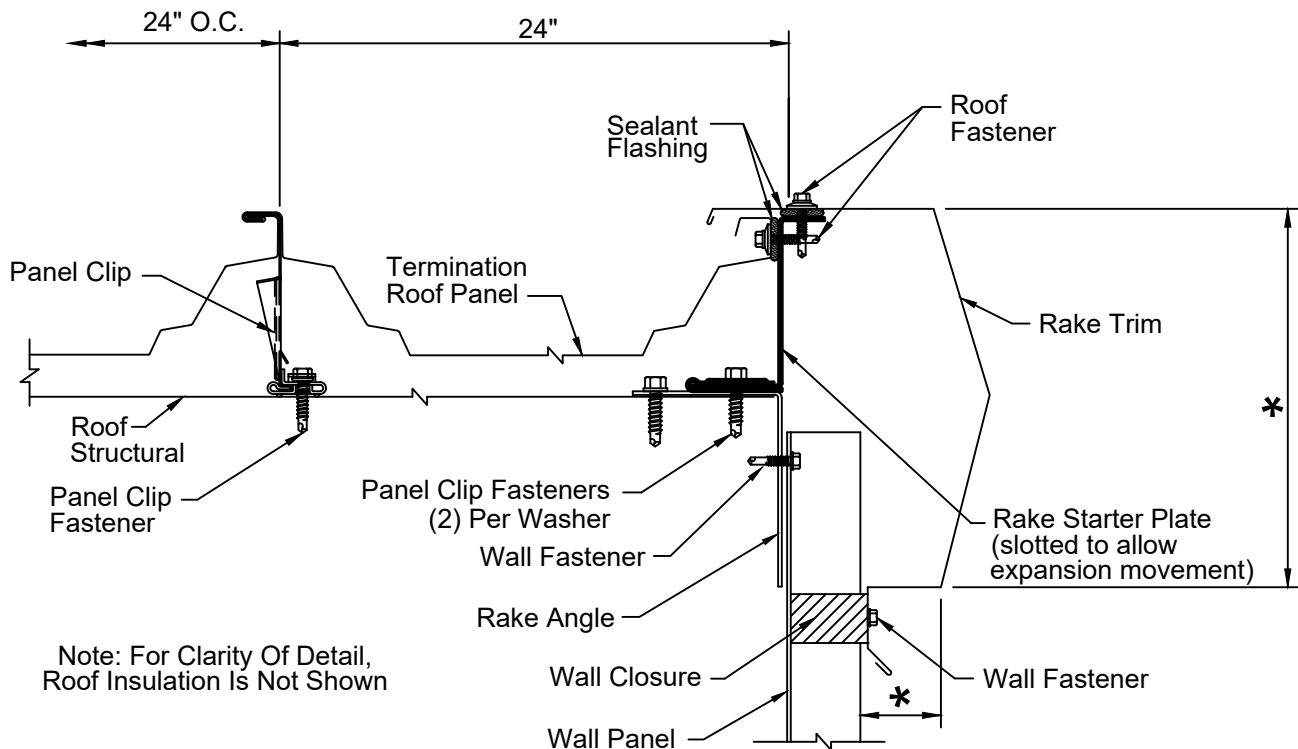

* Determined By Manufacturer.

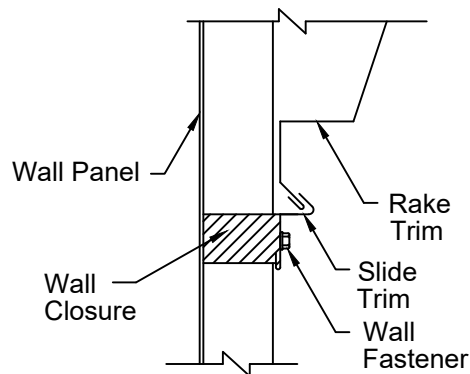

Alternate
Sliding Rake
Trim (Allows Expansion Movement Of Rake
Trim Required When Roof Run Exceeds 25')

Finish Rake Section - Alternate On-Module Rake Trim

This drawing, as well as the designs and illustrations shown and described are furnished under licence and may be used or copied only in accordance with the terms of such licence. The content of this drawing is furnished to the Building Research Systems, Inc. (BRS) licensee only and is subject to change without notice and should not be construed as a commitment by BRS.

Printed in the United States of America. All rights reserved. This drawing may not be produced, stored in a retrieval system, or transmitted in any form without the written permission of Building Research Systems, Inc.



Creating Unique Products
for Your Market Needs

TS-324™ Roof System Architectural Details

Dwg. No.

E_TS0_014R03BRS

Date

AUGUST 2021

* Determined By Manufacturer.

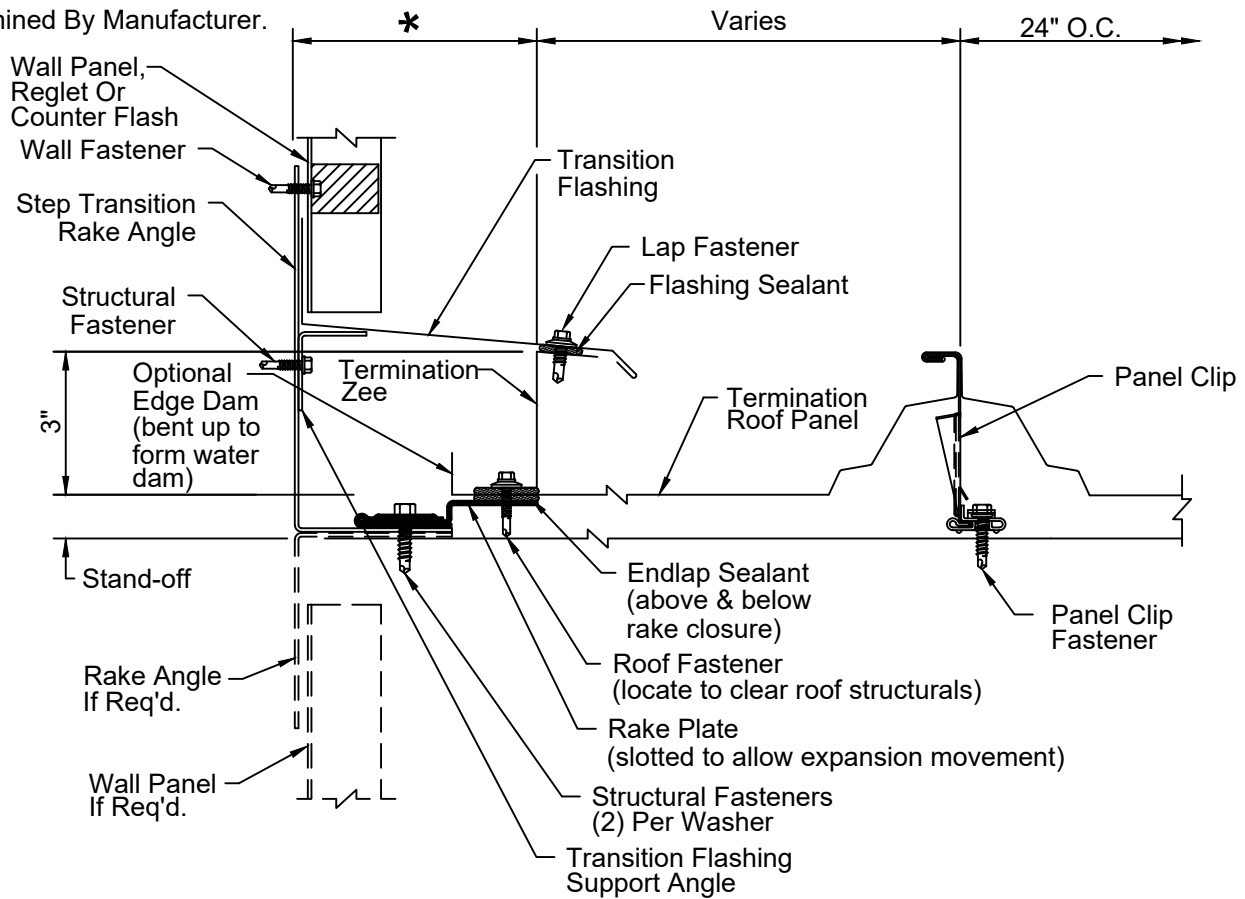

- Notes: 1. Detail Shown At Starting Rake,
Detail At Finish Rake Is Similar.
2. For Clarity Of Detail,
Roof Insulation Is Not Shown.

Rake Section - Transition Flashing

This drawing, as well as the designs and illustrations shown and described are furnished under licence and may be used or copied only in accordance with the terms of such licence. The content of this drawing is furnished to the Building Research Systems, Inc. (BRS) licensee only and is subject to change without notice and should not be construed as a commitment by BRS.

Printed in the United States of America. All rights reserved. This drawing may not be produced, stored in a retrieval system, or transmitted in any form without the written permission of Building Research Systems, Inc.



Creating Unique Products
for Your Market Needs

TS-324™ Roof System Architectural Details

Dwg. No.

E_TS0_014.5R01BRS

Date

AUGUST 2021

* Determined By Manufacturer.

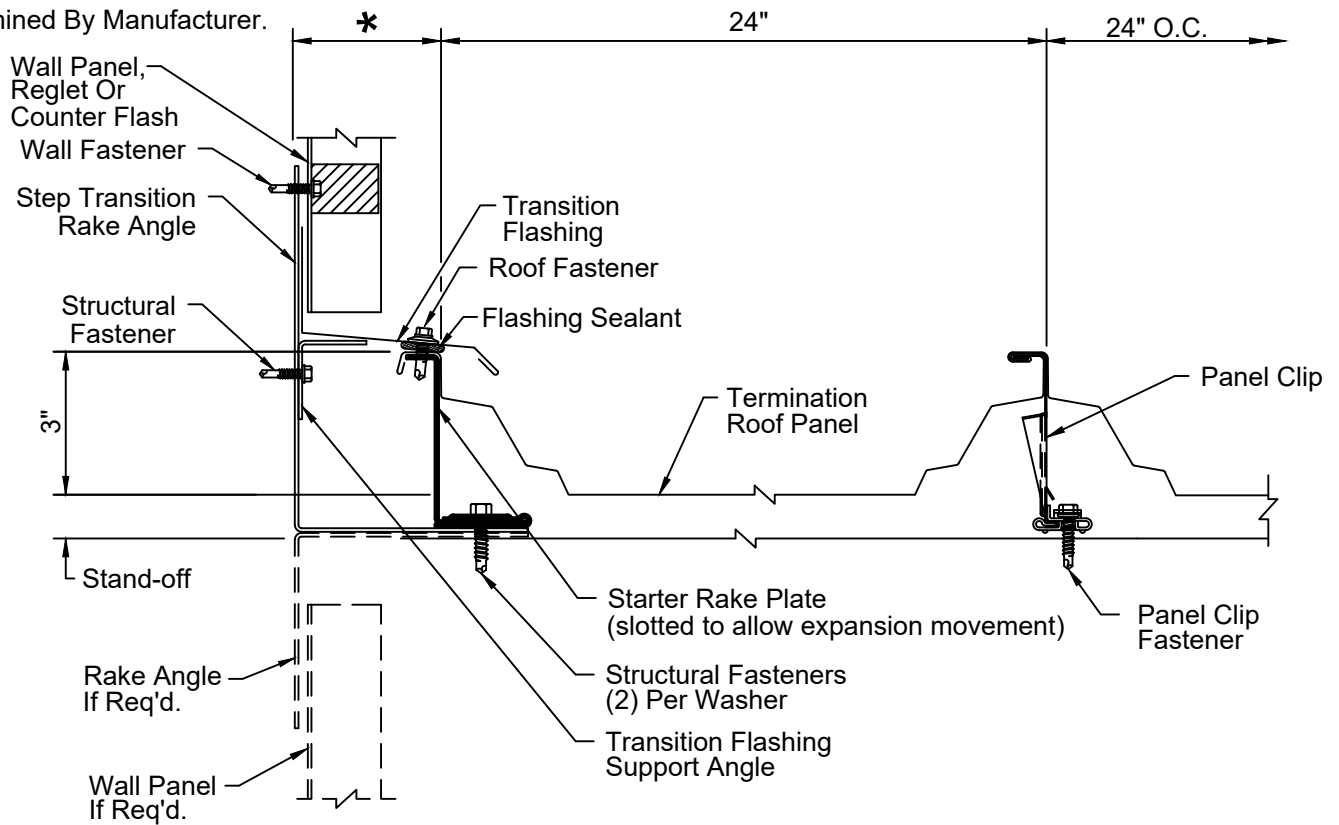

- Notes: 1. Detail Shown At Starting Rake,
Detail At Finish Rake Is Similar.
2. For Clarity Of Detail,
Roof Insulation Is Not Shown.

Rake Section - Alternate On-Module Transition Flashing

This drawing, as well as the designs and illustrations shown and described are furnished under licence and may be used or copied only in accordance with the terms of such licence. The content of this drawing is furnished to the Building Research Systems, Inc. (BRS) licensee only and is subject to change without notice and should not be construed as a commitment by BRS.

Printed in the United States of America. All rights reserved. This drawing may not be produced, stored in a retrieval system, or transmitted in any form without the written permission of Building Research Systems, Inc.



Creating Unique Products
for Your Market Needs

TS-324™ Roof System Architectural Details

Dwg. No.

E_TS0_015R01BRS

Date

AUGUST 2021

Note: For Clarity Of Detail,
Roof Insulation Is Not Shown

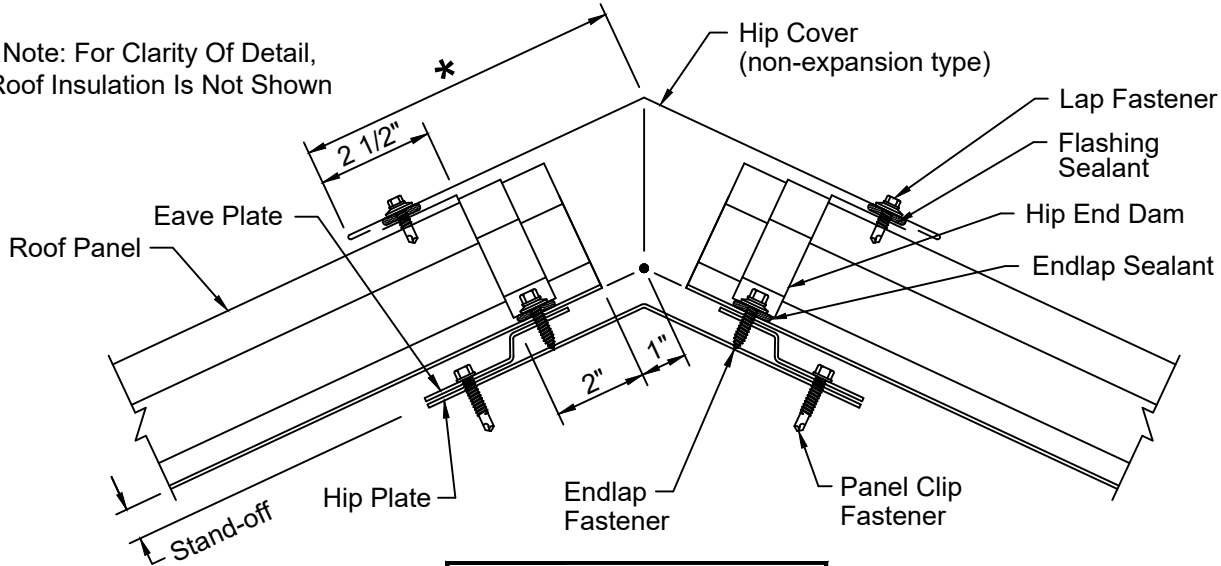

Fixed Roof Panel Attachment
(Typical For Roof Panel Runs
Less Than 25 Feet)

* *Varies With Roof Pitch*

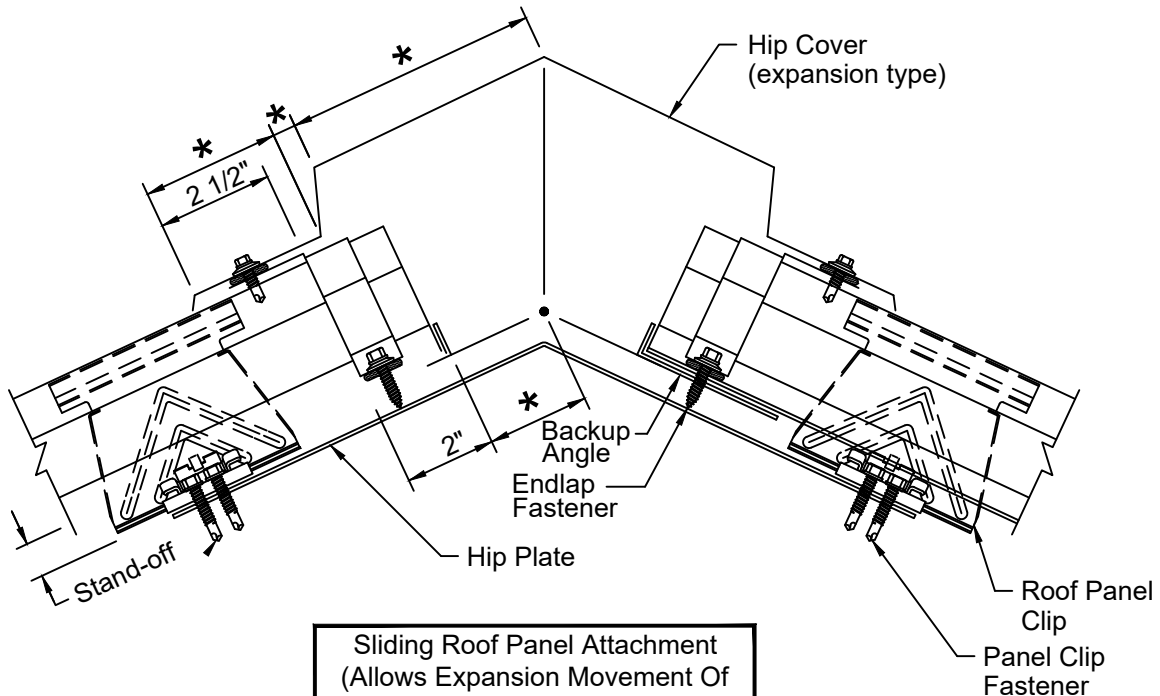

Sliding Roof Panel Attachment
(Allows Expansion Movement Of
Roof Panel, Required When Roof
Panel Run Exceeds 25 Feet)

Hip Section

This drawing, as well as the designs and illustrations shown and described are furnished under licence and may be used or copied only in accordance with the terms of such licence. The content of this drawing is furnished to the Building Research Systems, Inc. (BRS) licensee only and is subject to change without notice and should not be construed as a commitment by BRS.

Printed in the United States of America. All rights reserved. This drawing may not be produced, stored in a retrieval system, or transmitted in any form without the written permission of Building Research Systems, Inc.



Creating Unique Products
for Your Market Needs

TS-324™ Roof System Architectural Details

Dwg. No.

E_TS0_016R01BRS

Date

AUGUST 2021

Note: For Clarity Of Detail,
Roof Insulation Is Not Shown

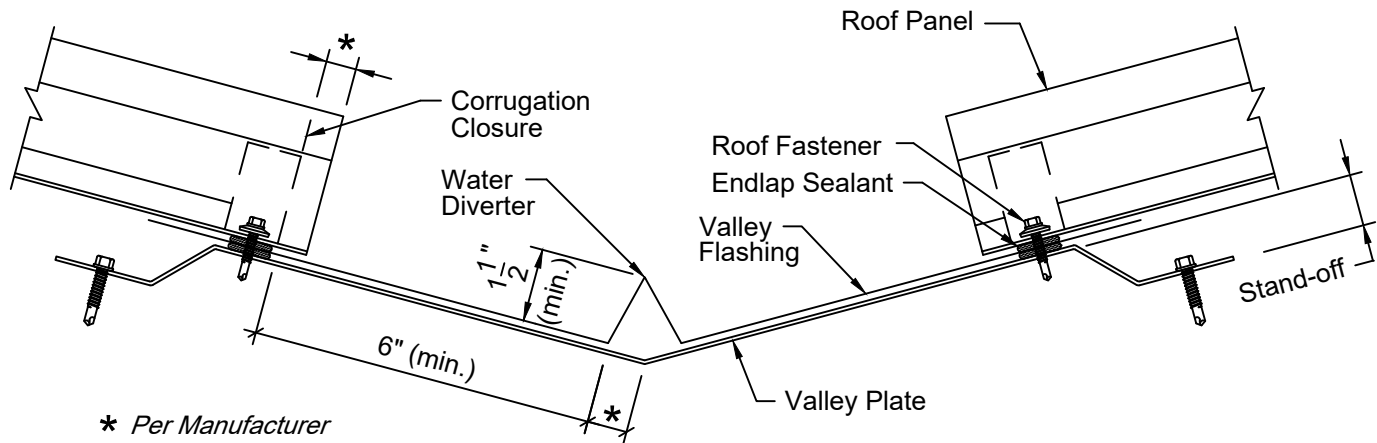

Valley Section

This drawing, as well as the designs and illustrations shown and described are furnished under licence and may be used or copied only in accordance with the terms of such licence. The content of this drawing is furnished to the Building Research Systems, Inc. (BRS) licensee only and is subject to change without notice and should not be construed as a commitment by BRS.

Printed in the United States of America. All rights reserved. This drawing may not be produced, stored in a retrieval system, or transmitted in any form without the written permission of Building Research Systems, Inc.



Creating Unique Products
for Your Market Needs

TS-324™ Roof System Architectural Details

Dwg. No.

E_TS0_017R01BRS

Date

AUGUST 2021

Note: For Clarity Of Detail,
Roof Insulation Is Not Shown

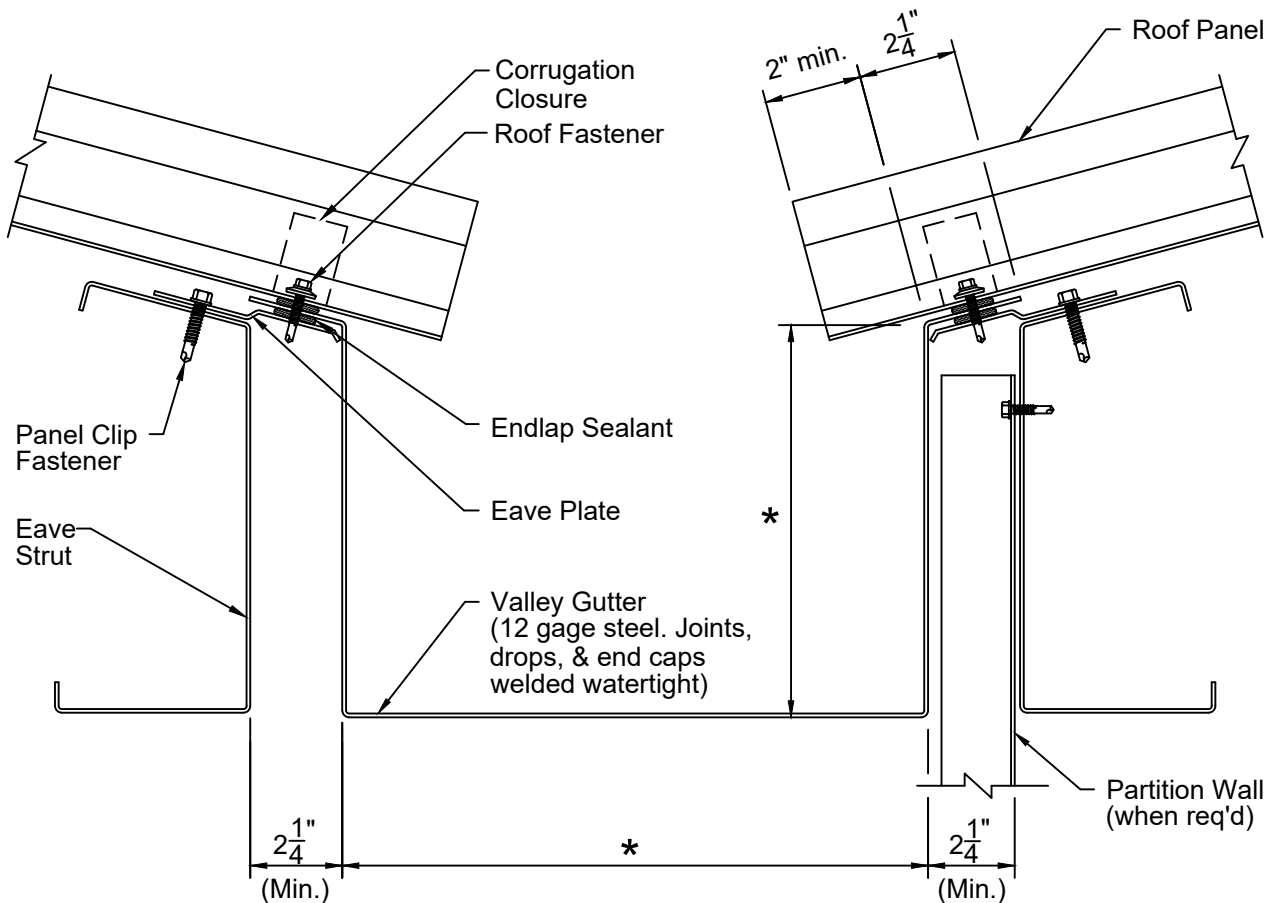

* As Determined By Manufacturer

CAUTION
Interior Gutter Must Be
Provided With Protection From
Corrosion, Icing, Damming &
Interior Condensation

Valley Gutter Section

This drawing, as well as the designs and illustrations shown and described are furnished under licence and may be used or copied only in accordance with the terms of such licence. The content of this drawing is furnished to the Building Research Systems, Inc. (BRS) licensee only and is subject to change without notice and should not be construed as a commitment by BRS.

Printed in the United States of America. All rights reserved. This drawing may not be produced, stored in a retrieval system, or transmitted in any form without the written permission of Building Research Systems, Inc.



Creating Unique Products
for Your Market Needs

TS-324™ Roof System Architectural Details

Dwg. No.

E_TS0_018R01BRS

Date

AUGUST 2021

Note: For Clarity Of Detail,
Roof Insulation Is Not Shown

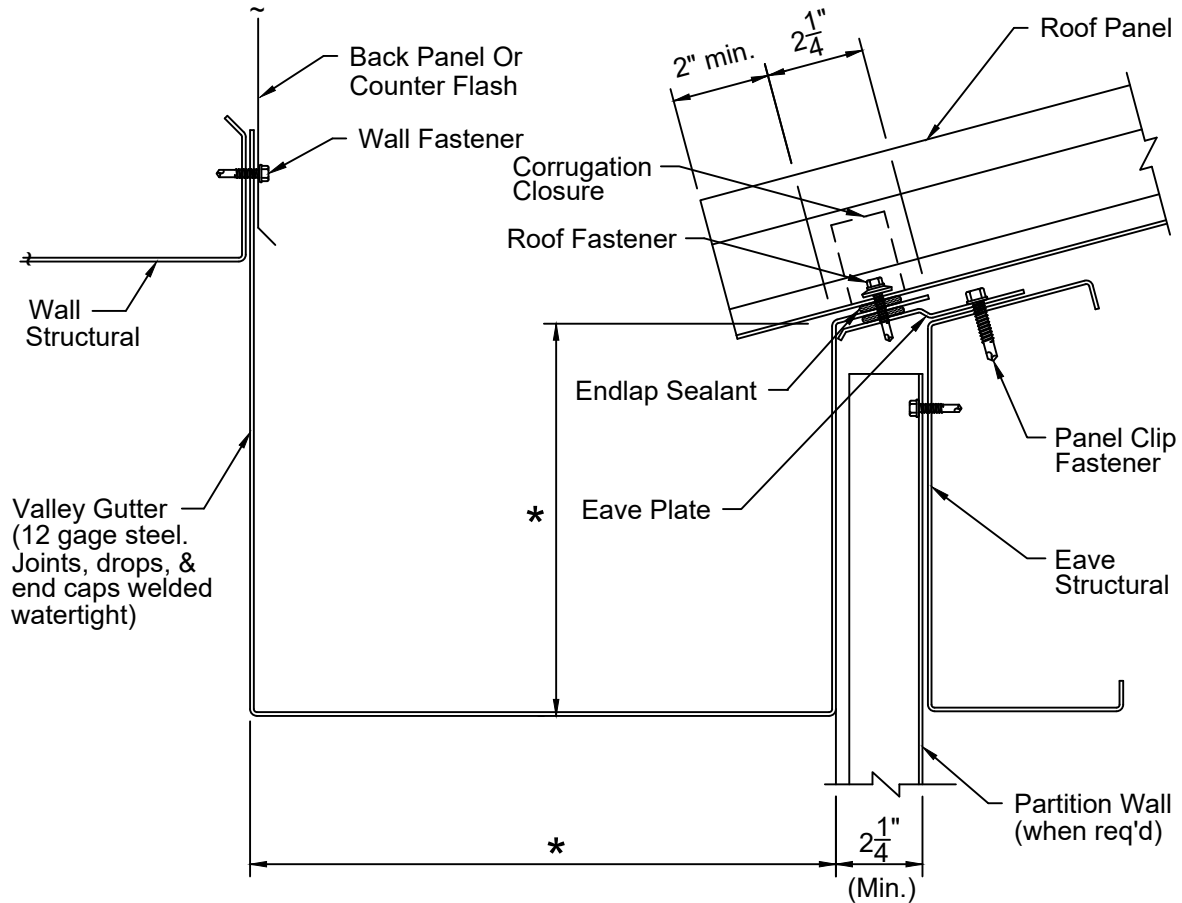

* As Determined By Manufacturer

CAUTION
Interior Gutter Must Be
Provided With Protection From
Corrosion, Icing, Damming &
Interior Condensation

Interior Eave Gutter Section

This drawing, as well as the designs and illustrations shown and described are furnished under licence and may be used or copied only in accordance with the terms of such licence. The content of this drawing is furnished to the Building Research Systems, Inc. (BRS) licensee only and is subject to change without notice and should not be construed as a commitment by BRS.

Printed in the United States of America. All rights reserved. This drawing may not be produced, stored in a retrieval system, or transmitted in any form without the written permission of Building Research Systems, Inc.



Creating Unique Products
for Your Market Needs

TS-324™ Roof System Architectural Details

Dwg. No.

E_TS0_019R02BRS

Date

AUGUST 2021

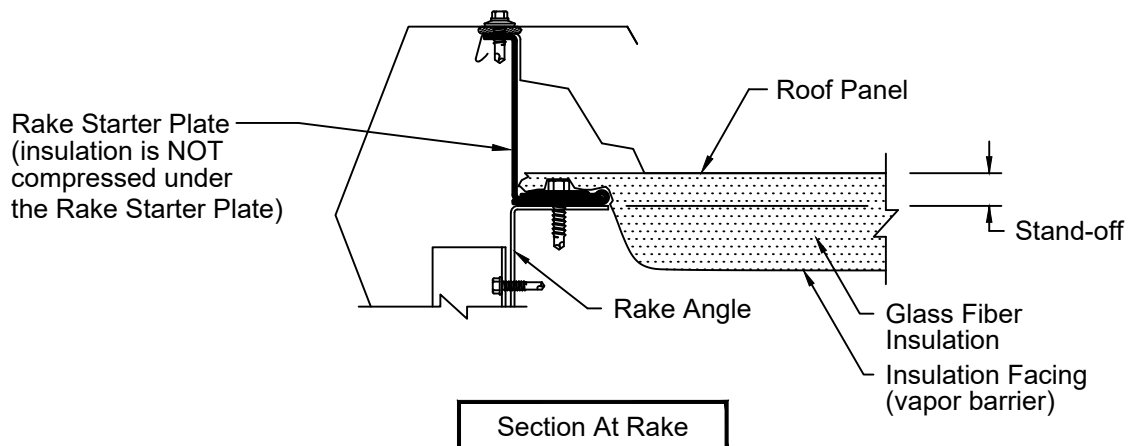
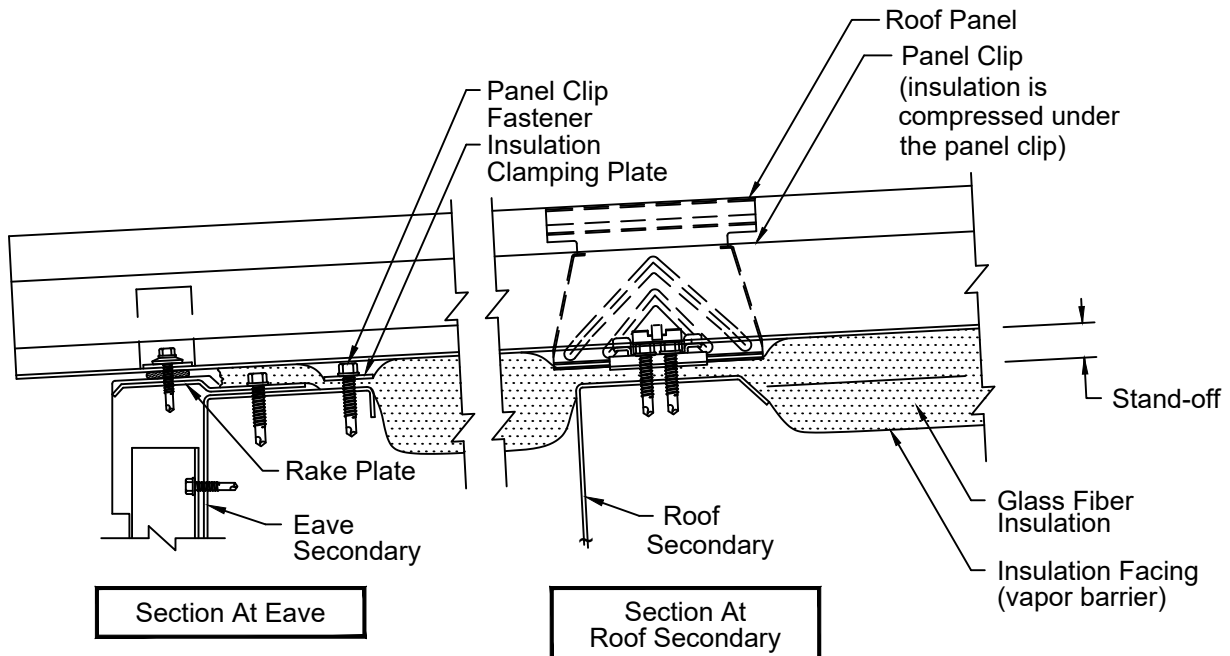

Insulation Note

- 1/2" Standoff Is Recommended For Up To 4" Thick Insulation.
- 1 1/2" Standoff Is Recommended For 4" To 6" Thick Insulation.
- 2" Standoff Is Recommended For 6" To 8" Thick Insulation.
- 2 1/2" Standoff Is Recommended For 8" To 10" Thick Insulation.
- 3" Standoff Is Recommended For 10" to 12" Insulation.

Roof Sections - Fiberglass Insulation

This drawing, as well as the designs and illustrations shown and described are furnished under licence and may be used or copied only in accordance with the terms of such licence. The content of this drawing is furnished to the Building Research Systems, Inc. (BRS) licensee only and is subject to change without notice and should not be construed as a commitment by BRS.

Printed in the United States of America. All rights reserved. This drawing may not be produced, stored in a retrieval system, or transmitted in any form without the written permission of Building Research Systems, Inc.



Creating Unique Products
for Your Market Needs

TS-324™ Roof System Architectural Details

Dwg. No.

E_TS0_020R02BRS

Date

AUGUST 2021

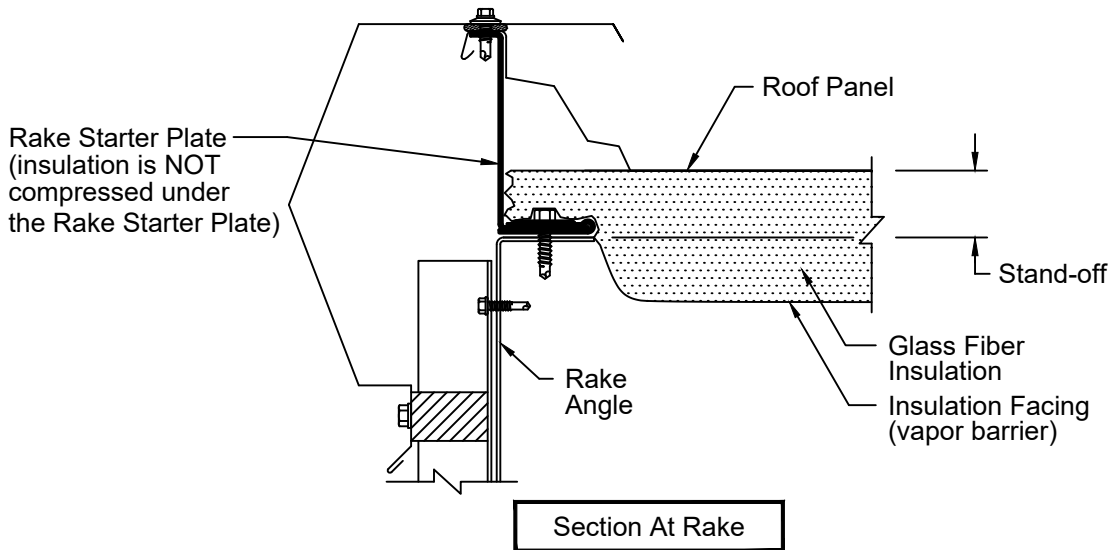
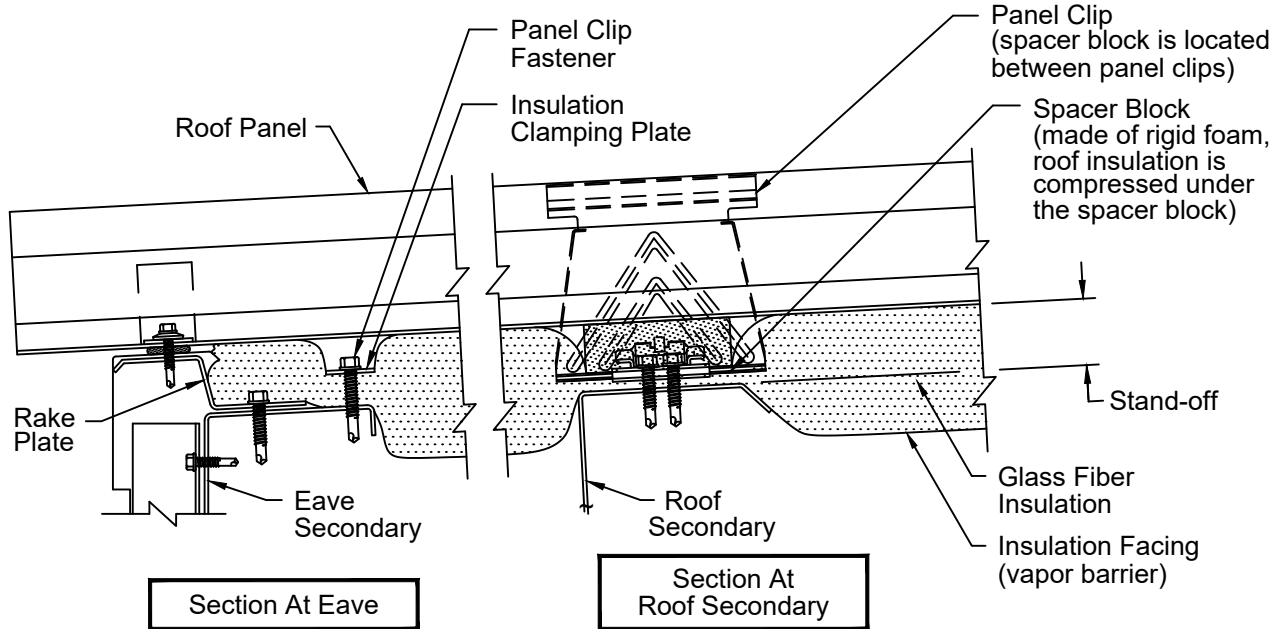

Insulation Note

- 1/2" Standoff Is Recommended For Up To 4" Thick Insulation.
- 1 1/2" Standoff Is Recommended For 4" To 6" Thick Insulation.
- 2" Standoff Is Recommended For 6" To 8" Thick Insulation.
- 2 1/2" Standoff Is Recommended For 8" To 10" Thick Insulation.
- 3" Standoff Is Recommended For 10" To 12" Insulation.

Roof Sections - Fiberglass Insulation With Thermal Spacer Blocks

This drawing, as well as the designs and illustrations shown and described are furnished under licence and may be used or copied only in accordance with the terms of such licence. The content of this drawing is furnished to the Building Research Systems, Inc. (BRS) licensee only and is subject to change without notice and should not be construed as a commitment by BRS.

Printed in the United States of America. All rights reserved. This drawing may not be produced, stored in a retrieval system, or transmitted in any form without the written permission of Building Research Systems, Inc.



Creating Unique Products
for Your Market Needs

TS-324™ Roof System Architectural Details

Dwg. No.

E_TS0_021R02BRS

Date

AUGUST 2021

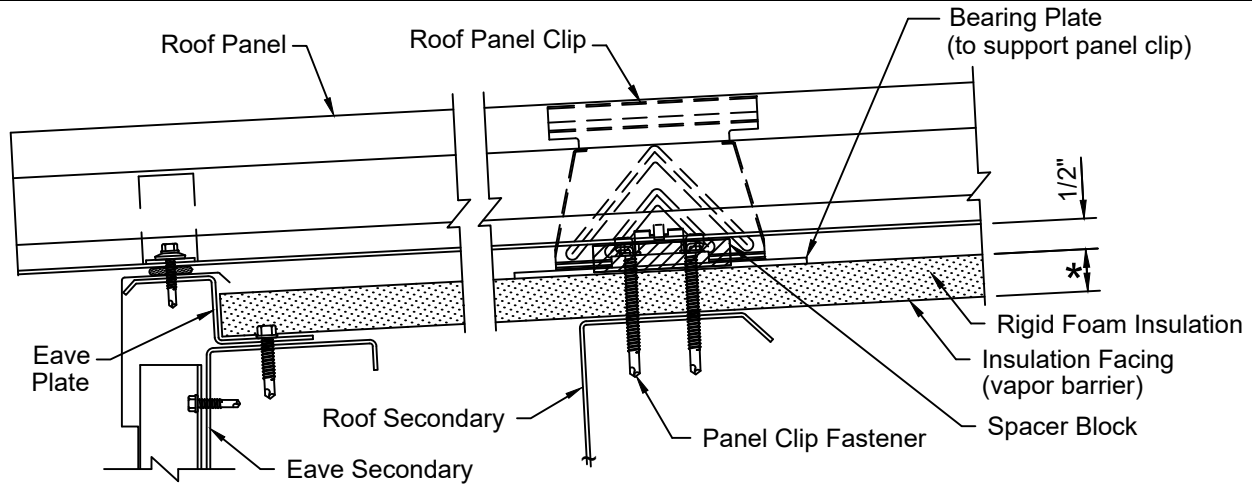

Section At Eave

Section At
Roof Secondary

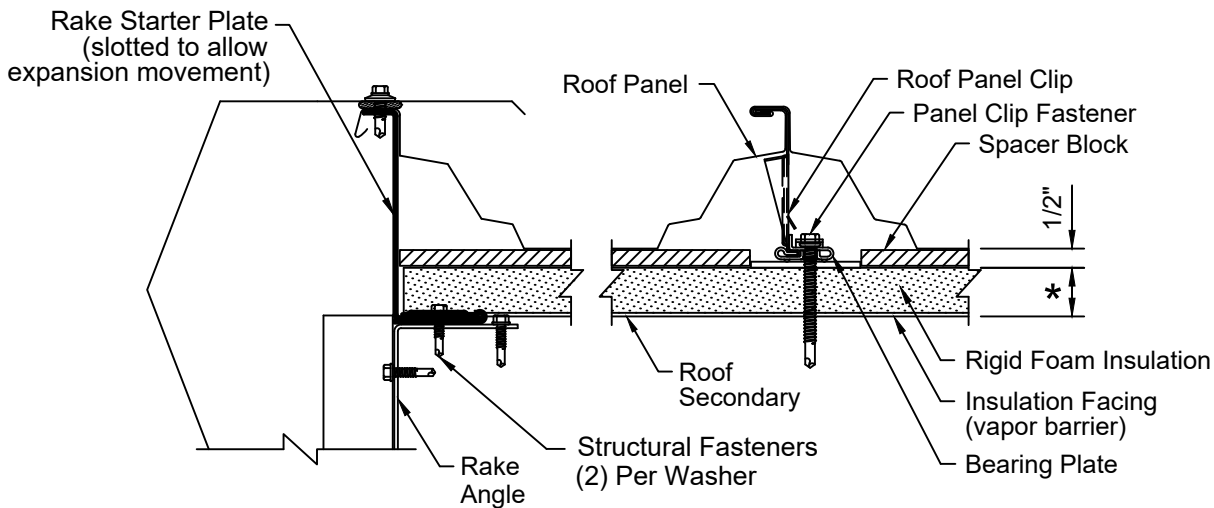

Section At Rake

* Notes

Rigid Foam Insulation Thickness Varies
Rigid Insulation Will Require Custom Eave, Rake Starter Plates, And Rake Plates

Roof Sections - Rigid Foam Insulation

This drawing, as well as the designs and illustrations shown and described are furnished under licence and may be used or copied only in accordance with the terms of such licence. The content of this drawing is furnished to the Building Research Systems, Inc. (BRS) licensee only and is subject to change without notice and should not be construed as a commitment by BRS.

Printed in the United States of America. All rights reserved. This drawing may not be produced, stored in a retrieval system, or transmitted in any form without the written permission of Building Research Systems, Inc.