

Product Code 1241TB

12"x41"x 2 1-4" Step Tread Broom Finish w/ 3/8" Bolts

Camp Logan Cement Works Inc.

www.camplogancement.com

800-445-9062

clcw@camplogancement.com

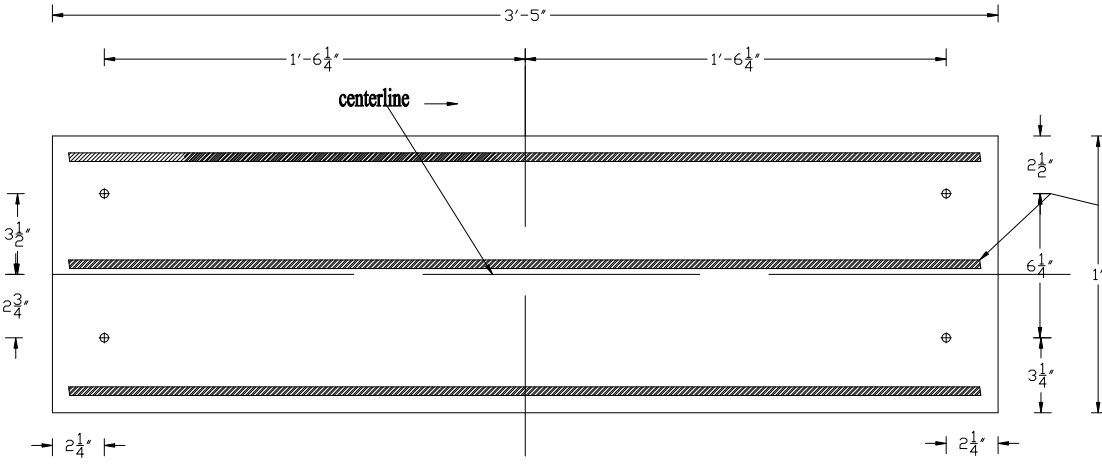

3 PIECES OF #3 REBAR
EMBEDDED 3/4" IN TREAD

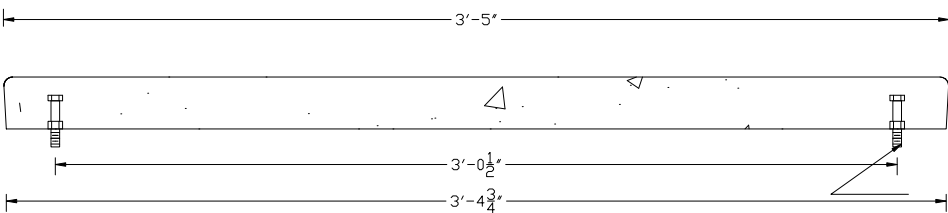
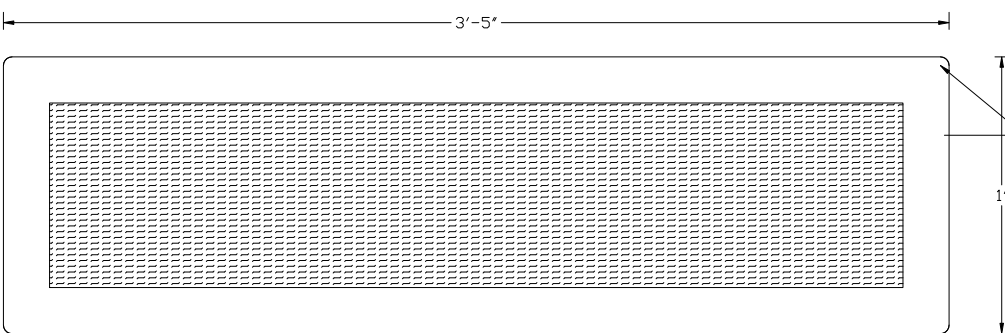

3/8" BOLTS ENCASED IN
CONCRETE W/ SUPPORT
NUT

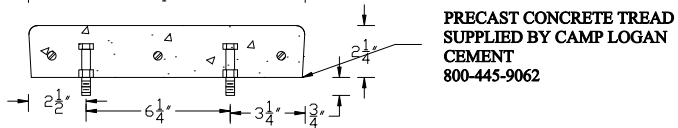

usually 2 1/2" is front of tread

