

Product Code 1242TBLIP

12"x42"x 2 1-4" Step Tread Broom Finish w/ lip w/ $\frac{3}{8}$ " Bolts

Camp Logan Cement Works Inc.

www.camplogancement.com

800-445-9062

clcw@camplogancement.com

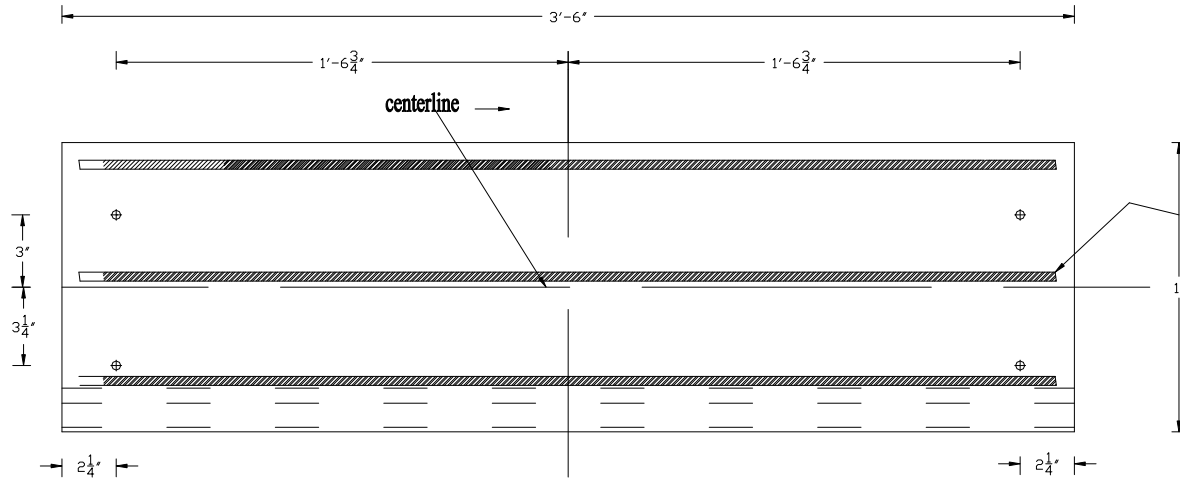

3 PIECES OF #3 REBAR GRADE 40
EMBEDDED 3/4" IN TREAD

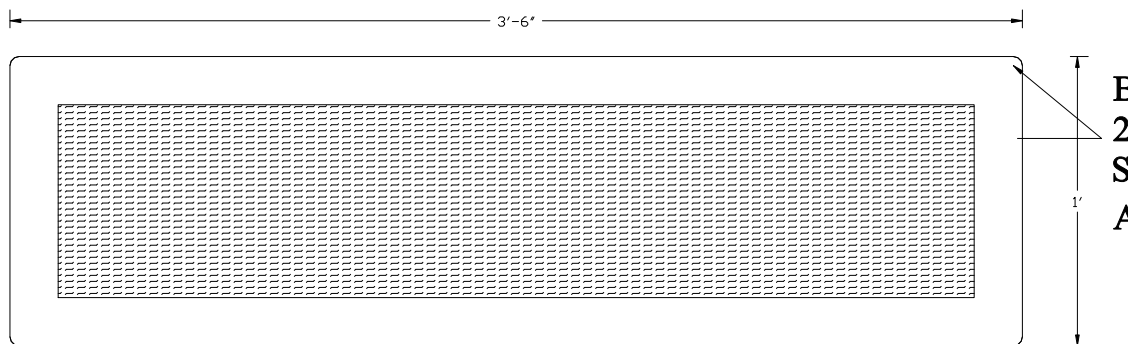

BRUSH FINISH W/
2" EDGING ON
SIDES
AND A $\frac{3}{8}$ " RADIUS

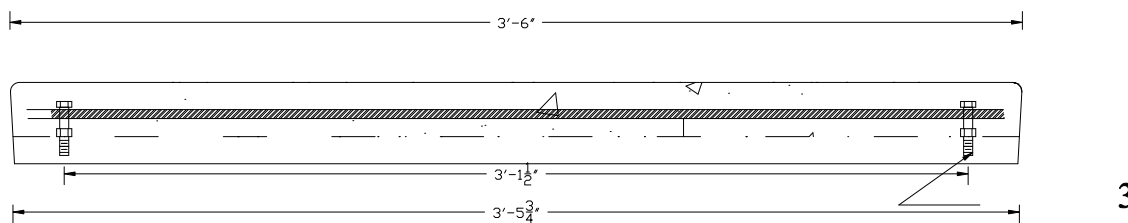

$\frac{3}{8}$ " BOLTS ENCASED IN
CONCRETE W/ SUPPORT
NUT

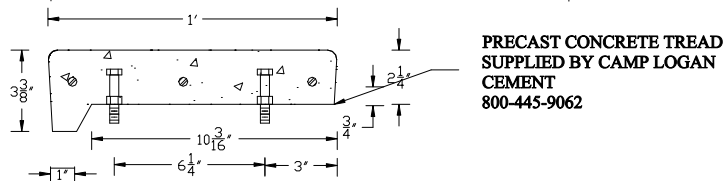

PRECAST CONCRETE TREAD
SUPPLIED BY CAMP LOGAN
CEMENT
800-445-9062