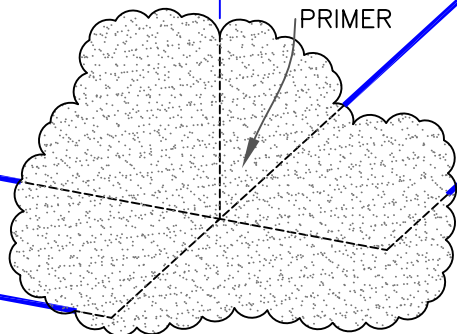
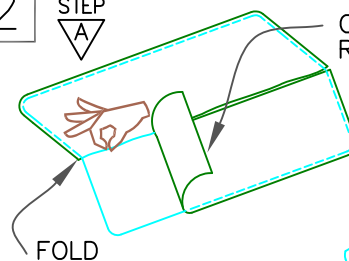

1

EPDM
PRIMER

CLEAN THE DRY SPLICE AREA OF THE EPDM MEMBRANE BY SCRUBBING WITH EPDM PRIMER.

2

STEP
ACLEAR POLY
RELEASE PAPER

FOLD

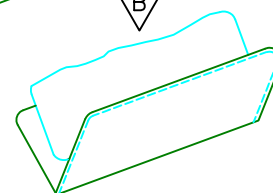
STEP
B

PRIOR TO PLACEMENT OF SURE-SEAL CORNER, PEEL OFF THE BLUE POLY RELEASE FILM AND HEAT THE FLASHING SIDE WITH A HEAT GUN. RE-APPLY THE POLY LOOSELY. FOLD THE FLASHING IN HALF.

3

FIRMLY PRESS

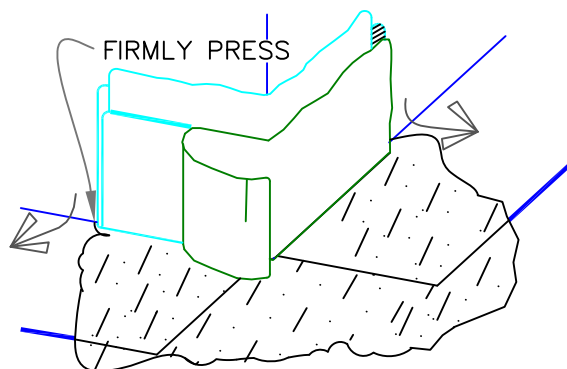

PLACE SURE-SEAL INSIDE/OUTSIDE CORNER AS SHOWN AND REMOVE RELEASE PAPER. PRESS FOLDED FLASHING TIGHTLY INTO ANGLE CHANGE AND FIRMLY PRESS FLASHING AGAINST THE VERTICAL SURFACE.

4

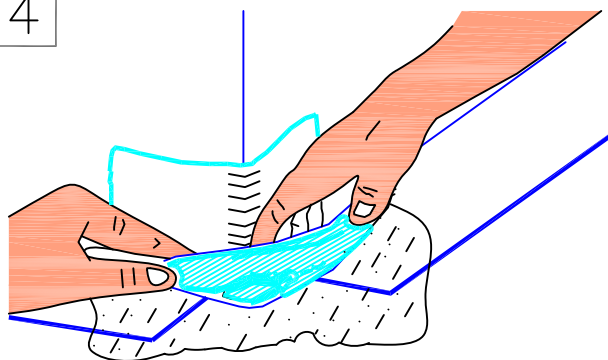

PLACE FOLDED FLASHING TIGHTLY INTO ANGLE CHANGE AND FIRMLY PRESS FLASHING ONTO THE DECK FLANGE BY PRESSING THE FLASHING AGAINST THE HORIZONTAL SURFACE.

5

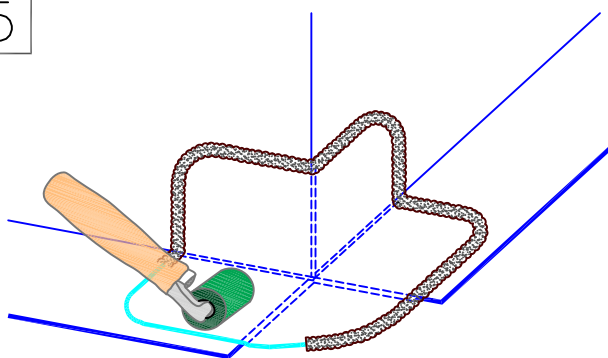

ROLL WITH A TWO INCH WIDE ROLLER. PAY PARTICULAR ATTENTION TO THE STEP OFFS AND ANGLE CHANGE.

NOTE:

FOR PROJECTS WITH 25 AND 30-YEAR WARRANTIES OR WHEN USING 145-MIL MEMBRANE, REFER TO THERMOSET DETAIL U-15H FOR REQUIRED FLASHING ENHANCEMENTS.

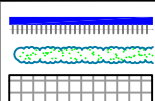

— FleeceBACK MEMBRANE

— FLEX FAST/AQUABASE

— APPROVED SUBSTRATE

— SEE NOTE(S)

EPDM PRESSURE-SENSITIVE OUTSIDE
CORNER

MAXIMUM WARRANTY: 30 YEARS



DETAIL NO.

FB-15B.1

FLEECEBACK ADHERED