

MEMBRANE SPLICE

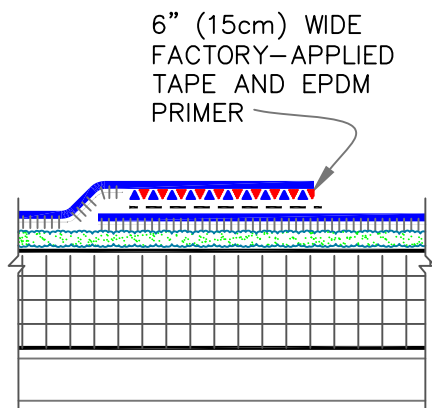

END LAP SPLICE

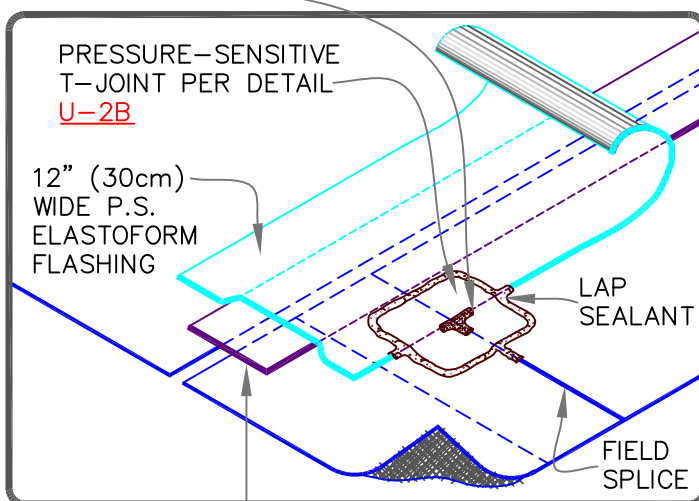
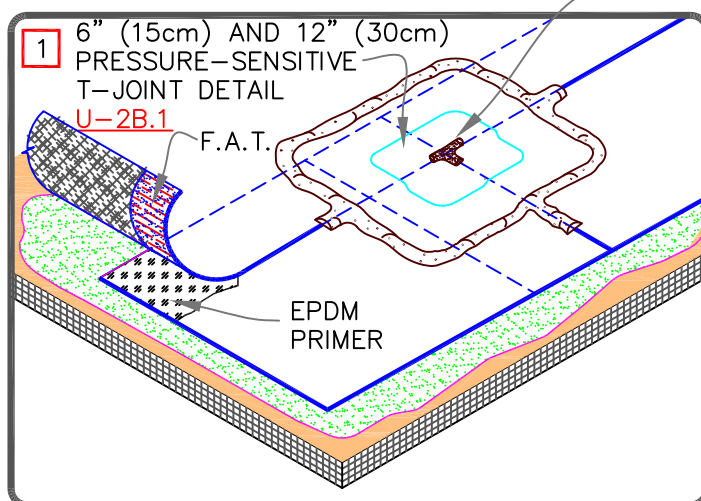
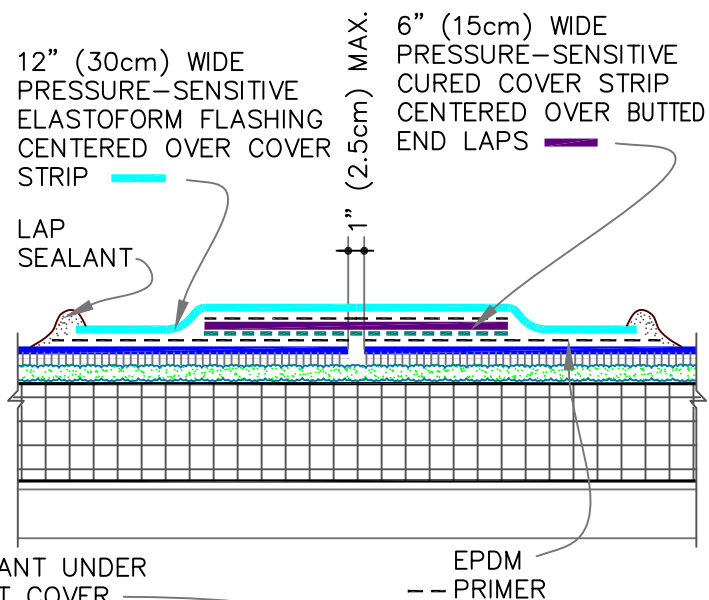

NOTES:

1. APPLY EPDM PRIMER TO MEMBRANE SURFACES PRIOR TO INSTALLING PRESSURE-SENSITIVE FLASHING AND/OR FACTORY APPLIED SecurTAPE.
2. APPLY LAP SEALANT ALONG THE EDGE OF THE MEMBRANE SPLICE (UNDER THE 6"x6" (15cm X 15cm) T-JOINT COVER) COVERING THE EXPOSED SPLICE TAPE 1/2" (1.5cm) IN EACH DIRECTION FROM THE SPLICE INTERSECTION.
3. ALL EPDM SPLICE INTERSECTIONS MUST BE OVERLAID WITH TWO LAYERS OF PRESSURE-SENSITIVE ELASTOFORM FLASHING. THE BOTTOM LAYER SHALL BE 6"x6" (15cm X 15cm) COVERED WITH A 12"x12" (30cm X 30cm) TOP LAYER. BOTH LAYERS SHALL BE CENTERED OVER THE SPLICE INTERSECTION AND SEALED WITH CONTINUOUS LAP SEALANT, AS SHOWN.

6" (15cm) WIDE
PRESSURE-SENSITIVE CURED
COVER STRIP CENTERED
OVER BUTTED END LAPS

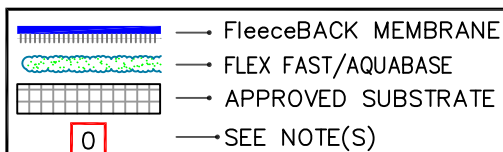

EPDM MEMBRANE SPLICES—
PROJECTS WITH 145-MIL MEMBRANE
OR 25 AND 30-YEAR WARRANTIES

MAXIMUM WARRANTY: 30 YEARS



DETAIL NO.

FB-2A.1

FLEECEBACK ADHERED