

FIELD APPLIED SecurTAPE

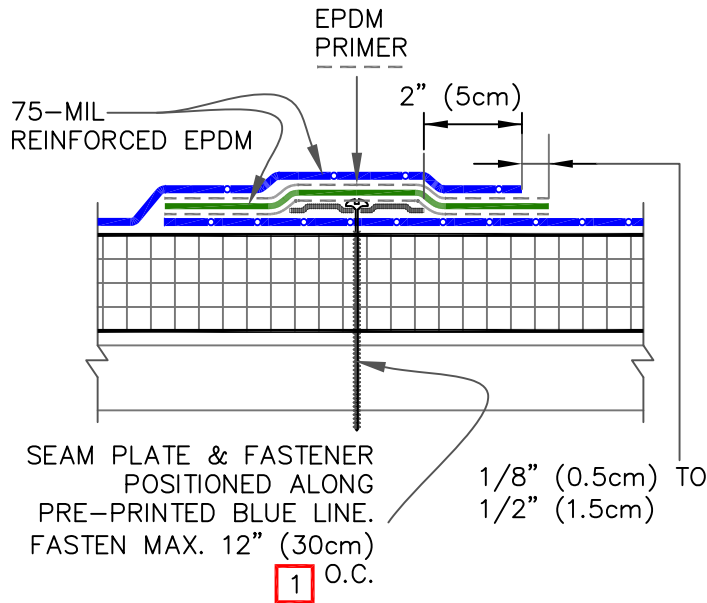

FACTORY APPLIED SecurTAPE

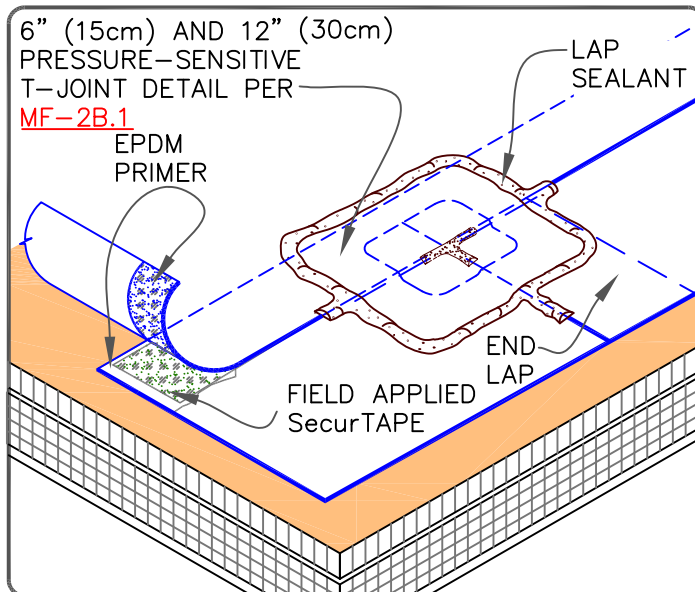
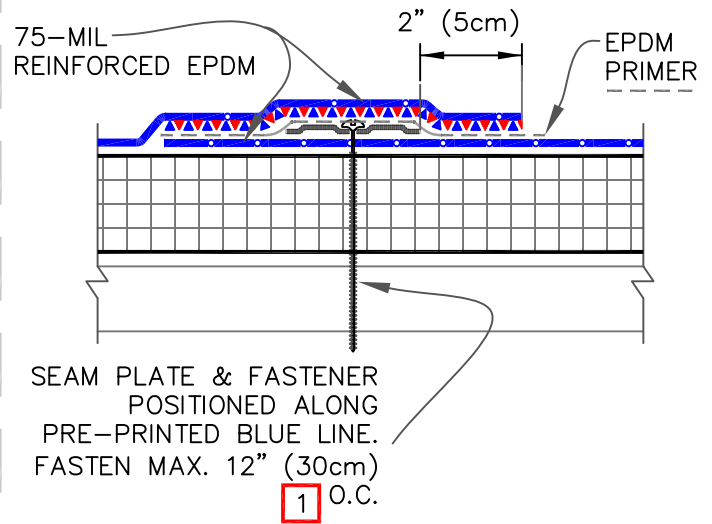

FIELD APPLIED SecurTAPE

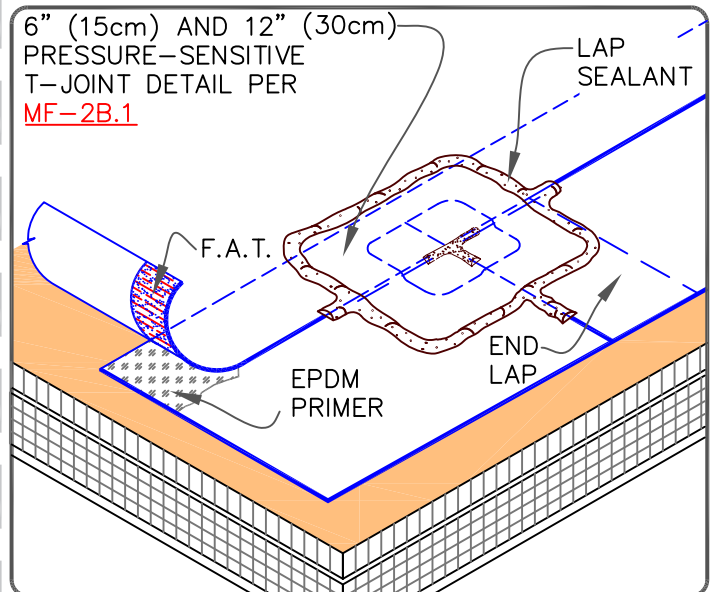

F.A.T. (FACTORY APPLIED SecurTAPE)

NOTES:

1. HP FASTENERS AND POLYMER SEAM PLATES ARE REQUIRED OVER STEEL DECKS.
2. END LAPS SHALL BE SPLICED USING 6" (15cm) WIDE SecurTAPE. REFER TO DETAIL [U-2A.1](#).
3. OVERLAP THE ENDS OF FIELD APPLIED SecurTAPE A MINIMUM OF 1" (2.5cm). APPLY LAP SEALANT AT TAPE OVERLAPS 2" (5cm) IN ALL DIRECTIONS.
4. LAP SEALANT IS REQUIRED ON CUT EDGES OF REINFORCED EPDM MEMBRANE.



MECHANICALLY FASTENED EPDM
MEMBRANE SPLICE
(25 / 30 YEAR WARRANTIES)
MAXIMUM WARRANTY: 30 YEARS

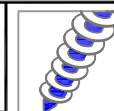

DETAIL NO.

MF-2A.1

MECHANICALLY FASTENED