

## NOTES:

1. REMOVE ALL LEAD AND OTHER FLASHING BEFORE INSTALLING PIPE SEAL.
2. TEMPERATURE OF PIPE MUST NOT EXCEED 180°F (82°C).
3. PRE-MOLDED PIPE SEAL MUST HAVE RIB INTACT AT THE TOP EDGE REGARDLESS OF PIPE DIAMETER.
4. INSTALL A MIN. OF 4 FASTENERS FOR PIPES WITH OUTSIDE DIAMETER <6" (15cm). SEE DETAIL [MF-8B](#) OR [MF-8B.1](#) FOR WIDER PIPES.
5. DECK FLANGES OF THE PRESSURE-SENSITIVE PIPE SEAL SHALL NOT BE OVERLAPPED, CUT OR APPLIED OVER ANY ANGLE CHANGE.

DIMENSIONS		cm	
(A)	1/2"	1.5	
(B)	6"	15	TO
	12"	30	
(C)	2"	5	
(D)	1/2"	1.5	TO
	6"	15	

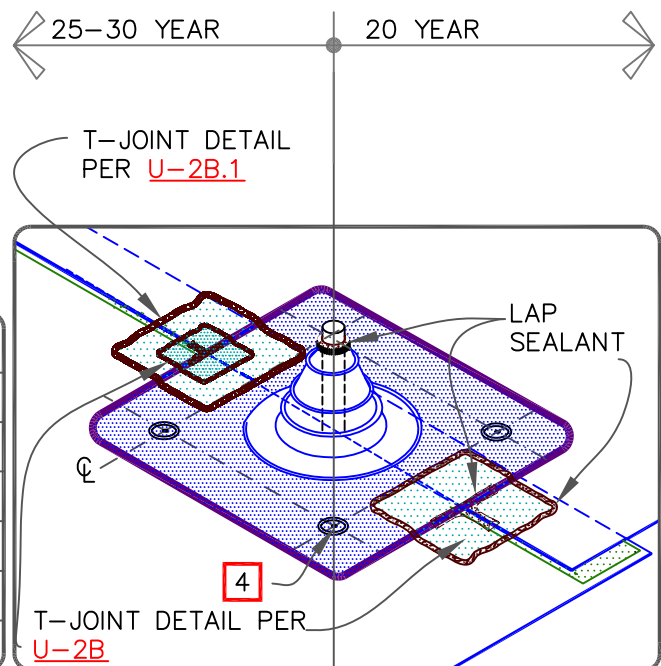

PRESSURE-SENSITIVE PIPE SEAL WITH  
20" PRESSURE-SENSITIVE CURED  
FLASHING

MAXIMUM WARRANTY: 30 YEARS

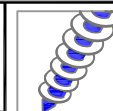

DETAIL NO.

MF-8A.1

MECHANICALLY FASTENED