

POSITION MEMBRANE TO ALLOW AN APPROXIMATE 7" (17.5cm) OVERLAP. MARK THE BOTTOM SHEET WITH AN INDELIBLE MARKER 1/2" (1.5cm) FROM THE EDGE OF THE TOP SHEET AS SHOWN. THE PRE-MARKED LINE ON THE MEMBRANE EDGE CAN ALSO BE USED AS A GUIDE.

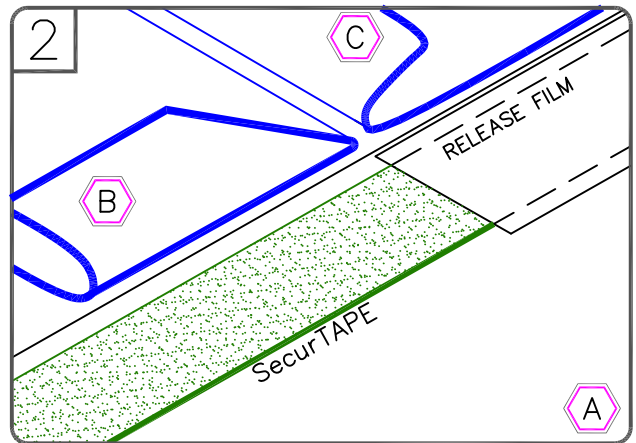

FOLD SHEETS BACK AS SHOWN. APPLY EPDM PRIMER TO THE SPLICE AREA ON BOTH SURFACES AND ALLOW TO FLASH-OFF. APPLY SecurTAPE WITH RELEASE FILM ALIGNED WITH MARKED LINE.

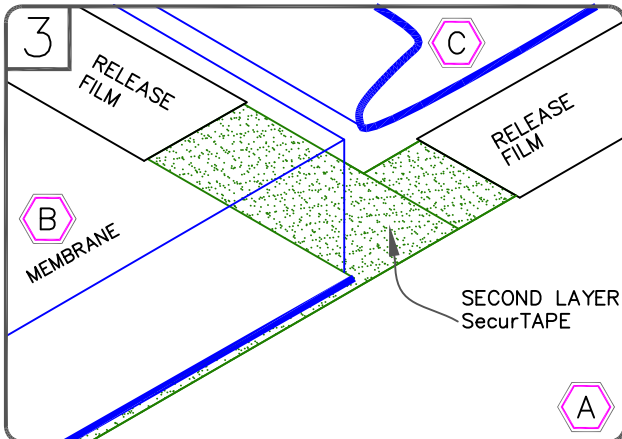

SPLICE SHEET B TO SHEET A AND APPLY SECOND PIECE OF SecurTAPE BETWEEN SHEET B AND C. TRIM RELEASE FILM AS SHOWN.

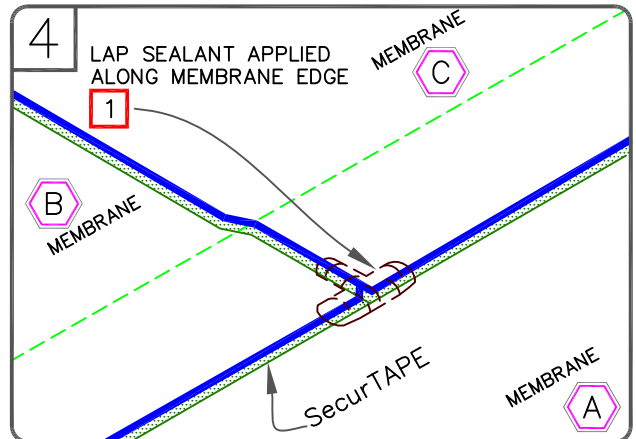

SPLICE SHEET C TO SHEET A AND B, PRESS TOP SHEET ONTO BOTTOM SHEET USING HAND PRESSURE TOWARDS THE OUTER EDGE OF THE SPLICE AND ROLL THE SPLICE AREA WITH A 2" (5cm) WIDE STEEL ROLLER.

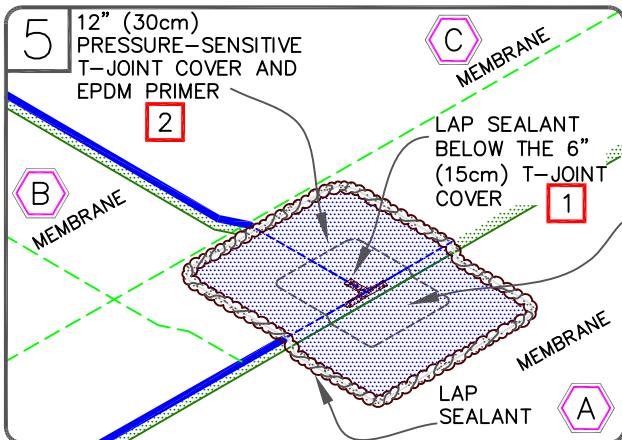

APPLY 6" (15cm) PRESSURE-SENSITIVE T-JOINT COVER AND 12" (30cm) PRESSURE-SENSITIVE T-JOINT COVER OR PRESSURE-SENSITIVE ELASTOFORM CENTERED OVER THE INTERSECTING POINT OF THE LEADING EDGES OF THE FIELD SPLICE INTERSECTION AS SHOWN.

6" (15cm) PRESSURE-SENSITIVE T-JOINT COVER AND EPDM PRIMER

#### NOTES:

1. APPLY LAP SEALANT ALONG THE EDGES OF THE MEMBRANE SPLICE COVERING THE EXPOSED SPLICE TAPE 1/2" (15cm) IN EACH DIRECTION FROM THE SPLICE INTERSECTION.
2. APPLY LAP SEALANT AT CUT EDGES OF REINFORCED MEMBRANE AND TAPE OVER LAPS.



EPDM MEMBRANE SPLICE  
INTERSECTION  
(25 / 30 YEAR WARRANTIES OR  
90mil MEMBRANE)  
MAXIMUM WARRANTY: 30 YEARS



DETAIL NO.

U-2B.1

THERMOSET UNIVERSAL