

**OPTION 1**

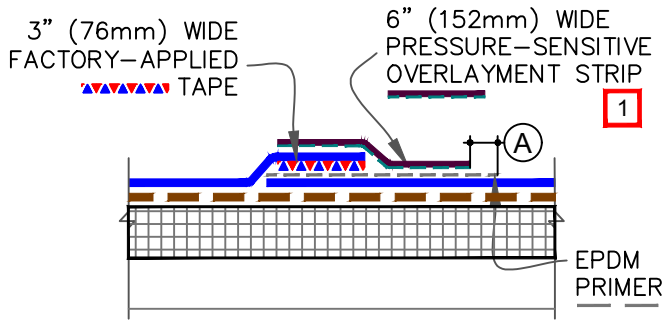

**OPTION 2**

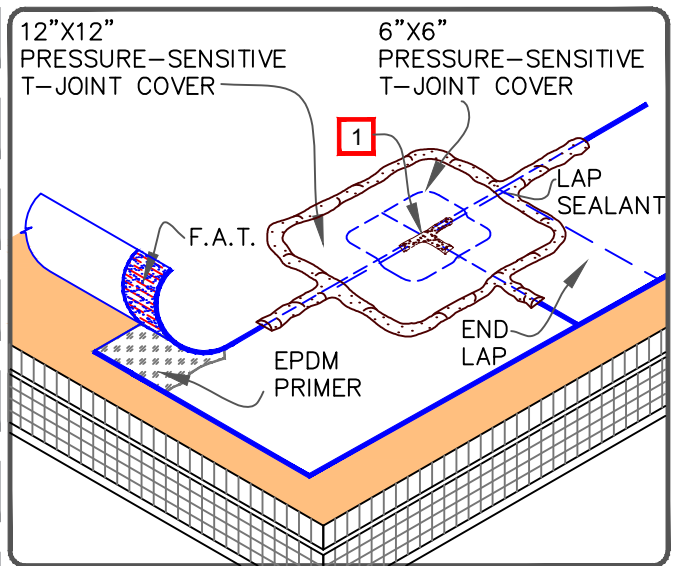
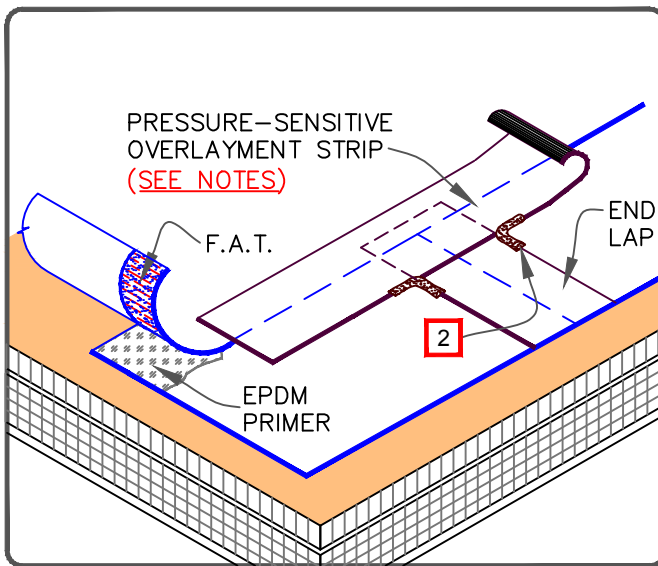
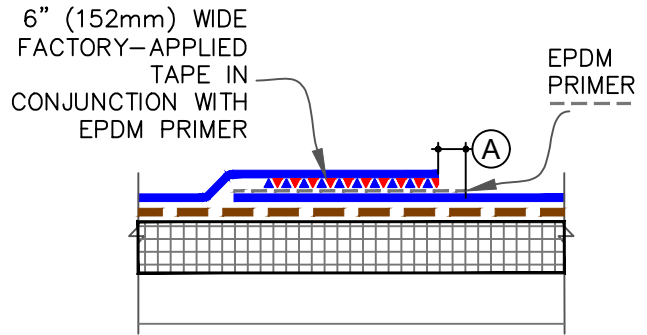

NOTES:

1. TAPE SPLICES MAY BE A MINIMUM 3" (76mm) WIDE FACTORY APPLIED TAPE (FAT). IN ADDITION, OVERLAY THE ENTIRE FIELD SPLICE WITH A CONTINUOUS 6" (152mm) WIDE PRESSURE-SENSITIVE OVERLAYMENT STRIP.
2. APPLY LAP SEALANT AT ALL INTERSECTIONS BETWEEN PRESSURE-SENSITIVE OVERLAYMENT STRIP.

NOTE:

1. APPLY LAP SEALANT ALONG THE LEADING EDGE OF THE MEMBRANE SPLICE COVERING 1/2" (13mm) IN ALL DIRECTIONS FROM THE SPLICE INTERSECTION AND OVERLAY WITH A 6"X6" (152X152mm) T-JOINT COVER. A SECOND LAYER OF 12"X12" (305X305mm) PRESSURE-SENSITIVE T-JOINT COVER IS REQUIRED.

DIMENSION	mm
(A) 1/8" TO 1/2"	3 TO 13mm

F.A.T. (FACTORY APPLIED SecurTAPE)

REV. 1/17



**EPDM MEMBRANE SPLICES (25 / 30 YEAR WARRANTIES)**

For additional information, refer to Specifications

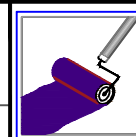

DETAIL NO.

A-2

ADHERED EPDM