

CAUTION

DETAIL NOT FOR USE ON 25 OR 30-YEAR WARRANTY PROJECTS. ACCEPTABLE EDGING SHALL CONFORM TO [DETAIL A-1A.1](#).

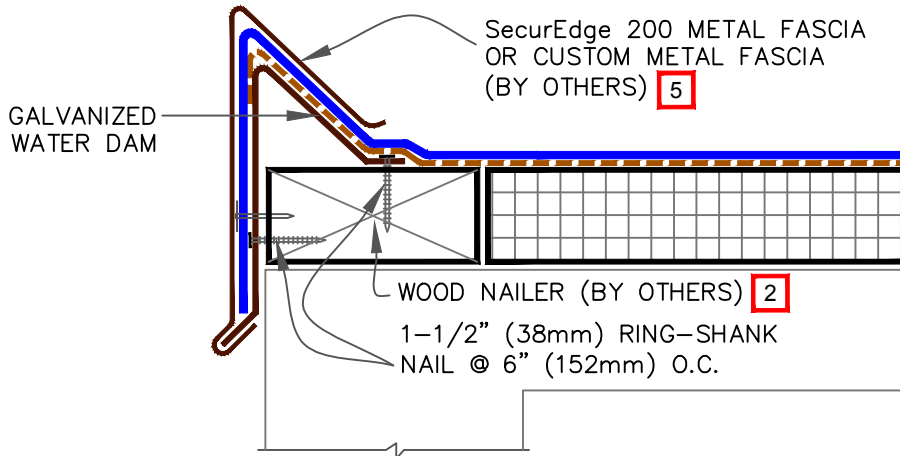

NOTES:

1. REFER TO [SecurEdge 200 INSTALLATION INSTRUCTION MANUAL](#) FOR STEP-BY-STEP INSTALLATION PROCEDURES.
2. WOOD NAILER MUST EXTEND PAST TOTAL WIDTH OF GRAVEL STOP DECK FLANGE.
3. APPLY EPDM PRIMER TO THE MEMBRANE SURFACE PRIOR TO INSTALLING PRESSURE-SENSITIVE ELASTOFORM FLASHING
4. 6" (152mm) WIDE SECTION OF PRESSURE-SENSITIVE ELASTOFORM FLASHING MAY ALSO BE CENTERED OVER FIELD SPLICE AT ANGLE CHANGE. PROJECTS USING 90-MIL MEMBRANE REQUIRE TWO LAYERS OF PRESSURE-SENSITIVE ELASTOFORM FLASHING. THE BOTTOM LAYER SHALL BE 6" (152mm) WIDE COVERED WITH A 12" WIDE TOP LAYER (305mm). BOTH LAYERS SHALL BE CENTERED AND SEALED WITH CONTINUOUS LAP SEALANT.
5. WHEN METAL FASCIA BY OTHERS IS USED, FASTENER TYPE AND FASTENING FREQUENCY SHALL BE RECOMMENDED BY METAL EDGE MANUFACTURER.

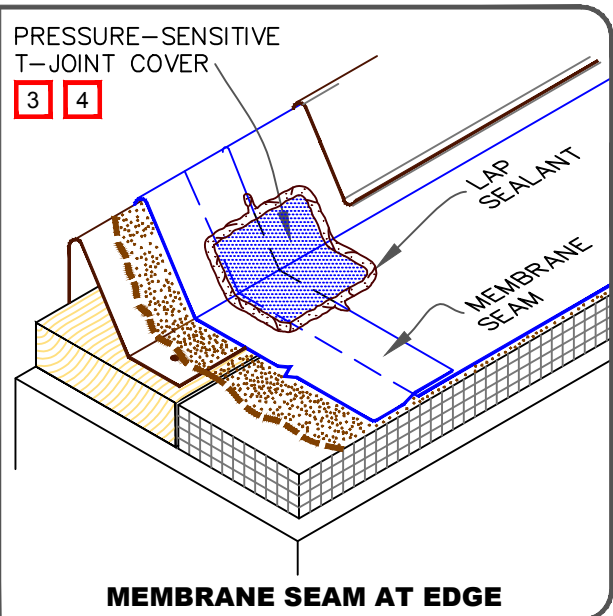
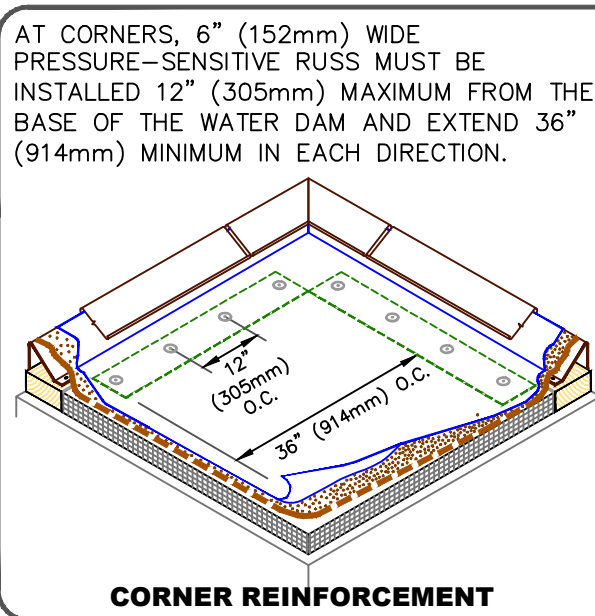

	<p>→ EPDM</p> <p>→ BONDING ADHESIVE</p> <p>→ APPROVED SUBSTRATE</p> <p>→ SEE NOTE(S)</p>	<p>CARLISLE SecurEDGE 200</p> <p>For additional information, refer to Specifications</p>		<p>DETAIL NO.</p> <p>A-1A</p> <p>ADHERED EPDM</p>
--	--	---	--	--