

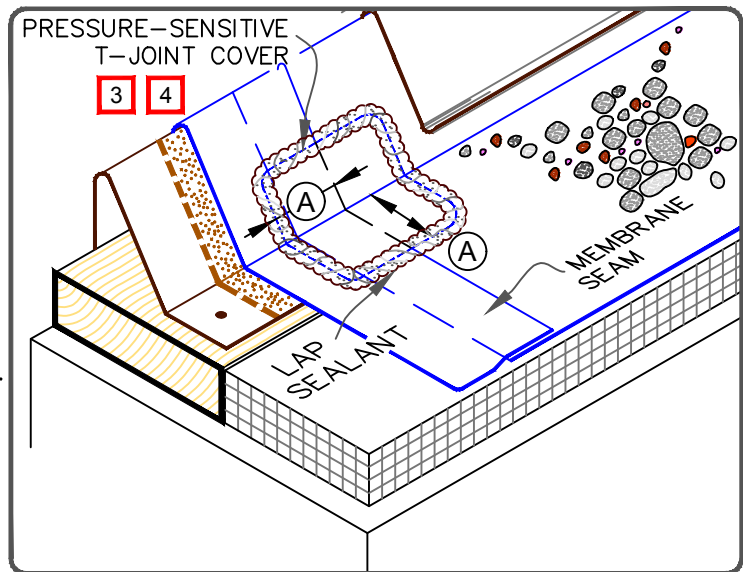



NOTES:

1. REFER TO [SecurEdge 200 INSTALLATION INSTRUCTION MANUAL](#) FOR STEP-BY-STEP INSTALLATION PROCEDURES.
2. WOOD NAILER MUST EXTEND PAST TOTAL WIDTH OF GRAVEL STOP DECK FLANGE.
3. 6" (152mm) WIDE SECTION OF PRESSURE-SENSITIVE ELASTOFORM FLASHING MAY ALSO BE CENTERED OVER FIELD SPLICE AT ANGLE CHANGE.
4. APPLY EPDM PRIMER TO THE MEMBRANE SURFACE PRIOR TO INSTALLING PRESSURE-SENSITIVE ELASTOFORM FLASHING.
5. AT GUTTER EDGES, SCUPPERS MUST BE PROVIDED FOR DRAINAGE.
6. WHEN METAL FASCIA BY OTHERS IS USED, FASTENER TYPE AND FASTENING FREQUENCY SHALL BE RECOMMENDED BY METAL EDGE MANUFACTURER.

DIMENSION	mm	
(A)	3"	76 MIN.



	• EPDM
	• APPROVED SUBSTRATE
	• SEE NOTE(S)

CARLISLE SecurEDGE 200

For additional information, refer to Specifications



DETAIL NO.

B-1A

BALLASTED EPDM