

NOTES:

1. REFER TO [SecurEdge 200 INSTALLATION INSTRUCTION MANUAL](#) FOR STEP-BY-STEP INSTALLATION PROCEDURES.
2. WOOD NAILER MUST EXTEND PAST TOTAL WIDTH OF GRAVEL STOP DECK FLANGE.
3. APPLY EPDM PRIMER TO THE MEMBRANE SURFACE PRIOR TO INSTALLING PRESSURE-SENSITIVE FLASHING.
4. 6" (152 mm) WIDE SECTION OF PRESSURE-SENSITIVE ELASTOFORM FLASHING MAY ALSO BE CENTERED OVER FIELD SPLICE AT ANGLE CHANGE.
5. AT GUTTER EDGES, SCUPPERS MUST BE PROVIDED FOR DRAINAGE.
6. WHEN METAL FASCIA BY OTHERS IS USED, FASTENER TYPE AND FASTENING FREQUENCY SHALL BE RECOMMENDED BY METAL EDGE MANUFACTURER.

DIMENSION	mm	
(A) 3"	76	MIN.

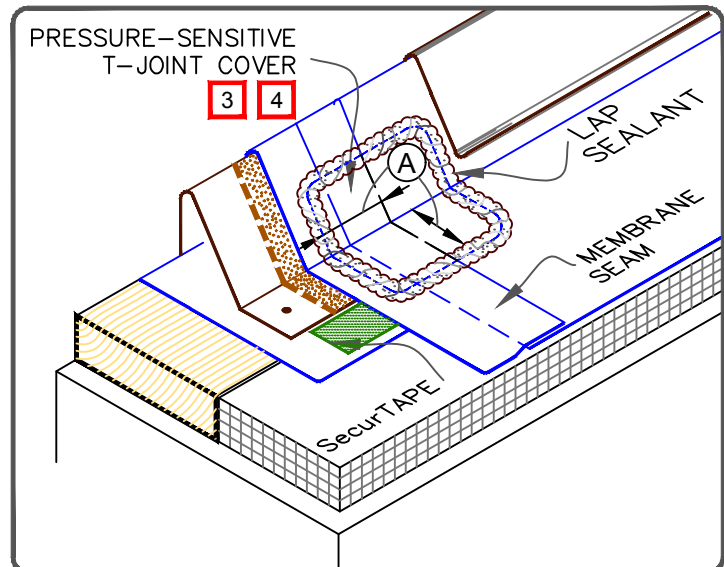

	<p>● REINFORCED EPDM—UNLESS NOTED OTHERWISE</p> <p>● APPROVED SUBSTRATE</p> <p>● SEE NOTE(S)</p>	<p>CARLISLE SecurEDGE 200</p> <p>For additional information, refer to Specifications</p>	<p>DETAIL NO. MF-1A</p> <p>MECHANICALLY FASTENED</p>
--	--	---	---