

NOTES:

1. WHEN USING 60-MIL TPO OR 80-MIL TPO OR PVC MEMBRANE, APPLY A 4-1/2" (11.5cm) DIAMETER "T-JOINT" COVER AT ALL FIELD SPLICE INTERSECTIONS.
2. APPROXIMATELY 1/8" (0.5cm) DIAMETER BEAD OF CUT-EDGE SEALANT IS REQUIRED ON CUT EDGES OF REINFORCED TPO MEMBRANE.
3. WHEN USING 60-MIL TPO, MAXIMUM WARRANTY IS 20 YEARS

DIMENSIONS	cm	
(A) 2-1/4"	6	MIN.

T-JOINT REQUIREMENTS

MEMBRANE	THICKNESS		
	45/50	60	80
PVC	N/A	N/A	YES
KEE HP	N/A	N/A	YES
TPO	N/A	YES	YES

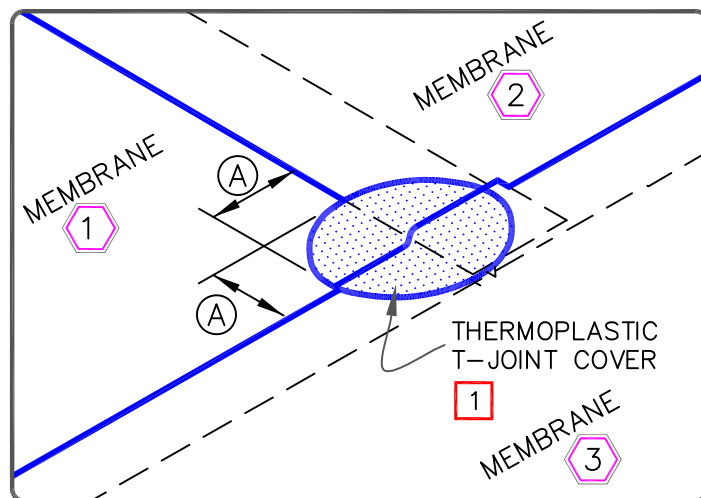

MEMBRANE SPLICE

MAXIMUM WARRANTY: 30 YEARS



DETAIL NO.

U-2A

THERMOPLASTIC UNIVERSAL