

6" (15cm) WIDE  
PRESSURE-SENSITIVE  
RUSS

CARLISLE FASTENER &  
SEAM FASTENING PLATE,  
MAX. 12" (30cm) O.C.

PRE-APPLIED  
PRESSURE-SENSITIVE TAPE

TPO PRIMER

SURE-WELD  
BONDING ADHESIVE

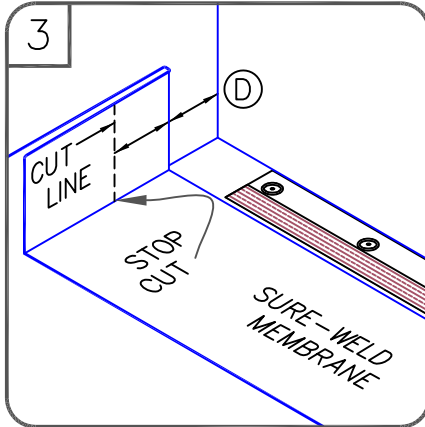
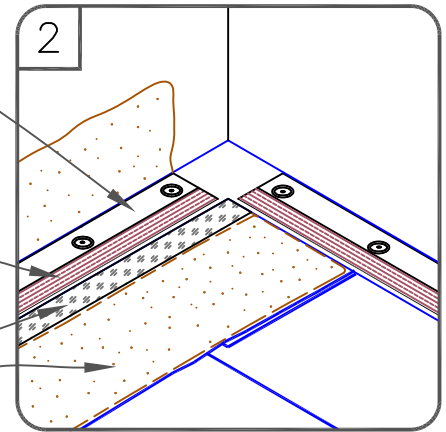

DIMENSIONS	cm	
(A) 6"	15	TO
9"	23	
(B) 1/8"	0.5	MIN.
1"	2.5	MAX.
(C) 12"	30	MIN.
(D) 6"	15	MIN.
(E) 1-1/2"	4	MIN.

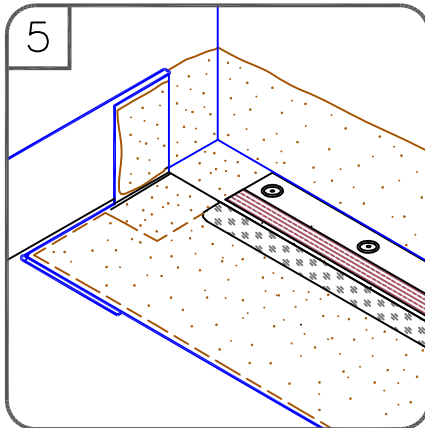
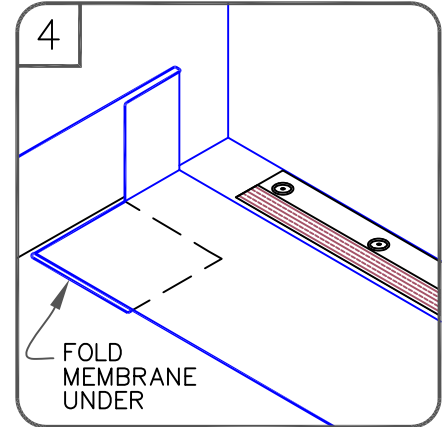

HOT AIR WELD FLAP  
IN [STEP 7](#)

CUT AT 45°

#### NOTES:

1. THE CUT SECTION OF VERTICAL MEMBRANE WILL BE FOLDED UNDER THE FIELD MEMBRANE AS SHOWN IN [STEP 4](#).
2. APPLY INSIDE CORNER IN ACCORDANCE WITH CARLISLE [DETAILS SW-15A OR SW-15B](#).

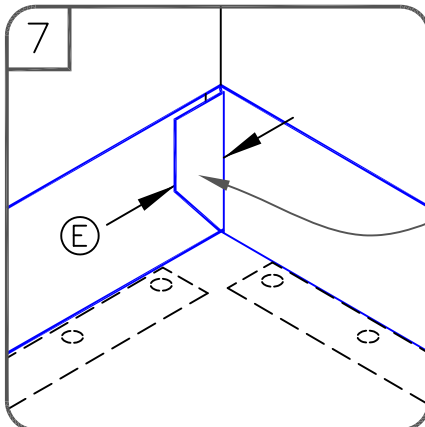
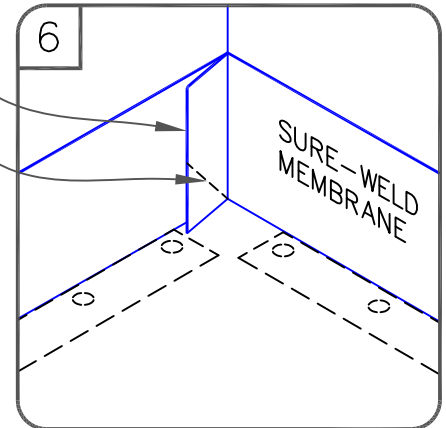

HOT AIR WELD

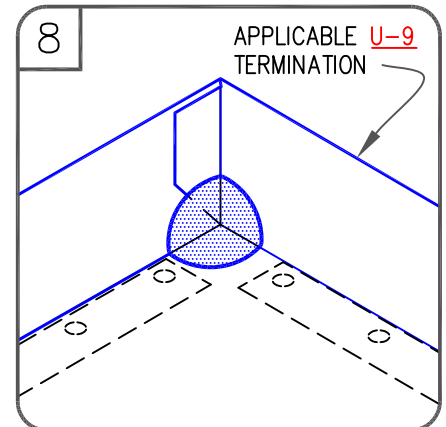

APPLICABLE [U-9](#)  
TERMINATION



PARAPET FLASHING WITH  
PRESSURE-SENSITIVE RUSS-  
PAGE 2 OF 2

MAXIMUM WARRANTY: 30 YEARS



DETAIL NO.

U-12B.1

THERMOPLASTIC TPO